

1. Do not scale from this drawing.
 2. All dimensions to be checked on site before ordering materials or commencing work.
 3. In case of discrepancies in drawings, calculations or details refer to TOWERS ASSOCIATES LTD. for clarification. Unilateral decisions by contractors will not be accepted.
 4. For any information not covered by these drawings, refer to TOWERS ASSOCIATES LTD. for clarification. Unilateral decisions by contractors will not be accepted.
 5. The contractor must ensure that work is being carried out to the latest revisions of all the working drawings.
 6. It is the contractor's responsibility to inform the local authority before work commences and to obtain all necessary approvals and permits.
 7. If work commences on site before full plans approval has been given, TOWERS ASSOCIATES LTD. shall not be responsible for any additional work or materials that the District Surveyor may require.
 8. This drawing and all copies produced therefrom remain the copyright and property of TOWERS ASSOCIATES LTD. and may only be used for the purposes stated. All copies must be returned to TOWERS ASSOCIATES LTD. if demanded.
- By using this drawing the user and his or her employer signify their agreement of the above terms and conditions.

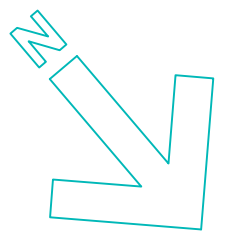
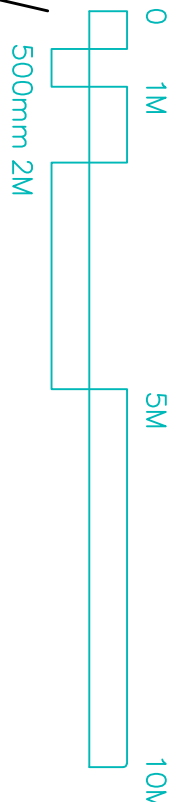
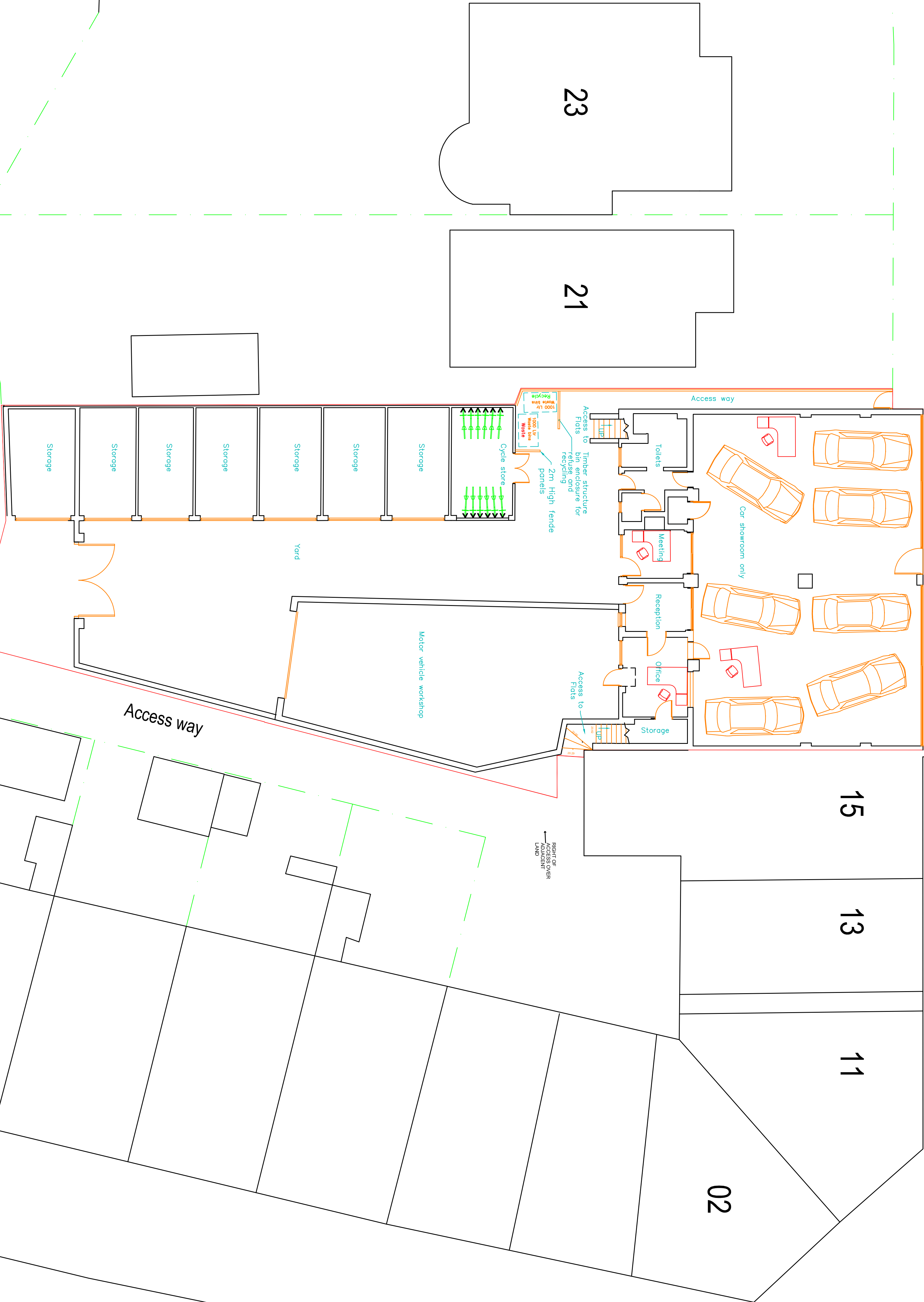

JOB
**17-19 Long Lane
Ickenham. UB10 8QU.**

TITLE
**Proposed
Site Layout.**

DRG. No **3341-02** REV. **—**

SCALE **1:100** © Copyright 2024

DATE Jan 24
CHECKED P/DN
DATE Jan 24

TOWERS ASSOCIATES LTD
Harefield Oil Terminal, Harvil Rd.
Harefield, MIDD. UB9 6JL.
TEL. **01895 812 822**
email info@towers-associates.com
WEB. www.towers-associates.com