

RENDERING:

It is proposed that we will use monocouche render and in chalk colour. (SEE RENDERING)



Standard - Chalk

ROOF TILES:

It is proposed that we will use Marley Hawkins clay plain tile in Dark Heather colour. So that it matches all of our neighbours roof tiles. (SEE ROOF 1 & ROOF 2)



CANOPY:

It is proposed that the canopy shall be hand-made by our carpenter, to the design like below. It will be a thick timber and painted in brown colour, along with the roof tiles as

above. The roof of the canopy will be joining the main roof. (SEE CANOPY 1 & CANOPY 2)

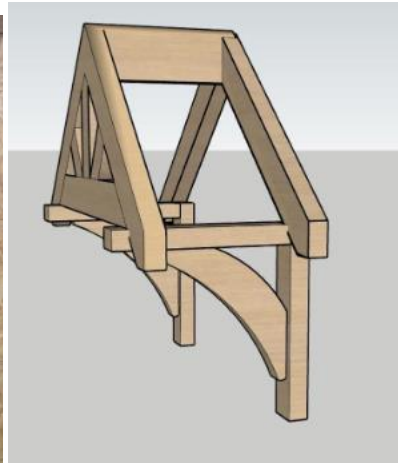

LONG WINDOWS:

It is proposed that we will buy a white double glazed, uPVC non-opening, long windows for the dining area, as per the drawing. Windows are from Sparwindows and will be plain, look like attached. [Sidelight 1 light - Home improvements saving energy with SparWindows.](#) (SEE LONG WINDOW)



WINDOWS:

PLEASE NOTE - we are hoping that all the windows in the front of the house will be flush fitting cruciform windows, and then all the side and the back windows to be in flush

fitting plain windows also in white colours. Side and back of the house is not visible to surrounding neighbours.