



Landscaping Key

Proposed New Trees

Liquidambar styraciflua

Hedge

Holly and Privet 1m high

General Amenity Planting

J Trichodispermum Jasminoides

B Buxus Balls

L Lavandula Angustifolia

Preparation Specification

1. All planting areas to be cleared of all grass, weeds, debris and stones/ concrete, etc., exceeding 50mm in diameter.
2. Soil in all planting areas that has been compacted/denatured/contaminated during the work in site shall be excavated to a minimum depth of 500mm, removed from site and completely replaced with quality topsoil to BS3883 specification.
3. Cultivation of all planting areas beneath the canopies of existing trees is to be undertaken by hand, taking care to avoid damage to tree roots.
4. All planting areas will be cultivated to a minimum depth of 500 mm.
5. No peat based products will be used.
6. The contractor shall maintain the works for a period of 36 months after practical completion, and return to site after the end of the 2nd and 3rd growing season to remove stakes, make good ties and rabbit protection, and replace any dead or diseased plants.

The contractor shall be responsible for the upkeep of any completed work during the progress of the works up to practical completion, and during the following 12 month defects liability period. The completed works may be offered for handover provided that all work and maintenance operations have been adequately completed. Should the works be unacceptable, the contractor shall remedy any deficiencies and continue maintenance operations at his own expense until remedial work has been satisfactorily completed.

7. Replacements: Any trees, shrubs, herbaceous plants and climbers which die or are removed or become seriously damaged or diseased, or which fail to thrive for whatever reason, shall be replaced by the contractor. This will not apply if the defects are caused by malicious damage to or theft from the works beyond the control of the contractor after practical completion.
8. Accidental Damage: Any damage to hard or soft works caused during establishment and aftercare operations, shall be made good at the contractor's own expense.
9. Litter: The site shall be kept litter free.
10. Aftercare of planting areas: Aftercare is to include watering, pruning and application of approved chemicals to combat insect attack and disease, application of approved herbicides to maintain a totally weed free condition, including woody and grass species, and removing all rubbish.

The contractor shall allow for a maximum of 4 herbicide applications and 4 hand weeding operations. Herbicide sprays shall not be used without a fitted guard to protect plants, nor when weather conditions could cause spray to drift. Any damage caused by herbicides shall be made good at the contractor's expense.

The following weeding operations shall be carried out (and as necessary to fulfil the maintenance specification):

- a. Apply residual herbicide in October December, and February March.
- b. Apply translocated herbicide in April May, and July August.
- c. Cultivate by hoe as required (4 visits per season) to control weeds.

The contractor shall make good with topsoil any pockets, gullies or indentation caused by rain, over-watering, etc. The contractor shall re-firm plants affected by frost, wind or water, etc., ensuring that plants are not loose or leaning, and bring soil back to its original levels.

Legend

- Existing lawn retained / new lawn laid depending on site conditions post construction
- Site boundary
- Existing house to be demolished
- Resin bound gravel
- Permeable block paving

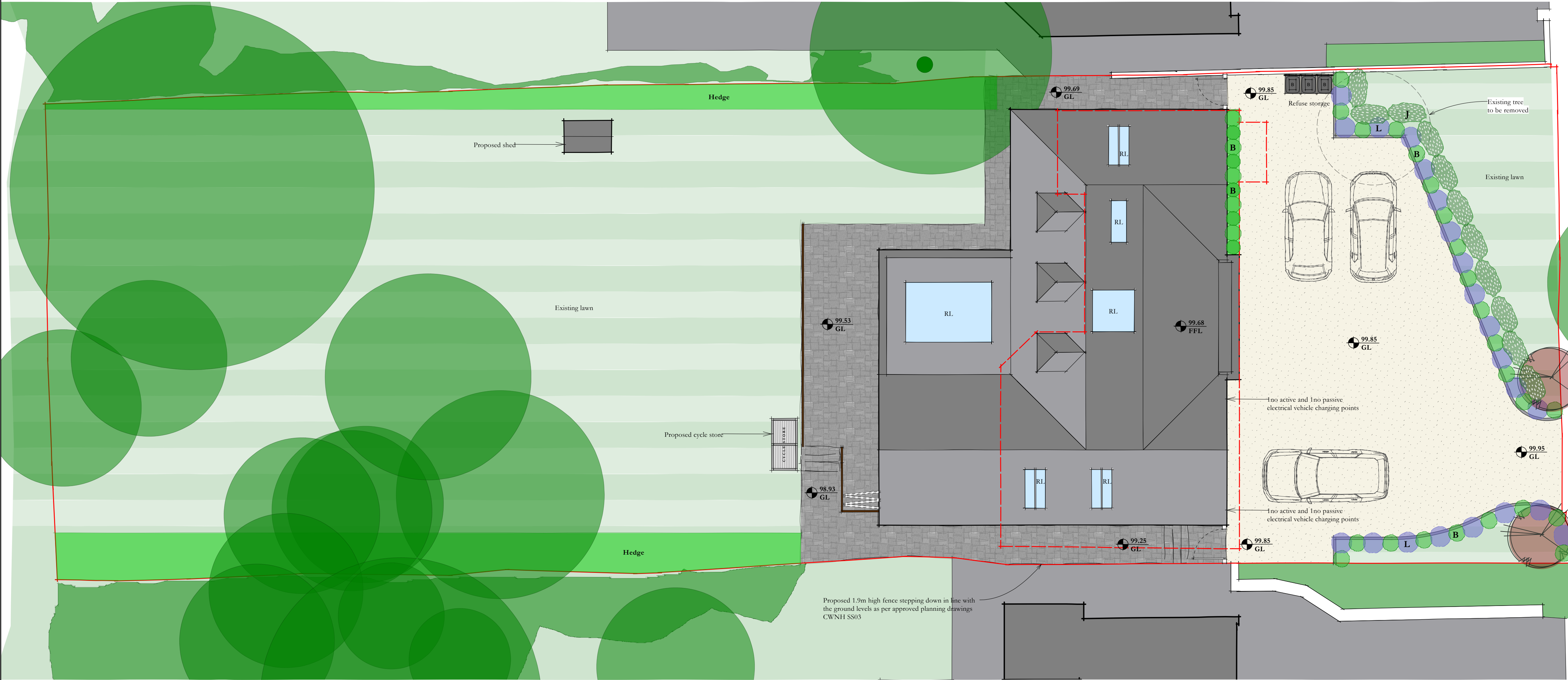

COPSE WOOD WAY

Rev	Date	Notes
<div>Beau Ideal Architects</div>		
vm@beauidealarchitects.co.uk +44 (0)790 869 0818 www.beauidealarchitects.co.uk		
client: Nishil & Shreya Tanna		
project address: 84 Copse Wood Way Northwood HA6 2UB		
scale: as stated	drawn: VM	status: PLANNING
drawing name: Landscaping & Hardstanding Plan		date: 01/05/2023
drawing no: CWNH SP04		rev: