

Site Plan - Existing  
1 : 500



80, Hatch Lane, West Drayton, Hillingdon, UB7 0BA



Location Plan shows area bounded by: 505799.65, 177352.03, 505941.07, 177493.45 (at a scale of 1:1250), OSGridRef: TQ 5877742. The representation of a road, track or path is no evidence of a right of way. The representation of features as lines is no evidence of a property boundary.

Produced on 16th Sep 2024 from the Ordnance Survey National Geographic Database and incorporating surveyed revision available at this date. Reproduction in whole or part is prohibited without the prior permission of Ordnance Survey. © Crown copyright 2024. Supplied by www.buyaplan.co.uk a licensed Ordnance Survey partner (100053143). Unique plan reference: #00926970-04E37C.

Ordnance Survey and the OS Symbol are registered trademarks of Ordnance Survey, the national mapping agency of Great Britain. Buy A Plan® logo, pdf design and the www.buyaplan.co.uk website are Copyright © Passinc Ltd 2024.

Location Plan  
1 : 1250



Re-Draw.  
ARCHITECTURAL DESIGN & PLANS

Project  
80 Hatch Ln, Harmondsworth, West Drayton, UB7 0BA

Title  
Proposed Drop Kerb

CLIENT  
Mr Jhony Singh

Date  
13-11-2024

Drawn by  
HS

Checked by  
MS

DRWAING NUMBER  
A205HS-V4-1

Scale as indicated on plans

Scale (@ A3)  
As indicated  
Rev 4



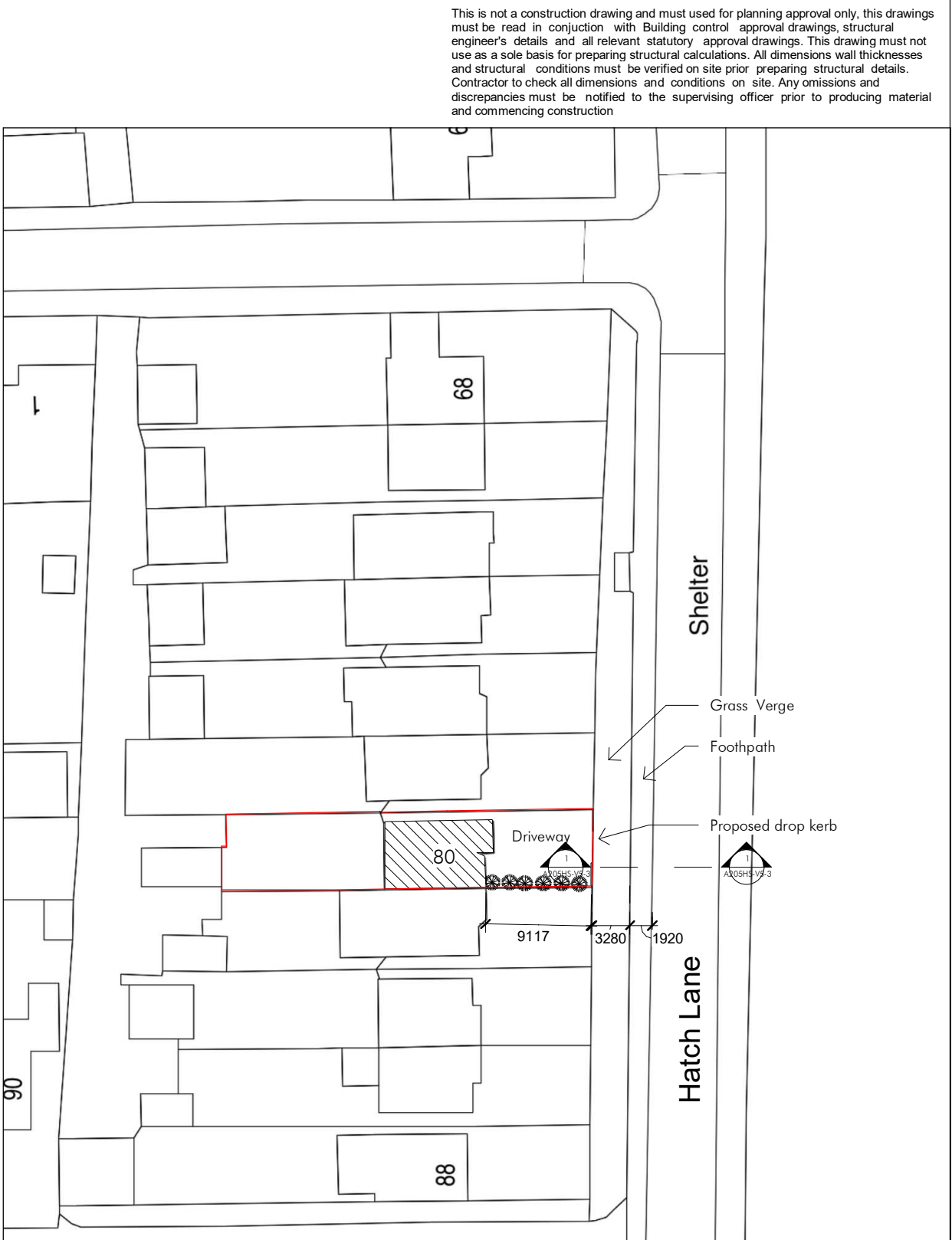
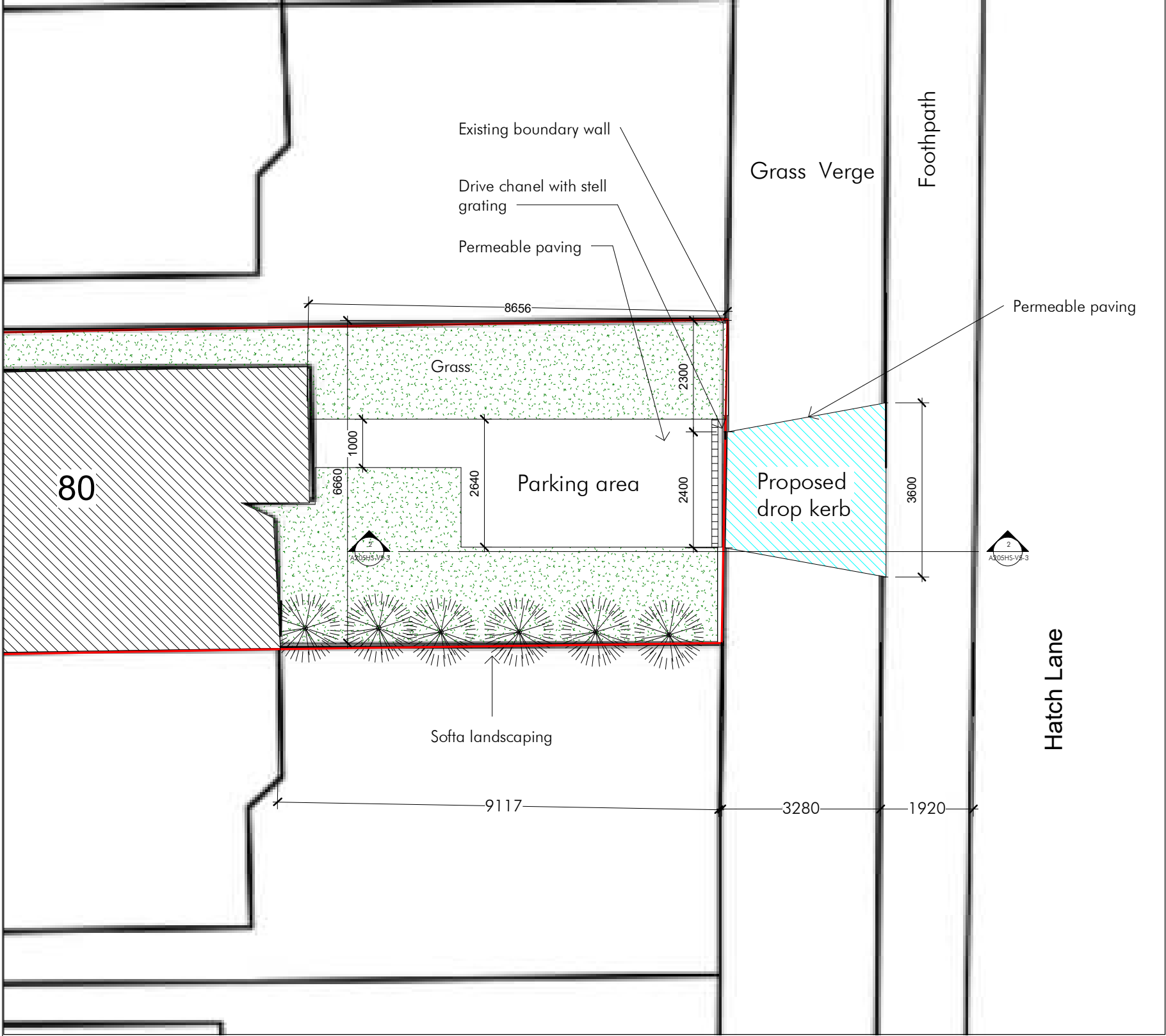

This is not a construction drawing and must used for planning approval only, this drawings must be read in conjunction with Building control approval drawings, structural engineer's details and all relevant statutory approval drawings. This drawing must not use as a sole basis for preparing structural calculations. All dimensions wall thicknesses and structural conditions must be verified on site prior preparing structural details. Contractor to check all dimensions and conditions on site. Any omissions and discrepancies must be notified to the supervising officer prior to producing material and commencing construction

Plan - Proposed

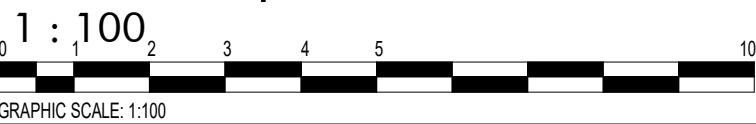

Site Plan - Proposed

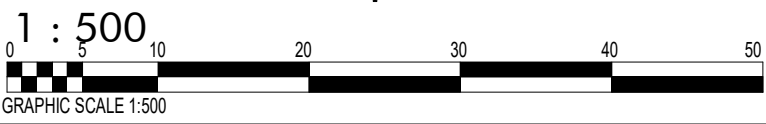

**Re-Draw.**  
ARCHITECTURAL DESIGN & PLANS

Project  
80 Hatch Ln, Harmondsworth, West Drayton, UB7 0BA

Title  
Proposed Drop Kerb

CLIENT

Mr Jhony Singh

Scale (@ A3)

As indicated

Rev

5



Date

13-11-2024

Drawn by

HS

Checked by

MS

DRWAING NUMBER

A205HS-V5-2

Scale as indicated on plans

This is not a construction drawing and must used for planning approval only, this drawings must be read in conjunction with Building control approval drawings, structural engineer's details and all relevant statutory approval drawings. This drawing must not use as a sole basis for preparing structural calculations. All dimensions wall thicknesses and structural conditions must be verified on site prior preparing structural details. Contractor to check all dimensions and conditions on site. Any omissions and discrepancies must be notified to the supervising officer prior to producing material and commencing construction

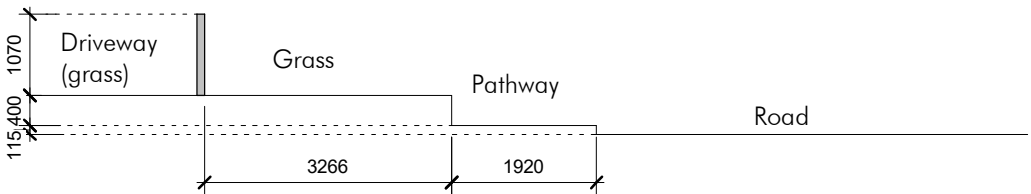

Section - Existing  
1 : 100

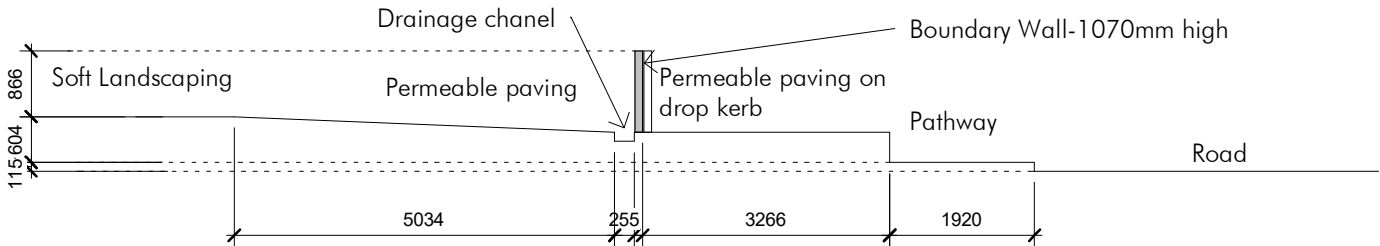

Section - Proposed  
1 : 100



Re-Draw.  
ARCHITECTURAL DESIGN & PLANS

Project  
80 Hatch Ln, Harmondsworth, West Drayton, UB7 0BA

Title  
Proposed Drop Kerb

CLIENT  
Mr Jhony Singh

Date  
13-11-2024

Drawn by  
HS

Checked by  
MS

DRWAING NUMBER  
A205HS-V5-3

Scale (@ A3)  
1 : 100

Rev  
5

