

Note:
This application is similar to Approved
application Ref:5457/APP/2022/1026.
Building form and location is exactly similar.

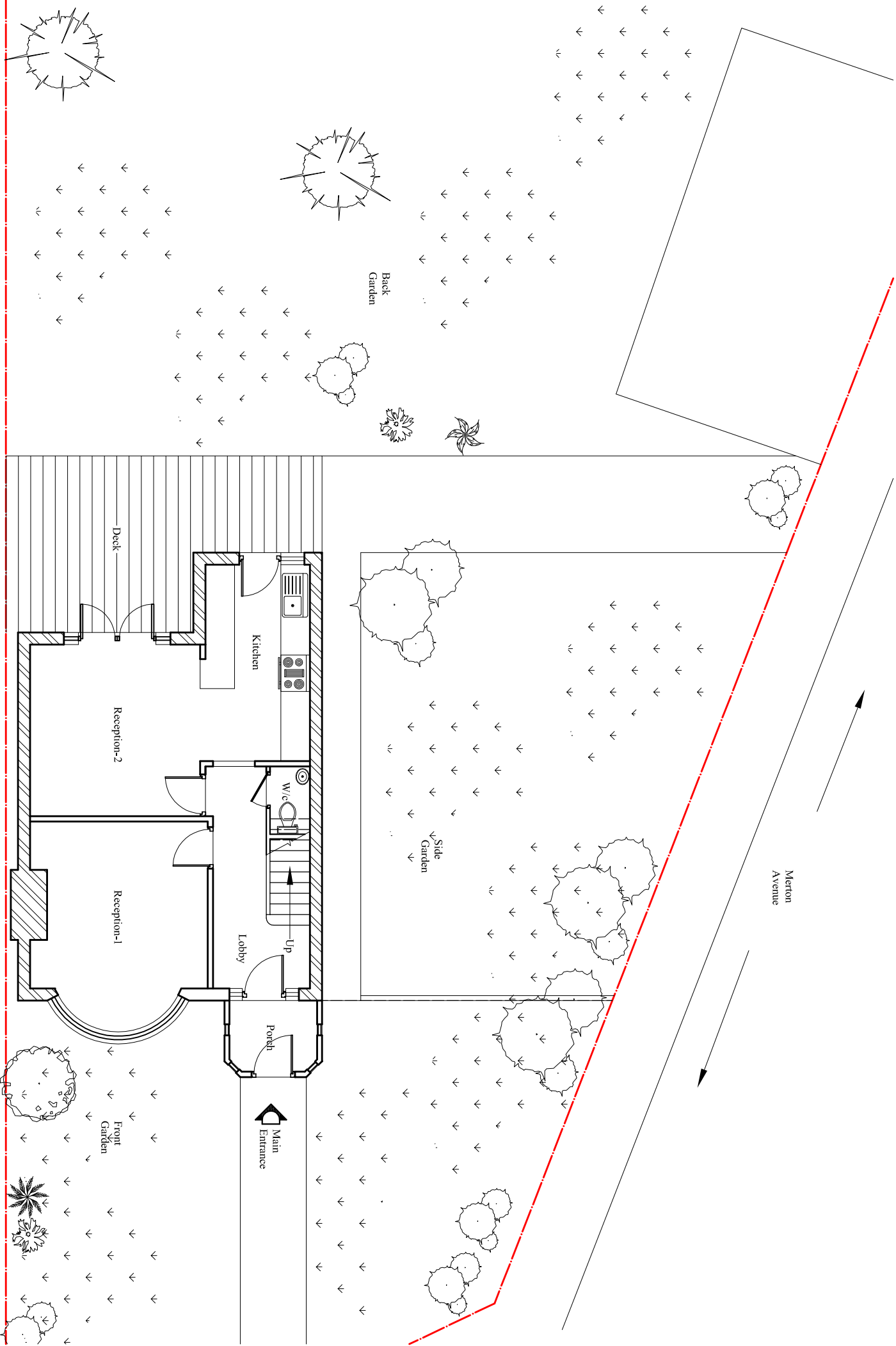

Existing Ground floor Plan
Scale:1:100

**BLUE ARCHITECTURE LIMITED**
Consulting Architects, Engineers and Interiors.
102 Dorchester Way, Hayes, Middlesex,
UB4 0HY, London.

Contact:
Email: info@bluearchdesign.co.uk,
Cell: 044 + 078 3293 8374
Web site: www.bluearchdesign.co.uk

Notes:
© 2024 Blue Architecture Limited.
All rights reserved.
All drawings are for the purpose of gaining
Planning Permission approval only.
All written dimensions to be taken in
preferences to scaled dimensions.

Rev.	Description	By	Ckd	Date

Client:
Mr. Nishant Dhungana.

Project:
Part Single part Double Storey Side /Rear
Wraparound Extension, incorporating a rear
dormer with roof windows.

Location:
50 Windsor Avenue,
Hillingdon, UB10 9AX.

Status:
PLANNING

Title:
Existing Ground floor plan.

Drawn by:	Str. Fr.	Checked by:
L.p	---	R.k
Project no:	Sheet Size	Sheet no.
BAL-50	A3	
Date:	Scale:	
16/03/2024	1:100	