

Location Plan 1:1250

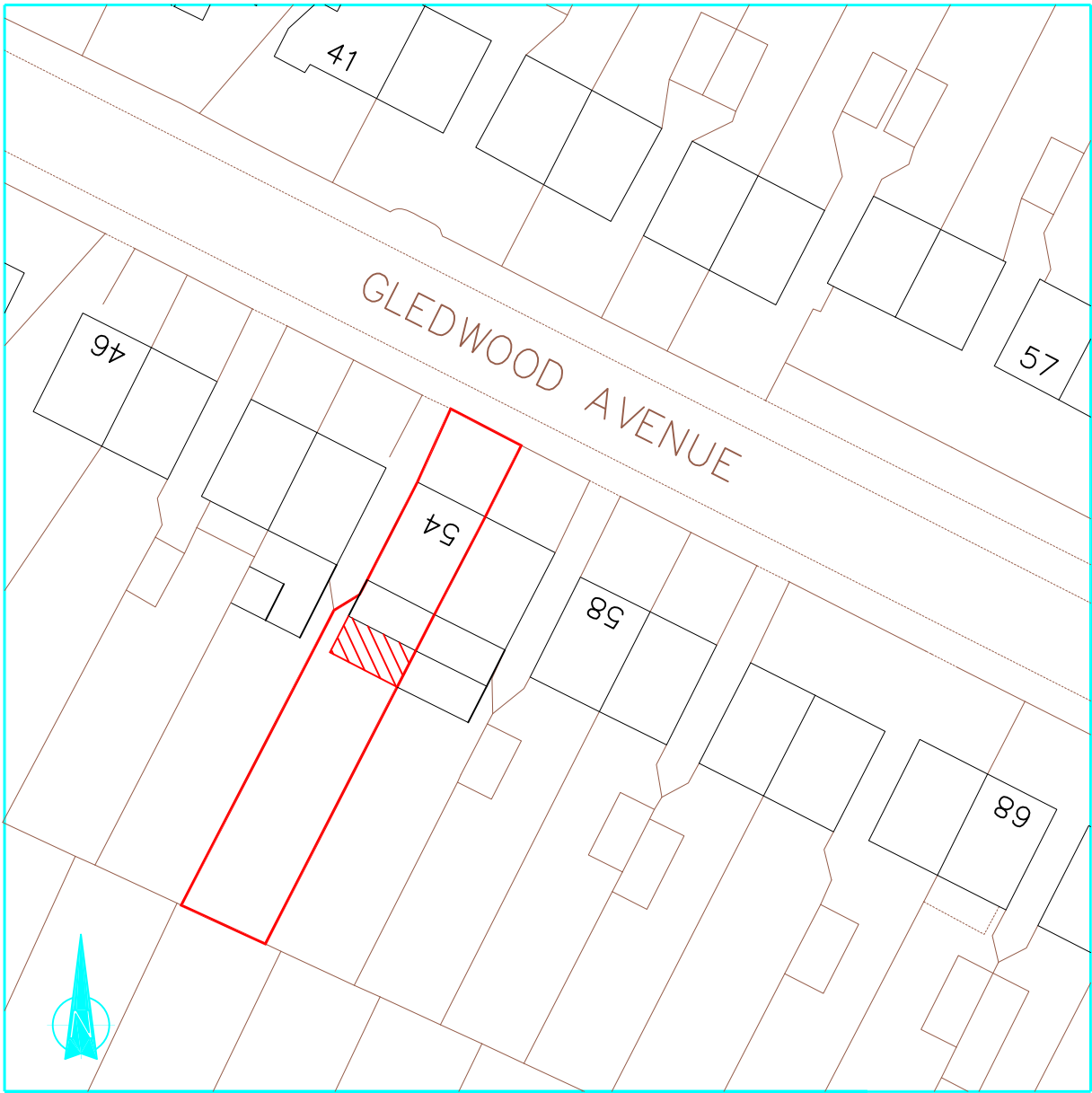

Block Plan 1:500

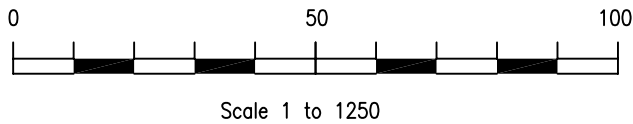
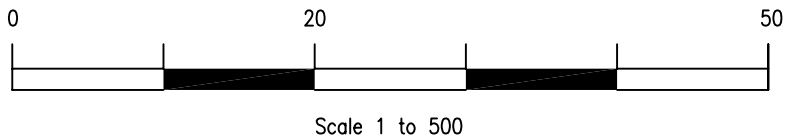

rev:			
These drawings should be approved by local Authority			
No dimensions to be scaled from this drawing. All dimensions to be checked on site. This drawing is copyright and should not be reproduced without permission of the Architects.			
client:	Dalbir Sandhu		
project:	54 Gledwood Avenue Hayes UB4 0AW		
drawing:	Location & Block Plans		
scale:	As Shown	date:	Jul 2025
drawn:		rev:	
01 / 06			