

NOTES

1. All dimensions are to be checked on site prior to the commencement of work and any discrepancy is to be reported to the construction manager before construction.
2. All work is to comply with current Building Regulations and allied legislation.
3. All contractors and sub-contractors must ensure that they have the latest issue of this drawing and details before the commencement of work on site.
4. All materials are to be used and installed in strict compliance with the relevant manufacturers instructions and recommendations.
5. All works on site, managed and implemented as a result of the designs indicated on this drawing, are to be given full consideration for compliance with the Health and Safety CDM Regulations in respect of design and implementation on site and no works are to be undertaken if it is considered that compliance with the Building Regulations cannot be achieved.
6. All dimensions shown in millimetres.
7. Footprint of buildings shown at 1.0m above ground level.

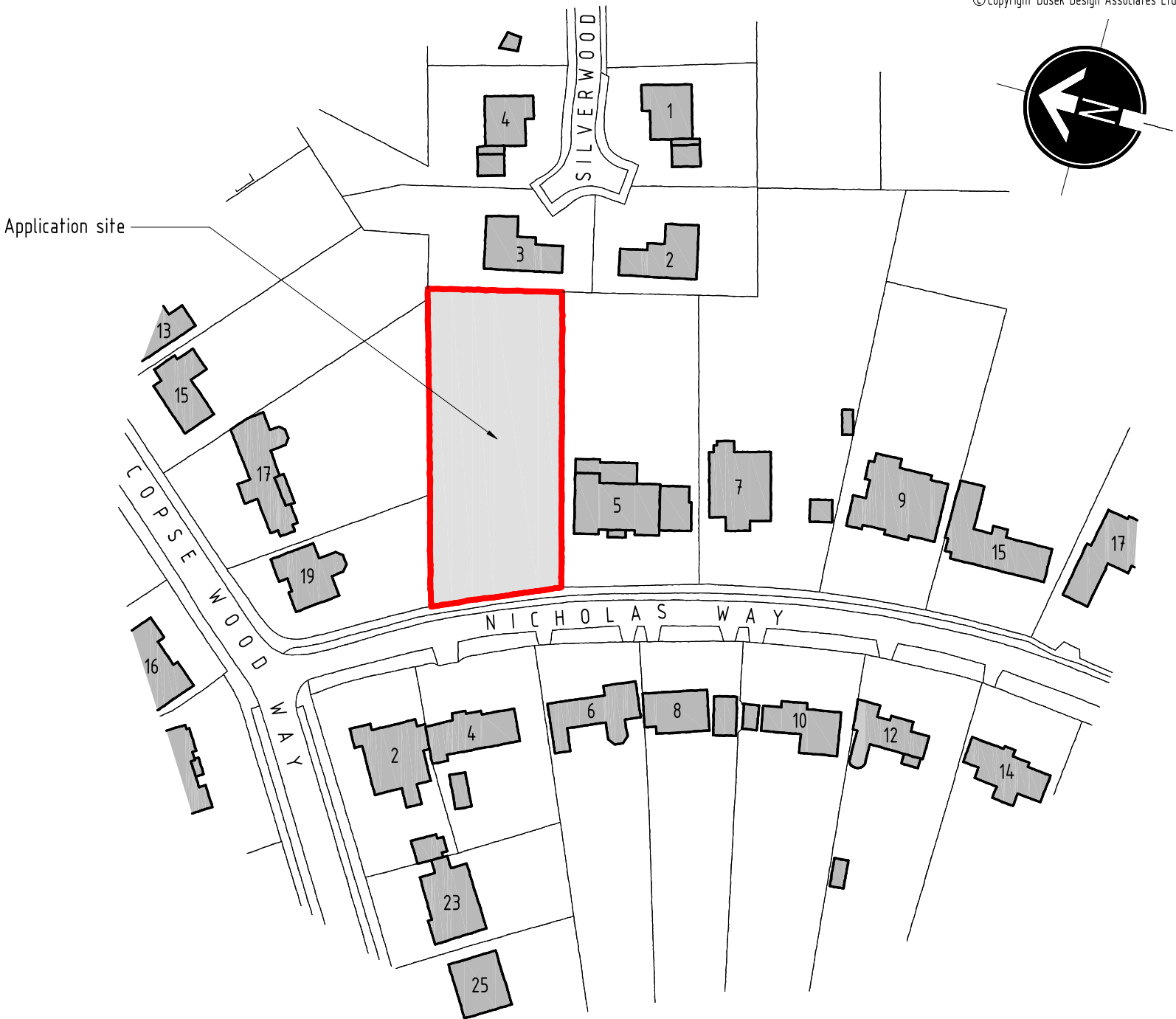
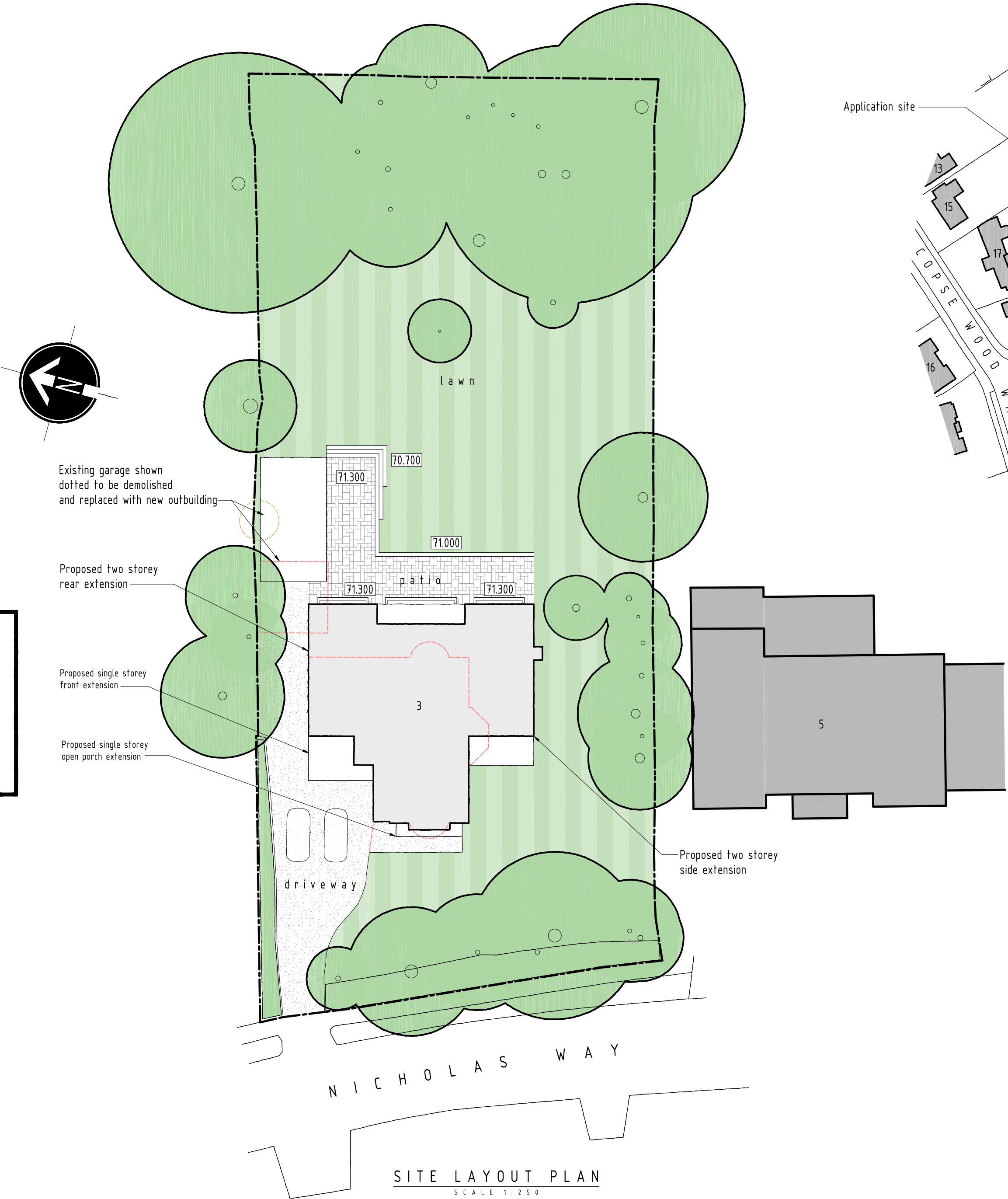

LEGEND

Proposed two storey

Proposed single storey

Extent of existing structures
to be demolished

SCALE BAR (m)

0 5 10 15 20 25

SITE LAYOUT PLAN

SCALE 1:250

SCALE BAR (m)

0 25 50 75 100 125

LOCATION PLAN

SCALE 1:1250

A 19/03/2024 Council comments added

rev:	date:	description:	
scale:	1:250	A2	date: 30 / 08 / 2023
drawing no:	1441 / P / 1A	drawn:	FJ

drawing: PLANNING PROPOSALS
SITE LAYOUT PLAN & LOCATION PLAN

project: LAND AT 3 NICHOLAS WAY,
NORTHWOOD, MIDDLESEX, HA6 2TR

client: MR & MRS DAVDA



DUSEK DESIGN ASSOCIATES LTD
ARCHITECTURE + PLANNING

01895 831 103
info@dusek.co.uk
www.dusek.co.uk

print history: Wednesday, 20 March, 2024 09:39:31

C:\Users\frank\ODA\Team - Documents\DUSEK\DWG 1401-1450\1441 3 NICHOLAS WAY, NORTHWOOD\1441-P-4.dwg