

EXISTING SIDE ELEVATION A-A
Scale 1:100

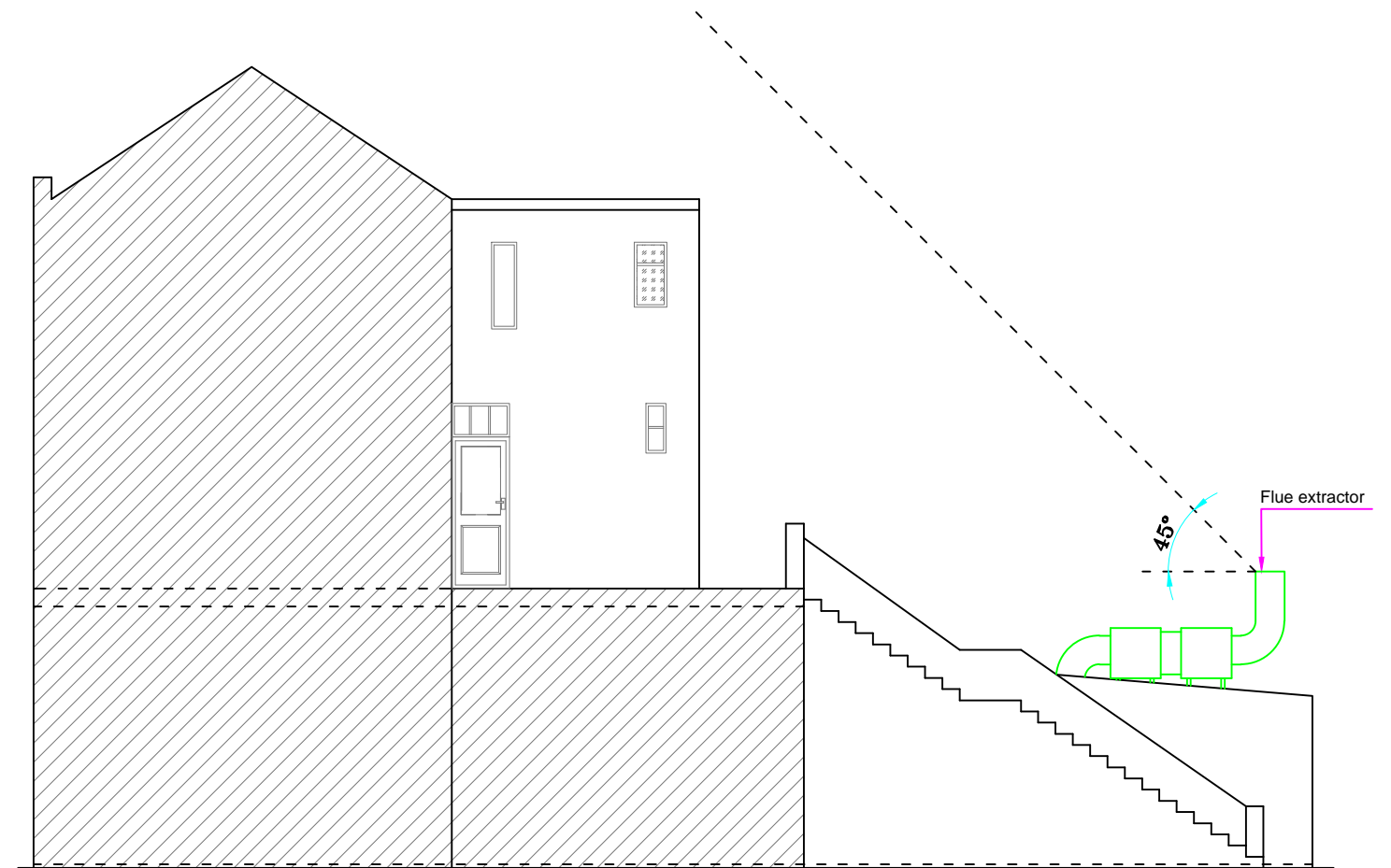

PROPOSED SIDE ELEVATION A-A
Scale 1:100

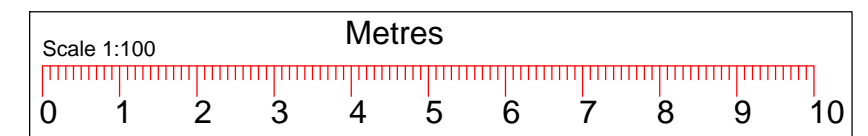

TITLE: CHANGE OF USE FROM A1 TO A5.

CLIENT NAME :
SITE ADDRESS : 288 WEST END ROAD,
RUISLIP,
HA4 6LS.

MKM DESIGN & CONSTRUCTION LTD

Contact: M.Mathu (BSc,MSc Civil Engineering)
Tel : 07515365953
Email : mathu_eng@yahoo.co.uk
Web : mkmdesigns.co.uk

IMPORTANT NOTE:

1.This drawing is copyright of MKM DESIGN AND CONSTRUCTION LTD . This can be used for any purposes, if it is issued/submitted by us only.
2.Contractor/Builder to check all dimensions on site before commencement of any works, any discrepancies to be notified to us in writing.
3.All works shall comply with the latest Building Regulations & be to the satisfaction of the Local Authority.
4.Materials shall be suitable for the purpose for which they are used & the quality shall not be lower than that defined in the relevant British standards.
5.The structural beam sizes shown on this drawing shall be installed once the beam sizes and structural calculations are approved by the Local Authority. Any changes to beam length and bearing plate/ bearing pier sizes to be confirmed with our engineer.

Dwg No:MKM/21/WES288/PL02 | Page :02/03 | Drwn By :M.MATHU | Date :24/05/2021 | Scale : Shown@A3