

The existing windows on the ground floor on both properties face a 2m high Fence the proposed 1st floor extension has no impact

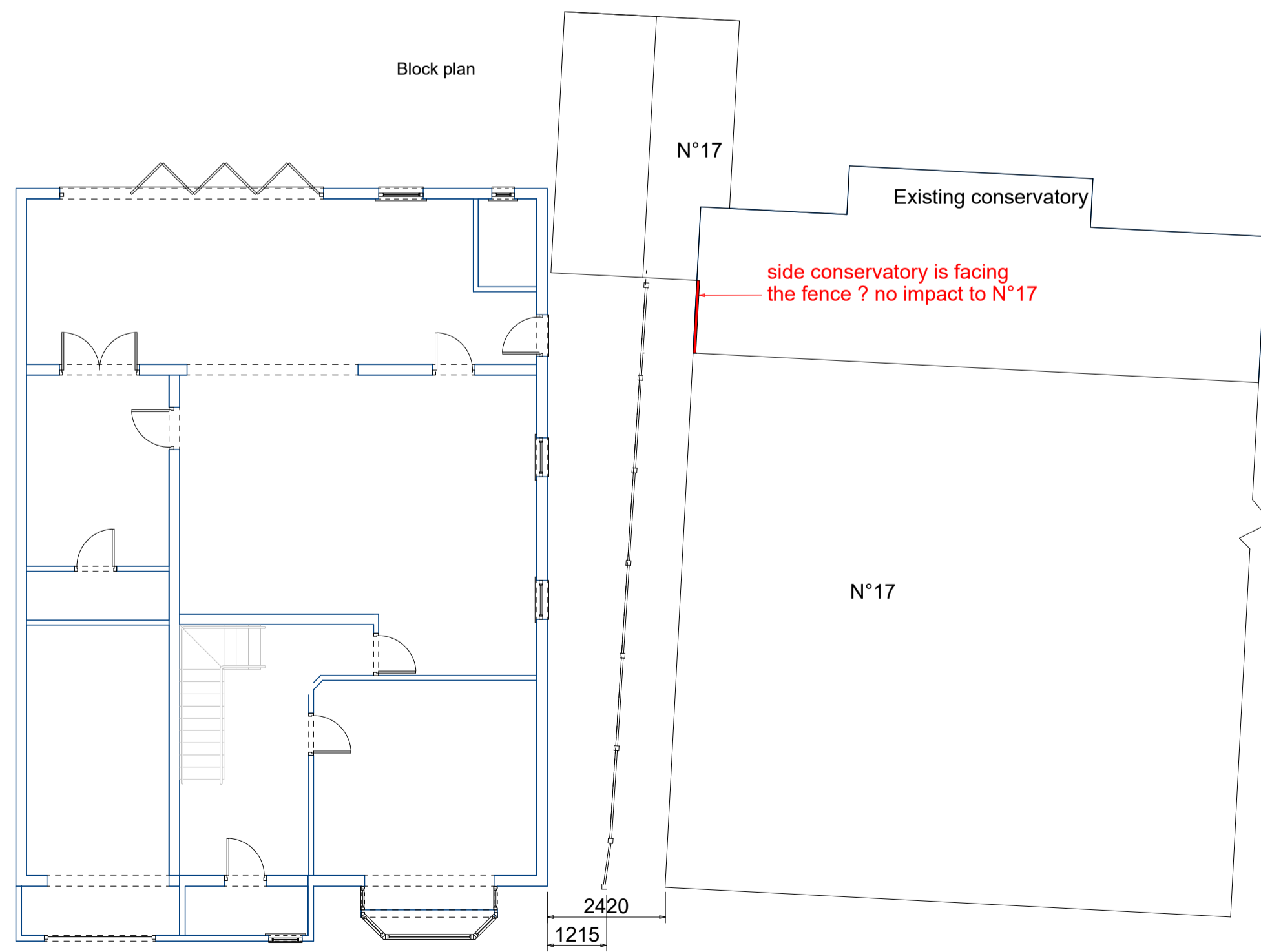

Window position

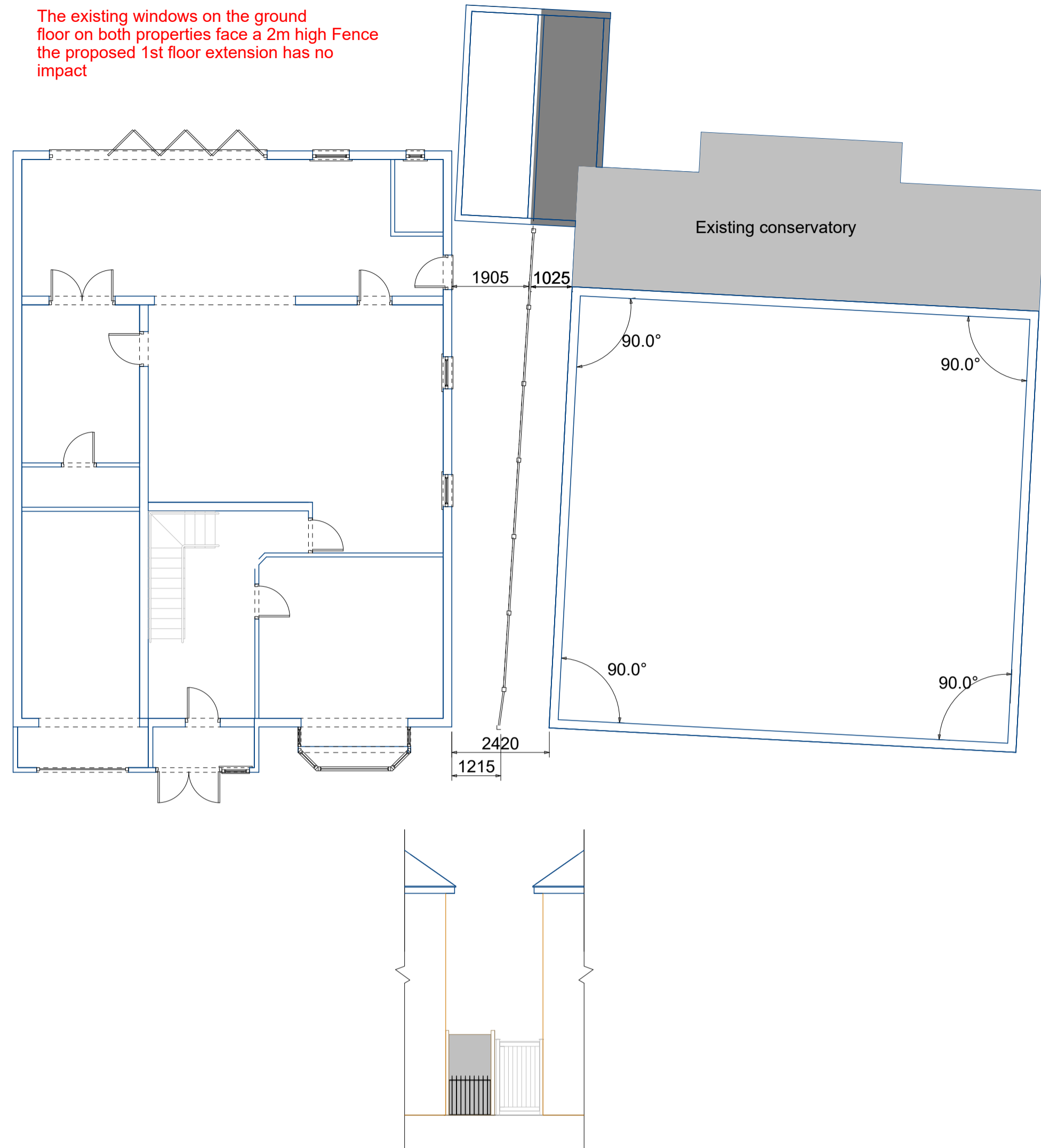
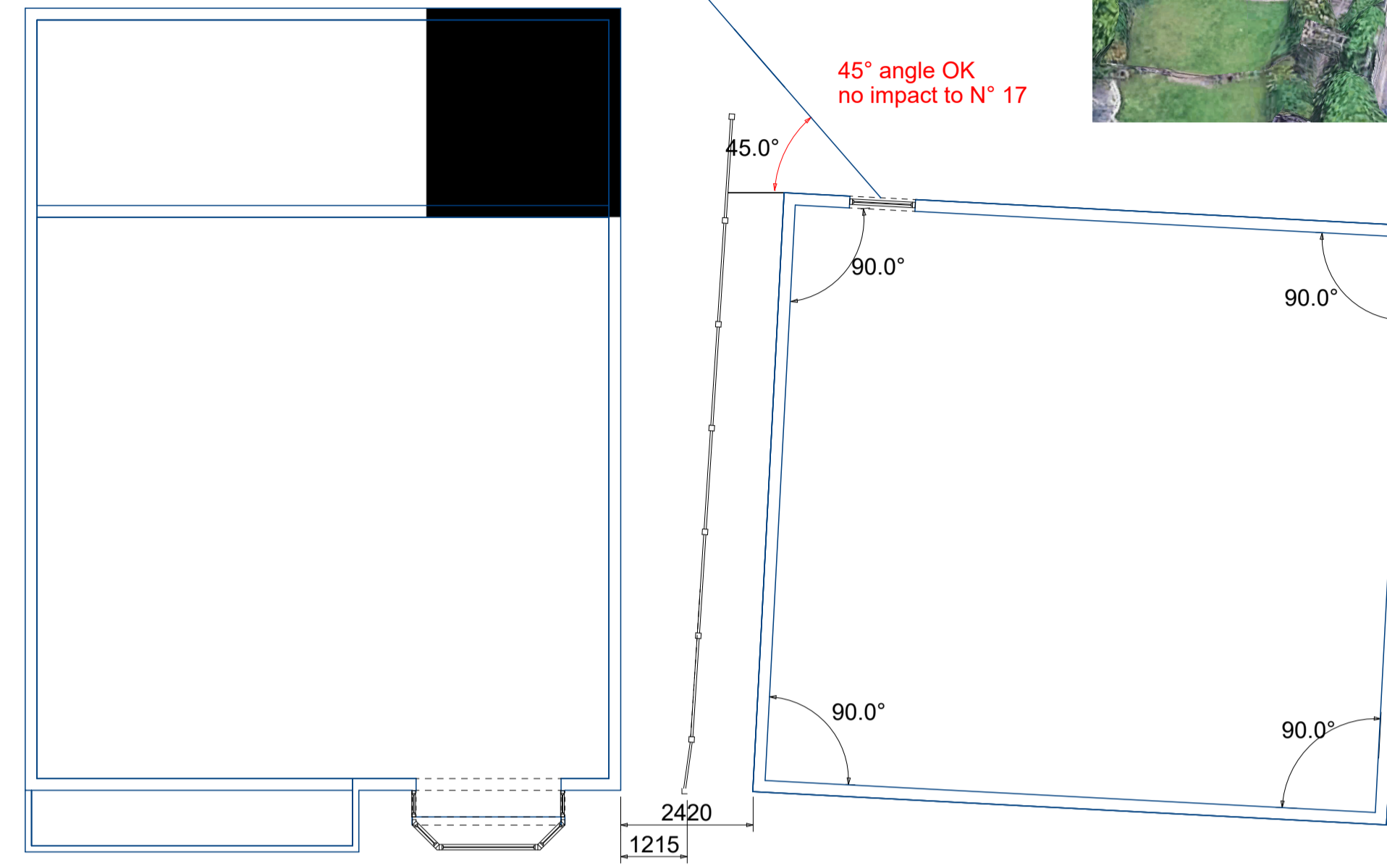

45° angle OK
no impact to N° 17



Notes

Plans Express

Architectural Planning Services

Project 1st Floor part rear extension

15 Kewferry Road
London
HA8 2NS

Drawing Title
Planning

Proposed
Client

Mr A Strachan

Drawing No.

003

Date
March 2026

Drawn by
D Black

Scale
1:100

Checked by
D Black

5000 mm

Page Size - A1

Plans Express
Tel: 02031314207
Mob: 07986229016
E: plansexpress@yahoo.com