

© This drawing is the property of Oxbridge Design and Detailing Services Ltd. Copyright is reserved by them and is issued on the condition that it is not copied or disclosed by or to any unauthorised persons without the prior consent in writing.
All dimensions to be checked on site any discrepancies must be reported to Oxbridge Design and Detailing Services Ltd. prior to undertaking of any relevant works.
Written dimensions to be follow in preference to scaled dimensions and all figured dimensions are millimetres unless otherwise stated.

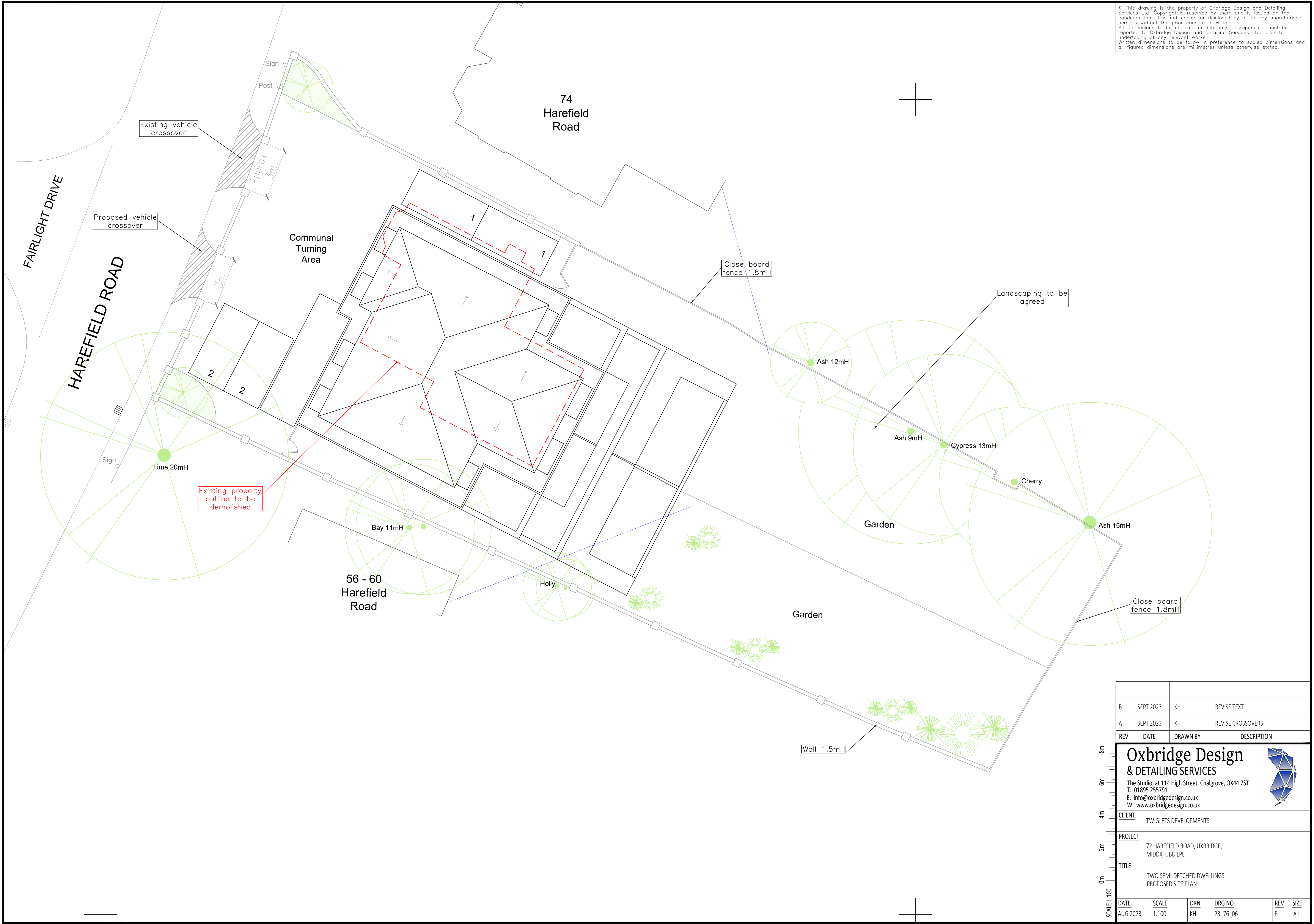

B	SEPT 2023	KH	REVISE TEXT
A	SEPT 2023	KH	REVISE CROSSOVERS
REV	DATE	DRAWN BY	DESCRIPTION
<div><div>Oxbridge Design & DETAILING SERVICES</div><div>The Studio, at 114 High Street, Chalgrove, OX44 7ST T. 01895 255791 E. info@oxbridgedesign.co.uk W. www.oxbridgedesign.co.uk</div><div></div></div>			
CLIENT TWIGLETS DEVELOPMENTS			
PROJECT 72 HAREFIELD ROAD, UXBRIDGE, MIDDLESEX, UB8 1PL			
TITLE TWO SEMI-DETACHED DWELLINGS PROPOSED SITE PLAN			
DATE AUG 2023	SCALE 1:100	DRN KH	DRG NO 23_76_06
REV B	SIZE A1		