

[Home](#) > [Stock](#) > Sawston Buff Brick

SAWSTON BUFF BRICK

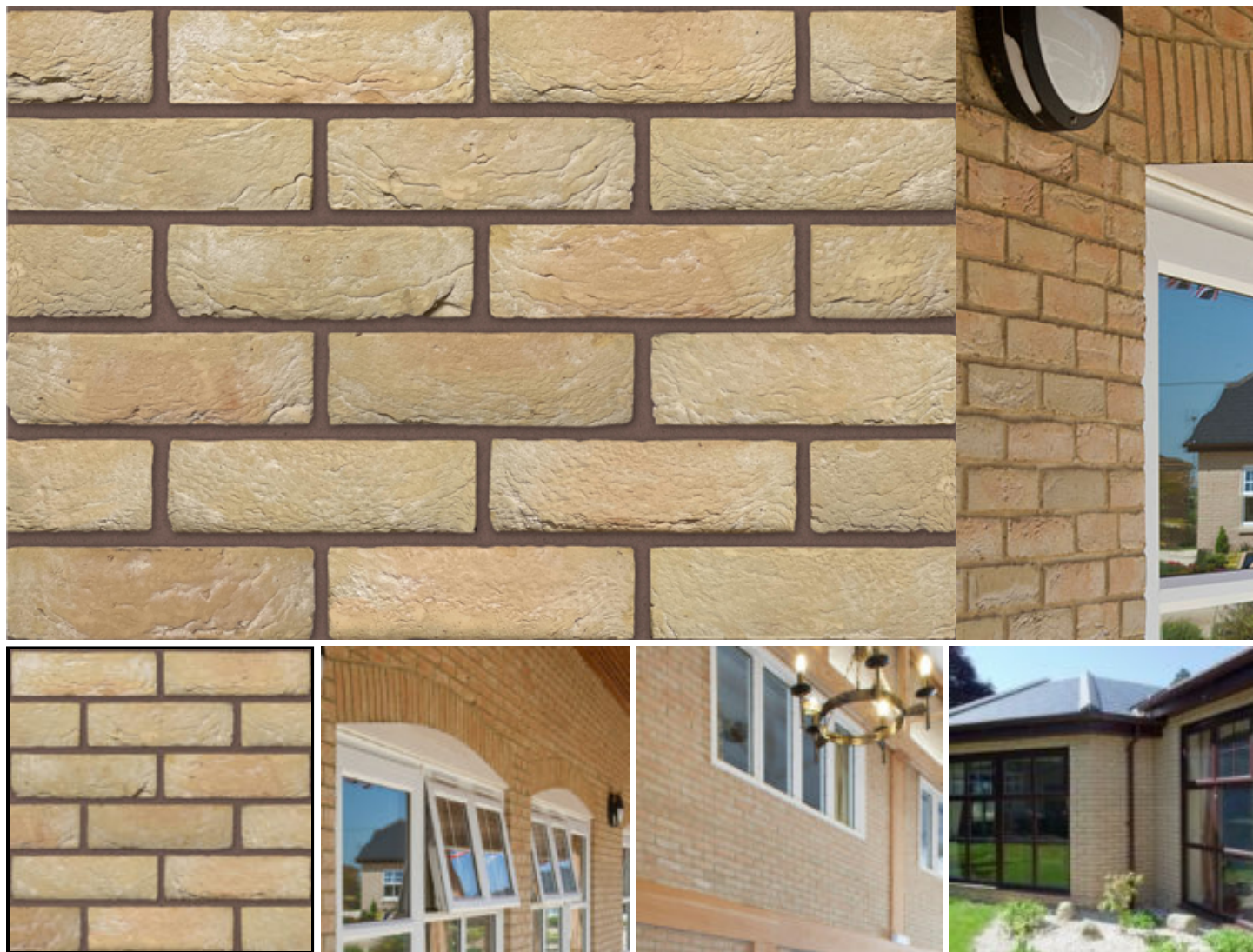

Manufacturer Details

Exclusive Range ET Clay Products are able to supply its own range of exclusive bricks which come in a wide range of colours and styles. As well as our base in Essex, we also have a large depot in the Midlands meaning that we can easily service all areas of the country.

Product Type: Stock

Colour: Buff / Yellow

[Privacy](#) - [Terms](#)

Declaration of performance

DoP number: 12802212-B1W1280

Product name:

SAWSTON BUFF

(1) Identification code of product-type is DoP-number

(2) Reference number: 12802212-B1W1280

(4)



Wienerberger

Wienerberger NV

8500 Kortrijk Kapel ter Bede

(3) Intended use(s) in masonry walls, columns and partitions for:

unprotected masonry

(6) Assessment and verification of constancy of performance:

System 2+

(7) Notified Body:

0749

Performed:

(i) initial inspection of the manufacturing plant and of factory production control

(ii) continuous surveillance, assessment and evaluation of factory production control and issued certificate number 0749-CPD-BC2-201

(9) Declared performance:

Type of unit: HD -masonry unit

Dimensions and tolerances

			Tm	Rm
Length:	mm	215	± 6	9
Width:	mm	102	± 4	6
Height:	mm	65	± 3	5
Tolerance:	category	T1		
Range:	category	R1		
Flatness of bed faces:	mm	NPD		
Plane parallelism:	mm	NPD		

Configuration

Group of the unit:	-	1
Volume of all formed voids:	%	NPD
Volume of frogs:	%	< 20

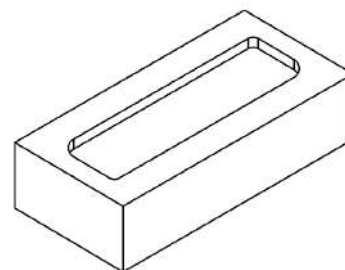

actual configuration may vary slightly

Density

Gross dry density:	kg/m³	1450
Net dry density:	kg/m³	1550
Tolerance:	category / %	D1 / 10

Compressive strength

Category:	-	I
Perpendicular to bedface:	N/mm²	12
Perpendicular to header:	N/mm²	NPD
Perpendicular to header 2:	N/mm²	NPD

Bond strength:	N/mm²	NPD
----------------	-------	-----

Thermal conductivity λ_{10} , dry, unit:	W/(m·K)	0.69	Determination method EN 1745:2012: S1
--	---------	------	---------------------------------------

Water vapour permeability:	-	$\mu = 5/10$	Tabulated min. and max. value according EN 17
----------------------------	---	--------------	---

Durability:	category	F2
-------------	----------	----

Water absorption:	%	19	EN 772-21
-------------------	---	----	-----------

Initial rate of water absorption:	kg/(m²·min)	0.01-4.1	EN 772-11
-----------------------------------	-------------	----------	-----------

Active soluble salt content:	category	S2	EN 772-5
------------------------------	----------	----	----------

Moisture movement:	mm/m	NPD
--------------------	------	-----

Reaction to fire:	class	A1	EN 13501-1
-------------------	-------	----	------------

Dangerous substances:	-	NPD
-----------------------	---	-----

(10) The performance of the product is in accordance with the specification above.

Signed on behalf of the manufacturer:

CEO

2013-07-01

Johan Van Der Biest

Wienerberger NV
8500 Kortrijk Kapel ter Bede

EN 771-1:2011

Supplementary national information:

DoP number: 12802212-B1W1280

Product name:

SAWSTON BUFF

(1) Identification code of product-type is DoP-number

(2) Reference number: 12802212-B1W1280

(4)



Wienerberger NV
8500 Kortrijk Kapel ter Bede

[Home](#) > [Stock](#) > Fitzjohn Multi Brick

FITZJOHN MULTI BRICK



Manufacturer Details

Exclusive Range ET Clay Products are able to supply its own range of exclusive bricks which come in a wide range of colours and styles. As well as our base in Essex, we also have a large depot in the Midlands meaning that we can easily service all areas of the country.

Product Type: Stock

Colour: Grey

[Privacy](#) - [Terms](#)

DECLARATION OF PERFORMANCE

DoP number: 1703020-B1W1235
Product name:
FITZJOHN MULTI
(65MM HERITAGE YORK RUSSET)
Identification code of product-type is DoP-number



Wienerberger NV
Kapel ter Bede - 8500 Kortrijk

Intended use in masonry walls, columns and partitions for:
Assessment and verification of constancy of performance:
Harmonised standard:
Notified body/ies:

unprotected masonry
System 2+
EN 771-1:2011+A1:2015
0749

Declared performance/s of a U - masonry unit

Dimensions and tolerances			Tm	Rm
Length:	mm	208	± 15	30
Width:	mm	98	± 15	30
Height:	mm	65	± 15	30
Tolerance:	category	Tm		
Range:	category	Rm		
Flatness of bed faces:	mm	NPD		
Plane parallelism:	mm	NPD		
Configuration				
Group of the unit:	-	1		
Volume of all formed voids:	%	NPD		
Volume of frogs:	%	NPD		
Density				
Gross dry density:	kg/m ³	1700		
Net dry density:	kg/m ³	1800		
Tolerance:	category / %	D1 / 10		
Compressive strength for Category I product				
Perpendicular to bedface:	N/mm ²	20		
Perpendicular to header:	N/mm ²	NPD		
Perpendicular to header 2:	N/mm ²	NPD		
Bond strength:	N/mm ²	NPD		
Thermal conductivity λ_{10} , dry, unit:	W/(m·K)	0.69		
Water vapour permeability:	-	$\mu = 5/10$		
Durability:	category	F2		
Water absorption:	%	9		
Initial rate of water absorption:	kg/(m ² ·min)	0.3-2		
Active soluble salt content:	category	S2		
Moisture movement:	mm/m	NPD		
Reaction to fire:	class	A1		
Dangerous substances:	-	NPD		

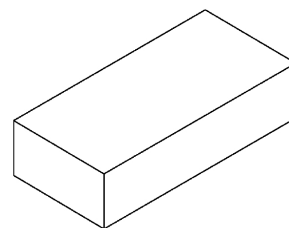

actual configuration may vary slightly

The performance of the product identified above is in conformity with the set of declared performance/s. This declaration of performance is issued, in accordance with Regulation (EU) No 305/2011, under the sole responsibility of the manufacturer identified above.

Signed for and on behalf of the manufacturer by:

2013-06-27

CEO

Johan Van Der Biest

Wienerberger NV
Kapel ter Bede - 8500 Kortrijk