

1 EXISTING SITE PLAN

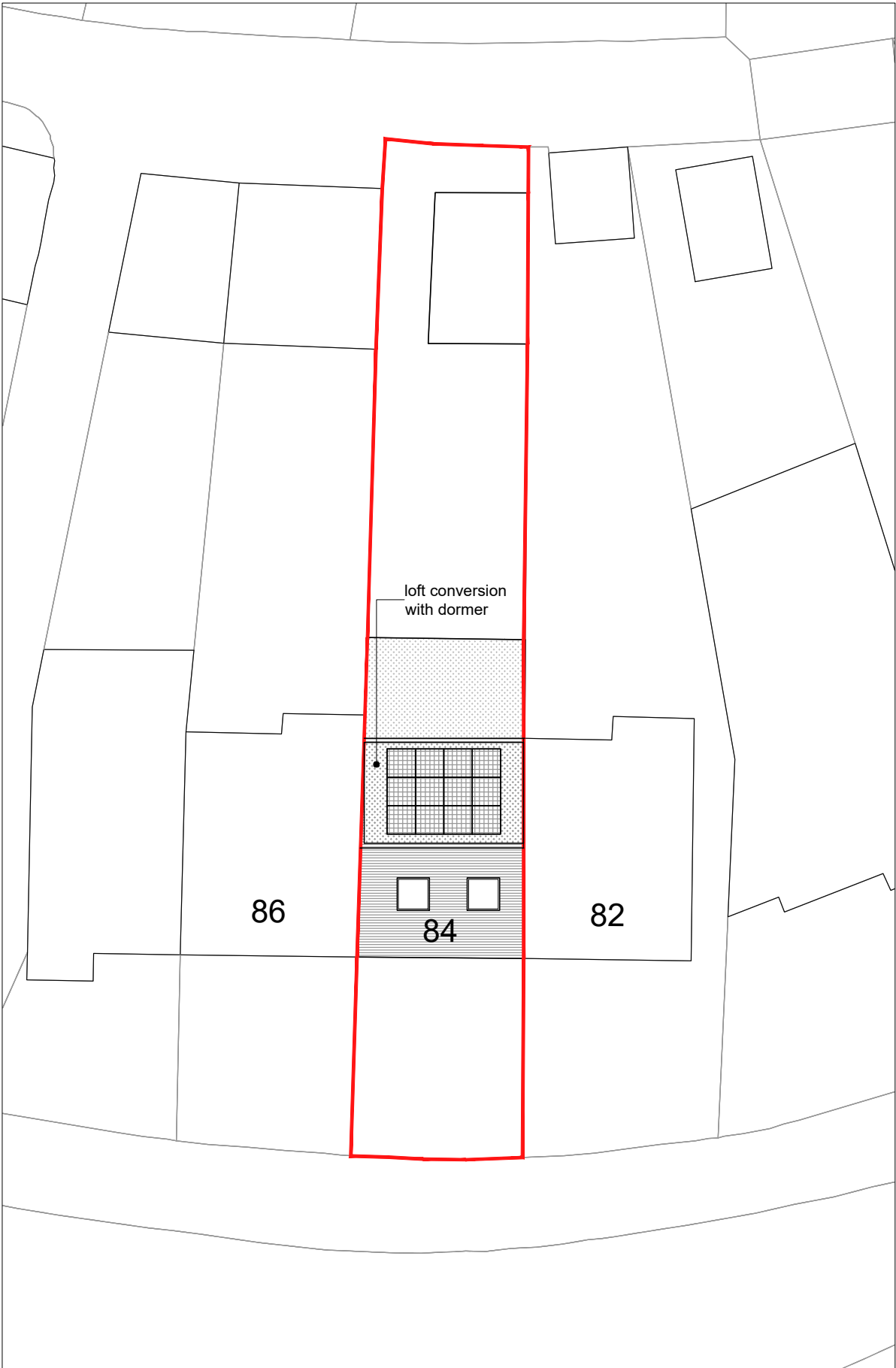

2 PROPOSED SITE PLAN

REVISION:

  
BANYAN TREE  
ARCHITECTS  
E: INFO@BANYANTREEARCHITECTS.COM  
T: 07980 765732

PROJECT:	84 WEST END ROAD, RUISLIP, HA4 6DS
DRAWING:	PN_002_EXISTING AND PROPOSED SITE PLAN
SCALE:	1:200@A3
DATE:	05/07/22
REVISION:	-
STATUS:	PLANNING



0m 2m 4m 6m 8m

All dimensions to be checked on site prior to construction.  
All drawings to be read in conjunction with structural engineer's drawings.