

Document to Discharge Planning Conditions 9 & 10

Northwood & Pinner
Health Centre

Logan Construction

January 2025



KEY	Site Boundary	Existing Wall To Be Retained	Pedestrian Gates To Architects & Engineers Details
Extent of Section 278 Works To be done by others	Brick Wall To Architects Details	Vehicle Gates To Architects & Engineers Details	Existing Tree To Be Retained Refer to Arboricultural Survey by Tamias Tree Consultants for AMS
Root Protection Area All works within RPA to be referred to Arboricultural Consultant and subject to AMS	Proposed Brick Wall Refer to Drg. No. SY752-400-0291	Existing Tree To Be Felled Refer to BS5837 Arboricultural Impact Assessment (March 2021) by Tamias Trees	Proposed Specimen Tree Refer to Drg. No. SY752-400-0081 & SY752-400-0271
Bitumen Macadam Surface With Coloured Wearing Course Refer to Drg. No. SY752-400-0201	King Post Temporary Retaining Wall System Refer to Drg. No. SY752-400-0293	Large Shrub Refer to Drg. No. SY752-400-0071	Proposed Hedge Refer to Drg. No. SY752-400-0071
Permeable Bitumen Macadam Surface With Coloured Wearing Course Refer to Drg. No. SY752-400-0201	Brick Pillar Refer to Drg. No. SY752-400-0290	Mixed Shrub And Herbaceous Planting Refer to Drg. No. SY752-400-0071	Proposed Tree Grill and Tree Guard Refer to Drg. No. SY752-400-0271
Sandstone Flags Refer to Drg. No. SY752-400-0202	Timber Fence Refer to Drg. No. SY752-400-0292	Proposed Tree Grill and Tree Guard Refer to Drg. No. SY752-400-0271	Electrical Vehicle Charger To Engineers Details
Sandstone Flags Refer to Drg. No. SY752-400-0202	Timber Bench Refer to Drg. No. SY752-400-0296		
Bitumen Macadam Surface With Standard Black-top Wearing Course Refer to Drg. No. SY752-400-0201	Timber Picnic Bench Refer to Drg. No. SY752-400-0296		
Concrete Kerb Refer to Drg. No. SY752-400-0206	Play Equipment Refer to Drg. No. SY752-400-0297		
Aluminium Edge Refer to Drg. No. SY752-400-0206	Visitor Cycle Stands Refer to Drg. No. SY752-400-0294		
Gravel Margin Refer to Drg. No. SY752-400-0206	Demountable Bollards Refer to Drg. No. SY752-400-0295		

1. All dimensions in millimetres unless otherwise shown.
2. All levels in metres above Ordinance Datum (mAD) unless otherwise shown.
3. All dimensions to be checked on site and any discrepancies reported to Employer before pricing / work starts.
4. Any ambiguities or discrepancies within this drawing and any other information given elsewhere must be reported to Camlins and the Employer for clarification before pricing work proceeds.
5. All drawings to be read in conjunction with other Camlins drawings and specification information as appropriate.
6. Refer to relevant Engineer's and Architect's information as appropriate for confirmation of all engineering and architectural details.
7. All works to be carried out in accordance with the latest British Standards and appropriate codes of practice as a minimum.

B 2024-09-17 Basement stairs changed. EVC added.
A 2024-09-03 Client changes to car park site boundary.
Rev. Date Description

AMB MSS
KS MCS
Revised by Checked by

New Zealand House, Abbey Foregate,
Shrewsbury, Shropshire, SY2 6FD
01743 298 779
www.camlins.com

Camlins

Northwood Cottage Hospital
Logan Construction

General Arrangement - Ground Floor Landscape Plan

Status
Stage 4

Drawn by
AMB

Checked by
MSS

Drawing Number
SY752-400-0001

Revision
B

Scale
1:200

Date
05.06.2024

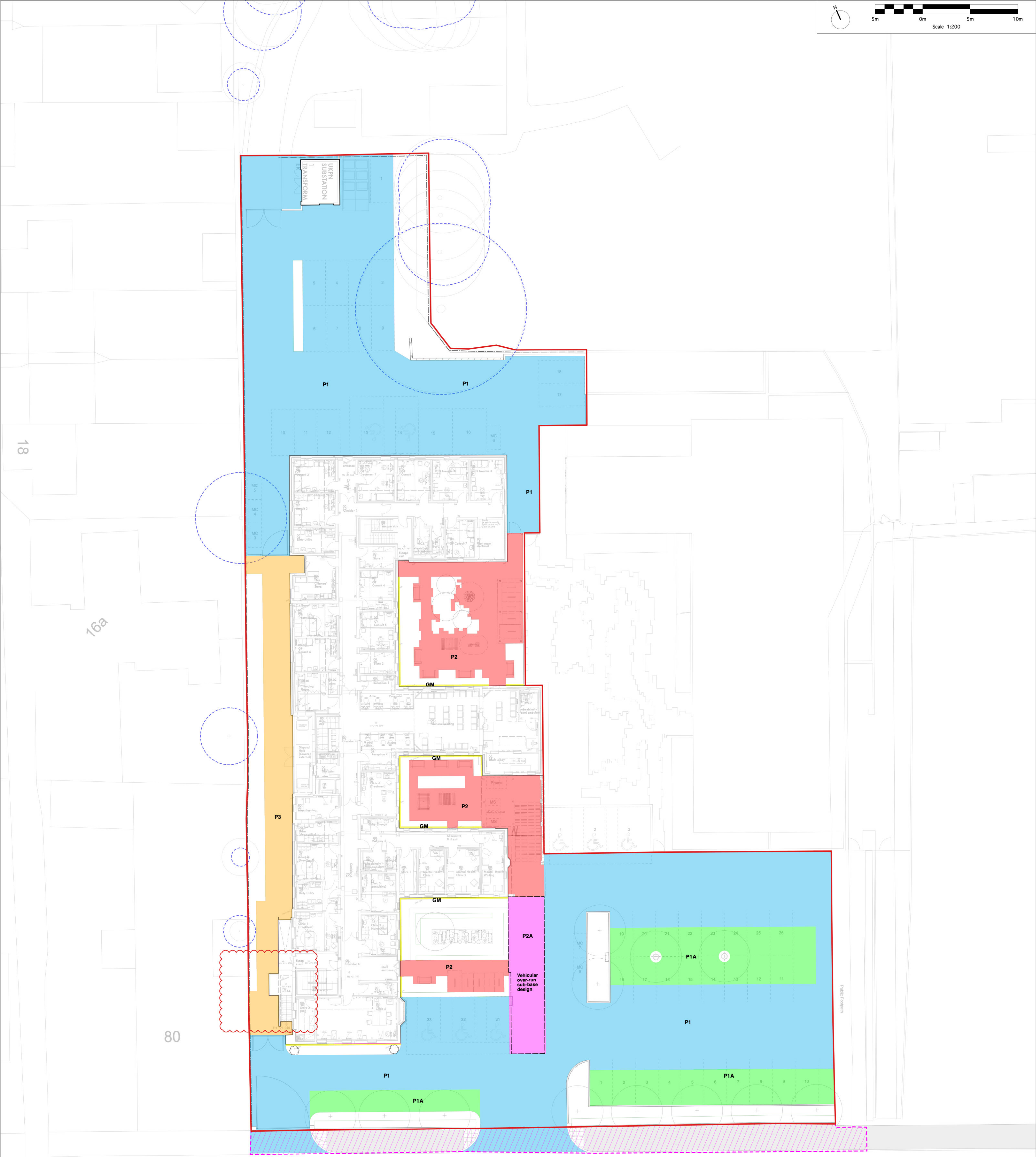

- KEY**
- Site Boundary
 - Extent of Section 278 Works
To be done by others
 - Root Protection Area
All works within RPA to be referred to Arboricultural Consultant
and subject to AMS

- Surfacing**
- P1** Bitumen Macadam Surface With Coloured Wearing Course
Refer to Drg. No. SY752-400-0201
 - P1A** Permeable Bitumen Macadam Surface With Coloured Wearing Course
Refer to Drg. No. SY752-400-0201
 - P2** Sandstone Flags
Refer to Drg. No. SY752-400-0202
 - P2A** Sandstone Flags
Refer to Drg. No. SY752-400-0202
 - P3** Bitumen Macadam Surface With Standard Black-top Wearing Course
Refer to Drg. No. SY752-400-0201
 - GM** Gravel Margin
Refer to Drg. No. SY752-400-0206

- All dimensions in millimetres unless otherwise shown.
- All levels in metres above Ordinance Datum (mAOD) unless otherwise shown.
- All dimensions to be checked on site and any discrepancies reported to Employer before pricing / work starts.
- Any ambiguities or discrepancies within this drawing and any other information given elsewhere must be reported to Camlins and the Employer for clarification before pricing work proceeds.
- All drawings to be read in conjunction with other Camlins drawings and specification information as appropriate.
- Refer to relevant Engineer's and Architect's information as appropriate for confirmation of all engineering and architectural details.
- All works to be carried out in accordance with the latest British Standards and appropriate codes of practice as a minimum.

C 2024-09-17 Basement stairs changed. AMB MSS
B 2024-09-04 Client changes to car park site boundary and extents of P1 reduced KS MSS
A 2024-07-16 No pavement finishes shown in 0276 works area. AMB MSS

Rev. Date Description Revised by Checked by

New Zealand House, Abbey Foregate,
Shrewsbury, Shropshire, SY2 6FD
01743 296 779
www.camlins.com

Northwood Cottage Hospital
Logan Construction

General Arrangement - Areas Of Hard Surfaces

Status
Stage 4

Drawn by
AMB

Checked by
MSS

Drawing Number
SY752-400-0031

Revision
C

Scale
1:200

Date
05.06.2024

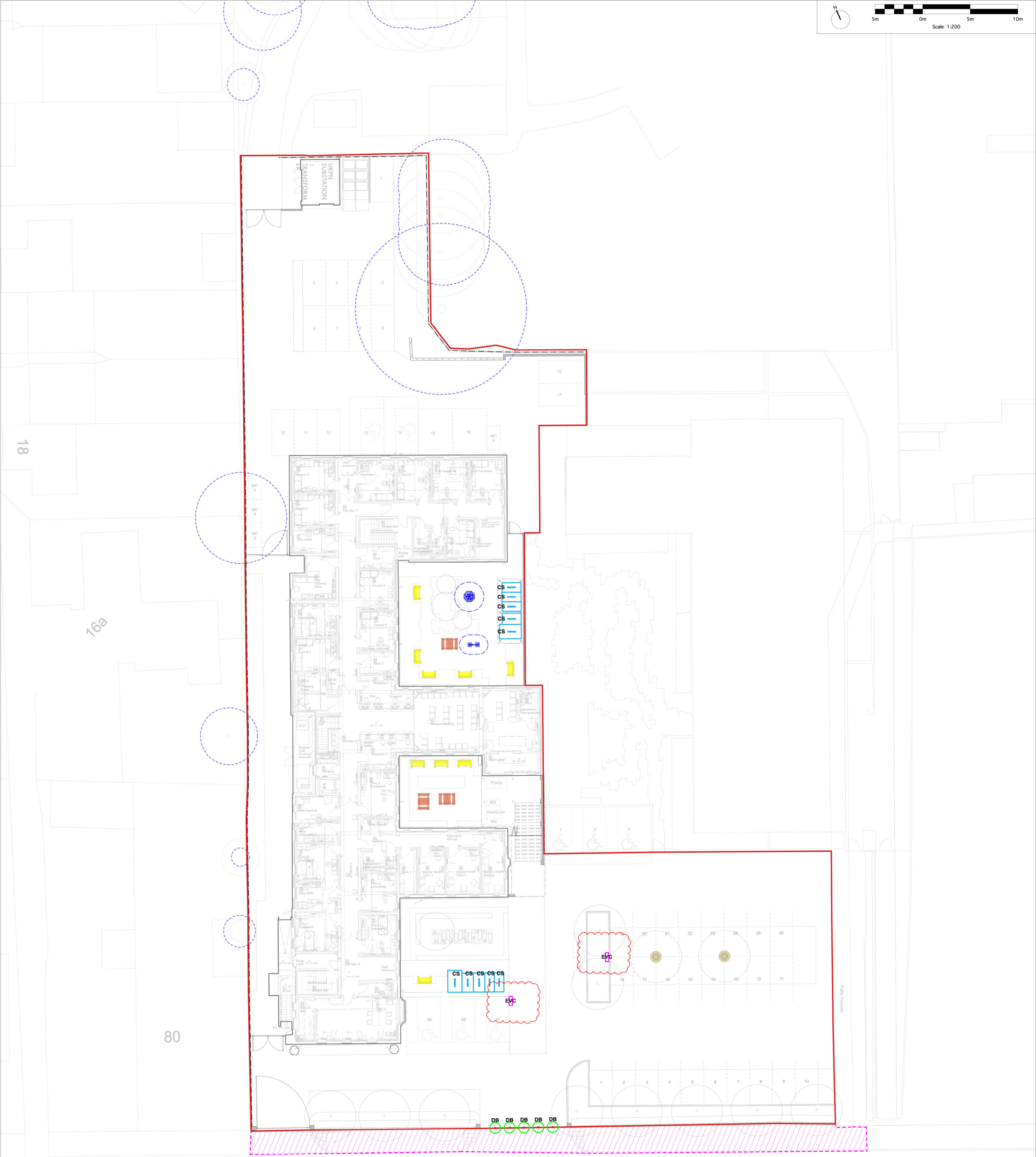

- KEY**
- Site Boundary
 - Extent of Section 278 Works
To be done by others
 - Root Protection Area
All works within RPA to be referred to Arboricultural Consultant
and subject to AMS

- Furniture & Fixtures**
- Timber Bench
Refer to Drg. No. SY752-400-0296
 - Timber Picnic Bench
Refer to Drg. No. SY752-400-0296
 - Visitor Cycle Stands
Refer to Drg. No. SY752-400-0294
 - Demountable Bollards
Refer to Drg. No. SY752-400-0295
 - Play Equipment
Refer to Drg. No. SY752-400-0297
 - Proposed Tree Grill and Tree Guard
Refer to Drg. No. SY752-400-0271

- Electrical Vehicle Charger
To Engineers Details

1. All dimensions in millimetres unless otherwise shown.
2. All levels in metres above Ordinance Datum (mAOD) unless otherwise shown.
3. All dimensions to be checked on site and any discrepancies reported to Employer before pricing / work starts.
4. Any ambiguities or discrepancies within this drawing and any other information given elsewhere must be reported to Camlins and the Employer for clarification before pricing work proceeds.
5. All drawings to be read in conjunction with other Camlins drawings and specification information as appropriate.
6. Refer to relevant Engineer's and Architect's information as appropriate for confirmation of all engineering and architectural details.
7. All works to be carried out in accordance with the latest British Standards and appropriate codes of practice as a minimum.

B	2024-09-17	EVC added.	AMB	MSS
A	2024-09-04	Client changes to car park site boundary and 1no. tree grill and tree guard omitted	KG	MSS
Rev.	Date	Description	Revised by	Checked by

Camlins
New Zealand House, Abbey Foregate,
Shrewsbury, Shropshire, SY2 6FD
01743 296 779
www.camlins.com

Northwood Cottage Hospital
Logan Construction

General Arrangement - Furniture & Fixtures

Status: Stage 4
Drawn by: AMB
Checked by: MSS

Drawing Number: SY752-400-0091
Revision: B
Scale: 1:200
Date: 05.06.2024

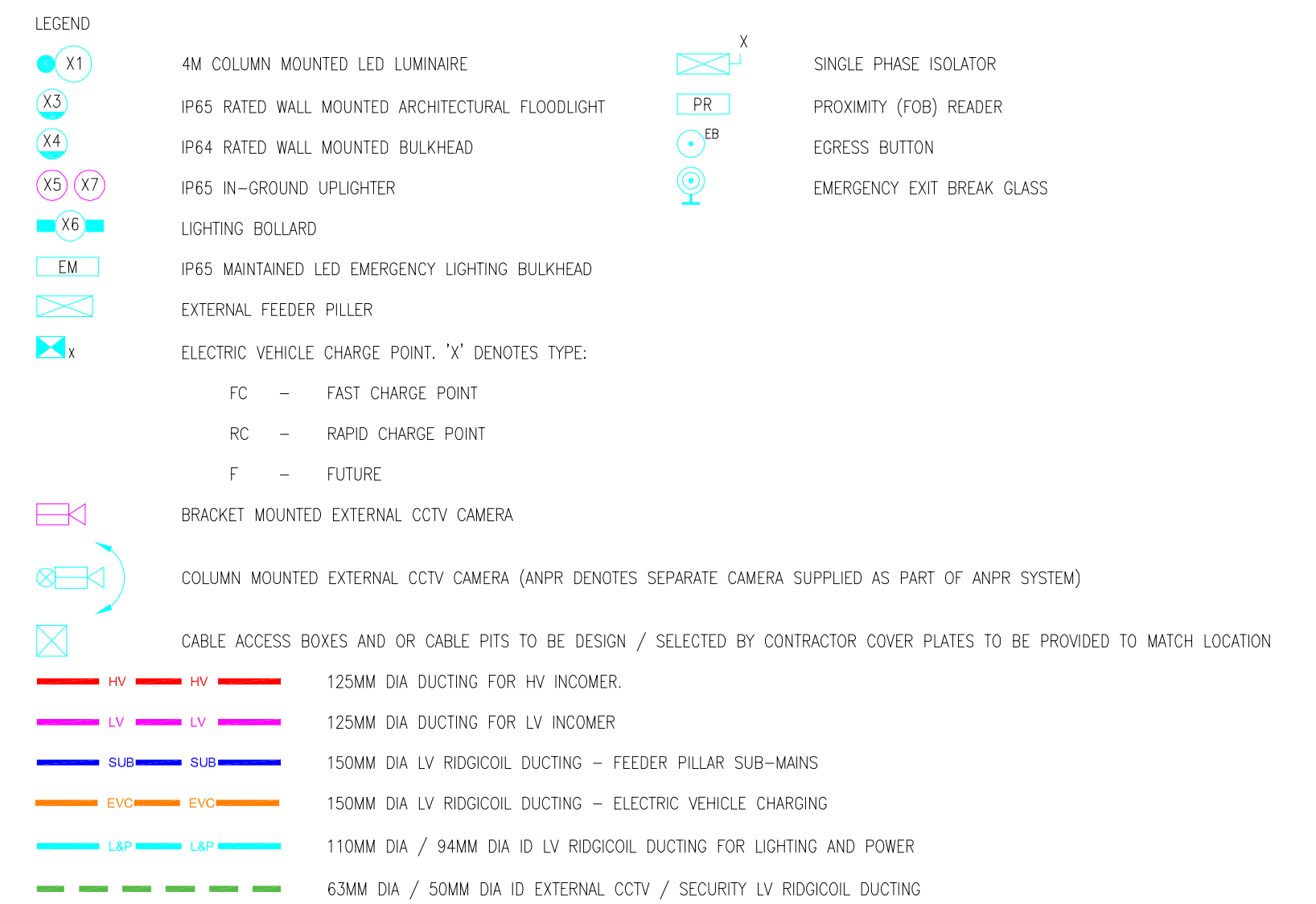

NOTES:

- CONTRACTOR SHALL PROVIDE PASSIVE DUCTS AND CHAMBERS FOR EVC NETWORK REQUIRED TO SERVE REMAINING PARKING BAYS FROM CURRENT 2 NO. EVCS BEING PROVIDED:
 - 1 NO. 50KW TWIN RAPID CHARGER
 - 1 NO. 22KW TWIN FAST CHARGER
- ALL EVC UNITS TO BE PROVIDED WITH PROTECTIVE HOOPS/BARRIERS.
- FINAL SETTING OUT OF EVC UNITS TO BE AS PER THE LANDSCAPE ARCHITECTS REQUIREMENTS.

03/09/24	PRELIMINARY ISSUE	P1	PC
Date	Description	Rev	By
Revision Description			



hulley & kirkwood

London Office

Castle House Horizon Centre
28-38 Upper High Street
Epsom
Surrey
KT17 4RS

Tel No: 01372 747 047
E: hk.london@hulley.co.uk

...Making Buildings Work

Project:
NORTHWOOD & PINNER HEALTH CENTRE P23

Drawing Title:
EXTERNAL SERVICES LAYOUT
SHEET 1 OF 3
NORTH

Drawing Number:
41935(60)902

Revision:	P1
Date:	03/07/2024
Scale:	1:100
Drawn By:	PC
CAD Dwg File:	41935(60)902.dwg
Arch. Base Dwg:	

Issue Status:

PRELIMINARY

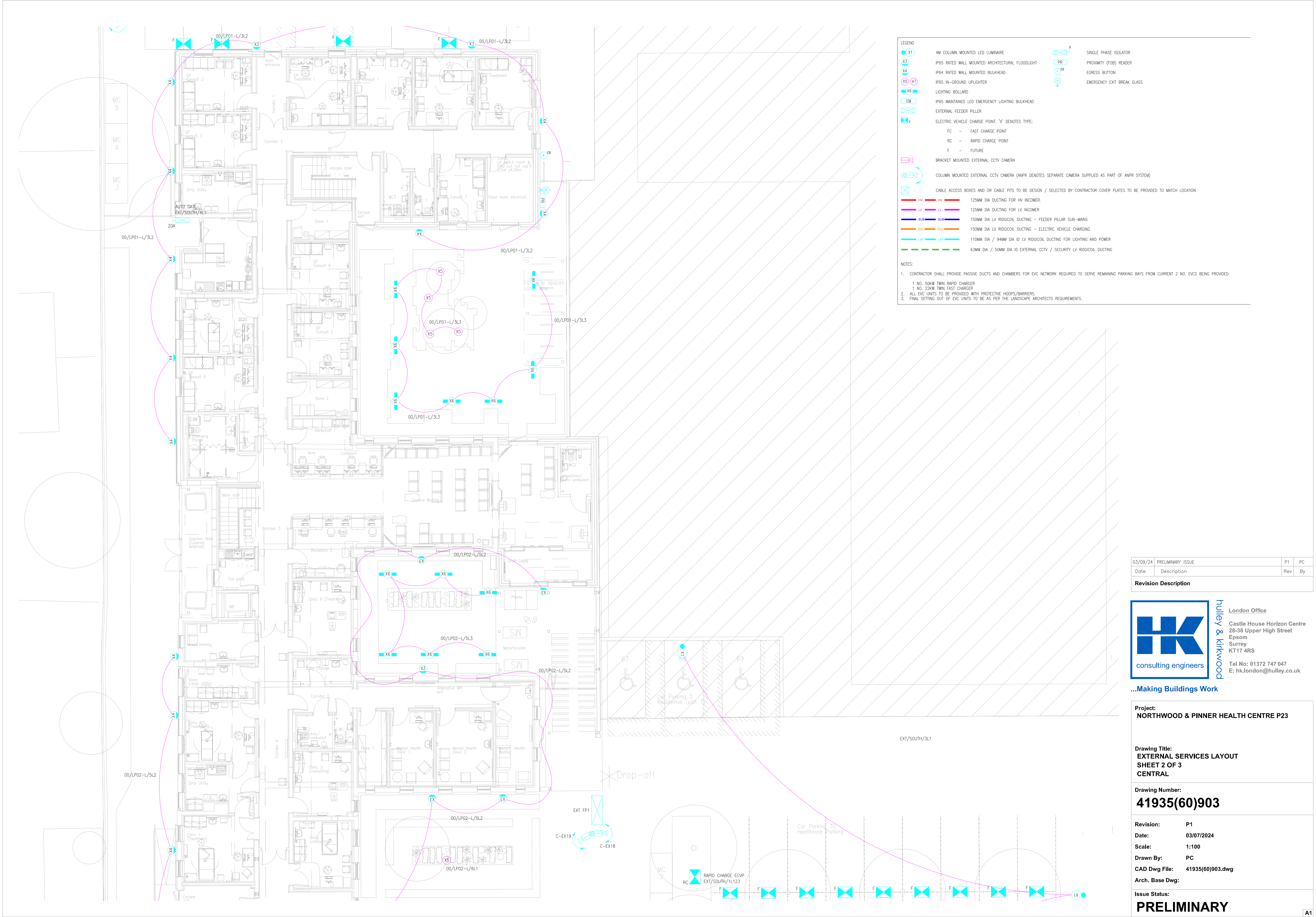

03/09/24	PRELIMINARY ISSUE	P1	PC
Date	Description	Rev	By

Revision Description



consulting engineers

London Office

Castle House Horizon Centre
28-38 Upper High Street
Epsom
Surrey
KT17 4RS

Tel No: 01372 747 047
E: hk.london@hulley.co.uk

...Making Buildings Work

Project:

NORTHWOOD & PINNER HEALTH CENTRE P23

Drawing Title:

**EXTERNAL SERVICES LAYOUT
SHEET 2 OF 3
CENTRAL**

Drawing Number:

41935(60)903

Revision:

P1

Date:

03/07/2024

Scale:

1:100

Drawn By:

PC

CAD Dwg File:

41935(60)903.dwg

Arch. Base Dwg:

Issue Status:

PRELIMINARY

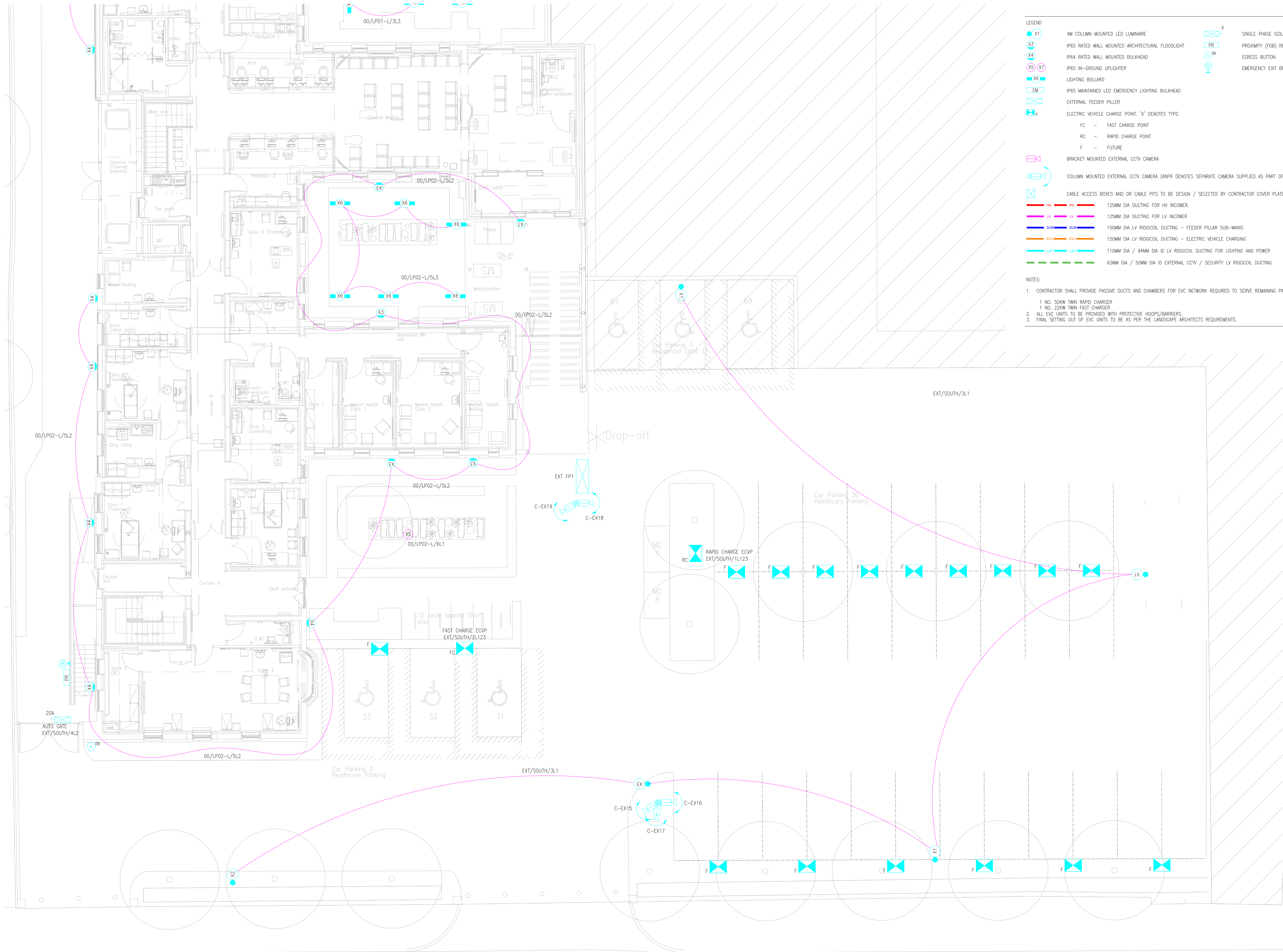

LEGEND

X1	4M COLUMN MOUNTED LED LUMINAIRE	X	SINGLE PHASE ISOLATOR
X3	IP64 RATED WALL MOUNTED ARCHITECTURAL FLOODLIGHT	PR	PROXIMITY (FOB) READER
X4	IP64 RATED WALL MOUNTED BULKHEAD	EB	EGRESS BUTTON
X5 (X7)	IP65 IN-GROUND UPLIGHTER		EMERGENCY EXIT BREAK GLASS
X6	LIGHTING BOLLARD		
DM	IP65 MAINTAINED LED EMERGENCY LIGHTING BULKHEAD		
	EXTERNAL FEEDER PILLER		
	ELECTRIC VEHICLE CHARGE POINT. 'X' DENOTES TYPE:		
FC	FAST CHARGE POINT		
RC	RAPID CHARGE POINT		
F	FUTURE		
	BRACKET MOUNTED EXTERNAL CCTV CAMERA		
	COLUMN MOUNTED EXTERNAL CCTV CAMERA (ANPR DENOTES SEPARATE CAMERA SUPPLIED AS PART OF ANPR SYSTEM)		
	CABLE ACCESS BOXES AND/OR CABLE PITS TO BE DESIGN / SELECTED BY CONTRACTOR COVER PLATES TO BE PROVIDED TO MATCH LOCATION		
HV	125MM DIA DUCTING FOR HV INCOMER		
LV	125MM DIA DUCTING FOR LV INCOMER		
SUB	150MM DIA LV RIDGICOL DUCTING - FEEDER PILLAR SUB-MANS		
EVC	150MM DIA LV RIDGICOL DUCTING - ELECTRIC VEHICLE CHARGING		
LAF	110MM DIA / 94MM DIA ID LV RIDGICOL DUCTING FOR LIGHTING AND POWER		
LAF	63MM DIA / 50MM DIA ID EXTERNAL CCTV / SECURITY LV RIDGICOL DUCTING		

- NOTES:**
- CONTRACTOR SHALL PROVIDE PASSIVE DUCTS AND CHAMBERS FOR EVC NETWORK REQUIRED TO SERVE REMAINING PARKING BAYS FROM CURRENT 2 NO. EVCS BEING PROVIDED:
1 NO. 50KW TWIN RAPID CHARGER
1 NO. 22KW TWIN FAST CHARGER
 - ALL EVC UNITS TO BE PROVIDED WITH PROTECTIVE HOOPS/BARRIERS.
 - FINAL SETTING OUT OF EVC UNITS TO BE AS PER THE LANDSCAPE ARCHITECTS REQUIREMENTS.

03/09/24	PRELIMINARY ISSUE	P1	PC
Date	Description	Rev	By

Revision Description



hulley & kirkwood
consulting engineers

London Office
Castle House Horizon Centre
28-38 Upper High Street
Epsom
Surrey
KT17 4RS
Tel No: 01372 747 047
E: hk.london@hulley.co.uk

...Making Buildings Work

Project:
NORTHWOOD & PINNER HEALTH CENTRE P23



Drawing Title:
EXTERNAL SERVICES LAYOUT
SHEET 3 OF 3
SOUTH

Drawing Number:
41935(60)904

Revision: P1
Date: 03/07/2024
Scale: 1:100
Drawn By: PC
CAD Dwg File: 41935(60)904.dwg
Arch. Base Dwg:

Issue Status:
PRELIMINARY

EXTERNAL LUMINAIRE SCHEDULE		Rev. 02	
PROJECT	Northwood and Pinner Health Centre	STAGE 4+	
SCHEDULE REF:	0212-INS-HC-XX-SH-E-6003		

REF	DESCRIPTION	MANUFACTURER / CAT No	IMAGE
X1	SINGLE-PIECE DIE-CAST ALUMINIUM HOUSING, THAT CONFORMS TO EN1706 AC-46500, WITH INTEGRAL HEAT SINK FINS TO OPTIMISE THERMAL MANAGEMENT THROUGH CONDUCTIVE COOLING. LED MODULES ARE IP65 WITH INDIVIDUAL LENSES, AND HIGH GRADE ALUMINIUM HOUSING TO TRANSFER HEAT AWAY FROM THE LEDS AND DISSIPATE THROUGH THE FINNED HOUSING FOR COOLING. THE LED DRIVER IS MOUNTED IN DIRECT CONTACT WITH THE FINNED HOUSING FOR COOLING TO PROMOTE LOW OPERATING TEMPERATURE AND LONG SYSTEM LIFE. HOUSING IS COMPLETELY SEALED AGAINST MOISTURE AND ENVIRONMENTAL CONTAMINANTS (IP65). INSTALLATION IS VIA THE INTEGRATED MOUNTING BLOCK AND INTEGRAL ARM THAT FACILITATE A QUICK AND EASY INSTALLATION.	HOLOPHANE D-SERIES DSX0.1.LA053.FW	
	To be supplied with DALI compatible driver and photocell options enabling dimming facility. Fully integrated into HoloPhane standard column range.		
	POWER (W) LUMEN OUTPUT (lm) OPTICS		NOTES
	37 4672 FORWARD THROW		COLUMN TO BE BLACK COLOUR
X2		HOLOPHANE D-SERIES DSX0.1.LA053.AY	
	To be supplied with DALI compatible driver and photocell options enabling dimming facility. Fully integrated into HoloPhane standard column range.		
	POWER (W) LUMEN OUTPUT (lm) OPTICS		NOTES
	37 4541 ASSYMETRIC		
X3		HOLOPHANE D-SERIES DSX0.1.LA053.SY	
	To be supplied with DALI compatible driver and photocell options enabling dimming facility. Fully integrated into HoloPhane standard column range.		
	POWER (W) LUMEN OUTPUT (lm) OPTICS		NOTES
	37 4765 FORWARD THROW		
X3	FLOODLIGHT 20 MICRO LED, FLOODLIGHT, PRIMARY LIGHT CONTROL WITH LENS, OF PLASTIC, PRIMARY OPTICAL COVER: PROTECTIVE DISC, OF TOUGHENED SAFETY GLASS, TRANSPARENT, LIGHT DISTRIBUTION: PL52, LIGHT EMISSION: DIRECT DISTRIBUTION, PRIMARY LIGHT CHARACTERISTIC: ASYMMETRIC, INSTALLATION TYPE: SURFACE-MOUNTED, LED HIGH POWER LED, RATED LUMINOUS FLUX: 2.410 LM, LIGHT COLOUR: 830, COLOUR TEMPERATURE: 3000K, CONTROL GEAR: ECG PLUS, CONTROL: FLEXIBLE LUMINOUS FLUX PARAMETERISATION, TIME-DEPENDENT LUMINOUS FLUX CONTROL, DI 27W, LED UNIT, OF DIECAST ALUMINIUM, POWDER-COATED, SITECO® METALLIC GREY (DB 702S), LENGTH: 304 MM, WIDTH: 222 MM, HEIGHT: 55MM, HOUSING FRAME, OF DIECAST ALUMINIUM, POWDER-COATED, SITECO® METALLIC GREY (DB 702S), MOUNTING BRACKET, OF STEEL, POWDER-COATED, SITECO® METALLIC GREY (DB 702S), DALI PROTECTION RATING (COMPLETE): IP66, INSULATION CLASS (COMPLETE): INSULATION CLASS II (SAFETY INSULATION), CERTIFICATION: CE, ENEC, VDE, PROTECTION SYMBOL: D, PERMISSIBLE AMBIENT TEMPERATURE FOR INDOOR APPLICATIONS: -40...+40°C, PERMISSIBLE AMBIENT TEMPERATURE FOR OUTDOOR APPLICATIONS: -40...+50°C, STANDARD: DIN EN 12944, PACKAGING UNIT: 1 PIECE	SITECO FLOODLIGHT 20 MICRO LED 5XA7662A1D1AC	
	POWER (W) LUMEN OUTPUT (lm) OPTICS		NOTES
	27 2410 ASSYMETRIC		COLOUR TBC
X4	HOLOPHANE DENVER ID: WALL CONSISTS OF A 2-PART BODY AND A REMOVABLE LED MODULE MANUFACTURED FROM LM6 MARINE GRADE DIE-CAST ALUMINIUM WITH INTEGRATED THERMAL MANAGEMENT PROPERTIES. THE LED MODULE OPTICAL ARRANGEMENT CONSISTS OF LEDS WITH INDIVIDUAL PMMA OPTICAL LENSES SURROUNDED BY A PATENTED WHITE TRANSITION ZONE TO REDUCE PERCEIVED GLARE. THIS IS SEALED BEHIND HIGH-TRANSPARENCY 'HYDROPHILIC' GLASS. BOTH LUMINAIRE BODY AND LED MODULE ARE SEALED TO IP65 AND RATED IK10. DRIVERS AND LED ARE MOUNTED SEPARATELY FROM EACH OTHER TO PROMOTE LOW OPERATING TEMPERATURES AND LONG SYSTEM LIFE. MOUNTING OF THE LUMINAIRE IS FACILITATED BY MOUNTING THE BACK CASTING OF LUMINAIRE TO SUITABLE SURFACE. CABLE ENTRY AND TERMINATION TO THE LUMINAIRE IS A VIA AN 2 X IP65 20MM CABLE GLAND. ACCESS TO THE LUMINAIRE IS VIA 2 X NUTS.	HOLOPHANE DENVER ID DBD.1.LA013.DO.NR.C4.CII.T SZ.TZ01.LRT76.B.V1	
	X4 fittings to be supplied with integral photocells + auto dimming facility. Extra backboxes to be supplied as required to contain controls as required		
	POWER (W) LUMEN OUTPUT (lm) OPTICS		NOTES
	10.3 1385 LONG AND NARROW		COLOUR TBC



ADDITIONAL ITEMS	DESCRIPTION	MANUFACTURER / CAT No
COLUMNS	4m DEMOUNTABLE COLUMNS TO BE PROVIDED FINISHED IN BLACK	FABRIKAT RAISE AND LOWER MID-HINGE COLUMNS
CONTROLS	SOLAR DIAL TIMECLOCK AND PHOTOCCELL CONTROLS	SANGAMO

NOTES

1 SCHEDULE TO BE READ IN CONJUNCTION WITH DRAWINGS AND SPECIFICATION

ISSUE/REVISION	02	SIGNED	GR
DATE	02/06/2023	CHECKED	MH

EXTERNAL LUMINAIRE SCHEDULE		Rev. 02	
PROJECT	Northwood and Pinner Health Centre	STAGE 4+	
SCHEDULE REF:	0212-INS-HC-XX-SH-E-6003		

REF	DESCRIPTION	MANUFACTURER / CAT No	IMAGE
X5	IN-GROUND UPLIGHTERS TO HIGHLIGHT SPECIMEN TREES AND SHRUBS. SPECIFICATION TBC IN CONJUNCTION WITH LANDSCAPE ARCHITECT.		ALLOW £400 PER POINT
	POWER (W) LUMEN OUTPUT (lm) OPTICS		NOTES
X6	HOLOPHANE DENVER ID: BOLLARD DENVER CONSISTS OF LM6- EXTRUDED ALUMINIUM BODY AND A REMOVABLE LED MODULE MANUFACTURED FROM LM6 MARINE GRADE DIE-CAST ALUMINIUM WITH INTEGRATED THERMAL MANAGEMENT PROPERTIES. THE LED MODULE OPTICAL ARRANGEMENT CONSISTS OF LEDS WITH INDIVIDUAL PMMA OPTICAL LENSES SURROUNDED BY A PATENTED WHITE TRANSITION ZONE TO REDUCE PERCEIVED GLARE AND UP LIGHT. THIS IS SEALED BEHIND HIGH-TRANSPARENCY CLEAR POLYCARBONATE EXTRUSION. BOTH LUMINAIRE BODY AND LED MODULE ARE SEALED TO IP65 AND RATED IK10. DRIVERS AND LED ARE MOUNTED SEPARATELY FROM EACH OTHER TO PROMOTE LOW OPERATING TEMPERATURES AND LONG SYSTEM LIFE. MOUNTING OF THE LUMINAIRE IS FACILITATED BY USING THE MOUNTING BASE OF THE BOLLARD THROUGH SPECIFICALLY DRILLED POINTS. CABLE ENTRY AND TERMINATION TO THE LUMINAIRE IS A VIA AN IP65 CABLE GLAND. ACCESS TO THE LUMINAIRE IS VIA 2 X NUTS	HOLOPHANE DENVER ID DBD.1.LA013.DO.AY.W009	
	POWER (W) LUMEN OUTPUT (lm) OPTICS		NOTES
	9 995 ASSYMETRICAL		
X7	IN GROUND LED CIRCULAR UPLIGHT WITH DIFFUSER OPTIC ER56: FLOOR-RECESSED ORBIT LUMINAIRE D=23MM - FLUSH-MOUNTED STAINLESS STEEL FRAME - WARM WHITE LED - DIFFUSER OPTIC X489.13: OUTER CASING IN PLASTIC FOR THE GROUND, FLOOR WITH STAINLESS STEEL RING + CLOSURE CAP - STEEL	IGUZZINI LIGHT UP	
	POWER (W) LUMEN OUTPUT (lm) OPTICS		
	3.8 470 MEDIUM 24DEGREE		
	EXTERNAL CANOPY LIGHTING ALLOW £3500 PROVISIONAL SUM		

ADDITIONAL ITEMS	DESCRIPTION	MANUFACTURER / CAT No
COLUMNS	4m DEMOUNTABLE COLUMNS TO BE PROVIDED FINISHED IN BLACK	FABRIKAT RAISE AND LOWER MID-HINGE COLUMNS
CONTROLS	SOLAR DIAL TIMECLOCK AND PHOTOCCELL CONTROLS	SANGAMO

NOTES

1 SCHEDULE TO BE READ IN CONJUNCTION WITH DRAWINGS AND SPECIFICATION

ISSUE/REVISION	02	SIGNED	GR
DATE	02/06/2023	CHECKED	MH

EXTERNAL LUMINAIRE X1 & X2

D-SERIES



D-SERIES



HOLOPHANE[®]
An Acuity Brands Company

D-SERIES

The modern styling of the **D-Series** is striking yet unobtrusive - making a bold, progressive statement as it blends seamlessly with its environment. **D-Series** takes all the benefits of LED technology and moulds it into a high performance, high efficacy and long life area lighting luminaire.

With its exceptional 'finned' thermal management system, **D-Series** is capable of delivering over 100,000 hours LED module life. Offering a wide range of lumen packages and optical distributions, **D-Series** delivers optimised lighting application designs.

With the integrated ZD4i compatibility **D-Series** delivers a controllable luminaire that helps you realise energy consumption goals and demonstrate environmental responsibility. With its unique optics placed below each LED it ensures light is delivered where it needs to be, providing a uniform Nighttime Friendly environment with minimal light pollution.

Applications

- Amenity Areas
- Car Parks
- Retail Parks
- Truck Yards
- Warehousing
- Exterior Areas

Optics / Light Source

- Lumen packages ranging from 2,000 - 50,000 in 3 different luminaire variants
- Fully soak tested light engines ensuring LED reliability and eliminating early failures.
- 2700K/3000K/4000K colour temperature.
- RA 70.

TM66 CEAM-Make Rating

Rating: 2.6 Excellent Circularity.



TM66 Assured Score

Approvals

Complies with EN60598



IP IP65 luminaire and LED optic

Ta -40°C to +40°C

DSX1



For further information please visit the Holophane website www.holophane.co.uk

AN ENVIABLE REPUTATION THROUGHOUT THE WORLD



When Holophane was founded in 1896 in London, headed by Pelham Trotter, it marked the start of an incredible history that has now seen Holophane become a global business revered throughout the world for its expertise, quality, innovation and excellence in lighting.

Holophane’s first product was the famous patented globe in ‘white’ or ‘rose crystal’ that sold for around 2 shilling (10p). Today, Holophane continues this proud tradition with our values deeply rooted in the dedication to creating luminaires, with exceptional lighting performance, innovative patented technologies, and delivering added customer value beyond illumination.

What does it mean for our customers?

A Trusted & Reliable UK Manufacturer

From Royalty all the way to small residential projects, Holophane has been a trusted manufacturer over the decades for all manner of projects. You can be sure you are in good hands and can rely on the collective knowledge and expertise we have gathered since our inception in 1896.

Development of Innovative Products

As part of our design philosophy, Holophane are always trying to push boundaries in the development of unique product innovations. As such many of our luminaires hold UK and International design patents.



Products That Deliver Added Value

In today’s world, sustainability and added value are becoming increasingly important. As such our products and solutions go further than just lighting. Many of our innovations include integrated smart connected solutions to help customers achieve further energy savings and can also enable remote monitoring.

Delivering excellent customer service

Over our 125-year history we have always been committed to delivering the best service to our customers and supporting in a myriad of ways to ensure the best possible outcomes. This goes as far as offering a free lighting design service to one-off products/ solutions to meet customers unique needs.

THE D-SERIES RANGE 3 LUMINAIRES, ONE COMPLETE PROJECT SOLUTION

The **D-Series** range has been designed not only for super optical quality and performance but also to have a cohesive family aesthetic.

Available in 3 luminaire sizes, the D-Series range offers a full outdoor lighting solution for any environment.



DSX0

2,000 to 22,000 lumens
up to 6m mounting heights



DSX1

22,000 - 36,000 lumens
between 6m and 10m mounting heights



DSX2

30,000 - 50,000 lumens
8m mounting heights and above

PRODUCT FEATURES

Enhanced Performance

The **D-Series** range features the very latest LED technologies. In conjunction with silicone optics this delivers the best lighting performance coupled with low-energy consumption and high efficacy. This also means D-Series meets BREEAM compliance.

Class leading optics

The **D-Series** range has the flexibility of 4 optimised optical distributions. Through using individual bubble optics per LED D-Series controls the light exactly where it's needed. This results in a luminaire that provides best in class spacings and uniformity.

Easy maintenance

The **D-Series** range has an easily accessible gear compartment ensuring fast and simple component changes if required.



D-SERIES



DSX1



DSX2

Connected

The **D-Series** range is ZD4i compatible when specified with the 4-pin Zhaga socket options (TZ01 or TZ02) enabling a future proof luminaire that can be used in conjunction with Controlux Air or a expanding ecosystem of third party devices and sensors.

Note: Post Top Bracket for The D-Series range is sold separately. Please enquire with your Holophane representative for the full range of mounting options.



DSX0

THERMAL MANAGEMENT

The reliability and performance of an LED luminaire is dependent on a combination of factors. Keeping the temperature of the drivers, LEDs and electronic components as low as possible is critical to maintaining the luminaire's efficiency.

One of Holophane's key luminaire design principles ensures that the **D-Series** family utilises all three heat transfer principles of conduction, convection and radiation.



Conduction

Taking heat away from electronic components, LEDs and drivers.

The **D-Series** range has drivers and LEDs that are mounted directly to thermally efficient, LM6 Aluminium to promote efficient transfer of heat from these critical components.



Convection

From luminaire heat sink chassis and LED module to ambient air.

The **D-Series** range is designed to have drivers and LEDs that are mounted separately to avoid compound heating of components. This ensures critical components are kept as cool as possible to ensure long system life.



Radiation

Surface finish and form designed to maximise heat radiation.

The **D-Series** range incorporates a large finned casting design which increases the total surface area of the luminaire and in turn helps to promote cooling through radiation.

THERMAL MANAGEMENT

DSX1

