

Northwood & Pinner Cottage Hospital elevations are based on survey drawings. Windows will be replaced throughout. In critical elevations such as South and southern edge of East and South elevation. New windows to match existing types including including profiles and glazed subdivision.



01 NORTH ELEVATION



02 SOUTH ELEVATION

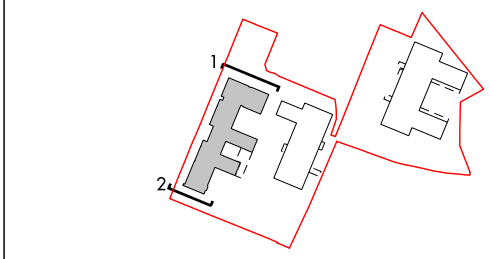

Figured dimensions are in millimetres unless noted otherwise. All dimensions and levels shall be verified on site before proceeding with works. Detailed site survey to be carried out to verify positions and level relationships with site features and outcrops survey. The Architect must be notified of any discrepancy. Boundaries are indicative only and are to be verified by others.

Allies & Morrison LLP is not responsible for any errors caused by the transmission, translation, software or computer systems. Allies & Morrison LLP is not responsible for nor shall be liable for the consequences of any use made of the drawings or models other than that for which they were produced by Allies & Morrison LLP for the Client. All Intellectual Property Rights reserved.

| REV | DATE | DESCRIPTION | CD |
|-----|------------|---------------------------------------------|----|
| P1 | 12.03.2021 | ISSUED FOR PLANNING | AO |
| P2 | 24.08.2021 | ISSUED FOR PLANNING - AUGUST PL. AMENDMENTS | AO |
| P3 | 09.06.2023 | ISSUED FOR PLANNING | RG |
| | | | |
| | | | |
| | | | |

0 5m

Allies and Morrison LLP
85 Southwark Street
London SE1 0HX
020 7921 0100
020 7921 0101
studio@alliesandmorrison.com
A&M JOB NO: 17115_05

NHS - NORTHWOOD AND PINNER, LONDON
Healthcare Centre: PROPOSED ELEVATIONS SHEET 1
PLANNING
17115_05_HC_07_200
SCALE 1:100 @A1 1:200@A3

P3

Revision