

## Middlesex

Published 1868

Source map scale - 1:10,560

The historical maps shown were reproduced from maps predominantly held at the scale adopted for England, Wales and Scotland in the 1840's. In 1854 the 1:2,500 scale was adopted for mapping urban areas; these maps were used to update the 1:10,560 maps. The published date given therefore is often some years later than the surveyed date. Before 1938, all OS maps were based on the Cassini Projection, with independent surveys of a single county or group of counties, giving rise to significant inaccuracies in outlying areas. In the late 1940's, a Provisional Edition was produced, which updated the 1:10,560 mapping from a number of sources. The maps appear unfinished - with all military camps and other strategic sites removed. These maps were initially overprinted with the National Grid. In 1970, the first 1:10,000 maps were produced using the Transverse Mercator Projection. The revision process continued until recently, with new editions appearing every 10 years or so for urban areas.

## Map Name(s) and Date(s)

00500	1868	1:10,560
01000	1868	1:10,560

## Historical Map - Slice A

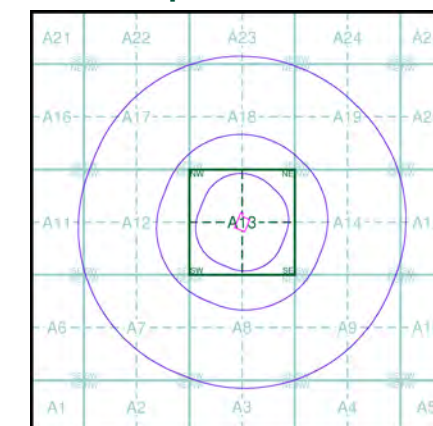

## Order Details

Order Number: 71541451\_1\_1  
Customer Ref: 35554/3501  
National Grid Reference: 510020, 190670  
Slice: A  
Site Area (Ha): 0.62  
Search Buffer (m): 1000

## Site Details

Northwood & Pinner Hospital, Pinner Road, Northwood, HA6 1DE

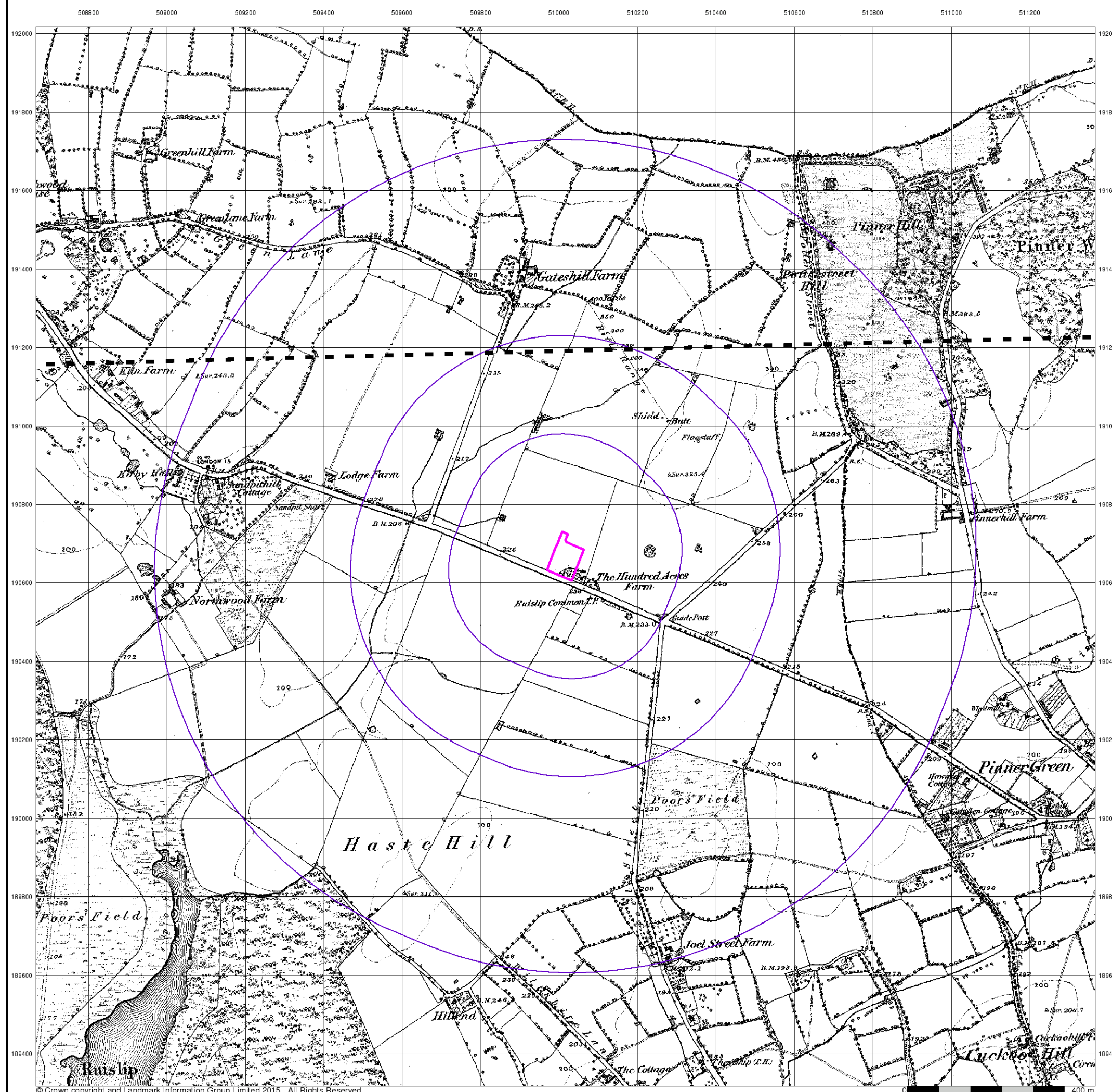





## Buckinghamshire

Published 1883

Source map scale - 1:10,560

The historical maps shown were reproduced from maps predominantly held at the scale adopted for England, Wales and Scotland in the 1840's. In 1854 the 1:2,500 scale was adopted for mapping urban areas; these maps were used to update the 1:10,560 maps. The published date given therefore is often some years later than the surveyed date. Before 1938, all OS maps were based on the Cassini Projection, with independent surveys of a single county or group of counties, giving rise to significant inaccuracies in outlying areas. In the late 1940's, a Provisional Edition was produced, which updated the 1:10,560 mapping from a number of sources. The maps appear unfinished - with all military camps and other strategic sites removed. These maps were initially overprinted with the National Grid. In 1970, the first 1:10,000 maps were produced using the Transverse Mercator Projection. The revision process continued until recently, with new editions appearing every 10 years or so for urban areas.

### Map Name(s) and Date(s)

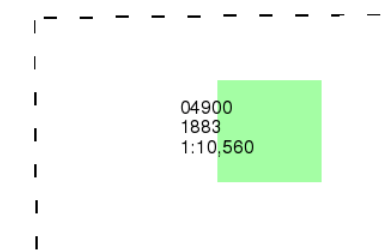

### Historical Map - Slice A

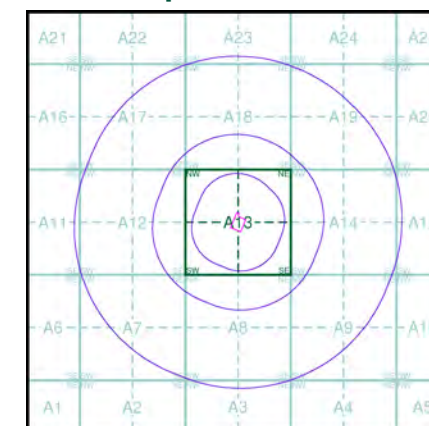

### Order Details

Order Number: 71541451\_1\_1  
Customer Ref: 35554/3501  
National Grid Reference: 510020, 190670  
Slice: A  
Site Area (Ha): 0.62  
Search Buffer (m): 1000

### Site Details

Northwood & Pinner Hospital, Pinner Road, Northwood, HA6 1DE



Tel: 0844 844 9952  
Fax: 0844 844 9951  
Web: www.envirocheck.co.uk

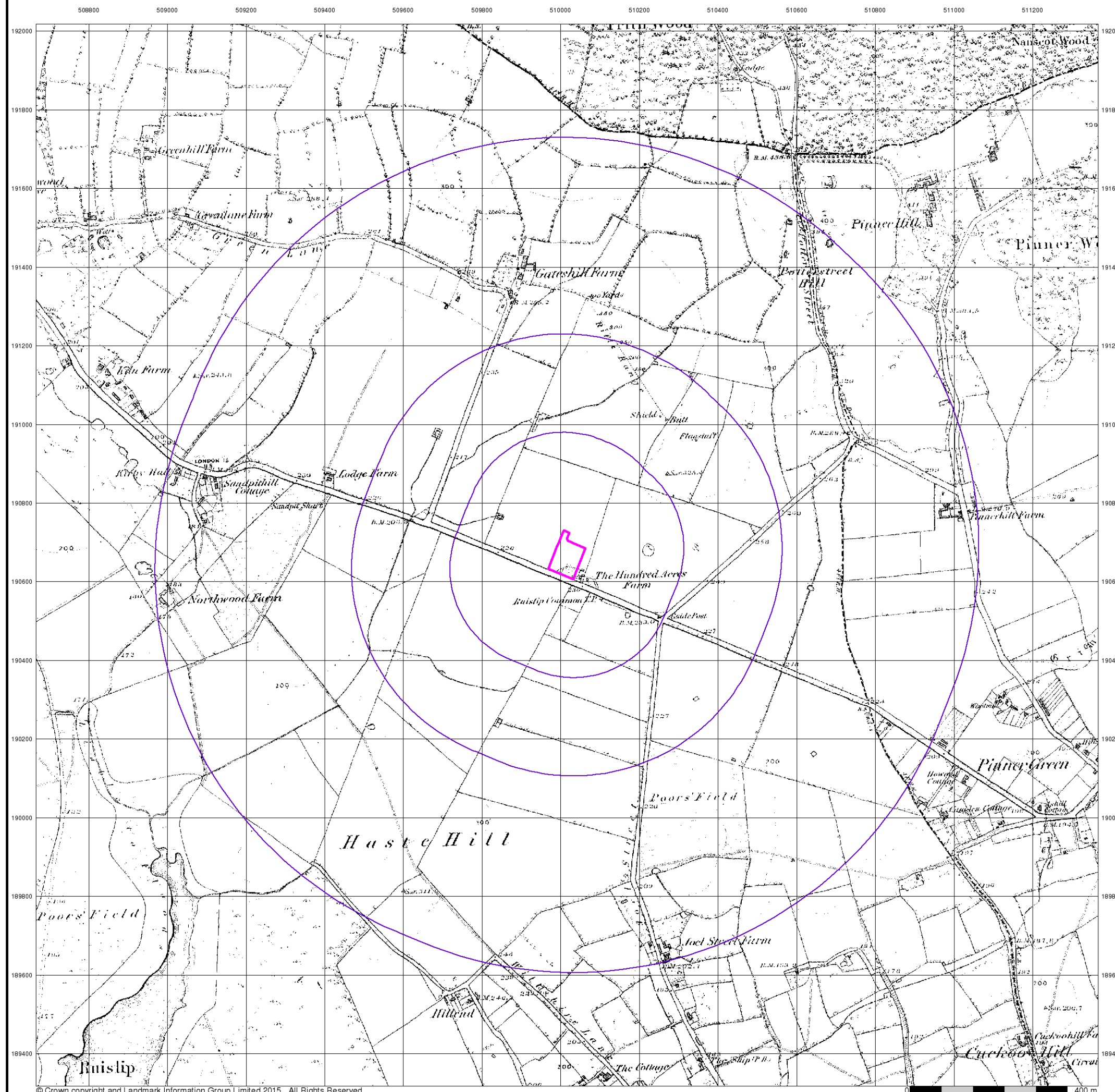





## Middlesex

Published 1897 - 1899

Source map scale - 1:10,560

The historical maps shown were reproduced from maps predominantly held at the scale adopted for England, Wales and Scotland in the 1840's. In 1854 the 1:2,500 scale was adopted for mapping urban areas; these maps were used to update the 1:10,560 maps. The published date given therefore is often some years later than the surveyed date. Before 1938, all OS maps were based on the Cassini Projection, with independent surveys of a single county or group of counties, giving rise to significant inaccuracies in outlying areas. In the late 1940's, a Provisional Edition was produced, which updated the 1:10,560 mapping from a number of sources. The maps appear unfinished - with all military camps and other strategic sites removed. These maps were initially overprinted with the National Grid. In 1970, the first 1:10,000 maps were produced using the Transverse Mercator Projection. The revision process continued until recently, with new editions appearing every 10 years or so for urban areas.

### Map Name(s) and Date(s)

005SW
1899
1:10,560
010NW
1897
1:10,560

### Historical Map - Slice A

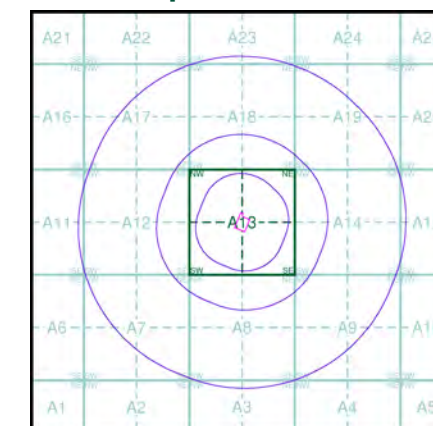

### Order Details

Order Number: 71541451\_1\_1  
Customer Ref: 35554/3501  
National Grid Reference: 510020, 190670  
Slice: A  
Site Area (Ha): 0.62  
Search Buffer (m): 1000

### Site Details

Northwood & Pinner Hospital, Pinner Road, Northwood, HA6 1DE



Tel: 0844 844 9952  
Fax: 0844 844 9951  
Web: www.envirocheck.co.uk

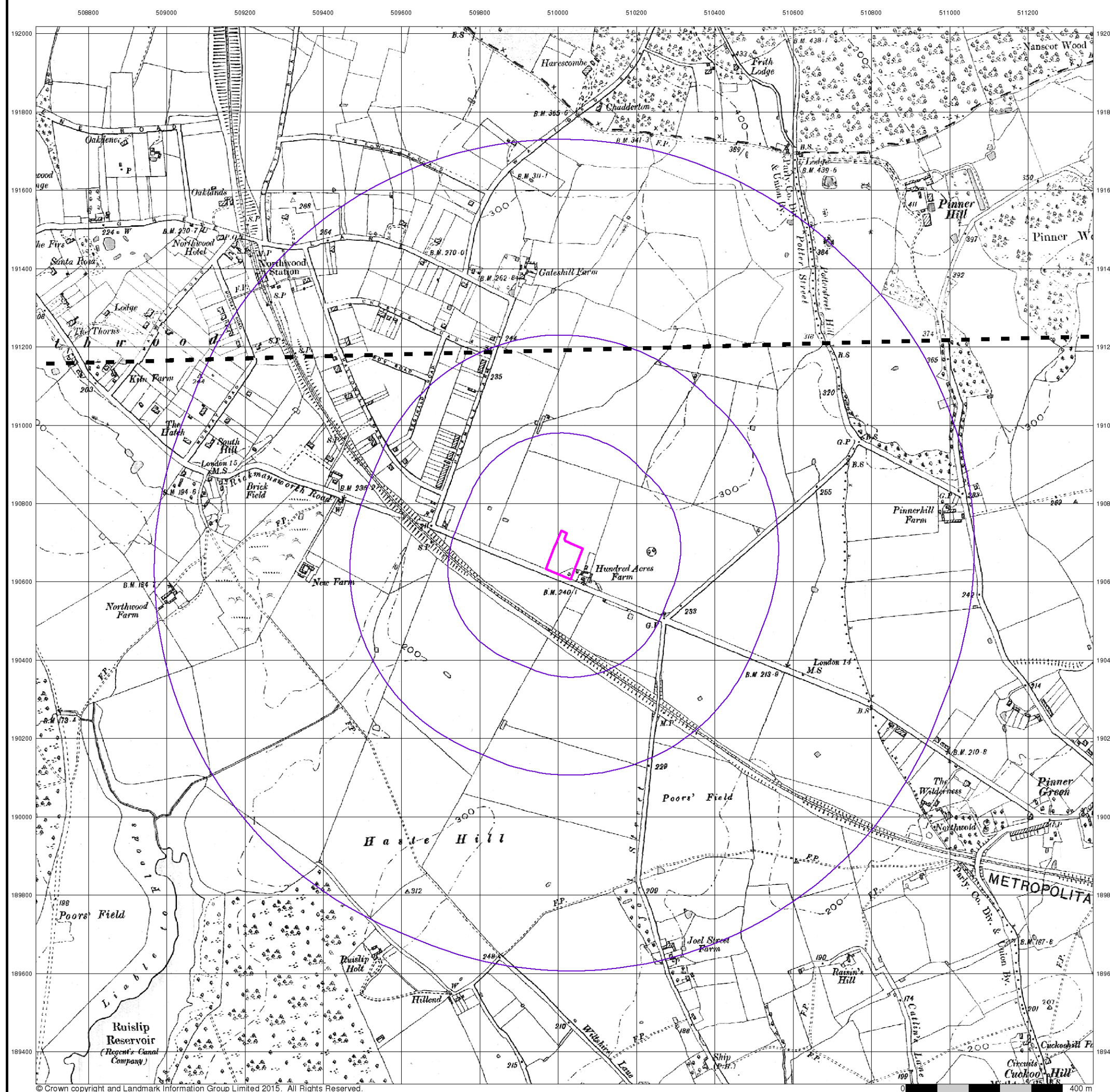

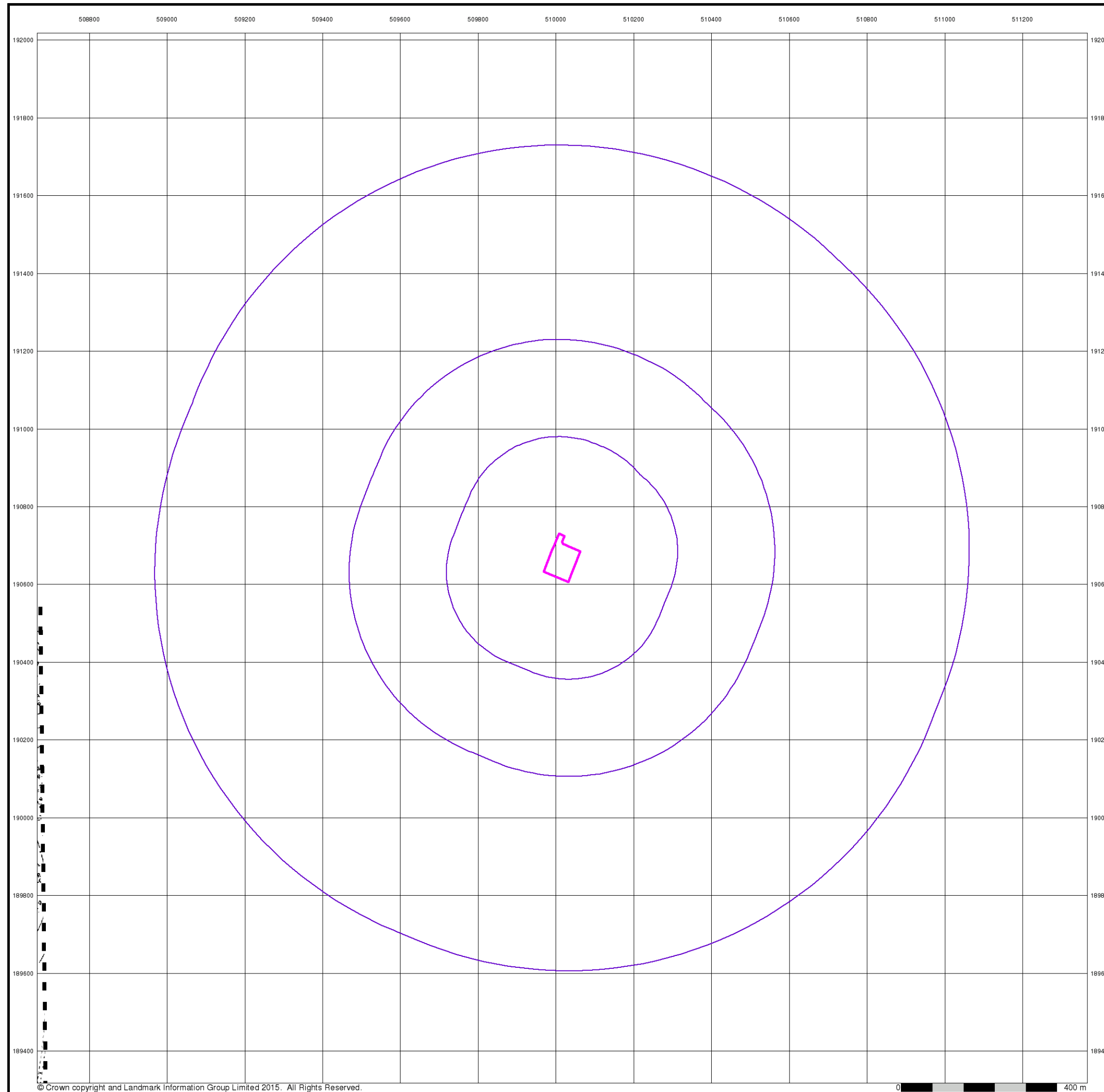

## Buckinghamshire

**Published 1900**

**Source map scale - 1:10,560**

The historical maps shown were reproduced from maps predominantly held at the scale adopted for England, Wales and Scotland in the 1840's. In 1854 the 1:2,500 scale was adopted for mapping urban areas; these maps were used to update the 1:10,560 maps. The published date given therefore is often some years later than the surveyed date. Before 1938, all OS maps were based on the Cassini Projection, with independent surveys of a single county or group of counties, giving rise to significant inaccuracies in outlying areas. In the late 1940's, a Provisional Edition was produced, which updated the 1:10,560 mapping from a number of sources. The maps appear unfinished - with all military camps and other strategic sites removed. These maps were initially overprinted with the National Grid. In 1970, the first 1:10,000 maps were produced using the Transverse Mercator Projection. The revision process continued until recently, with new editions appearing every 10 years or so for urban areas.

### Map Name(s) and Date(s)

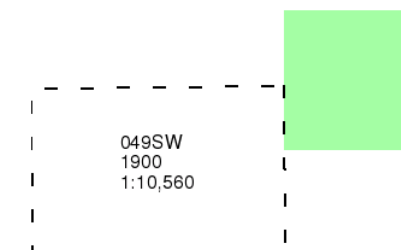

### Historical Map - Slice A

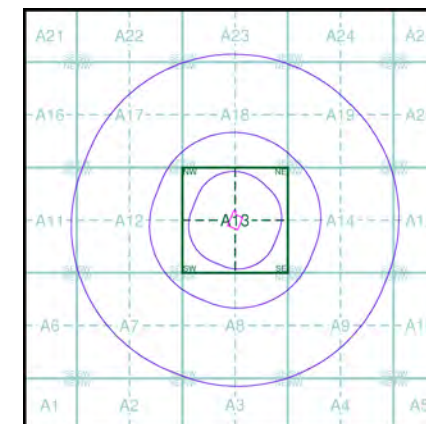

### Order Details

Order Number: 71541451\_1\_1  
Customer Ref: 35554/3501  
National Grid Reference: 510020, 190670  
Slice: A  
Site Area (Ha): 0.62  
Search Buffer (m): 1000

### Site Details

Northwood & Pinner Hospital, Pinner Road, Northwood, HA6 1DE



Tel: 0844 844 9952  
Fax: 0844 844 9951  
Web: www.envirocheck.co.uk



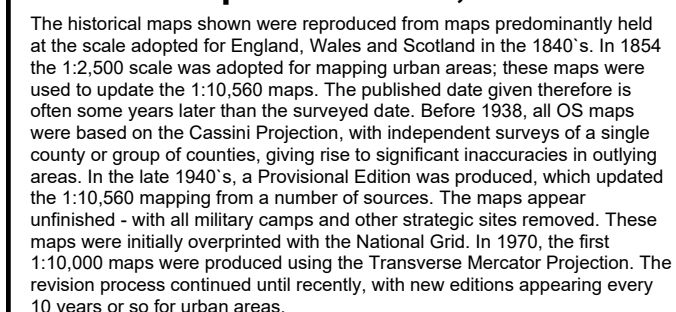

010NW  
1916  
1:10,560

Order Number: 71541451\_1\_1  
Customer Ref: 35554/3501  
National Grid Reference: 510020, 190670  
Slice: A  
Site Area (Ha): 0.62  
Search Buffer (m): 1000

Northwood & Pinner Hospital, Pinner Road, Northwood, HA6  
1DE

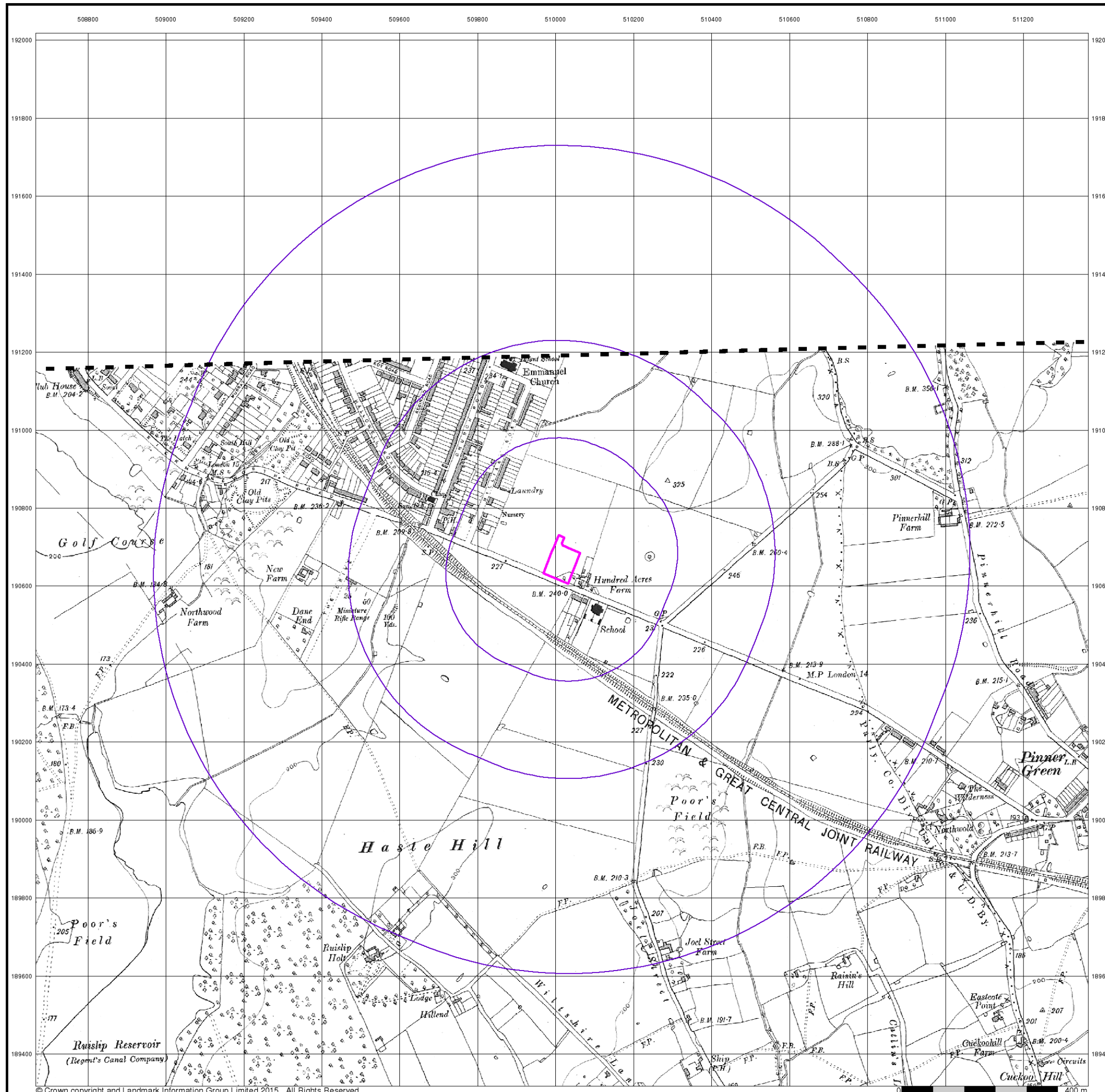









Hertfordshire

Published 1920

Source map scale - 1:10,560

The historical maps shown were reproduced from maps predominantly held at the scale adopted for England, Wales and Scotland in the 1840's. In 1854 the 1:2,500 scale was adopted for mapping urban areas; these maps were used to update the 1:10,560 maps. The published date given therefore is often some years later than the surveyed date. Before 1938, all OS maps were based on the Cassini Projection, with independent surveys of a single county or group of counties, giving rise to significant inaccuracies in outlying areas. In the late 1940's, a Provisional Edition was produced, which updated the 1:10,560 mapping from a number of sources. The maps appear unfinished - with all military camps and other strategic sites removed. These maps were initially overprinted with the National Grid. In 1970, the first 1:10,000 maps were produced using the Transverse Mercator Projection. The revision process continued until recently, with new editions appearing every 10 years or so for urban areas.

### Map Name(s) and Date(s)

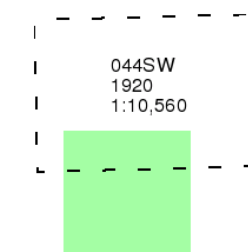

### Historical Map - Slice A

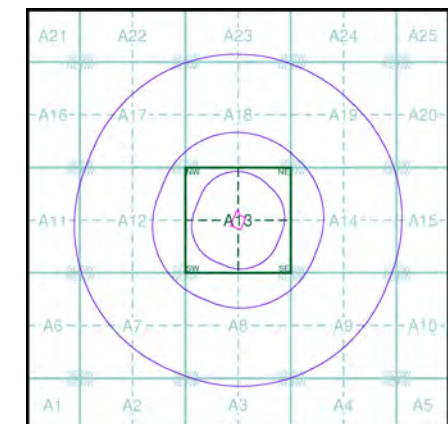

### Order Details

Order Number: 71541451\_1\_1  
Customer Ref: 35554/3501  
National Grid Reference: 510020, 190670  
Slice: A  
Site Area (Ha): 0.62  
Search Buffer (m): 1000

### Site Details

Northwood & Pinner Hospital, Pinner Road, Northwood, HA6 1DE



Tel: 0844 844 9952  
Fax: 0844 844 9951  
Web: www.envirocheck.co.uk

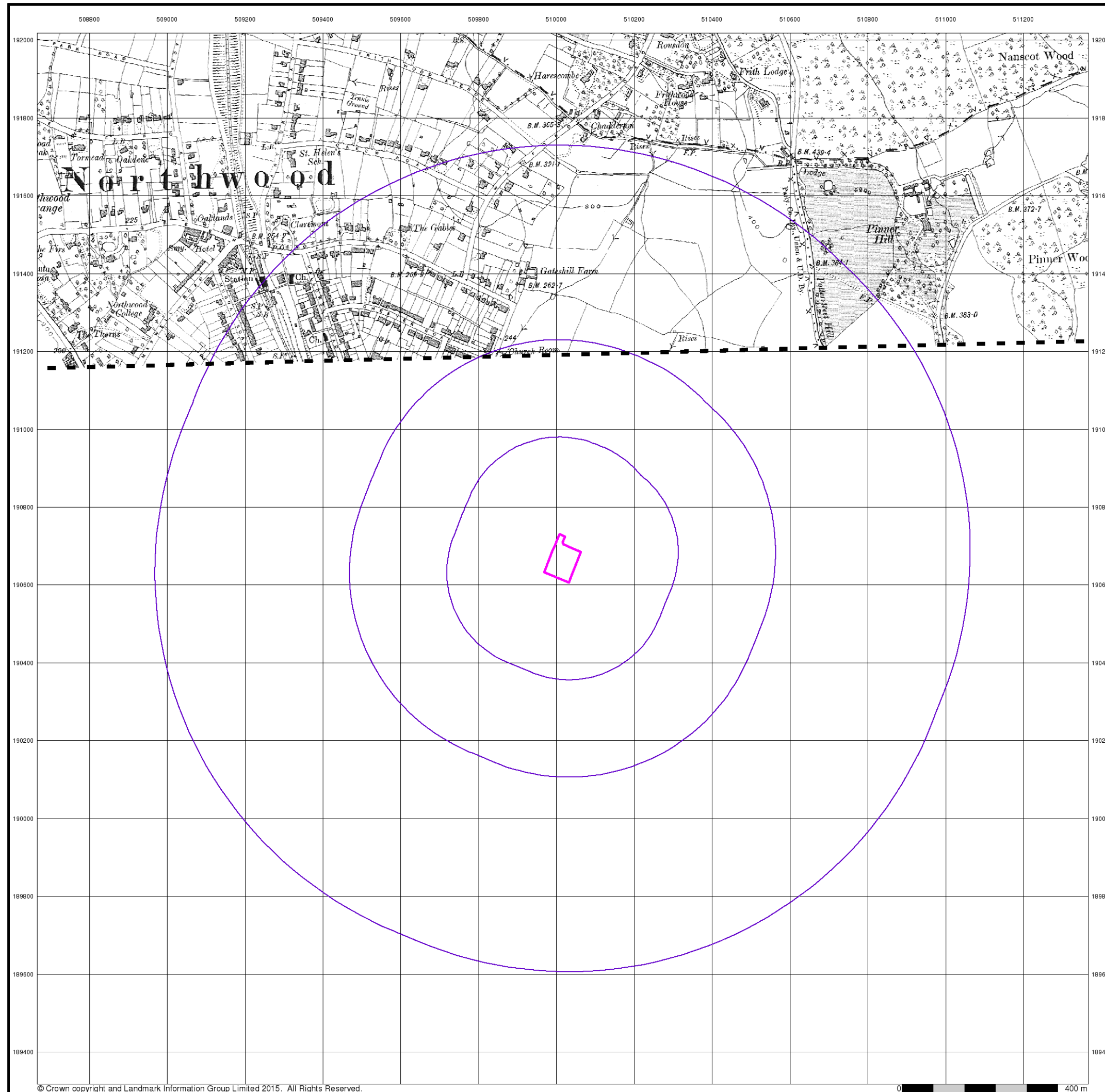



## Middlesex

Published 1935

Source map scale - 1:10,560

The historical maps shown were reproduced from maps predominantly held at the scale adopted for England, Wales and Scotland in the 1840's. In 1854 the 1:2,500 scale was adopted for mapping urban areas; these maps were used to update the 1:10,560 maps. The published date given therefore is often some years later than the surveyed date. Before 1938, all OS maps were based on the Cassini Projection, with independent surveys of a single county or group of counties, giving rise to significant inaccuracies in outlying areas. In the late 1940's, a Provisional Edition was produced, which updated the 1:10,560 mapping from a number of sources. The maps appear unfinished - with all military camps and other strategic sites removed. These maps were initially overprinted with the National Grid. In 1970, the first 1:10,000 maps were produced using the Transverse Mercator Projection. The revision process continued until recently, with new editions appearing every 10 years or so for urban areas.

## Map Name(s) and Date(s)

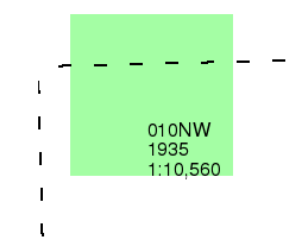

## Historical Map - Slice A

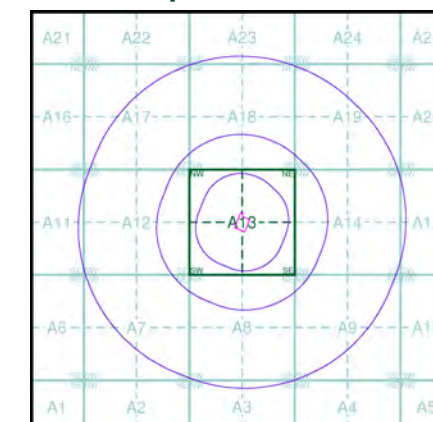

## Order Details

Order Number: 71541451\_1\_1  
Customer Ref: 35554/3501  
National Grid Reference: 510020, 190670  
Slice: A  
Site Area (Ha): 0.62  
Search Buffer (m): 1000

## Site Details

Northwood & Pinner Hospital, Pinner Road, Northwood, HA6 1DE

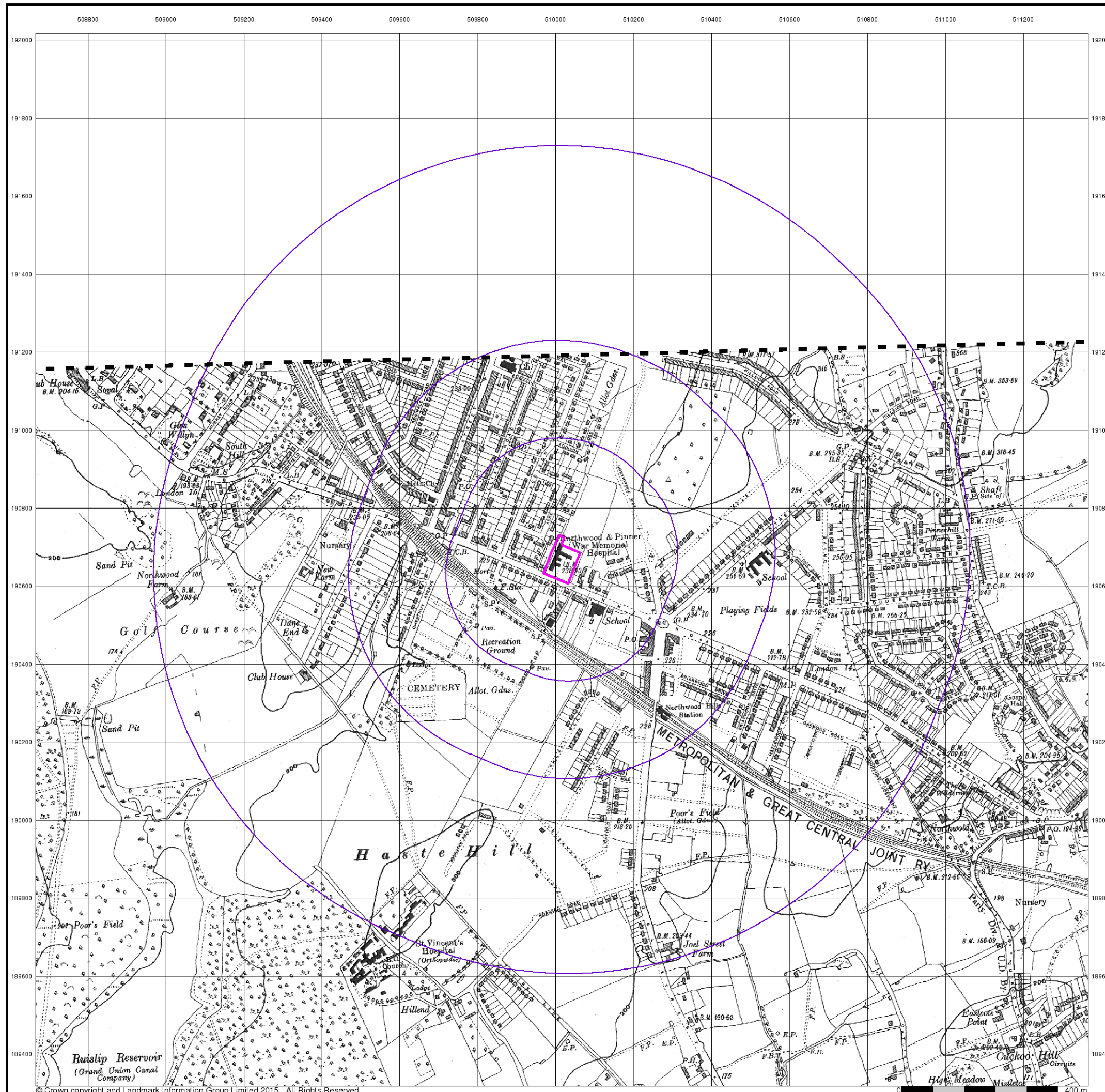





## Hertfordshire

Published 1935

Source map scale - 1:10,560

The historical maps shown were reproduced from maps predominantly held at the scale adopted for England, Wales and Scotland in the 1840's. In 1854 the 1:2,500 scale was adopted for mapping urban areas; these maps were used to update the 1:10,560 maps. The published date given therefore is often some years later than the surveyed date. Before 1938, all OS maps were based on the Cassini Projection, with independent surveys of a single county or group of counties, giving rise to significant inaccuracies in outlying areas. In the late 1940's, a Provisional Edition was produced, which updated the 1:10,560 mapping from a number of sources. The maps appear unfinished - with all military camps and other strategic sites removed. These maps were initially overprinted with the National Grid. In 1970, the first 1:10,000 maps were produced using the Transverse Mercator Projection. The revision process continued until recently, with new editions appearing every 10 years or so for urban areas.

### Map Name(s) and Date(s)

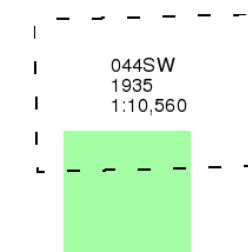

### Historical Map - Slice A

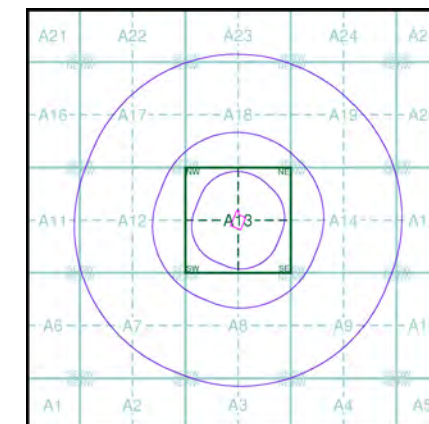

### Order Details

Order Number: 71541451\_1\_1  
Customer Ref: 35554/3501  
National Grid Reference: 510020, 190670  
Slice: A  
Site Area (Ha): 0.62  
Search Buffer (m): 1000

### Site Details

Northwood & Pinner Hospital, Pinner Road, Northwood, HA6 1DE



Tel: 0844 844 9952  
Fax: 0844 844 9951  
Web: www.envirocheck.co.uk

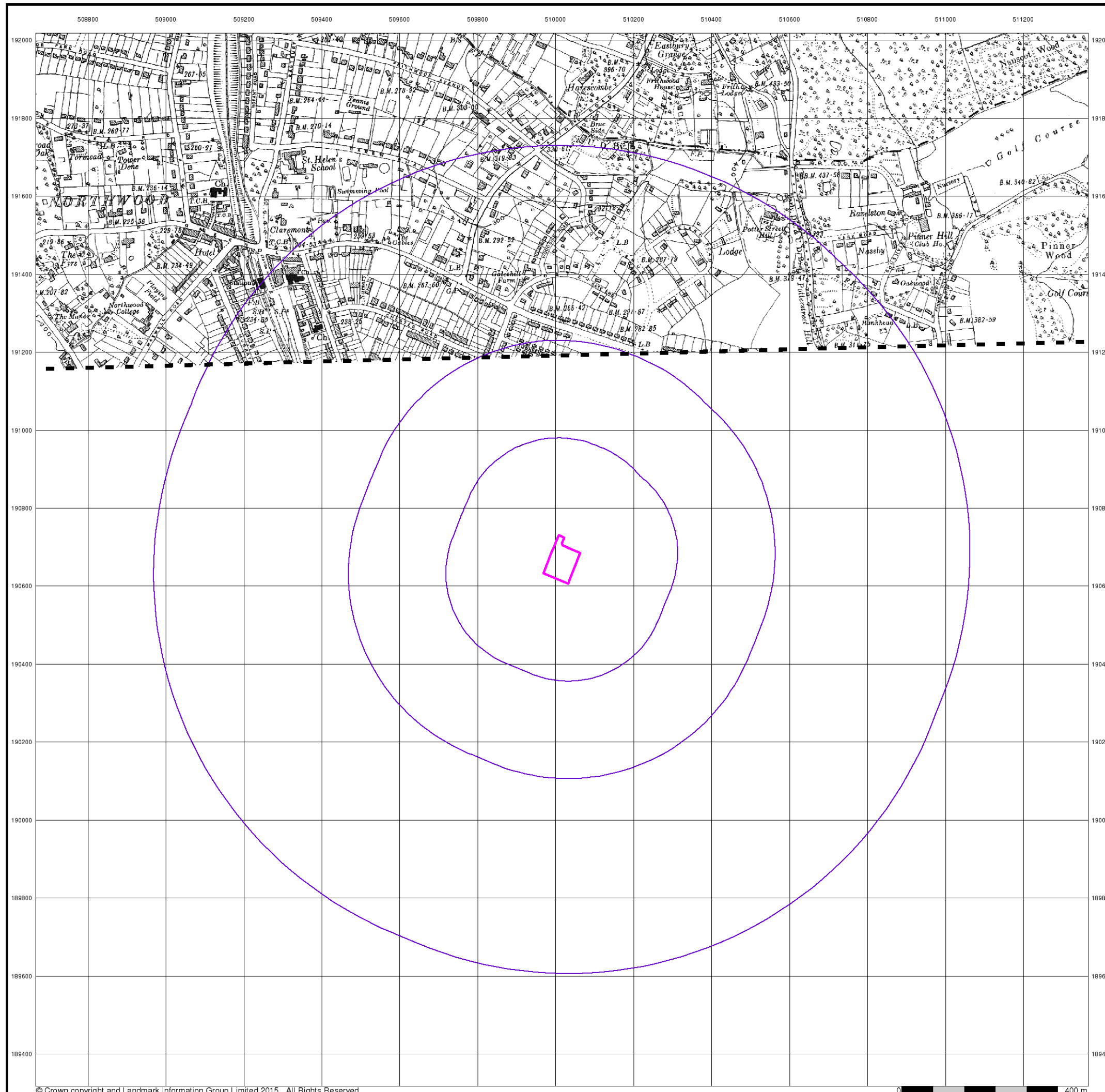





## Hertfordshire

Published 1938

Source map scale - 1:10,560

The historical maps shown were reproduced from maps predominantly held at the scale adopted for England, Wales and Scotland in the 1840's. In 1854 the 1:2,500 scale was adopted for mapping urban areas; these maps were used to update the 1:10,560 maps. The published date given therefore is often some years later than the surveyed date. Before 1938, all OS maps were based on the Cassini Projection, with independent surveys of a single county or group of counties, giving rise to significant inaccuracies in outlying areas. In the late 1940's, a Provisional Edition was produced, which updated the 1:10,560 mapping from a number of sources. The maps appear unfinished - with all military camps and other strategic sites removed. These maps were initially overprinted with the National Grid. In 1970, the first 1:10,000 maps were produced using the Transverse Mercator Projection. The revision process continued until recently, with new editions appearing every 10 years or so for urban areas.

### Map Name(s) and Date(s)

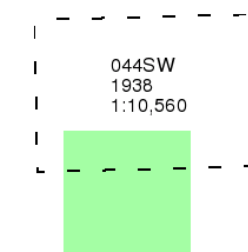

### Historical Map - Slice A

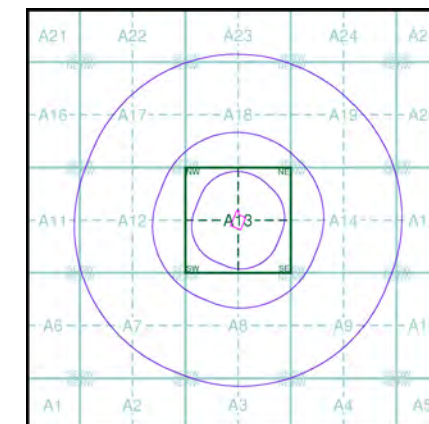

### Order Details

Order Number: 71541451\_1\_1  
Customer Ref: 35554/3501  
National Grid Reference: 510020, 190670  
Slice: A  
Site Area (Ha): 0.62  
Search Buffer (m): 1000

### Site Details

Northwood & Pinner Hospital, Pinner Road, Northwood, HA6 1DE



Tel: 0844 844 9952  
Fax: 0844 844 9951  
Web: www.envirocheck.co.uk

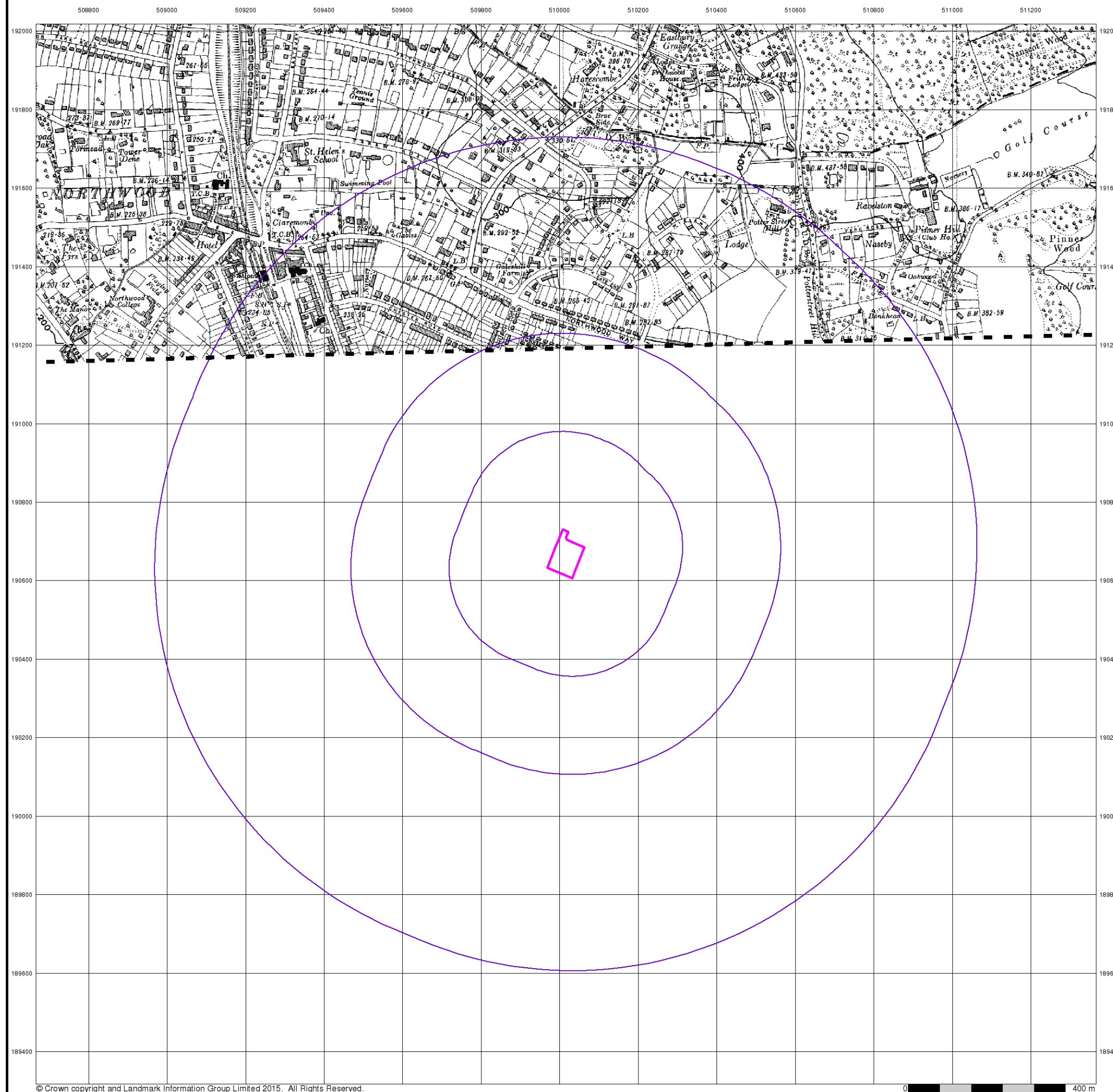



## Middlesex

Published 1938

Source map scale - 1:10,560

The historical maps shown were reproduced from maps predominantly held at the scale adopted for England, Wales and Scotland in the 1840's. In 1854 the 1:2,500 scale was adopted for mapping urban areas; these maps were used to update the 1:10,560 maps. The published date given therefore is often some years later than the surveyed date. Before 1938, all OS maps were based on the Cassini Projection, with independent surveys of a single county or group of counties, giving rise to significant inaccuracies in outlying areas. In the late 1940's, a Provisional Edition was produced, which updated the 1:10,560 mapping from a number of sources. The maps appear unfinished - with all military camps and other strategic sites removed. These maps were initially overprinted with the National Grid. In 1970, the first 1:10,000 maps were produced using the Transverse Mercator Projection. The revision process continued until recently, with new editions appearing every 10 years or so for urban areas.

## Map Name(s) and Date(s)

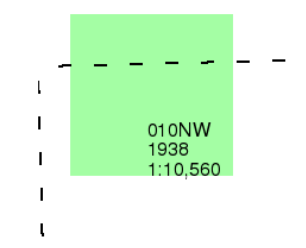

## Historical Map - Slice A

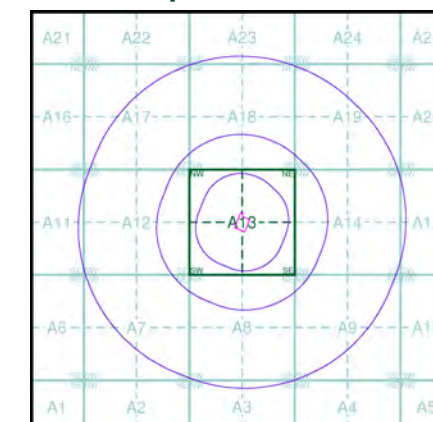

## Order Details

Order Number: 71541451\_1\_1  
Customer Ref: 35554/3501  
National Grid Reference: 510020, 190670  
Slice: A  
Site Area (Ha): 0.62  
Search Buffer (m): 1000

## Site Details

Northwood & Pinner Hospital, Pinner Road, Northwood, HA6 1DE

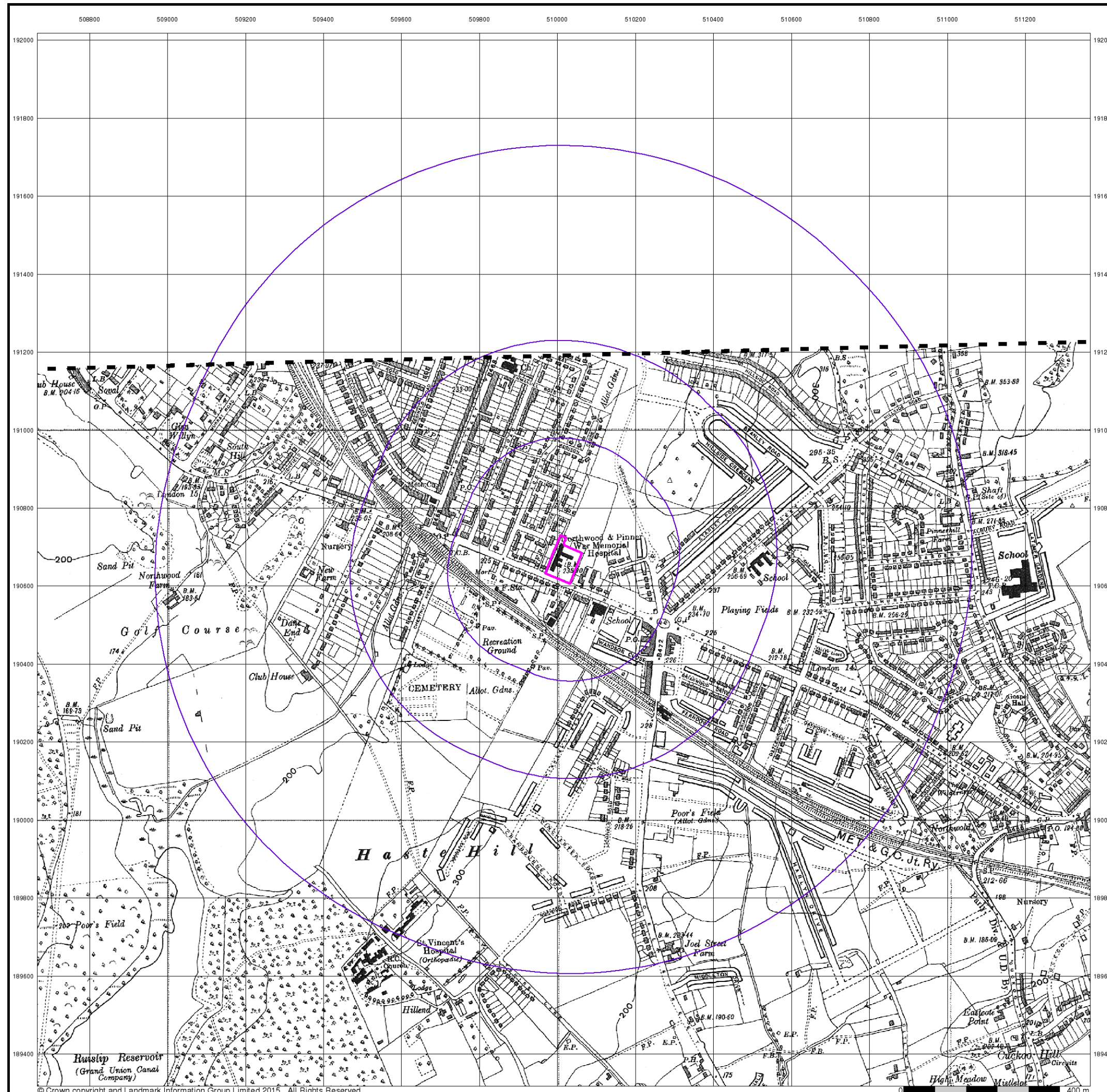





## Historical Aerial Photography

Published 1948 - 1950

Source map scale - 1:10,560

The Historical Aerial Photos were produced by the Ordnance Survey at a scale of 1:1,250 and 1:10,560 from Air Force photography. They were produced between 1944 and 1951 as an interim measure, pending preparation of conventional mapping, due to post war resource shortages. New security measures in the 1950's meant that every photograph was re-checked for potentially unsafe information with security sites replaced by fake fields or clouds. The original editions were withdrawn and only later made available after a period of fifty years although due to the accuracy of the editing, without viewing both revisions it is not easy to spot the edits. Where available Landmark have included both revisions.

© Landmark Information Group and/or Data Suppliers 2010.

### Map Name(s) and Date(s)

TQ09SE 1948 1:10,560	TQ19SW 1948 1:10,560
TQ08NE 1948 1:10,560	TQ18NW 1950 1:10,560

### Historical Aerial Photography - Slice A

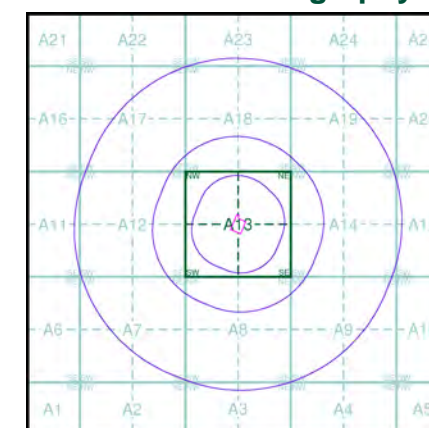

### Order Details

Order Number: 71541451\_1\_1  
Customer Ref: 35554/3501  
National Grid Reference: 510020, 190670  
Slice: A  
Site Area (Ha): 0.62  
Search Buffer (m): 1000

### Site Details

Northwood & Pinner Hospital, Pinner Road, Northwood, HA6 1DE



Tel: 0844 844 9952  
Fax: 0844 844 9951  
Web: [www.envirocheck.co.uk](http://www.envirocheck.co.uk)

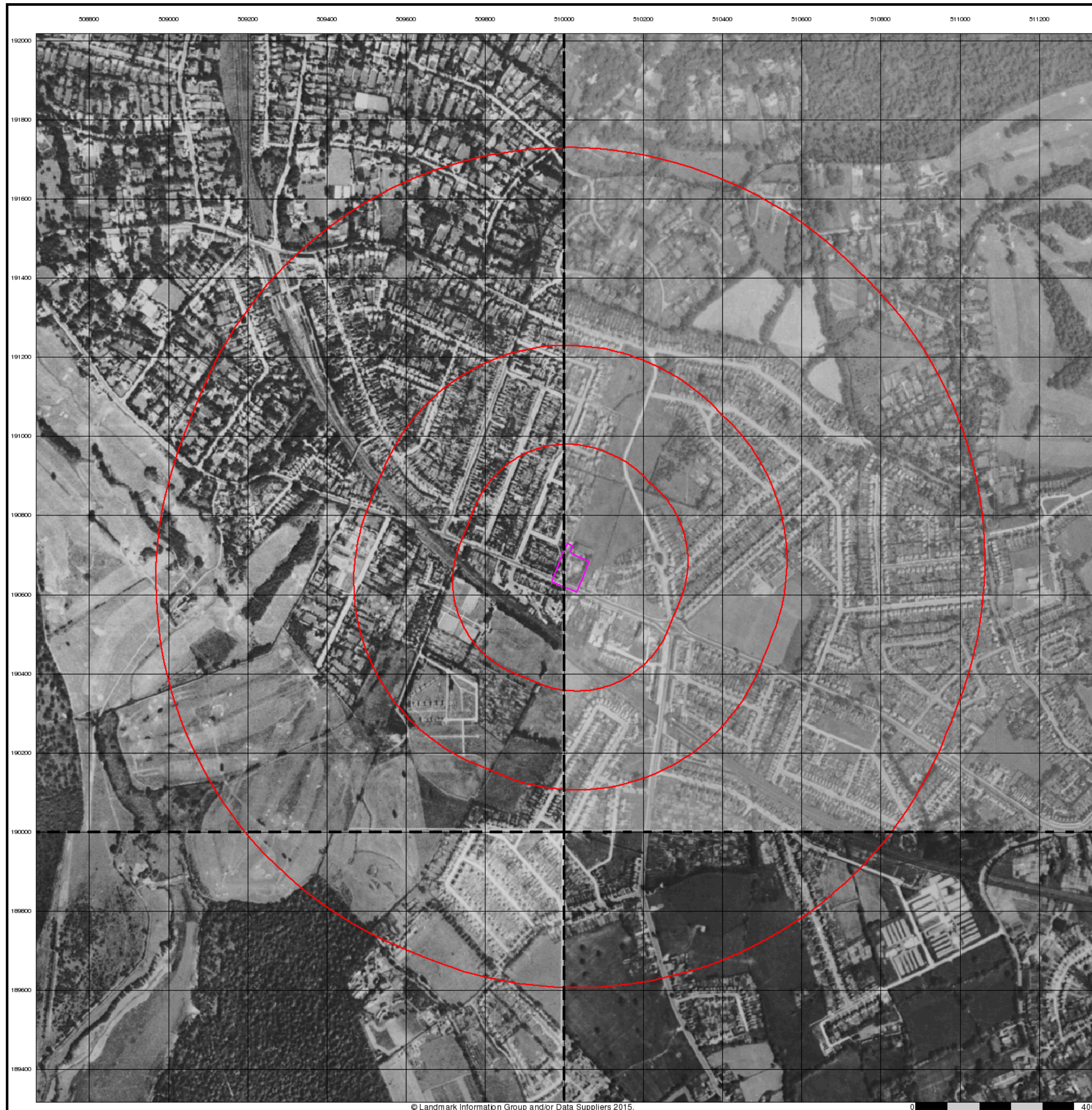





## Ordnance Survey Plan

Published 1960

Source map scale - 1:10,000

The historical maps shown were reproduced from maps predominantly held at the scale adopted for England, Wales and Scotland in the 1840's. In 1854 the 1:2,500 scale was adopted for mapping urban areas; these maps were used to update the 1:10,560 maps. The published date given therefore is often some years later than the surveyed date. Before 1938, all OS maps were based on the Cassini Projection, with independent surveys of a single county or group of counties, giving rise to significant inaccuracies in outlying areas. In the late 1940's, a Provisional Edition was produced, which updated the 1:10,560 mapping from a number of sources. The maps appear unfinished - with all military camps and other strategic sites removed. These maps were initially overprinted with the National Grid. In 1970, the first 1:10,000 maps were produced using the Transverse Mercator Projection. The revision process continued until recently, with new editions appearing every 10 years or so for urban areas.

### Map Name(s) and Date(s)

TQ09SE	TQ19SW
1960	1960
1:10,560	1:10,560
I	
TQ08NE	TQ18NW
1960	1960
1:10,560	1:10,560

### Historical Map - Slice A

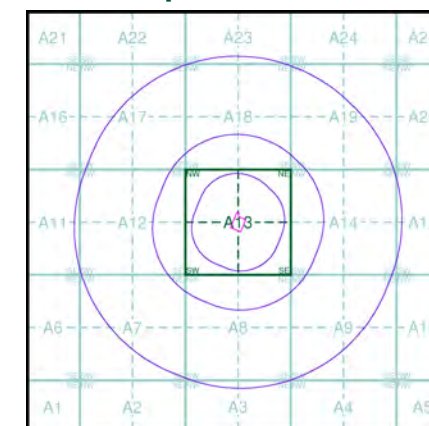

### Order Details

Order Number: 71541451\_1\_1  
Customer Ref: 35554/3501  
National Grid Reference: 510020, 190670  
Slice: A  
Site Area (Ha): 0.62  
Search Buffer (m): 1000

### Site Details

Northwood & Pinner Hospital, Pinner Road, Northwood, HA6 1DE



Tel: 0844 844 9952  
Fax: 0844 844 9951  
Web: www.envirocheck.co.uk





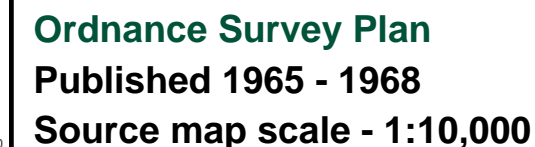

The historical maps shown were reproduced from maps predominantly held at the scale adopted for England, Wales and Scotland in the 1840's. In 1854 the 1:2,500 scale was adopted for mapping urban areas; these maps were used to update the 1:10,560 maps. The published date given therefore is often some years later than the surveyed date. Before 1938, all OS maps were based on the Cassini Projection, with independent surveys of a single county or group of counties, giving rise to significant inaccuracies in outlying areas. In the late 1940's, a Provisional Edition was produced, which updated the 1:10,560 mapping from a number of sources. The maps appear unfinished - with all military camps and other strategic sites removed. These maps were initially overprinted with the National Grid. In 1970, the first 1:10,000 maps were produced using the Transverse Mercator Projection. The revision process continued until recently, with new editions appearing every 10 years or so for urban areas.

TQ09SE	TQ19SW
1965	1968
1:10,560	1:10,560
TQ08NE	TQ18NW
1968	1966
1:10,560	1:10,560



Order Number: 71541451\_1\_1  
Customer Ref: 35554/3501  
National Grid Reference: 510020, 190670  
Slice: A  
Site Area (Ha): 0.62  
Search Buffer (m): 1000

Northwood & Pinner Hospital, Pinner Road, Northwood, HA6  
1DE

