

"The attached OS data has been purchased by Allies and Morrison, who have a license to use it. We are forwarding it to you for use on 17115 NHS Northwood and Pinner sites only and subject to your agreement that you will use it for this project only".

KEY
Planning Application boundary

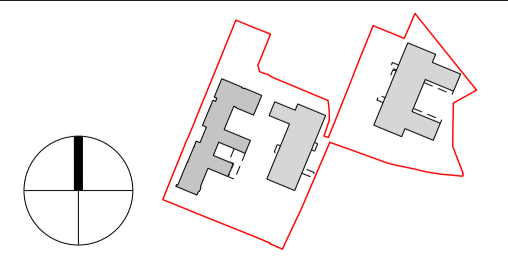

Figured dimensions are in millimetres unless noted otherwise. All dimensions and levels shall be verified on site before proceeding with works. Detailed site survey to be carried out to verify positions and level relationships with site features and outcrops survey. The Architect must be notified of any discrepancy. Boundaries are indicative only and are to be verified by others.

Allies & Morrison LLP is not responsible for any errors caused by the transmission, translation, software or computer systems. Allies & Morrison LLP is not responsible for nor shall be liable for the consequences of any use made of the drawings or models other than that for which they were produced by Allies & Morrison LLP for the Client. All Intellectual Property Rights reserved.

REV	DATE	DESCRIPTION	CD
P1	12.03.2021	ISSUED FOR PLANNING	AO

Allies and Morrison LLP
85 Southwark Street
London SE1 0HX
020 7921 0100
020 7921 0101
studio@alliesandmorrison.com
A&M JOB NO: 17115_05

NHS - NORTHWOOD AND PINNER, LONDON
SITE LOCATION PLAN
PLANNING
17115_05_00_07_001
SCALE 1:1250 @A1 1:2500@A3

P1
Revision