

DIMENSIONS IN MILLIMETRES-UNLESS STATED

DO NOT SCALE DRAWING - IF IN DOUBT ASK

3rd ANGLE PROJECTION

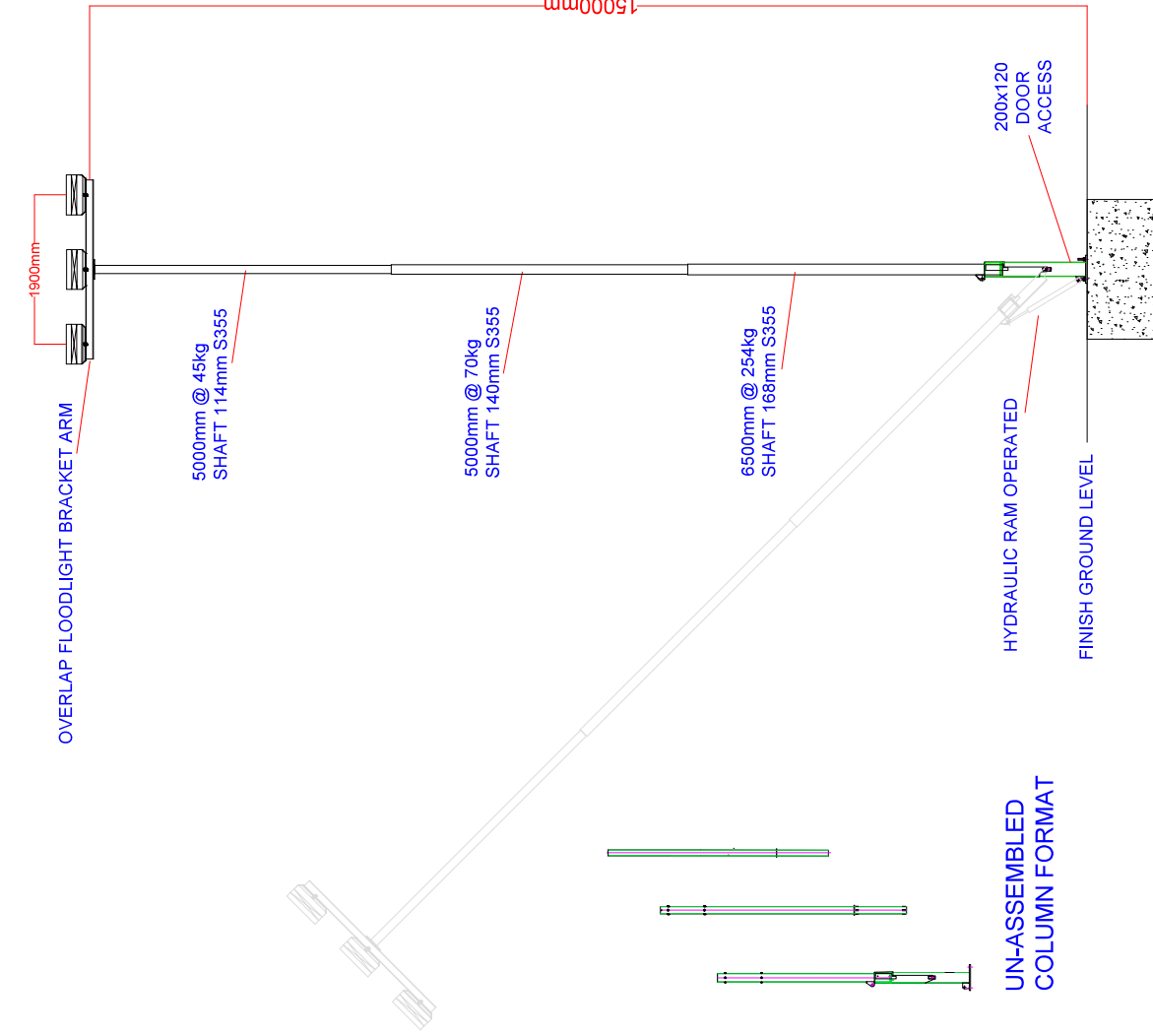
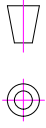

DESIGN PARAMETERS:	15m ABOVE GROUND
ALTITUDE ABOVE SEA LEVEL:	200m
BASIC WIND SPEED:	25.0m/s
TERRIAN CAT:	I

FLOODLIGHT SETUP:	3No
TOTAL WIND AREA:	0.68m ²
TOTAL HEAD WEIGHT:	116KG

*** ABOVE INCLUDES WEIGHT OF FLOODLIGHT BRACKET ARM ***

MOMENT AT GROUND LEVEL:	40.32kNm
SHEAR AT GROUND LEVEL:	3.96 kN
WEIGHT OF MAST:	369KG

*** FIGURES ARE BASED ON UNFACTORED ***

FOUNDATION DRAWING:	OLKF-FCT-M30-400
FOUNDATION STUDDING:	M30 GRADE 8.8
STUDDING CENTRES:	

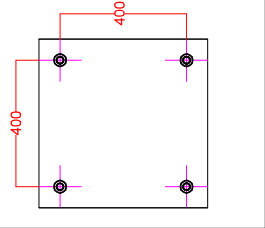

LOWERING TOOL CODE:	KF-HYBHSF-1
PRESSURE RATING:	200 BAR

NOTES

COLUMN DESIGNED TO CARRY 3 No FLOODLIGHTS ONLY - REFER TO ORDER SPECIFICATION
 COLUMN DESIGNED TO BE INSTALLED UPTO 200m ALTITUDE, 25m/s & TERRIAN CAT I
 GALVANISED TO BS EN 1461 STANDARDS
 TRAINED OPERATIVES TO OPERATE OLKF MAST RANGE ONLY, NO OTHER HYDRAULIC
 RAM UNIT TO OPERATE WITHOUT WRITTEN CONSENT FROM THE TECHNICAL
 DEPARTMENT.

FIRST ISSUE /1	DATE:12/7/17	MODIFICATION/2	DATE	MODIFICATION/2	DATE	DESCRIPTION
MODIFICATION /4	DATE	MODIFICATION /5	DATE	MODIFICATION /5	DATE	ARRANGEMENT OF 15m HYDRAULICALLY OPERATED LIGHTING COLUMN FLANGE MOUNTED ON SUNKEN BLOCK
						3No KINGFISHER FLOODLIGHTS ONLY

COPYRIGHT
 This drawing is the property of
 KINGFISHER LIGHTING. Drawings
 not to be reproduced without the
 written consent of KINGFISHER Ltd

DRG: OLKF-15LDBH

DRAWN BY: O.N. APPROVED BY: O.N.

CUSTOMER: KINGFISHER STANDARD

DATE: 11/09/2022 SCALE: ~1/-

Part of the LUCICO group of companies