

Block Plan
as Existing 1:200

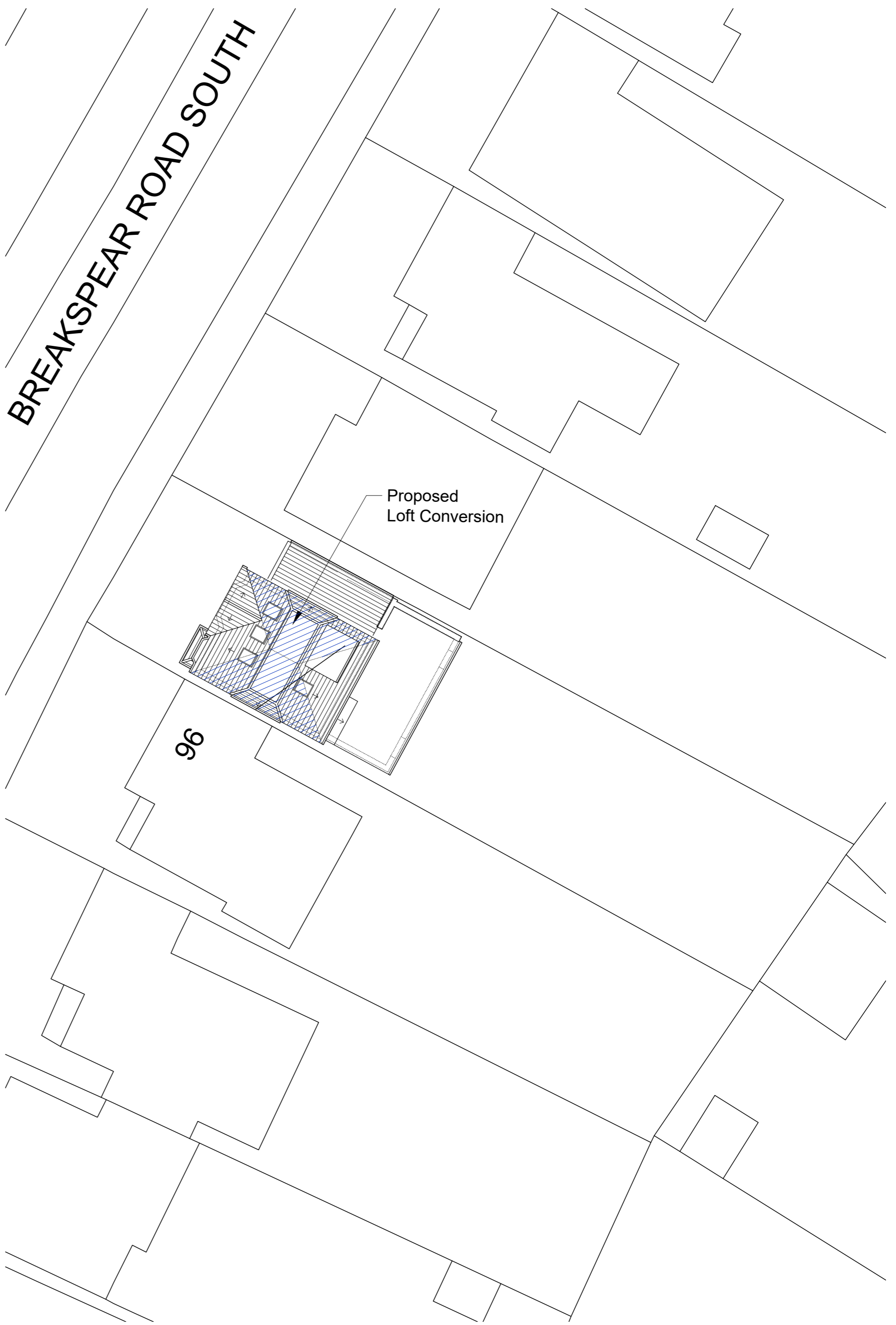

Block Plan
as Proposed 1:200

Issue:
LDC

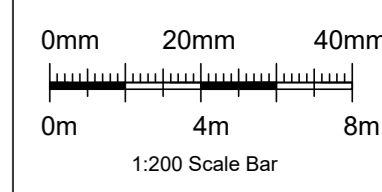

Revisions

Rev	Description	Drawn	Date

CG ARCHITECTS
 36 Canon Hill, Southgate, N14 6LG
 Tel: 020 8449 5100 | Fax: 020 8449 5170

Client:
Mr & Mrs Venizelou

Site:
98 Breakspear Road South
Uxbridge
UB10 8HF

Title:
Block Plan
as Existing and Proposed

Scale: 1:200 @ A2	Drawn: RG	Checked: CG
Date: Apr. 2026		

Dwg. No. 1719/11	Rev. #
---------------------	-----------