



Slim line frame for pitched roof. Reset within roof tiles. Can be fixed to roof pitch as low as 12 deg. & as high as 90 deg.

#### ROOF LIGHTS on pitch roof

Rooflights to be double glazed + to meet 'U' value of min. 2.0 W/m sq.K. All roof lights to be A-A fire rated.

Double up rafters on the side of opening, supporting double trimmers above & below opening. Bolt together with M12 bolts at 450 c/s. Must be 450mm minimum clear opening with non opening fasteners.



#### FLAT ROOF LIGHT

VELUX or similar slim line aluminium roof light

To be double glazed + to meet 'U' value of min. 2.0W/m sq.K. All roof lights to be A-A fire rated.

Fully thermally broken construction.

Double up rafters on the side of opening, supporting double trimmers above & below opening. Bolt together with M12 bolts at 450 c/s.

Fixed in accordance with the manufacturers instructions.



New ground floor roof



New first floor roof



New dormer roof

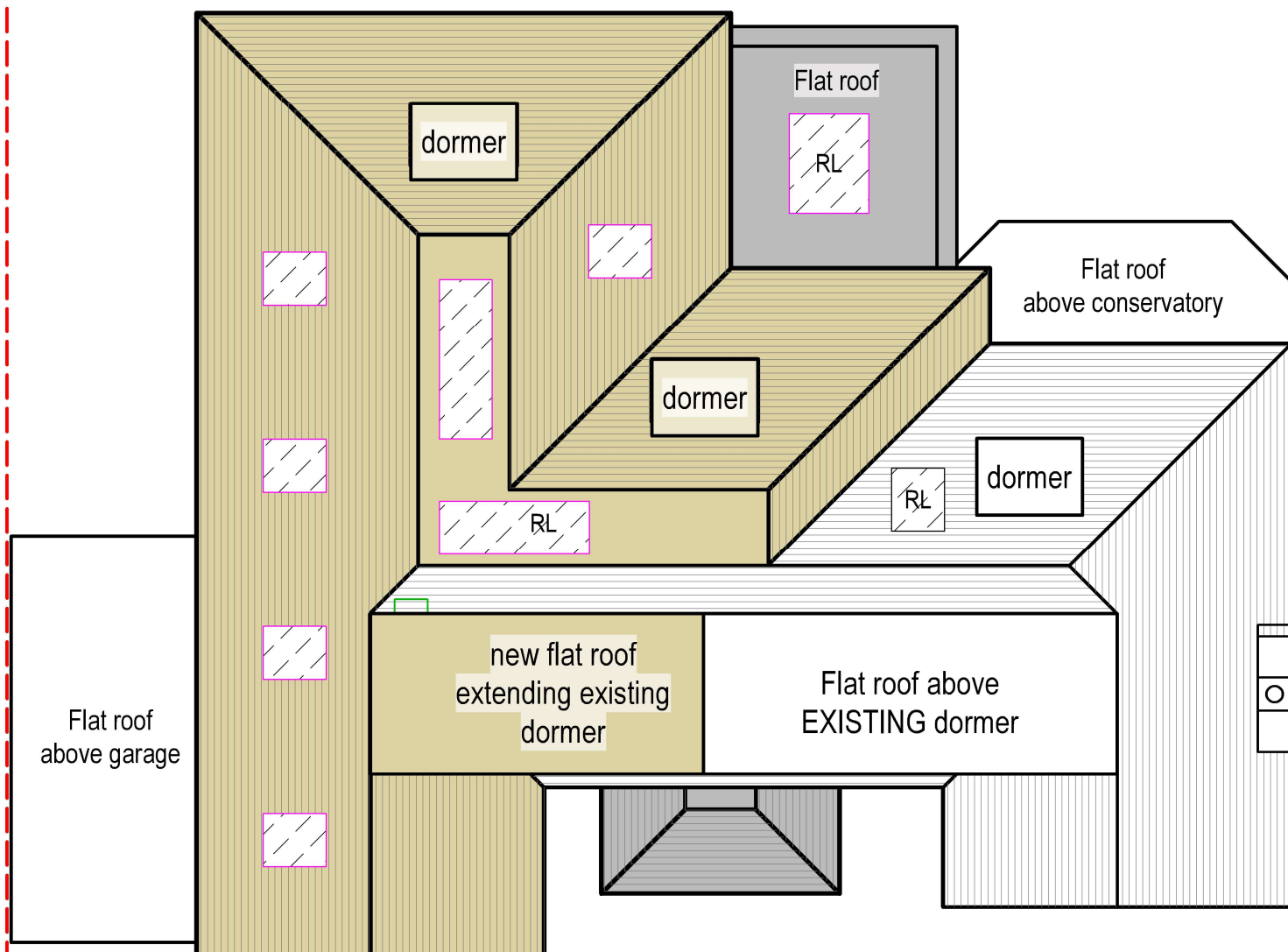

47 Nicholas Way

15

### PROP ROOF PLAN

Scale: 1:100



tel : 0796 222 3141  
email : sandeep@sskarchitects.co.uk

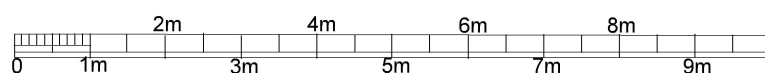

scale - 1 : 100 @ A3

REV A - 23/11/2024  
Conservatory note amended

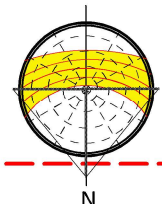

Purpose - Householder planning application

All dimensions to be checked on site.  
All omissions & discrepancies to be reported to the designer.

© SSK architects owns the copyright of this drawing which must not be reproduced in whole or part without the written permission.

PROJECT: 49 Nicholas Way,  
Northwood, HA6 2TR

DWG NO: **PROP ROOF**

**15**

DATE: 18/09/2024

REVISION: **A**

PROPOSED