

1:50

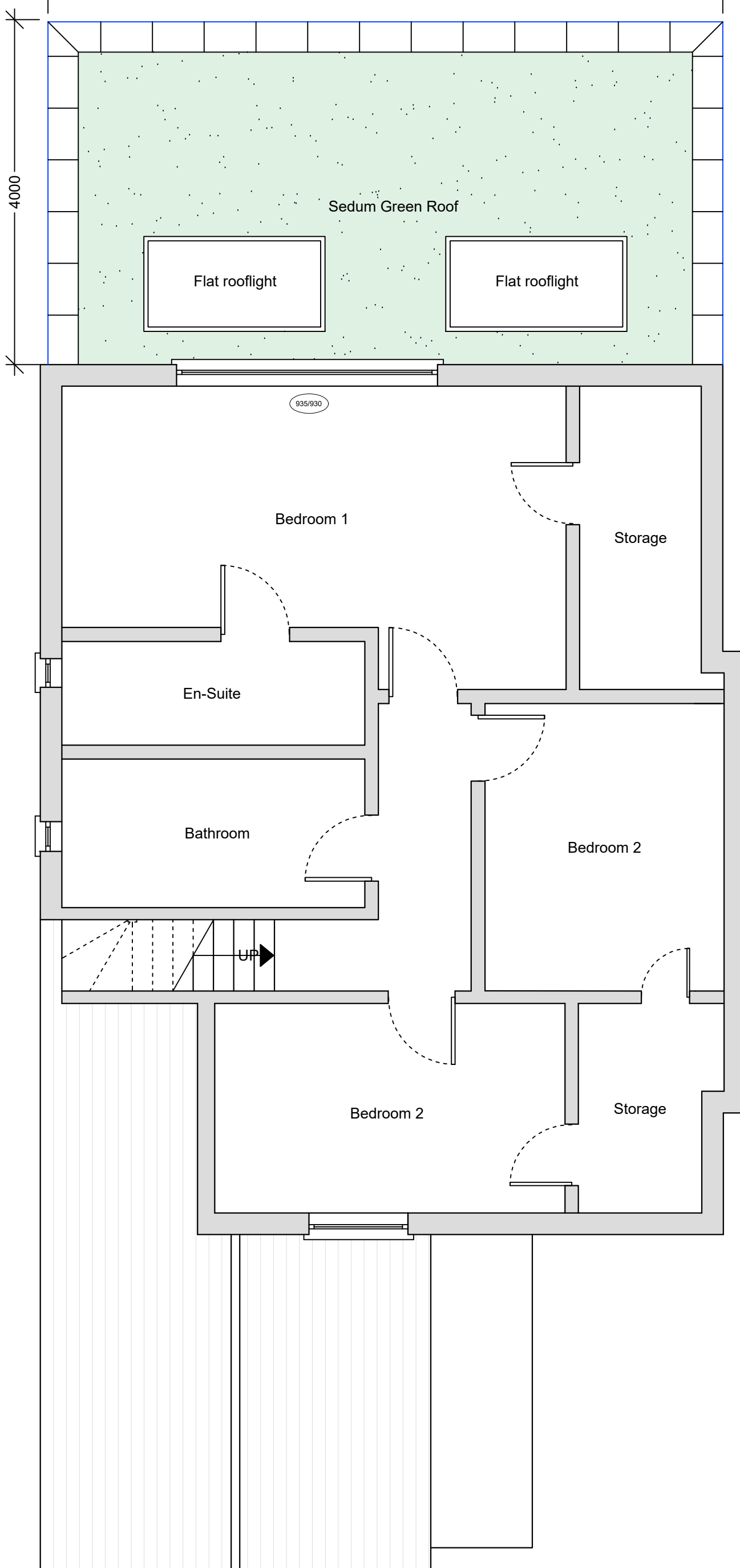
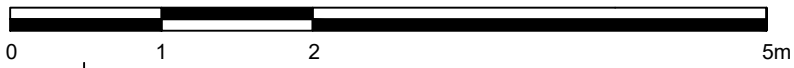

NOTES GENERAL:

- Work to figured dimensions and relative position only, confirm to designer
- This drawing is to be read in conjunction with all relevant drawings, detailed specifications where applicable and all associated drawings in this series (if any)
- Any discrepancy on this drawing is to be reported immediately to Oakman Architecture Ltd for clarification
- The contractor is responsible for all temporary works and for the stability of the works in progress

	10.04.26	BJS			
Revision	Date	Drawn	Designer	Checked	Approved

Revision History

OAKMAN ARCHITECTURE.

Address:
7 Denham Way,
Denham
UB9 5AX

Mob : 07787197752
E mail : benjamin@oakmanltd.com

Project Address:

42 Keswick Gardens
Ruislip
HA4 7XN

Client:

Mr and Mrs Spitz

PROPOSED

Drawing Number:	Scales:	Rev. No.
2532-PL-102	1:50 © A3	A

○ First Floor Plan
1:50