

COPYRIGHT DO NOT SCALE FROM THIS DRAWING. CONTRACTOR MUST CONFIRM SITE DIMENSIONS BEFORE COMMENCEMENT OF WORK. THIS DRAWING OR DESIGN IS THE COPYRIGHT AND MAY NOT BE REPRODUCED WITHOUT WRITTEN CONSENT OF THE DESIGNER. CONTRACTOR RESPONSIBLE FOR CORRECT SETTING OUT ON SITE. ANY DISCREPANCIES TO BE NOTED TO THE DESIGNER IMMEDIATELY.		
MARKED	REVISION	DATE
A		

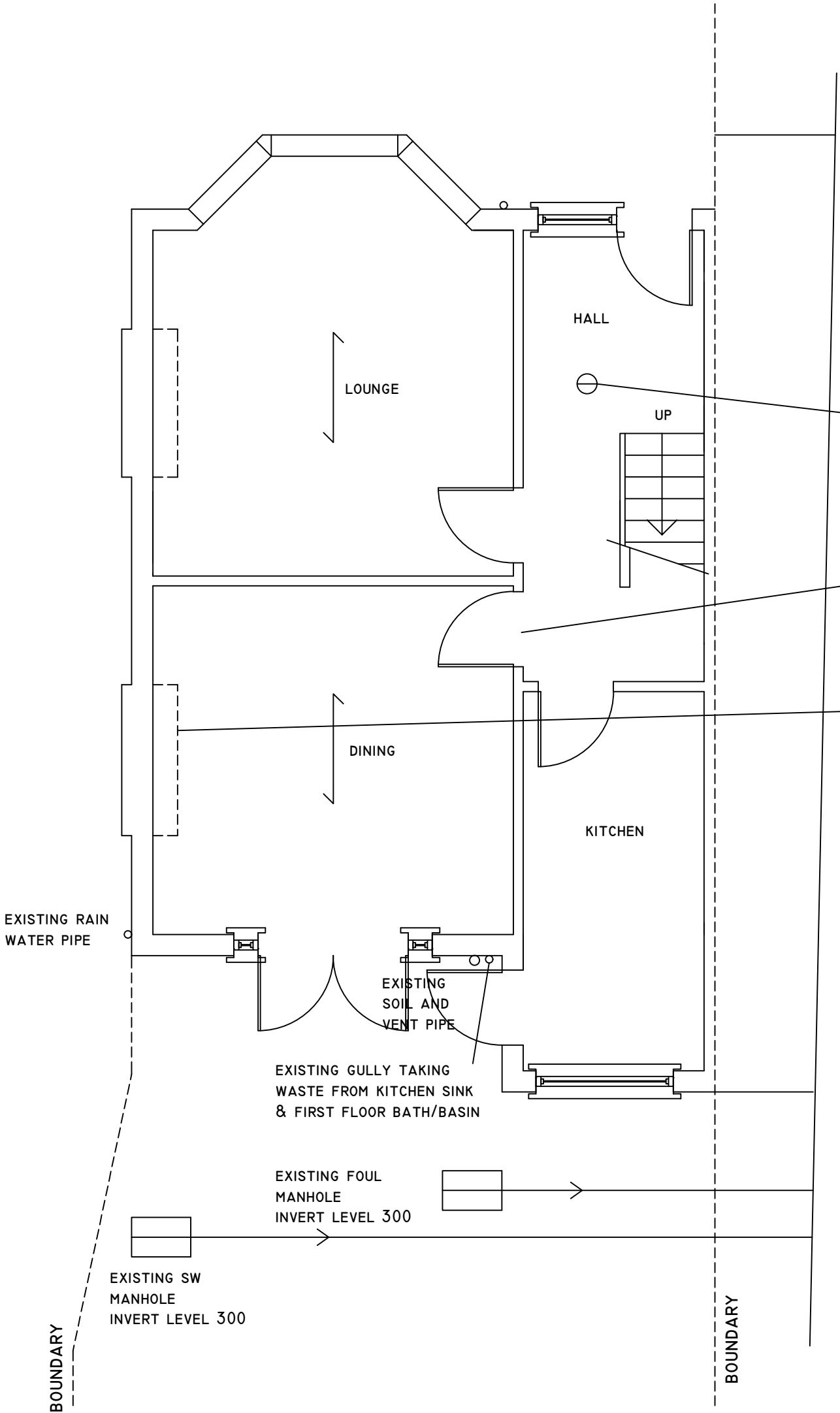

PROVIDE AT EACH LANDING SELF CONTAINED SMOKE DETECTORS PERMANENTLY WIRED TO A SEPARATELY FUSED CIRCUIT AT THE DISTRIBUTION BOARD WITH BATTERY BACK UP, SMOKE ALARMS TO BE LINKED AND DENOTED THUS:- Ø SMOKE ALARMS TO COMPLY WITH BS 5446;PART I

EXISTING DOORS CHANGED TO HALF HOUR FIRE DOORS FD30 -AT FIRST AND GROUND FLOOR LEVEL THAT OPEN ONTO STAIRS INCLUDING BATH AND W.C.

REMOVE INTERNAL FRONT AND REAR CHIMNEY BREAST AT GROUND AND FIRST FLOOR LEVEL AND THE STACKS ABOVE ROOF LEVEL AND INCLUDING CONCRETE HEARTH, INFILL FLOOR AND CEILING JOISTS TO MATCH EXISTING, 12.5MM PLASTER BOARD CEILING AND SKIM MAKE GOOD DISTURBED WALL SURFACE WITH 2 COATS SAND AND CEMENT RENDER WITH SKIM FINISH

ALL STEELWORK TO BE GRADE S275 AND PAINTED 2 COATS OF ZINC PHOSPHATE, CONCRETE FOR FOUNDATIONS TO BE GENI FOR MASS CONCRETE FOUNDATION DEPTH TO BE INSPECTED & APPROVED BY BUILDING INSPECTOR

PROPOSED GROUND FLOOR PLAN



CHECKED:	DATE: JAN 2026
DRAWN:	SCALE: 1:50
DRAWING NUMBER:	LI

DRAWING TITLE:
**PROPOSED GROUND
FLOOR PLAN**

PROJECT:
**38 VICTORIA AVENUE
HILLINGDON
UB10 9AH**