

SOAKWAYS attenuated crates

To be designed for 1m3 for every 16m2 of roof serving it.
Not less than 5 m. from buildings. Depth 600 mm below invertlevel of drains.
Use modular attenuation cells of lightweight plastic structure with a high void ratio.
Beneath the unit & on all sides provide 100mm of gravel and on top 500mm cover including 100mm gravel layer.
Size of the hole to be 1600mm deep and 1200mm sq.
Pipe to 100mm dia. and 1: 40 fall.
Where the pipe enters the soakaway it should be surrounded by gravel.

All to meet building inspectors approval on site.

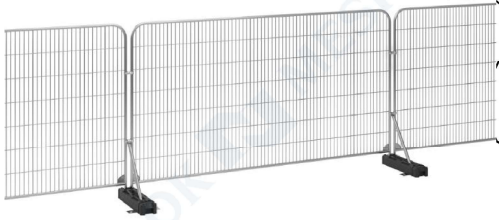

Tree T1, T2, T3, T4 and T18 to be removed.
Refer to ARB report

NEIGHBOURS HOUSE
Feldon

There are no side windows on the two storey element for neighbours property "Feldon"
Please refer to photo on drawing number 10.

Rear access for piling machine
First method
Mini piling machine will be used and will be brought in by taking down the fence between the neighbour "Feldon" house.
All in agreement with the neighbour.
After completing the works the area will be made good and the existing fence will be replaced.

Second method
Mini piling machine will be lifted up over the house by a crane

SSK ARCHITECTS

tel : 0796 222 3141
email : sandeep@sskarchitects.co.uk

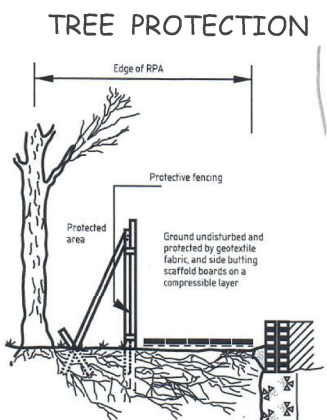
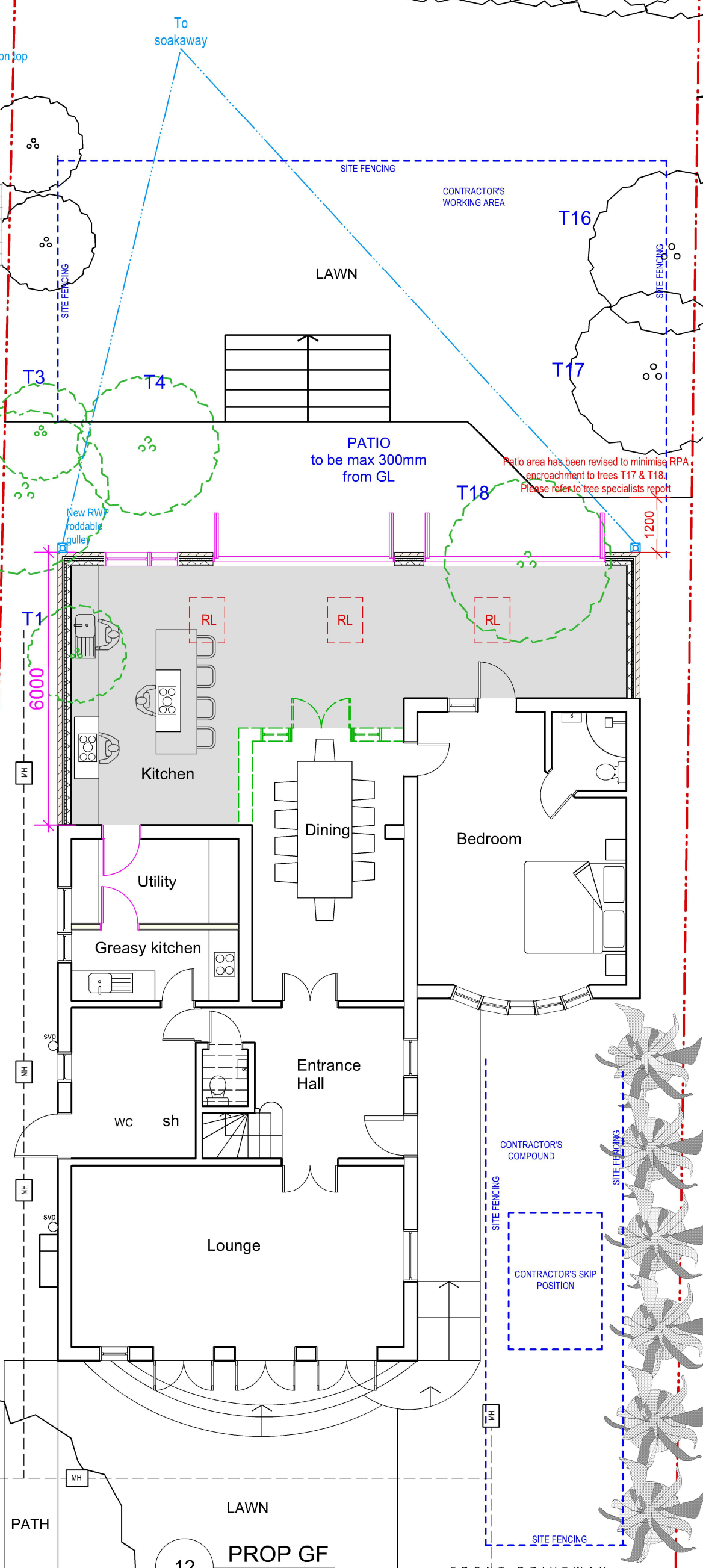

- TREE PROTECTION**
- 2m high Heras fencing to be provided around tree and must be in place until all construction and hard surfacing is complete
 - No work to take place within fenced off area
 - Materials must be stored on existing hard surface and provision for spillage must be made
 - Cement/concrete mixing must take place over a suitable hard surface away from treezone

- TREE PROTECTION**
- The slope of ground should be taken into account so no material runs towards tree
 - Notice boards, cables or other services should not be attached to tree
 - Care should be taken when planning site to ensure wide or tall loads do not come into contact with retained tree

NEIGHBOURS HOUSE
32a Dene Road

- REV C - 02/11/22
Tree positions shown and notes added in red.
- REV B - 26/10/22
Patio area has been revised to minimise RPA encroachment to trees T17 & T18.
Please refer to tree specialists report
- REV A - 23/08/22
Tree protection information added

12

PROP GF
Scale: 1:100

0 1m 2m 3m 4m 5m 6m 7m 8m 9m

scale - 1 : 100 @ A3

Purpose - Householder planning application

All dimensions to be checked on site.
All omissions & discrepancies to be reported to the designer.

SSK architects owns the copyright of this drawing which must not be reproduced in whole or part without the written permission.

PROJECT
New Lodge, Dene Road,
Northwood, HA6 2DA

DWG NO:
PROP GF

DATE:
25/06/2022

REVISION:
12

C

PROPOSED