

EXISTING LOFT FLOOR PLANS
scale 1:100

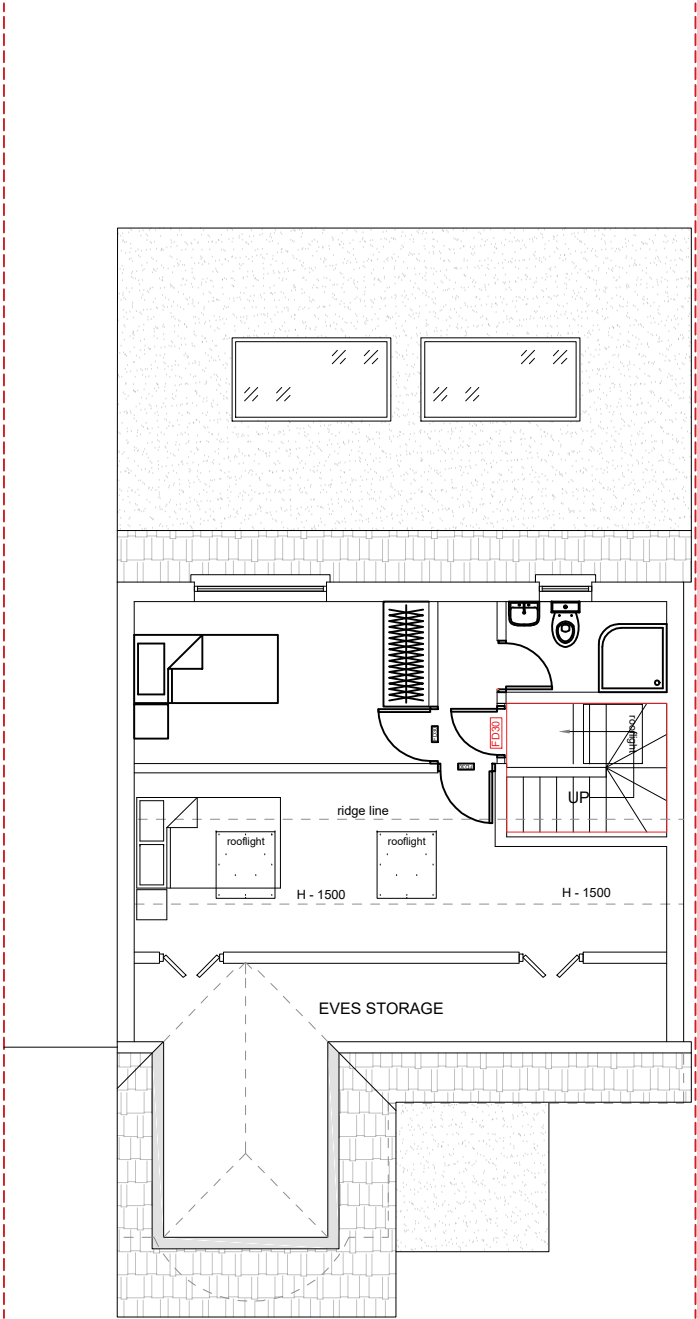

PROPOSED LOFT FLOOR PLANS
scale 1:100



Archibees

GENERAL NOTES

- All dimensions must be checked on site before any works commencement.
- All discrepancies must be reported to the Main Architect before works proceed.
- Only figured dimensions are to be used.
- Any conflict of given data on the drawing(s) with site condition to be discussed with the Architect
- The General Contractor and/or all Sub-contractors working according these drawings and specifications to contact the architect or representative if any measurements do not appear correct or unclear, add up properly or scale correctly to the indicated size upon approvals.

STRUCTURAL NOTES

All Structural Elements Spans must be measured on site before ordering.
This drawing must be read in conjunction with the Structural Engineer's Drawings, Calculations and other details.

All drawings to be read in conjunction with structural engineer's drawings and specifications.

Note: Accurate site dimensions are to be taken by the contractor on site prior to any construction commencing.

DRAWINGS:

PROPERTY ADDRESS

39 Woodford Crescent
HAS 3TZ

PROJECT

4m Single storey rear extension
Hip to Gable loft conversion
Porch

TITLE

Loft Floor Plans

DWG REF

FL26

DRAWING NO.

A003

REVISION	01	DATE	06/05/2025
REV	-	DRAWN	FF
REV	-	CHECKED	AP
REV	-	SCALE	1:100