

PROPOSED BLOCK PLAN
SCALE 1:500

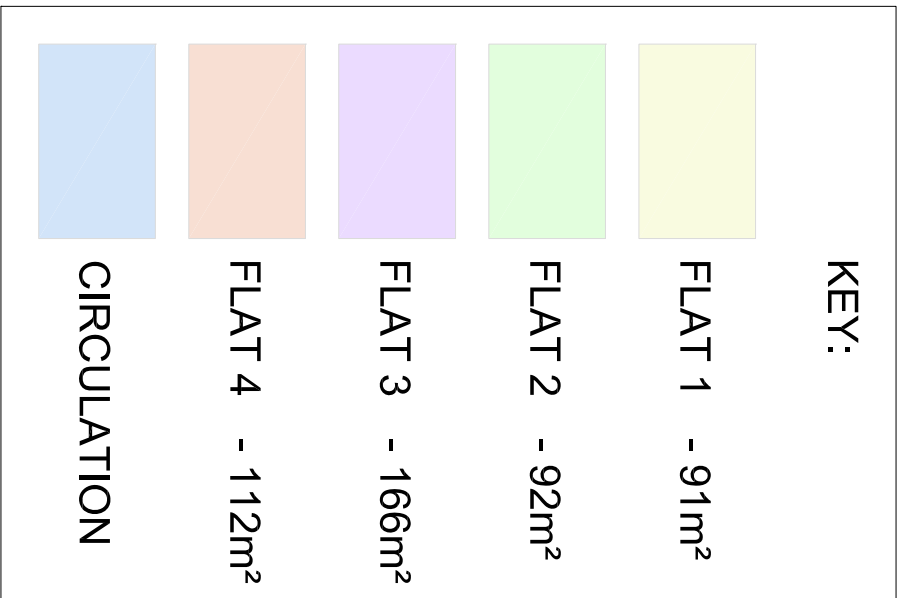

D	26/07/22	TO SUIT CASE OFFICER COMMENTS	BR
C	22/07/22	TO SUIT CASE OFFICER COMMENTS	BR
B	05/04/19	AMENDED TO PLANNERS COMMENTS	KP
A	28/01/18	AMENDED TO PLANNERS COMMENTS	KP
Rev	Date	Description	Int.

Client SUBACO PROPERTIES LTD

Project Title PROPOSED 4 APARTMENT BUILDING
12C MURRAY ROAD, NORTHWOOD HA6 2YJ
Drawing Title

PROPOSED FLOOR PLANS

Code	File	Sheet	Size	Scale
P001	A1	1	1:100	1:100
Drawn by	JUN 2018	Approved by	NJ	
Project No.	P301	Revision	D	

SCP ARCHITECTS LTD

ARGYLE HOUSE,
NORTHWOOD HILLS,
MIDDLESEX, HA6 1UN,
Telephone: 01823 840075
Email: info@scparchitects.co.uk

This drawing is property of SCP Architects Ltd © and must not be
reproduced or used in any way without the written consent of SCP
on site before commencing work. No dimensions to be scaled from
this drawing. This drawing was produced using AutoCad 2008.

PLANNING ISSUE

