

EXISTING SITE PLAN
Scale 1:200

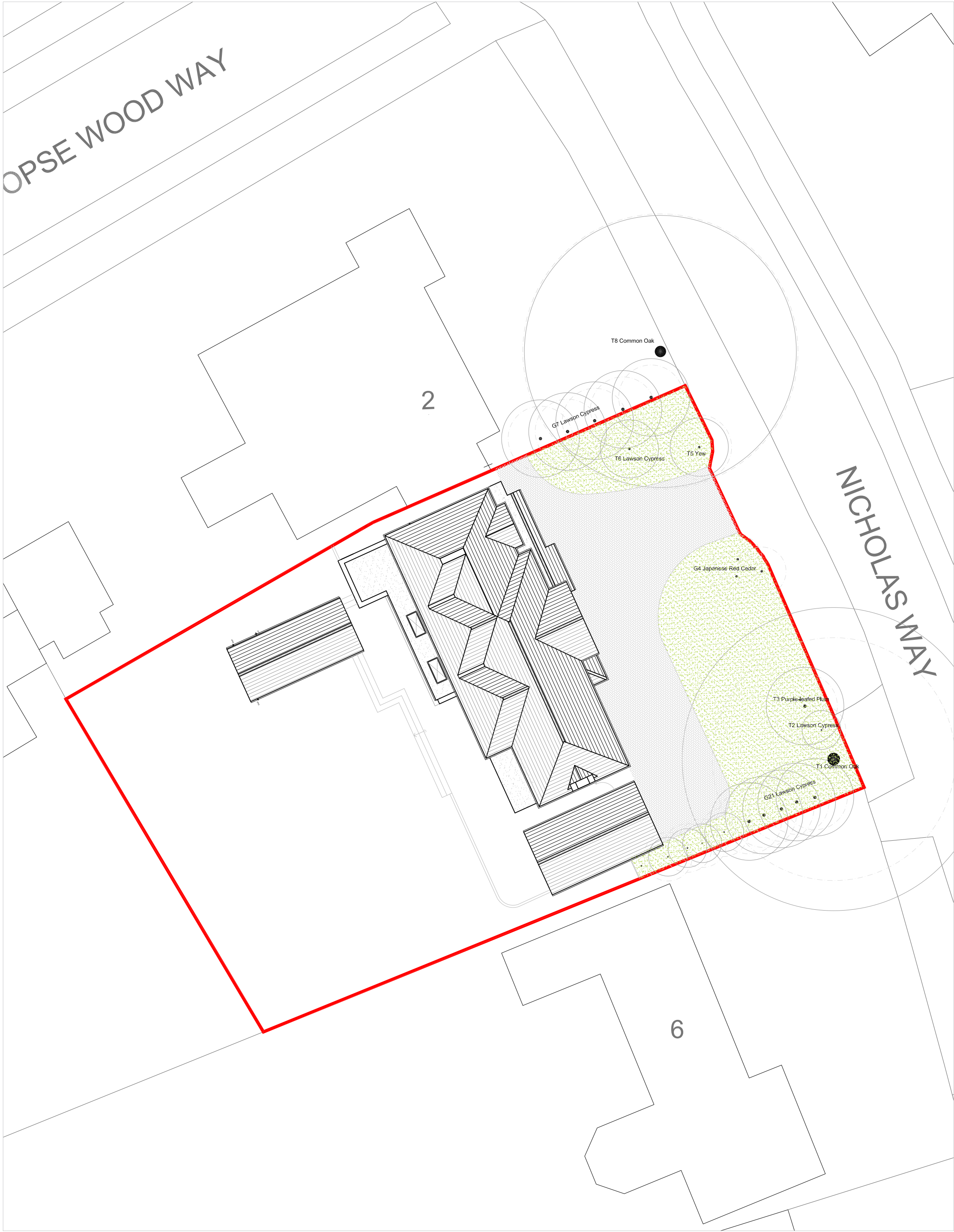

PROPOSED SITE PLAN
Scale 1:200

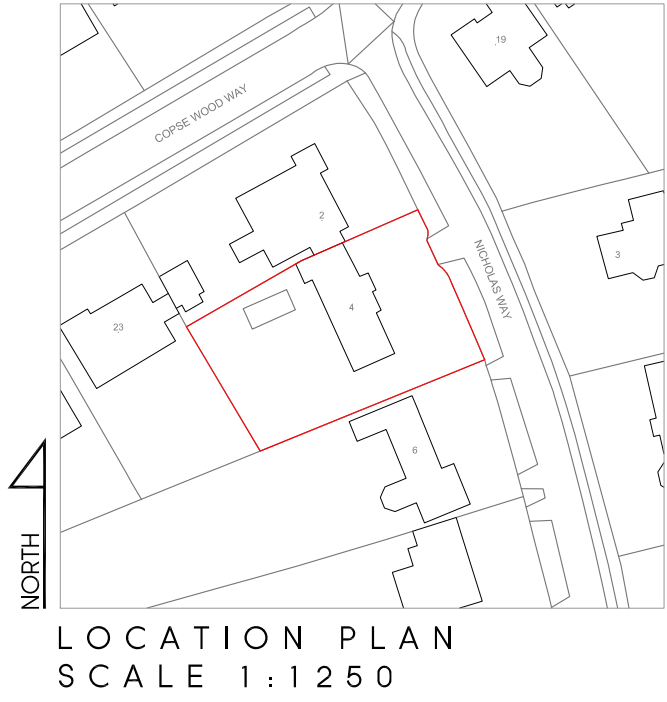

LOCATION PLAN
SCALE 1:1250

C	05.10.22	AMENDED TO SUIT PLANNERS COMMENTS	BR
B	10.05.22	AMENDED TO SUIT PRE-APP COMMENTS	BR
A	17.03.22	AMENDED TO SUIT PRE-APP COMMENTS	BR
Rev	Date	Description	Init.

Client
MR SRITHARAN

Project Title
PROPOSED EXTENSION AND ALTERATIONS

4 NICHOLAS WAY, NORTHWOOD, HA6 2TS
Drawing Title

EXISTING & PROPOSED SITE PLAN

Cad File	Sheet Size	Scale
P001	A1	1:200
Drawn by	Drawing Date	Approved by
AG	OCT 2021	NJ
Project No.	Drawing No.	Revision
1858	P201	C

Juttla Architects
2-4 High Street, Ruislip,
Middlesex, HA4 7AR
t 01923 840077 f 01923 840078
info@juttla-architects.com
juttla-architects.com

This drawing is property of Juttla Architects Ltd © and must not be copied or otherwise reproduced. All dimensions must be checked on site before commencing work. No dimensions to be scaled from this drawing. This drawing was produced using AutoCad 2016.