

PINN RIVER SEND SCHOOL

EXTERIOR FINISHES BOARD - BUILDING MATERIALS - Planning Reference No:2145/APP/2022/3534 Condition 16

January 2024



(2) (3) Buff brick - Sandalwood Yellow Multi  
Mortar- Braintree Light or similar



(2) (3) Mortar- Braintree Light or similar



(12) External signage - stainless steel individual lettering



(14) Glass balustrade panels to roof terraces -  
satin polish stainless steel top rail; laminated  
glass infills, opaque interlayer to glass infills  
around Plant Terrace



(19) Fibre cement panel to inner face of parapet -  
Anthracite 7020



(15) PPC aluminium teaching canopy - RAL 7030



(13) (11) Drop-off entrance canopy - glulam  
timber frame with light grey single ply  
roof membrane on timber deck



(4) (10) PPC aluminium - RAL 1006 Matt



(1) (5) (6) (7) (8) (9) (15) PPC aluminium - RAL 7030



North Elevation



South Elevation



East Elevation



West Elevation

EXTERIOR FINISHES

- 1 PPC aluminium coping
- 2 Buff Brick
- 3 Hit & miss buff brick screen
- 4 Coloured aluminium spandrel panel as part of window system
- 5 PPC aluminium window with aluminium louvre and / or opening lights
- 6 PPC aluminium door with glazed infill panels with fixed / opening light above
- 7 PPC aluminium door with glazed infill panels with fixed/ opening light above to side, with PPC aluminium louvre
- 8 PPC aluminium solid / louvred doors
- 9 PPC aluminium curtain wall framing system
- 10 Colour aluminium spandrel panel as part of curtain walling system
- 11 Timber columns/fins supporting drop-off canopy
- 12 Proposed signage - stainless steel individual lettering
- 13 Drop-off entrance canopy
- 14 Glass balustrade panels to roof terraces
- 15 PPC metal external teaching canopy
- 16 Self-weighted metal guardrail to roof
- 17 Photovoltaic array
- 18 Metal step - over ladder



PINN RIVER SEND SCHOOL

EXTERIOR FINISHES BOARD - BOUNDARY TREATMENTS - Planning Reference No:2145/APP/2022/3534 Condition 16

January 2024

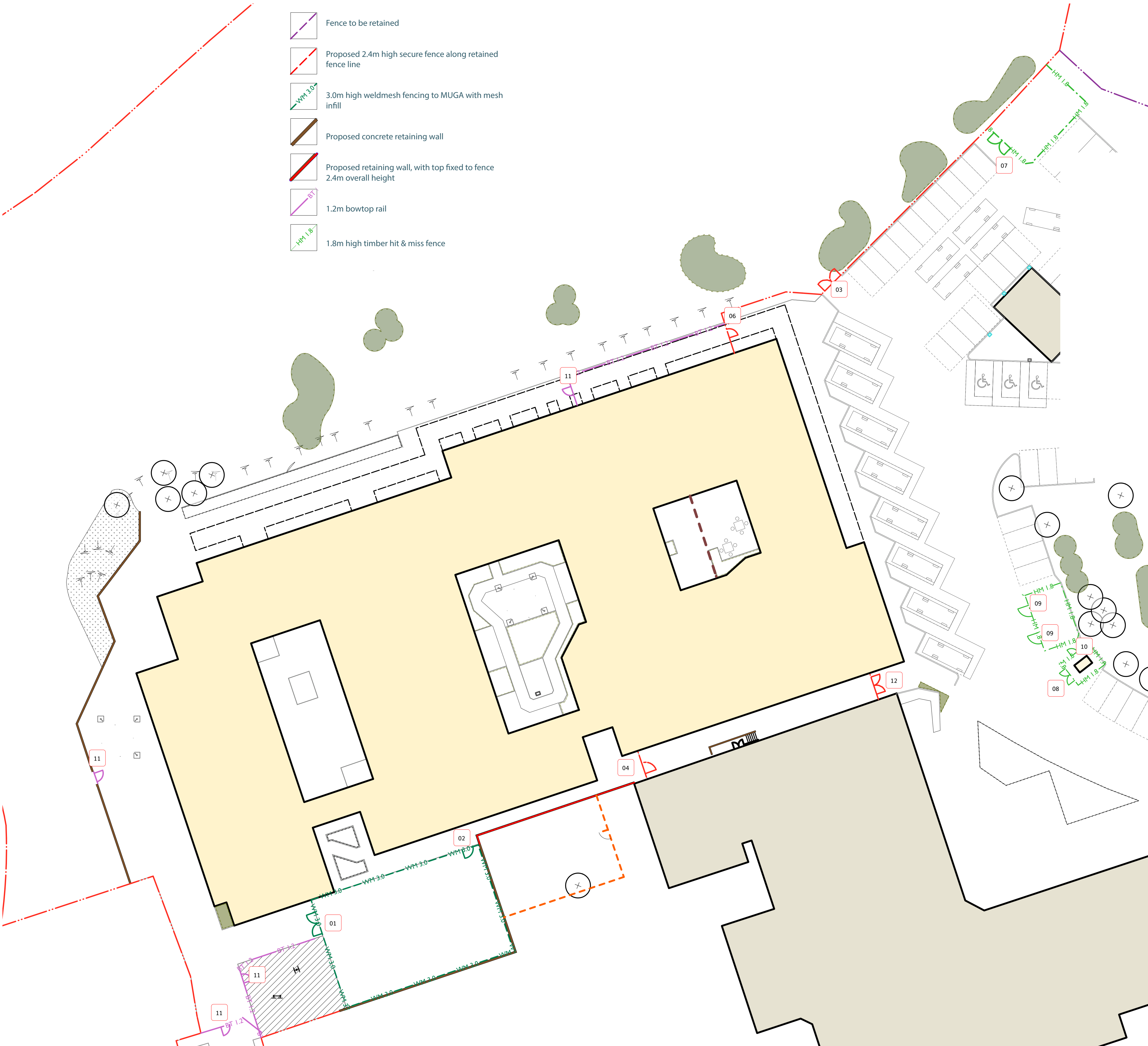

Proposed 2.4m high secure fence along retained fence line

- Zaun Hi Sec 358 or equal.
- 76.2x12.7 mesh pattern, 4mm horizontal and vertical wires.
- Galvanized rectangular hollow section posts, plastic coated RAL 6003 (Olive Green).



3.0m high weldmesh fencing to MUGA with mesh infill and 1.2m high rebound panel to bottom of fence and gate panels

- To MUGA
- Zaun Duo 8 Sports or equal.
- Welded mesh, 200mm vertical x 50mm horizontal x 6mm vertical wire diameter
- Galvanized rectangular hollow section posts, plastic coated RAL 6003 (Olive Green)
- Dye sub printed poly engineered eco airmesh hemmed reinforced webbing to full length of 3.0m high weldmesh fence.



1.2m bowtop rail

- To playgrounds
- 16mm diameter round vertical bars with bow tops
- Polyester powder coated in Black



1.8m high timber hit & miss fence

- To sprinkler tank, bin store and generator unit
- Treated softwood timber hit and miss fencing
- Square edge boards planed and coated with light oak wood stain.