

Trenches adjacent to or below foundations

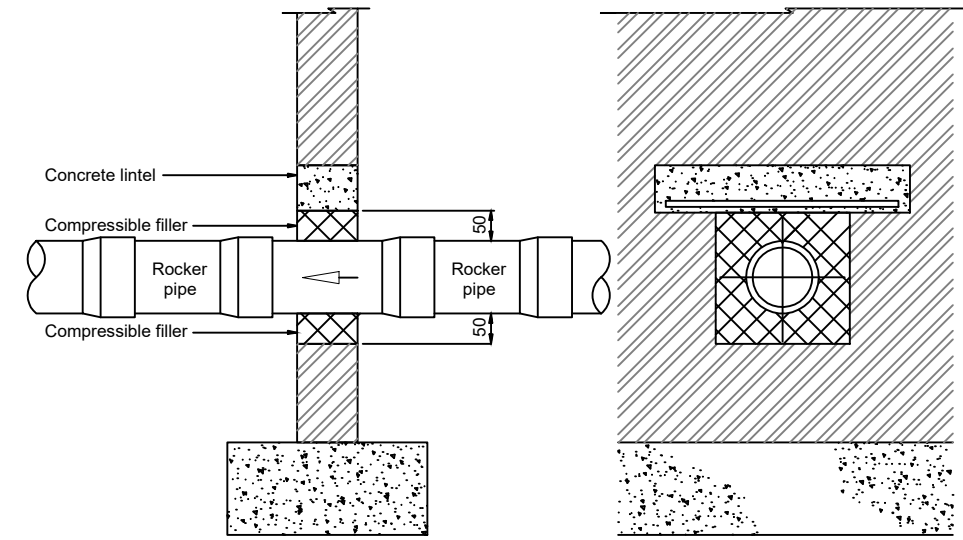

Protection of pipes penetrating single leaf boundary walls

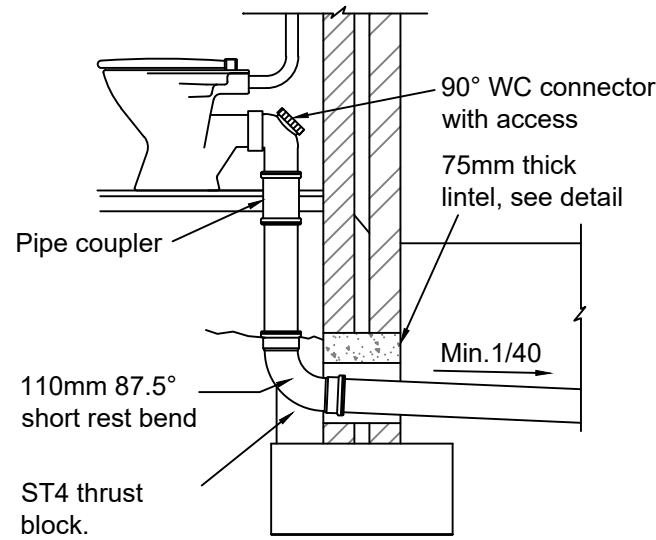

WC connection direct to drain

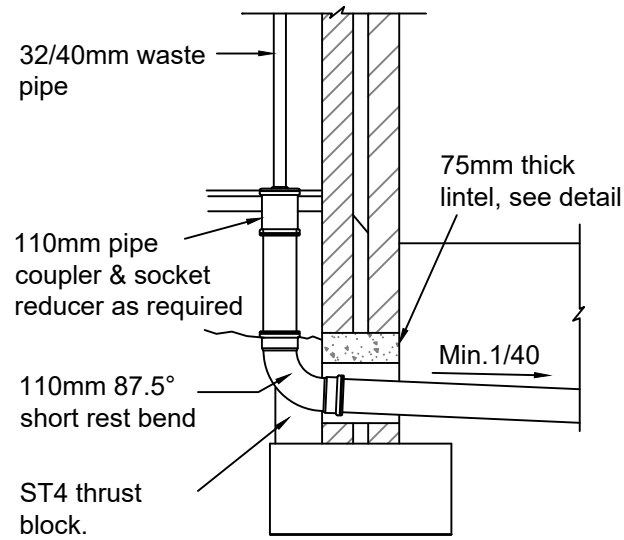

Internal waste pipe connection

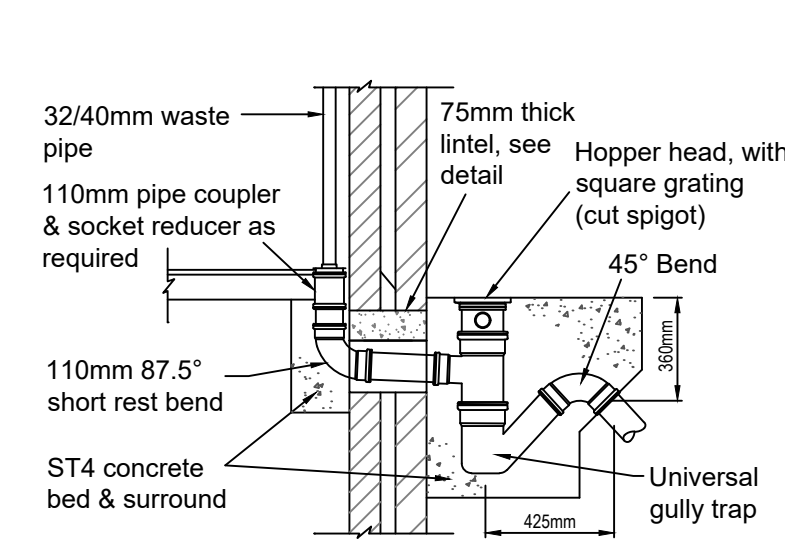

Back Inlet Gully (Universal Type)

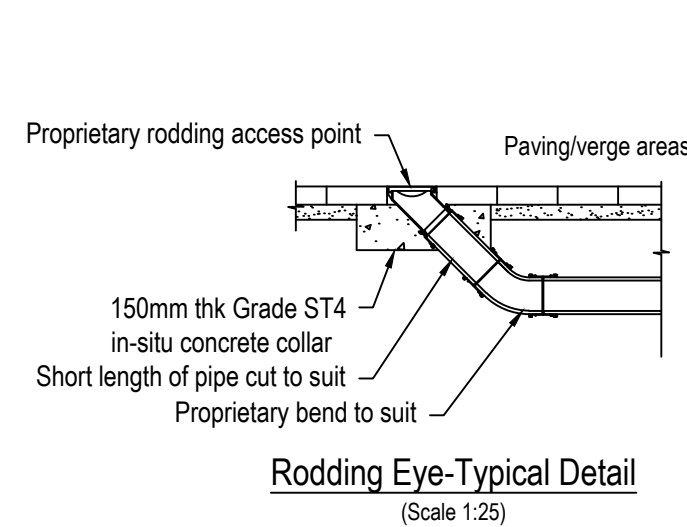

Rodding Eye-Typical Detail

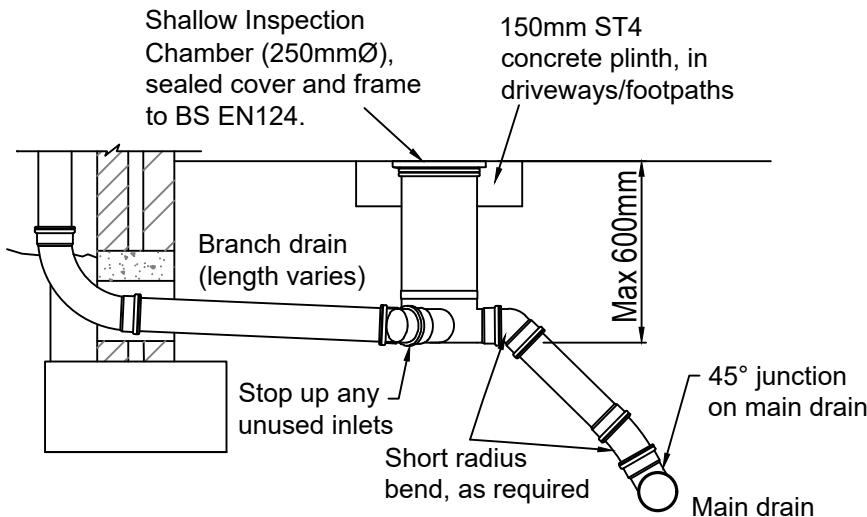

Typical section shallow inspection chamber

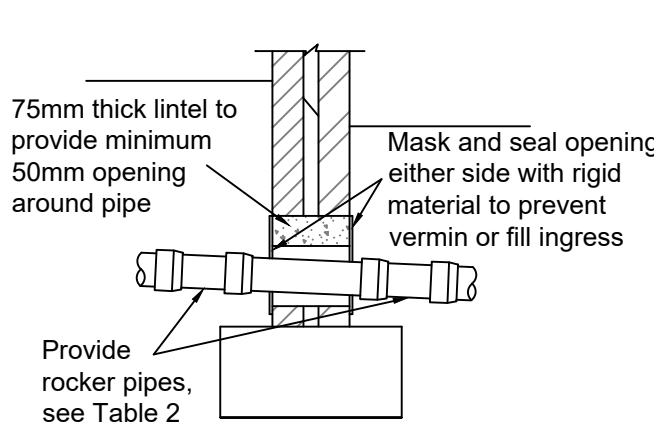

Pipes through walls (lintelled opening)

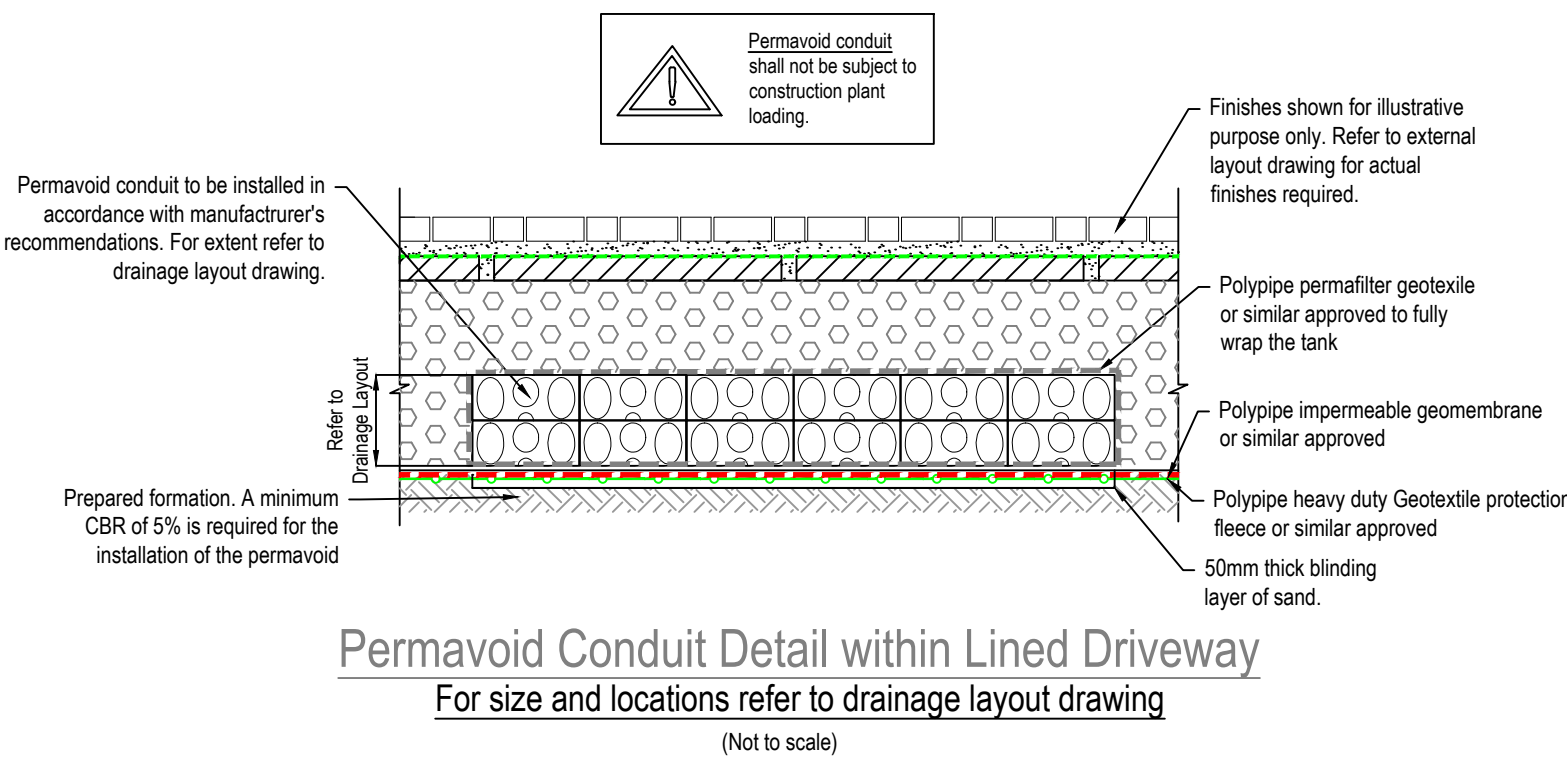

Permavoid Conduit Detail within Lined Driveway

For size and locations refer to drainage layout drawing

(Not to scale)

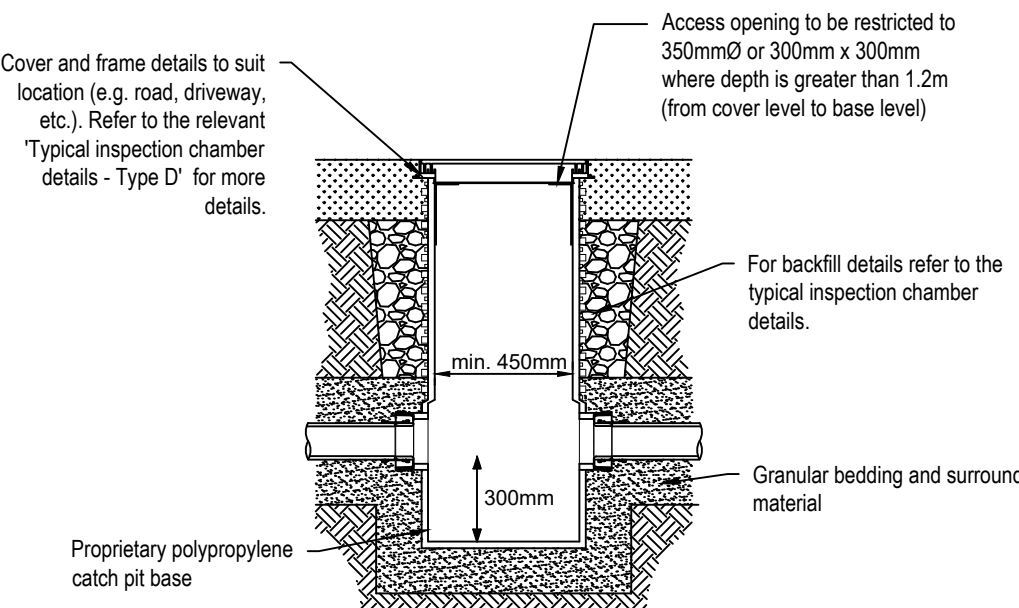

Typical Polypropylene Catch Pit Detail (non entry)

Max. depth from cover level to base 3.0m

(Not to scale)

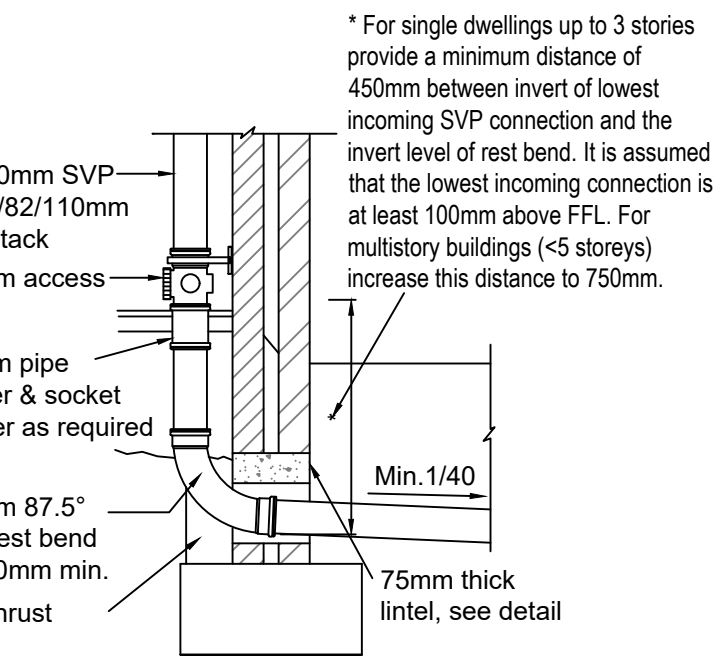

Soil & vent pipe connection and stub stack connection

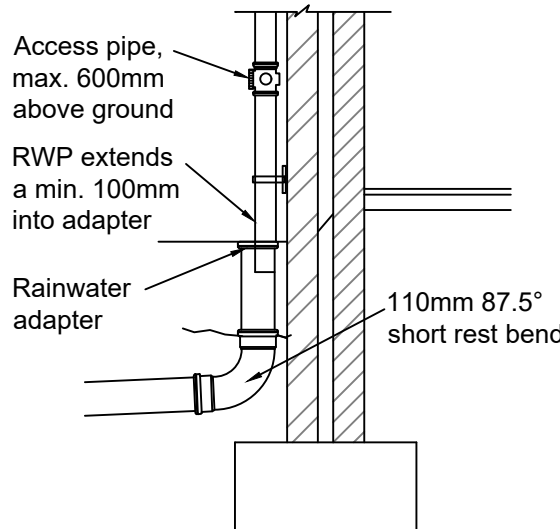

External RWP connection

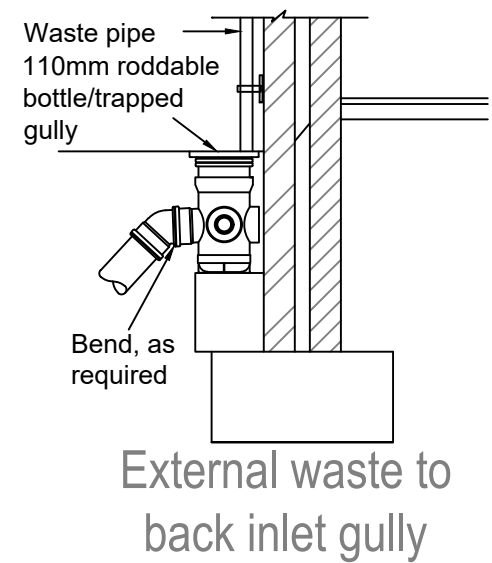

External waste to back inlet gully

© BEAL Consulting Engineers Ltd. All rights reserved.
No part of this document may be reproduced, stored in a retrieval system or transmitted, in any form or by means, electronic, mechanical, photocopying, recording or otherwise, without the prior permission of BEAL Consulting Engineers Ltd.

NOTES:

1. Do not scale from this drawing. This drawing shall be read in conjunction with all other relevant Architect's and Engineer's drawings.
2. Any discrepancies, ambiguities, or anomalies in the information provided on this or any of the engineering drawings package must be reported prior to work proceeding.
3. All accommodation work deemed necessary to facilitate a satisfactory link between the new works and the existing to be undertaken by the developer.
4. It is the contractor's responsibility to locate all existing services and verify their level & location prior to commencing any works. Should they be affected by the works then the respective statutory undertaker should be contacted and any special protection requirements agreed.
5. All highway works shall be undertaken in accordance with the Local Highway Authorities Design Guide and Specification and strictly in accordance with the 'Specification for Highway Works'. All drainage works shall be undertaken in accordance with the 'Design & Construction Guidance', and any other Regional Water company requirements. All works to be supervised/inspected as required by the relevant Inspector.
6. All works must comply with current Health and Safety guidance & standards. All temporary signing to comply with Traffic Signs Manual - Chapter 8.
7. All products are to be installed and maintained strictly in accordance with manufacturer's recommendations & guidelines.

PRELIMINARY

Rev:	Date:	Description:
------	-------	--------------

Client:

W E Black Ltd.

Project:

Land at Blackmore Way, Uxbridge

Drawing Title:

Drainage Construction Details (Sheet 2 of 2)



Haddenham Business Centre,
Chiltern House,
Thame Road,
Haddenham,
Bucks, HP17 8BY.
01844 396233
www.beal-uk.com

Designed: FD	Drawn: SRC	Checked: ----
--------------	------------	---------------

Scale: As shown @A1	Date: Aug 2024	Approved: ----
---------------------	----------------	----------------

Drawing Number: 619:005	Revision: -
-------------------------	-------------

