

GENERAL NOTES

DRAWING CAN BE SCALED FOR PLANNING SUBMISSION PURPOSES ONLY BUT IF IN ANY DOUBT ABOUT A DIMENSION OR ANY OF THE DRAWN INFORMATION PLEASE ASK CDRB ARCHITECTS LTD IMMEDIATELY.

Discharge Information For Condition 4.
on Application Ref 20652/APP/2023/840

Rooflight Specification:

Rooflight Supplier: The Rooflight Company
Product: CR 14 Conservation Rooflight

Internal Colour: White

External Colour: Black RAL 9005

Size: 1021mm structural width x 1333mm structural length

Glazing specification: Double glazed 4mm Thick SGG 'Planitherm' one 2 (Low E) Toughened inner with a 16mm thick Argon Cavity and a 4mm Thick SGG 'Planilux' Toughened outer

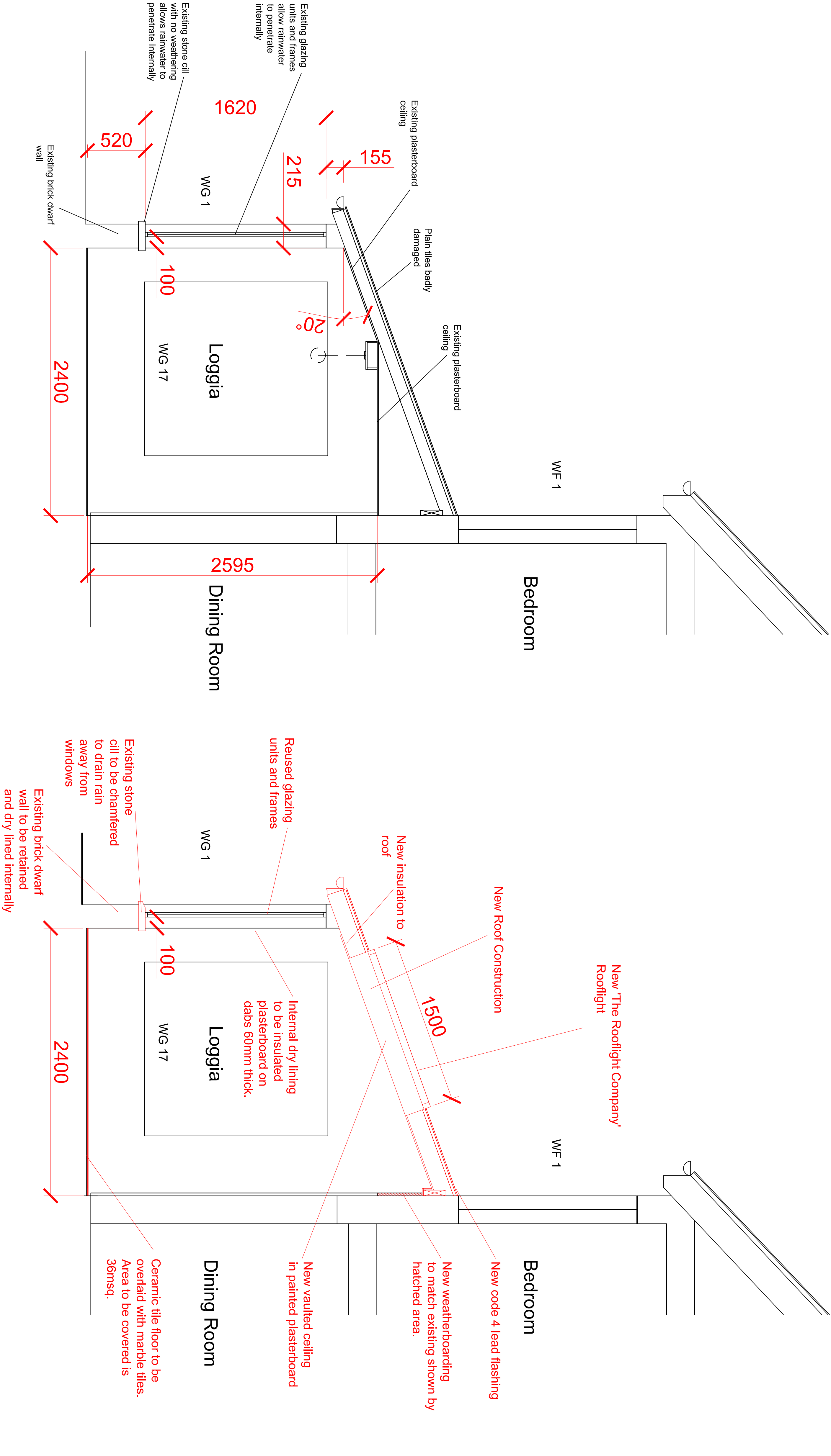

PLANNING SUBMISSION

job title		drawing title	
Discharge of Condition 4 on Application Ref: 20652/APP/2023/840 at The Old Shooting Box' High Road, Eastcote, Middlesex. HA5 2EY.		Existing and Proposed Loggia Cross Sections Condition 4 Discharge	
scale	drawn by	date	checked by
1:20 @ A1	ac	14/01/2023	CDRB
job no.	drawing no.	revision	
T2622	AL (DCO) 02	B	

B	25.8.23	Drawing updated following email from Planner on 25.8.23.	CR	CDRB
A	14.8.23	Issued following following email from Planner on 14.8.23. Conservation colligis confirmed as being from The Roof Light Company and not Stella as previously stated.	CR	CDRB
rev	date	description	by	checked
cdtb architects ltd Studio Road, Chesham, Bucks, HP8 4JY				