

Contact:
Email: info@bluearchdesign.co.uk,
Cell: 044 + 078 3293 8374
Web site: www.bluearchdesign.co.uk

Notes:
© 2024 Blue Architecture Limited.
All rights reserved.
All drawings are for the purpose of gaining
Building Control approval only.
All written dimensions to be taken in
preferences to scaled dimensions.
The contractor is responsible for checking
and verifying measurements on site prior
to any work commencing.
All work is to be carried out to be the
requirements, and to the satisfaction
of the Local Authority.

Rev.	Description	By	Ckd	Date

Client:
Mr/s. Pushkar Patel.

Project:
Change of use from Single Dwellings (C3) to
Class (C4) 6-Bed HMO.

Location:
5 Crossway, Hayes, Middlesex,
UB3 3JG, London.

Status:
PLANNING

Title:
Existing and Proposed Block plans

Drawn by:	Str. Etr.	Checked by:
L.p	---	R.k
Project no:	Sheet Size	Sheet no.
BAL-5XY	A3	
Date:	Scale:	
10/07/2024	1:500	

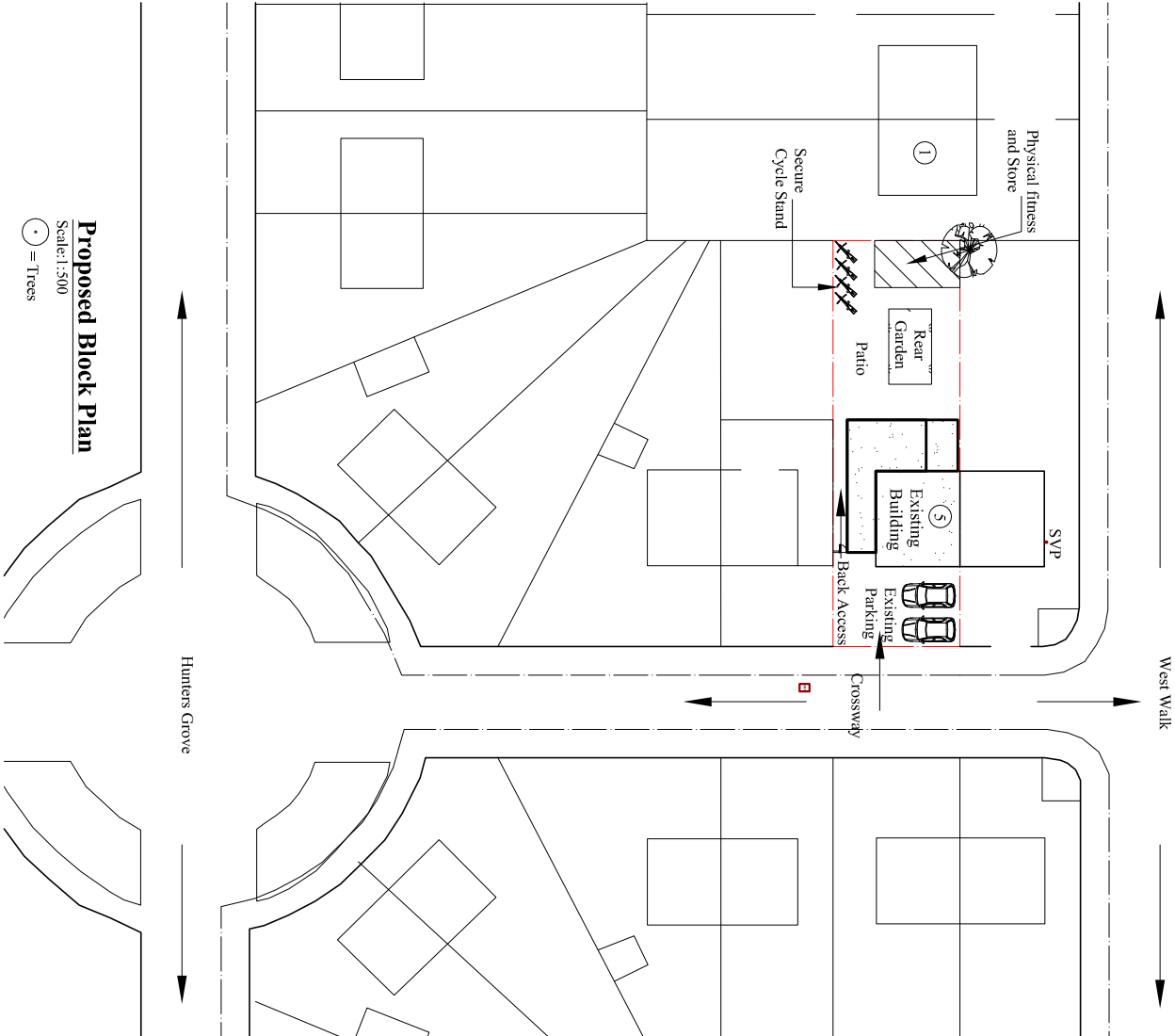
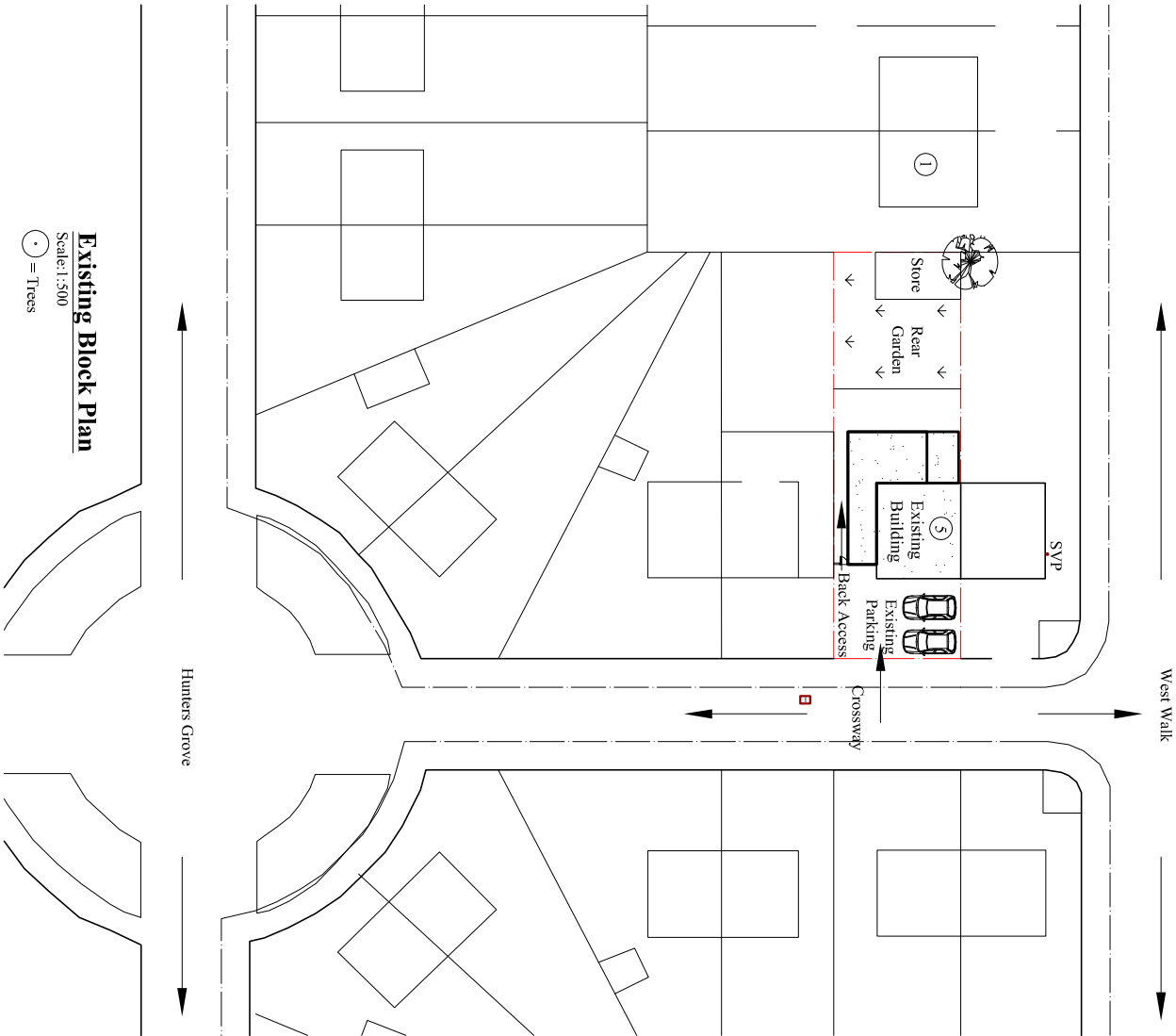
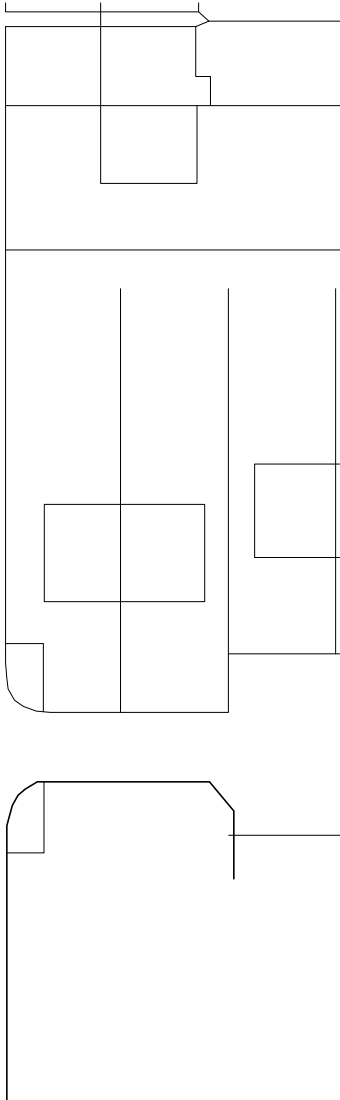
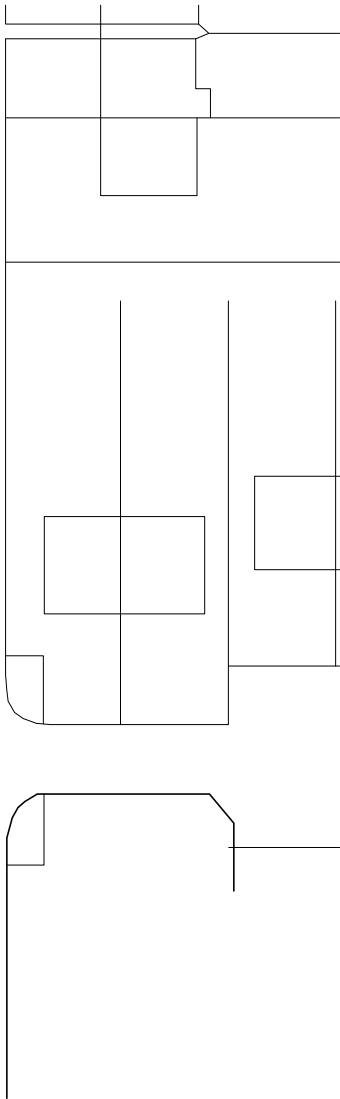
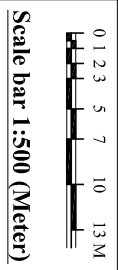
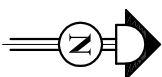

Existing Block Plan

Scale:1:500
● = Trees

Proposed Block Plan

Scale:1:500
● = Trees