

Contact:  
Email: info@bluearchdesign.co.uk,  
Cell: 044 + 078 3293 8374  
Web site: www.bluearchdesign.co.uk

Notes:  
© 2023 Blue Architecture Limited.  
All rights reserved.  
All drawings are for the purpose of gaining  
Building Control approval only.  
All written dimensions to be taken in  
preferences to scaled dimensions.  
The contractor is responsible for checking  
and verifying measurements on site prior  
to any work commencing.  
All work is to be carried out to be the  
requirements, and to the satisfaction  
of the Local Authority.

Rev.	Description	By	Ckd	Date

Client:  
**Mr/s. Pushkar Patel.**

**Project:**  
Change of use from Use Class C4 (6-Bed HMO)  
to use as a 6-Bed HMO for 10 person (Sui Generis).

**Location:**  
5 Crossway, Hayes, Middlesex,  
UB3 3JG, London.

**Status:**  
PLANNING

**Title:**  
Existing and Proposed Block plans

Drawn by:	Str. Etr.	Checked by:
L.p	---	R.k
Project no: <b>BAI-5CW</b>	Sheet Size <b>A3</b>	Sheet no.
Date: 22/05/2023	Scale: 1:500	<div>07</div>

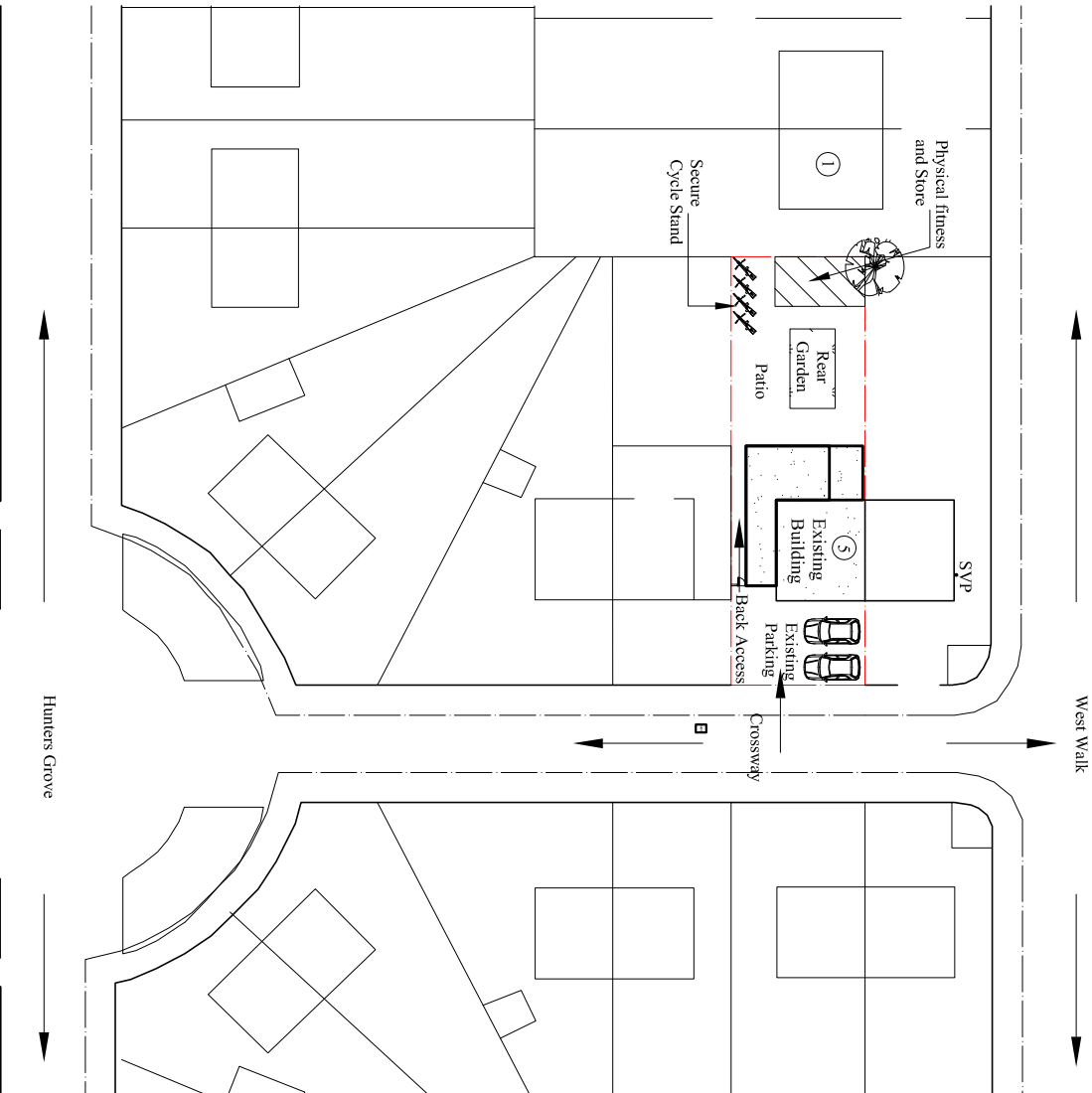
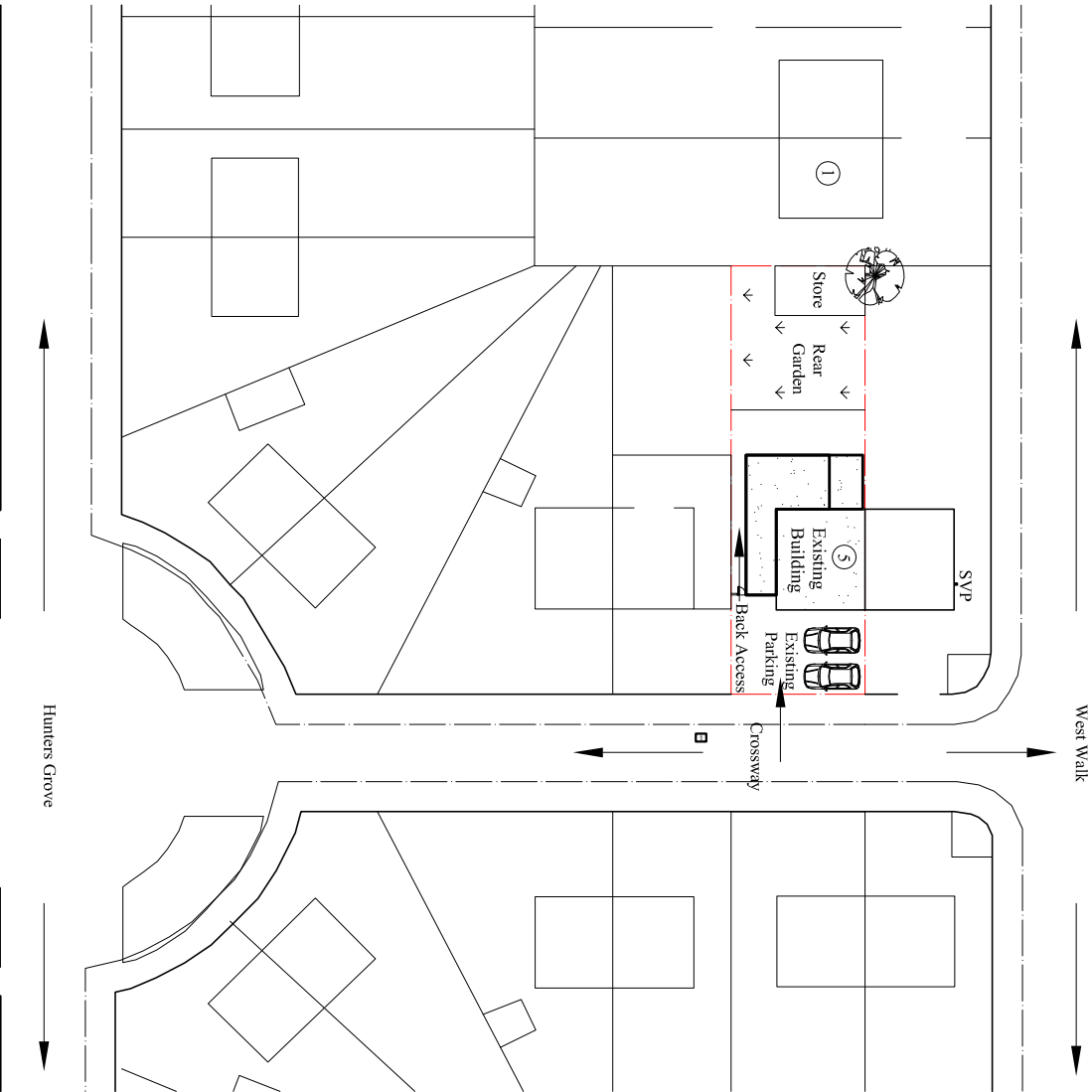
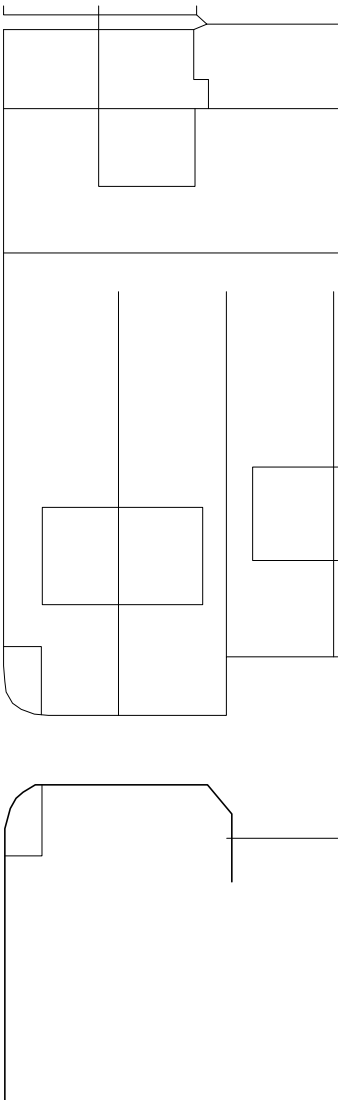
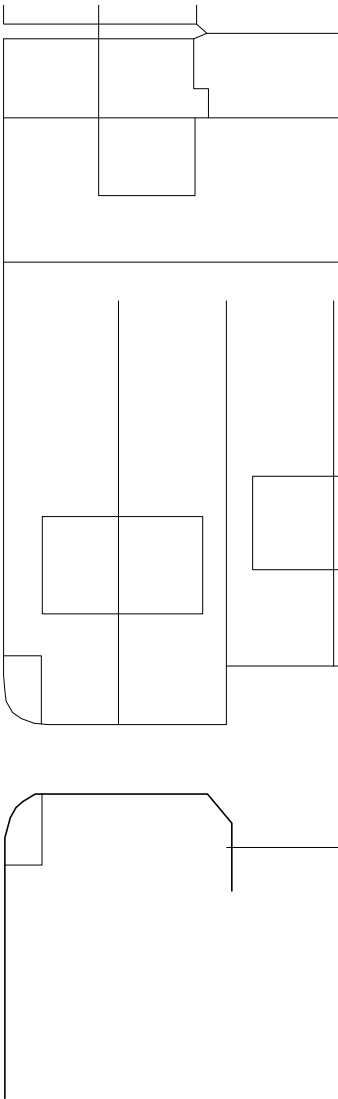
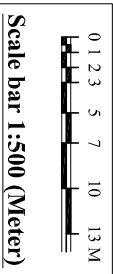
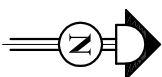

**Existing Block Plan**

Scale:1:500  
● = Trees

**Proposed Block Plan**

Scale:1:500  
● = Trees