

COPYRIGHT CONTRACTOR MUST CONFIRM SITE DIMENSIONS BEFORE COMMENCEMENT OF WORK. THIS DRAWING OR DESIGN IS THE COPYRIGHT AND MAY NOT BE REPRODUCED WITHOUT WRITTEN CONSENT OF THE DESIGNER. CONTRACTOR RESPONSIBLE FOR CORRECT SETTING OUT ON SITE. ANY DISCREPANCIES TO BE NOTED TO THE DESIGNER IMMEDIATELY.		
MARKED	REVISION	DATE
A		

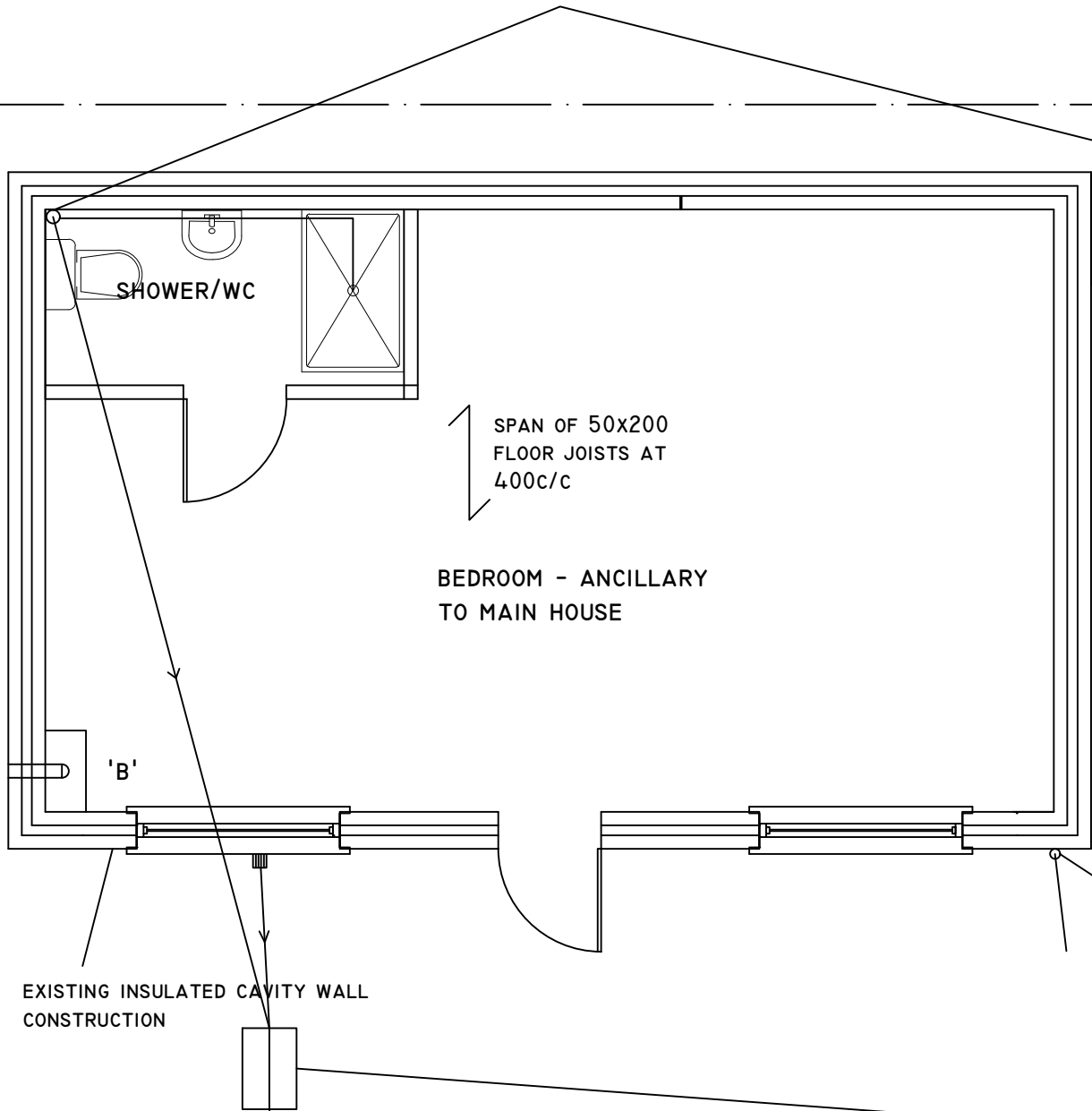

- 100 DIA. STACK TO TAKE WASTE FROM WC/SHOWER/BASIN IN ACCORDANCE WITH BS 5572, 100MM DRAIN TO FOUL DRAIN
- PROVIDE MECHANICAL FAN TO WC 15 LITRES PER SECOND CONNECTED TO LIGHT SWITCH AND DUCTED TO OUT SIDE
- PROVIDE 10MM GAP TO WC DOOR FOR AIR INTAKE
- HOT WATER SYSTEM USING UNVENTED SYSTEM TO BE INSTALLED BY PERSON HOLDING CURRENT REGISTERED OPERATIVE IDENTITY CARD
- HOT WATER STORAGE VESSEL REQUIRES PRECAUTIONS TO PREVENT WATER EXCEEDING 100 DEGREES C. SAFETY DEVICES TO DISCHARGE TO A SUITABLE PLACE OF SAFETY TO PREVENT INJURY TO PEOPLE
- PROVIDE THERMOSTATICALLY CONTROLLED VALVES TO ALL RADIATORS
- EXISTING 75MM DIA. RAIN WATER PIPE
- NEW BACK INLET GULLY TAKING WASTE FROM KITCHEN SINK, 100MM DIA DRAIN TO MANHOLE
- NEW 400x600 MANHOLE IN 215 ENGINEERING BRICKS ON 150MM CONCRETE BASE INVERT LEVEL 200MM, CONNECT DRAIN TO EXISTING MANHOLE
- BUILDER TO ENSURE THERE ARE NO THERMAL BRIDGES OF GAPS IN THE INSULATION LAYERS
- 'B' DENOTES WALL MOUNTED COMBI-BOILER CONDENSING TYPE WITH FLUE & GUARD SEDBUK VALUE 95%, PROVIDE COMMISSIONING CERTIFICATE FROM GAS SAFE REGISTERED INSTALLER AND DISCHARGE IN ACCORDANCE WITH INSTRUCTIONS FROM A CORGI REGISTERED PLUMBER, SLEEVE THROUGH THE ROOF TO BE NON-COMBUSTIBLE TYPE

GROUND FLOOR PLAN

ALL WIRING AND ELECTRICAL WORK TO BE DESIGNED, INSTALLED, INSPECTED AND TESTED IN ACCORDANCE WITH THE REQUIREMENTS OF BS 7671, THE IEE 18TH EDITION WIRING GUIDANCE AND BUILDING REGULATION PART P (ELECTRIC SAFETY) ON COMPLETION OF THE WORKS A COPY OF THE INSTALLERS ELECTRICAL INSTALLATION TEST CERTIFICATE COMPLIANT WITH BS 7671 IS TO BE PROVIDED TO THE CLIENT AND THE LOCAL AUTHORITY PRIOR TO COVERING OF ALL WIRING/CABLES THE APPLICANT IS TO ENSURE THAT THE INSTALLATION IS INSPECTED BY A COMPETENT PERSON AND ON COMPLETION OF THE WORKS; IN ADDITION TO THE INSTALLATION CERTIFICATE AN ADDITIONAL TEST COMPETENT PERSONS ELECTRICAL INSTALLATION TEST CERTIFICATE COMPLIANT WITH BS 7671 IS TO BE PROVIDED TO THE CLIENT AND LOCAL AUTHORITY

BUILDING WORK SHELL BE CARRIED OUT WITH PROPER MATERIALS AND WORK MAN LIKE MANNER

NEW STUD PARTITION ON DOUBLE JOISTS 50x100 STUDS AT 400c/c, INFILL VOIDS WITH 100 MINERAL WOOL DENSITY 15kg/m3 12.5MM PLASTER BOARD AND SKIM

FLUSHING DEVICES TO W.C. TO BE PROVIDED WITH PROVISION OF WHOLESOME WATER FROM THE MAINS

BASIN TO BE PROVIDED WITH HEATED WHOLESOME WATER OR SOFTENED WATER

ALL ELEMENTS OF HOT WATER SYSTEM TO BE DESIGNED, CONSTRUCTED AND INSTALLED TO RESIST EFFECTS OF TEMPERATURE DURING NORMAL USE AND IN THE EVENT OF A MALFUNCTION. SYSTEM TO BE ADEQUATELY SUPPORTED AND COMPLY WITH APPROVED DOCUMENT G (G3)

CHECKED:	DATE: OCT 2023
DRAWN:	SCALE: 1:50
DRAWING NUMBER:	03

DRAWING TITLE:
PROPOSED GROUND
FLOOR PLAN

PROJECT:
41 GRANGE ROAD
HAYES
UB3 2RP