



InfraGreen
solutions

Introducing the new generation of Tree Root Protection Systems.... **ArborRaft TRP**

For more information contact
info@infragreen-solutions.com

InfraWeb TRP is available in 5 panel depths: 50mm, 75mm, 100mm, 150mm and 200mm.

The depth of InfraWeb required for providing protection to existing tree roots is project specific.

We take into account in all designs the existing soil bulk density or CBR (California Bearing Ratio) and the type of vehicular loadings which will be exposed to the InfraWeb area. All structural designs are carried out in accordance with the design parameters detailed by Webber 1991 and are based on unpaved roads. The structural designs do not take into account any surfacing materials applied to the InfraWeb.

Infra Green's technical team have extensive experience in providing clients with solutions for Tree Root Protection Systems and provide free of charge:

- Site visits to assess product suitability
- Standard cad details
- Project specific structural designs and site specific drawings
- Full installation method statements
- On site installation support to ensure the successful integration of the InfraWeb TRP system into the project
- Installation sign of certification

Other Infra Green Products

- **AborRaft Tree Root Protection System**
- **TreeBox HP Tree Planting System**
- **SlimBlock 50 Grass / Gravel Paving**
- **FlowBlock 75 Grass / Gravel Paving**
- **GS Pro Grass / Gravel Paving**
- **Gravel Pro**
- **Gravel Paving**
- **Turf Pro Turf Reinforcement Mesh**
- **Geotextiles**
- **Geogrids**
- **Geomembranes**
- **Porous Rubber Tiles**



APPENDIX 3: SAMPLE SITE MONITORING SHEET



Site Monitoring Report Sheet

| | | | |
|--|------------|----------------------|------------|
| Client: | | Planning Ref: | |
| Local Authority: | | Date: | |
| Site Address: | | | |
| Proposal: | | | |
| Visit Checklist | Y/N | | Y/N |
| Tree protection barrier (TPB) in place | | TPB as per approved | |
| Ground protection (GP) in place | | GP as per approved | |
| TPB / GP breached | | Trees damaged | |
| Site Agent briefed by LT | | | |
| LT briefed by Site Agent | | | |
| LPA informed | | | |
| Remedial action required | | | |
| Comments | | | |
| | | | |
| Recommendations | | | |
| | | | |
| Outcome | | | |
| 1 | | | |
| 2 | | | |
| 3 | | | |
| 4 | | | |

Web: www.landmarktrees.co.uk
e-mail: info@landmarktrees.co.uk
Tel: 0207 851 4544



London Office: 20 Broadwick Street, W1F 8HT, London

Registered Office: Grange Cottage, All Cannings, Devizes, Wiltshire, SN10 3NR

Landmark Trees is the trading name of Landmark trees Ltd. Registered in Wales. Reg No. 3882076



APPENDIX 4: INDICATIVE PRUNING GUIDELINES

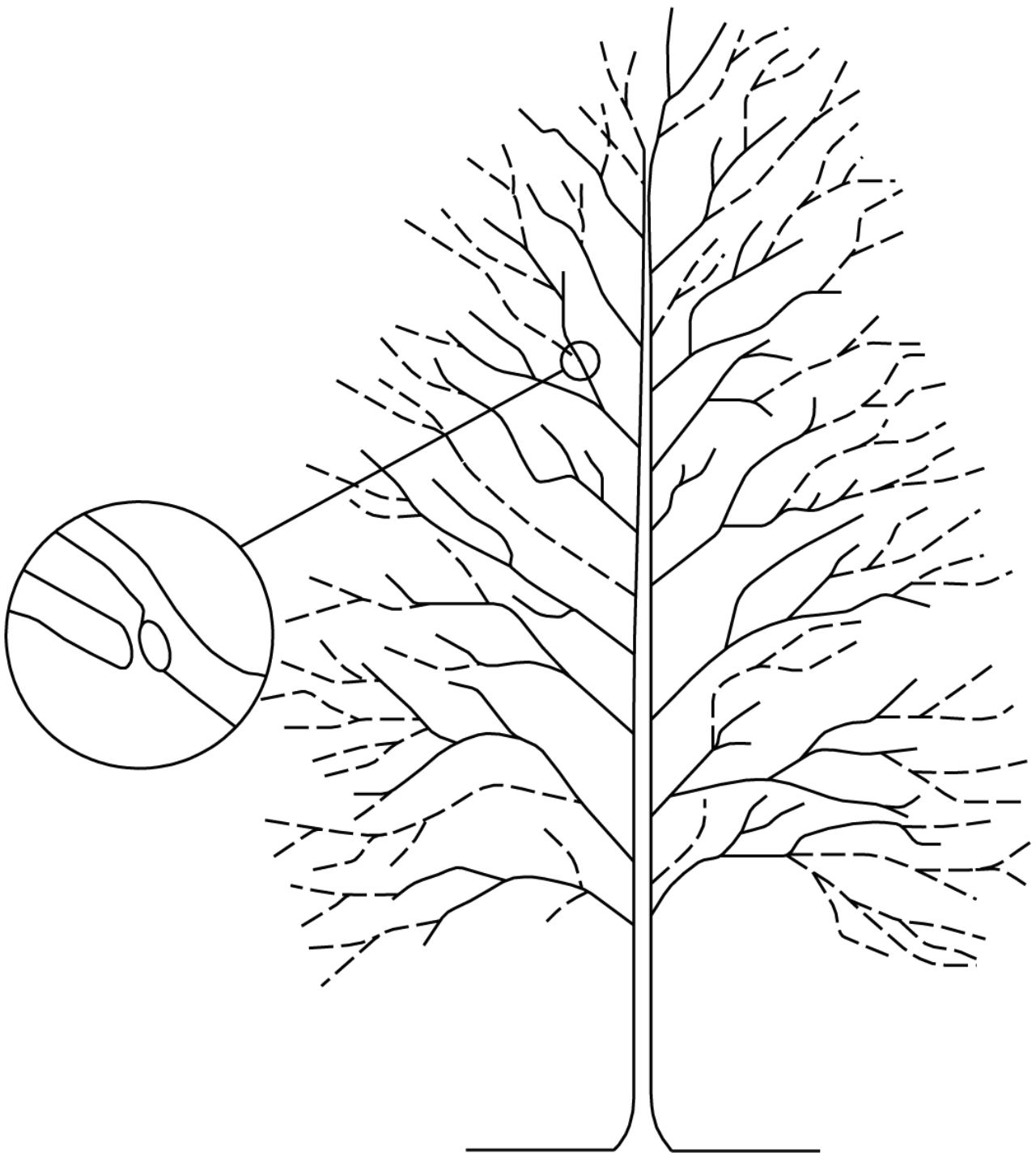

NOTE: Branches pruned back to suitable outward pointing bud or small branch.

REDUCING THE CROWN

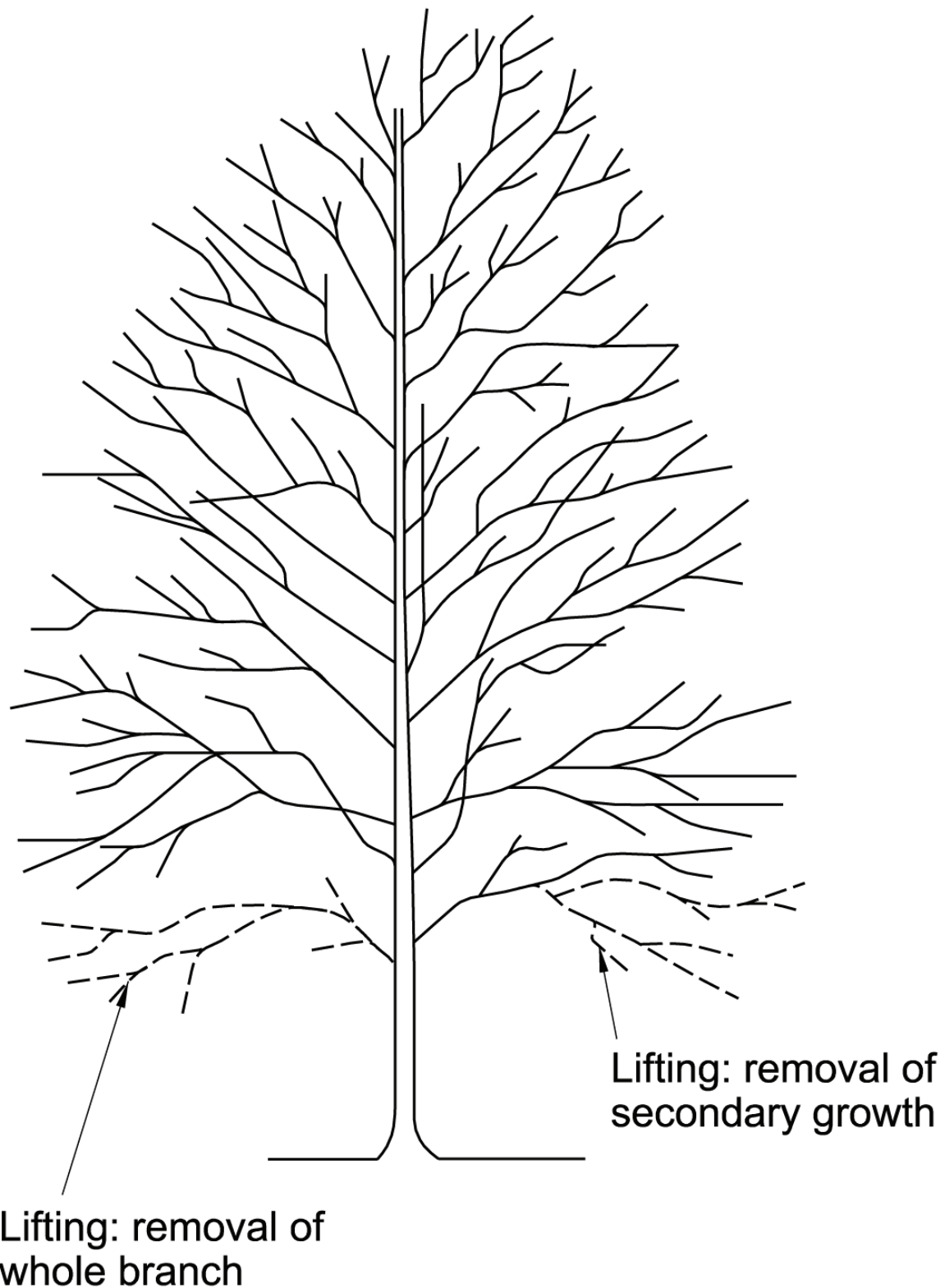

CROWN LIFTING

APPENDIX 5: TREE PROTECTION PLAN

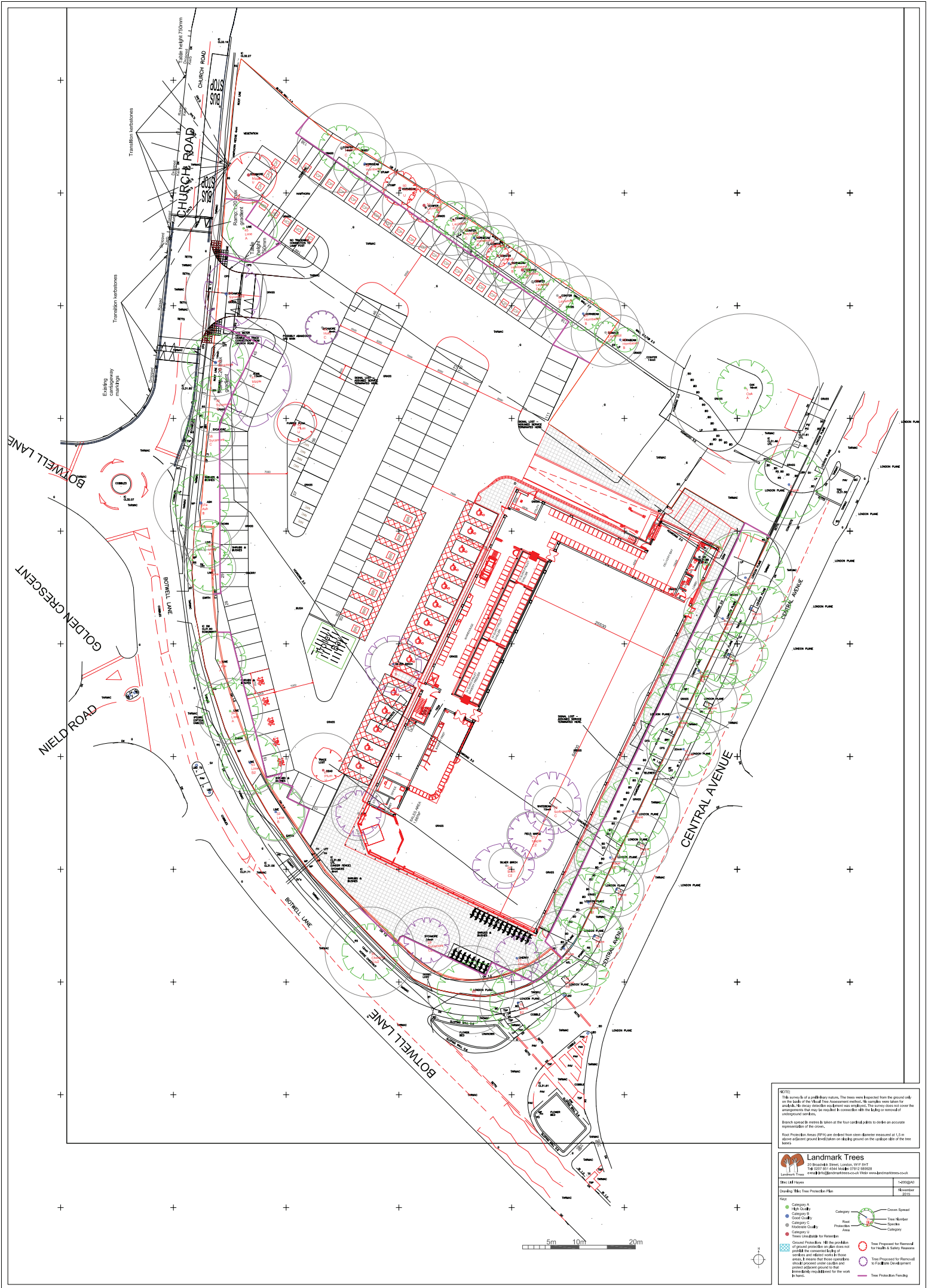

NOTES:
This survey is of a preliminary nature. The trees were inspected from the ground only on the basis of the visual tree assessment method. No specialist tree survey for analysis. No survey description equipment was employed. This survey does not cover the underground services that may be required to connect with the building or removal of underground services.
Branch spread is noted & taken at the four cardinal points to define an accurate representation of the crown.
Root Protection Areas (RPA) are defined from stem diameter measured at 1.5m above natural ground level (or on sloping ground on the up-side of the tree base).

Landmark Trees
21 Broadlands Street, London, SE10 2JF
Tel: 020 761 4544 Mobile: 0779 020008
Email: info@landmarktrees.co.uk Web: www.landmarktrees.co.uk

Site Land Values
Drawing Title: Tree Protection Plan
1:2000 (A1)
November 2023

Key:
Category A: High Quality
Category B: Good Quality
Category C: Moderate Quality
Category D: Low Quality
Tree Unlikely to be removed
Ground Protection: 10m for the protection of ground protection on site does not include the construction of a trench or other works to those areas. It means that those conditions should prevent other such work and prevent adjacent ground to the immediately adjacent for the work in hand.
Tree Proposed for Removal for Health & Safety Reasons
Tree Proposed for Removal to Fulfill Other Development
Tree Protection Fencing

Legend:
Crown Spread
Tree Number
Species
Category