



Published 1938

Source map scale - 1:10,560

The historical maps shown were reproduced from maps predominantly held by the estate assembled for England, Wales and Scotland in the 1840's. In 1864 the Ordnance Survey produced a map of the United Kingdom at a scale of 1:2,500,000. This was the first time that a single map of the whole country had been published. It was based on the Ordnance Survey maps of the 1840's and was updated to include the 1840's maps. The first edition of the map was published in 1933. The second edition was published in 1937. The third edition was published in 1939. The fourth edition was published in 1940. The fifth edition was published in 1941. The sixth edition was published in 1942. The seventh edition was published in 1943. The eighth edition was published in 1944. The ninth edition was published in 1945. The tenth edition was published in 1946. The eleventh edition was published in 1947. The twelfth edition was published in 1948. The thirteenth edition was published in 1949. The fourteenth edition was published in 1950. The fifteenth edition was published in 1951. The sixteenth edition was published in 1952. The seventeenth edition was published in 1953. The eighteenth edition was published in 1954. The nineteenth edition was published in 1955. The twentieth edition was published in 1956. The twenty-first edition was published in 1957. The twenty-second edition was published in 1958. The twenty-third edition was published in 1959. The twenty-fourth edition was published in 1960. The twenty-fifth edition was published in 1961. The twenty-sixth edition was published in 1962. The twenty-seventh edition was published in 1963. The twenty-eighth edition was published in 1964. The twenty-ninth edition was published in 1965. The thirtieth edition was published in 1966. The thirty-first edition was published in 1967. The thirty-second edition was published in 1968. The thirty-third edition was published in 1969. The thirty-fourth edition was published in 1970. The thirty-fifth edition was published in 1971. The thirty-sixth edition was published in 1972. The thirty-seventh edition was published in 1973. The thirty-eighth edition was published in 1974. The thirty-ninth edition was published in 1975. The fortieth edition was published in 1976. The forty-first edition was published in 1977. The forty-second edition was published in 1978. The forty-third edition was published in 1979. The forty-fourth edition was published in 1980. The forty-fifth edition was published in 1981. The forty-sixth edition was published in 1982. The forty-seventh edition was published in 1983. The forty-eighth edition was published in 1984. The forty-ninth edition was published in 1985. The fiftieth edition was published in 1986. The fifty-first edition was published in 1987. The fifty-second edition was published in 1988. The fifty-third edition was published in 1989. The fifty-fourth edition was published in 1990. The fifty-fifth edition was published in 1991. The fifty-sixth edition was published in 1992. The fifty-seventh edition was published in 1993. The fifty-eighth edition was published in 1994. The fifty-ninth edition was published in 1995. The sixtieth edition was published in 1996. The sixty-first edition was published in 1997. The sixty-second edition was published in 1998. The sixty-third edition was published in 1999. The sixty-fourth edition was published in 2000. The sixty-fifth edition was published in 2001. The sixty-sixth edition was published in 2002. The sixty-seventh edition was published in 2003. The sixty-eighth edition was published in 2004. The sixty-ninth edition was published in 2005. The seventieth edition was published in 2006. The seventy-first edition was published in 2007. The seventy-second edition was published in 2008. The seventy-third edition was published in 2009. The seventy-fourth edition was published in 2010. The seventy-fifth edition was published in 2011. The seventy-sixth edition was published in 2012. The seventy-seventh edition was published in 2013. The seventy-eighth edition was published in 2014. The seventy-ninth edition was published in 2015. The eightieth edition was published in 2016. The eighty-first edition was published in 2017. The eighty-second edition was published in 2018. The eighty-third edition was published in 2019. The eighty-fourth edition was published in 2020. The eighty-fifth edition was published in 2021. The eighty-sixth edition was published in 2022. The eighty-seventh edition was published in 2023. The eighty-eighth edition was published in 2024. The eighty-ninth edition was published in 2025.

Map Name(s) and Date(s)

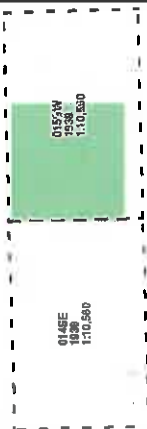

Historical Map - Slice A

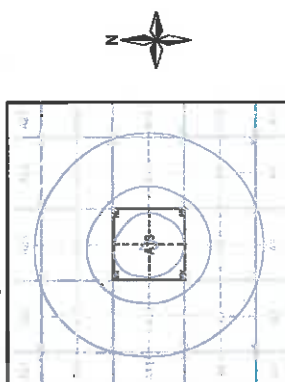

Order Details

Order Number: 48303056 1 1
Customer Ref: J-M0167.D0/MK001
National Grid Reference: 509730, 180080

Slice:	A
Site Area (Ha):	1.01
Search Buffer (m):	1000

Site Details

Site Name
Hayes Swimming Pool, Botwell Lane, HAYES, Middlesex, UB3
2BG



Tel: 0844 844 9852
 Fax: 0844 844 9851
 Web: www.enrwinchute.co.uk



Middlesex

Published 1938

Source map scale - 1:10,560

The historical maps shown were reproduced from maps predominantly held at the Ordnance Survey, which were used for England, Wales and Scotland. In 1984 the 1:2,500 scale was adopted for mapping urban areas; these maps were used to update the 1:10,560 maps. The published data given here are often some years later than the surveyed date. Before 1938, all OS maps were based on the Cassini Projection, with independent surveys of a single county or group of counties, giving rise to significant inaccuracies in outlying areas. In the late 1940's, a Provisional Edition was produced, which updated the 1:10,560 mapping from a number of sources. The maps appear unfinished - with all military camps and other strategic areas removed. These maps were initially overprinted with the National Grid. In 1970, the first revision process continued until recently, with new editions appearing every 10 years or so for urban areas.

Map Name(s) and Date(s)

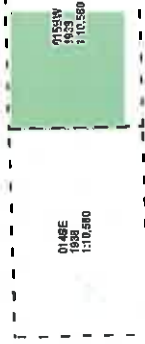

Historical Map - Slice A

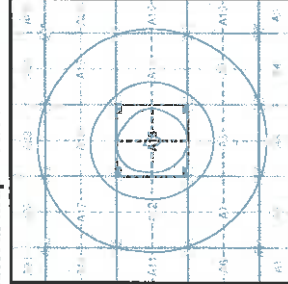

Order Details

Order Number: 46303056 1.1
Customer Ref: J-M0167.00/MK001
National Grid Reference: 509730, 180080
Slice: A
Site Area (Ha): 1.01
Search Buffer (m): 1000

Site Details

Hayes Swimming Pool, Botwell Lane, HAYES, Middlesex, UB3 2BG



0844 644 9952
0844 644 9951
www.annexhedge.co.uk



Historical Aerial Photography Published 1948

Source map scale - 1:10,560

The Historical Aerial Photos were produced by the Ordnance Survey at a scale of 1:1,250 and 1:10,560 from Air Force photography. They were produced between 1944 and 1951 as an interim measure, pending preparation of conventional mapping, due to post war resource shortages. New security measures in the 1950's meant that every photograph was rechecked for potentially unsafe information with security sites replaced by fake fields or clouds. The original editions were withdrawn and only later made available after a period of 50 years although due to the accuracy of the editing, without viewing both versions it is not easy to spot the edits. Where available Landmark have included both revisions.

© Landmark Information Group and/or Data Suppliers 2013.

Map Name(s) and Date(s)

TOURSE	TO 18SW
1948	1948
1:10,560	1:10,560
TOURNE	TO 17NW
1948	1948
1:10,560	1:10,560

Historical Aerial Photography - Slice A

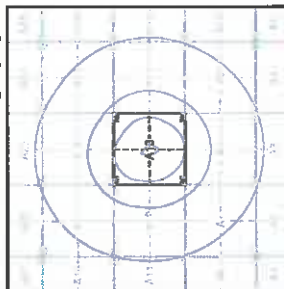

Order Details

Order Number: 46303056.1.1
Customer Ref: J-M0167.00/MK001
National Grid Reference: 509730, 180080
Slice: A
Site Area (Ha): 1.01
Search Buffer (m): 1000

Site Details

Hayes Swimming Pool, Botwell Lane, HAYES, Middlesex, UB3 2BG



Tel: 0844 844 9552
Fax: 0844 844 9551
Web: www.landmark.co.uk



**Historical Aerial Photography
Published 1948**

Source map scale - 1:10,560

[illegible]

© Landmark Information Group and/or Data Suppliers 2010.

Map Name(s) and Date(s)

TQ08SE 1948 1:10,560		TQ17NW 1948 1:10,560
----------------------------	--	----------------------------

Historical Aerial Photography - Slice A



BRITISH LIBRARY

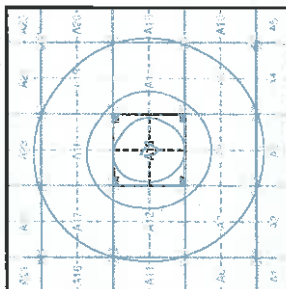

Order Details

Order Number: 46303056_1_1
Customer Ref: J-M0167,00/MK001
National Grid Reference: 509730, 180080
Slice: A
Site Area (Ha): 1.01
Search Buffer (m): 1000

Site Details

Site details
Hayes Swimming Pool, Botwell Lane, HAYES, Middlesex, UB3
2BG



Tel: 0844 844 9952
Fax: 0844 844 9951
Web: www.smithcheck.co.uk



Ordnance Survey Plan Published 1960

Source map scale - 1:10,000

The historical maps shown were reproduced from maps predominantly held at the scale adopted for England, Wales and Scotland in the 1840's. In 1954 the 1:2,500 scale was adopted for mapping urban areas; these maps were used to update the 1:10,000 maps. The published date given therefore is often some years later than the surveyed date. Before 1958, all OS maps were based on the Cassini Projection, with independent inaccuracies of a single county or group of counties, giving rise to significant inaccuracies in adjoining areas. From 1960, the maps were based on the Transverse Mercator Projection, the 1:10,000 maps being from a number of sources. The maps appear unaltered - with all railway camps and other strategic sites removed. These maps were initially overlaid with the National Grid. In 1970, the first 1:10,000 maps were produced using the Transverse Mercator Projection. The revision process continued until recently, with new editions appearing every 10 years or so for urban areas.

Map Name(s) and Date(s)

TOSSSE	TC16SW
1960	1960
1:10,000	1:10,000
TOSSSE	TC17NW
1960	1960
1:10,000	1:10,000

Historical Map - Slice A

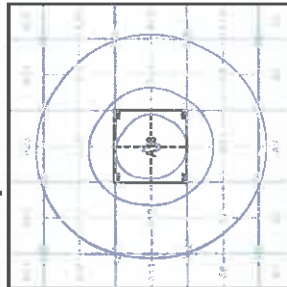

Order Details

Order Number: 46303056 1.1
Customer Ref: J-MD167.00/MK001
National Grid Reference: 509730, 180080
Slice: A
Site Area (Ha): 1.01
Search Buffer (m): 1000

Site Details

Hayes Swimming Pool, Botwell Lane, HAYES, Middlesex, UB3 2BG



Tel: 0844 644 6992
Fax: 0844 644 6993
Web: www.landmark.co.uk

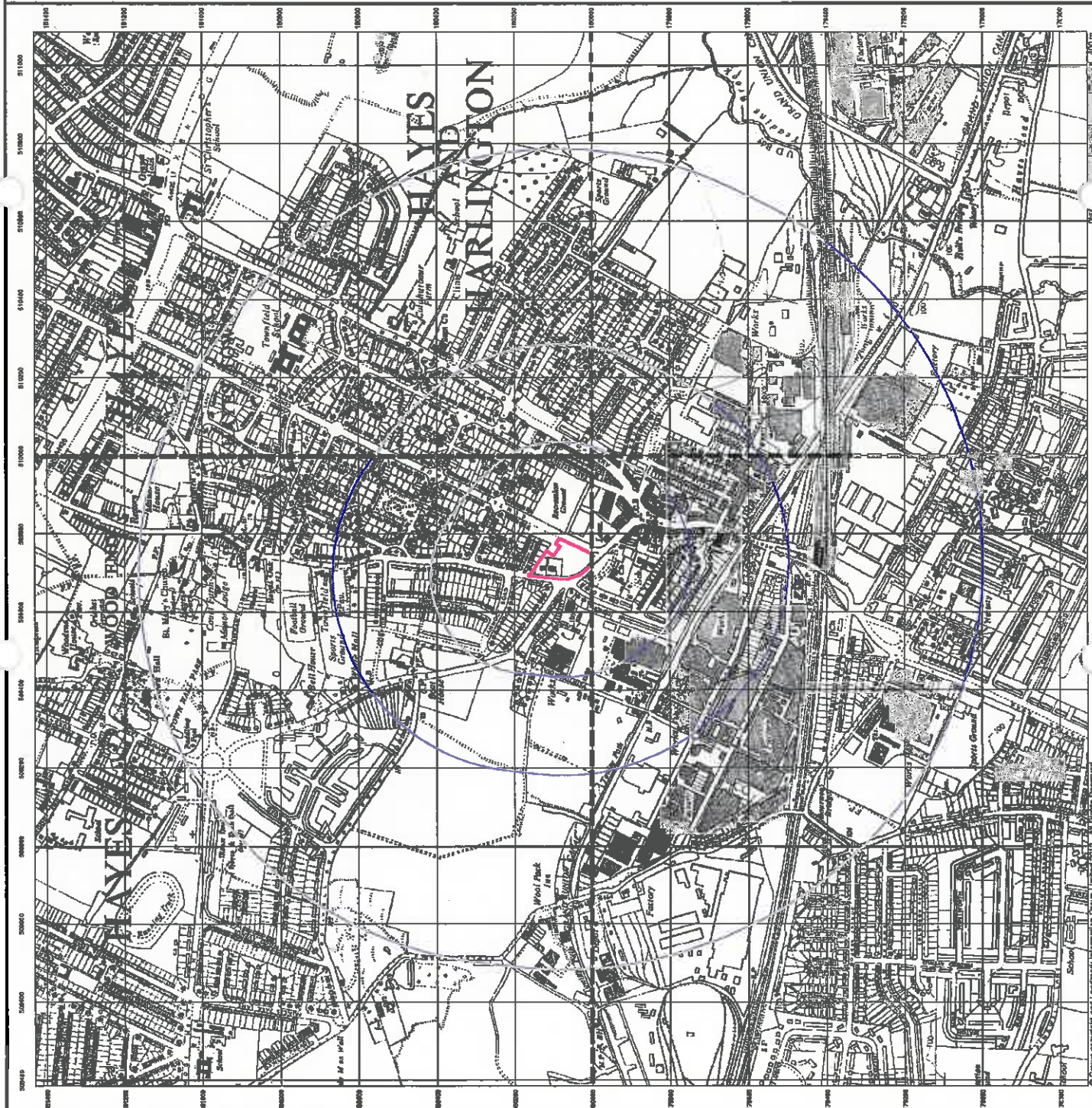



Ordnance Survey Plan

Published 1965 - 1966

Source map scale - 1:10,000

The historical maps shown were reproduced from maps predominantly held at the Ordnance Survey, which were first published in 1847. In 1954 the Ordnance Survey was reorganised for regional urban areas; these maps were used to update the 1:10,000 maps. The published date given therefore is often some years later than the surveyed date. Before 1935, all OS maps were based on the Cassini Projection, with independent surveys of a single county or group of counties, giving rise to significant inaccuracies in outlying areas. In the late 1940's, a Provisional Edition was produced, which updated the 1:10,000 mapping from a number of sources. The maps appear unfinished - with all military camps and other strategic areas removed. These maps were initially overprinted with the National Grid. In 1970, the first 1:10,000 maps were produced using the Transverse Mercator Projection. The revision process continued until recently, with new editions appearing every 10 years or so for urban areas.

Map Name(s) and Date(s)

TC18SW	1965	1:10,560
TC07NE	1965	1:10,560
TC17NW	1965	1:10,560

Historical Map - Slice A

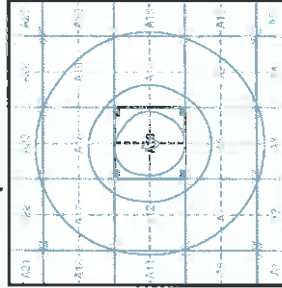

Order Details

Order Number: 46303056 1.1
Customer Ref: J-M0167 00/MK001
National Grid Reference: 509730, 180080
Slice: A
Site Area (Ha): 1.01
Search Buffer (m): 1000

Site Details

Hayes Swimming Pool, Botwell Lane, HAYES, Middlesex, UB3 2BG



Tel: 0844 344 5852
Fax: 0844 844 8951
Web: www.landmark.co.uk



Ordinance Survey Plan

Published 1970 - 1975

Source map scale - 1:10,000

The historical maps shown were reproduced from maps predominantly held at the scale adopted for England, Wales and Scotland in the 1840's. In 1854 the 1:25,000 scale was adopted for mapping urban areas; these maps were used to update the 1:10,000 maps. The published data given therefore is often some years later than the surveyed data. Before 1939, all OS maps were based on the Cassini Projection, with independent surveys of a single county or group of counties, giving rise to significant inaccuracies in outlying areas. In the late 1940's, a Provisional Edition was produced, which updated the 1:10,000 mapping from a number of sources. The maps appear to be unaltered in the urban areas, but the outlying areas were updated. These unaltered areas include the railway lines and the main roads. The first 1:10,000 maps were produced using the Transverse Mercator Projection. The revision process continued until recently, with new editions appearing every 10 years or so for urban areas.

Map Name(s) and Date(s)

TO06SE	TO16SW
1970	1975
1:10,000	1:10,000
TO07NE	TO17NW
1970	1975
1:10,000	1:10,000

Historical Map - Slice A

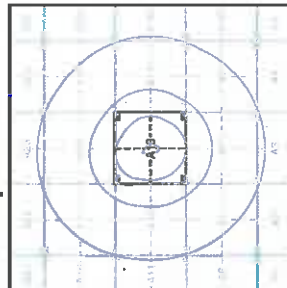

Order Details

Order Number: 46303856_L1
Customer Ref: J-MD167.00/M/K001
National Grid Reference: 509730, 180080

Slice: A
Site Area (Ha): 1.01
Search Buffer (m): 1000

Site Details

Hayes Swimming Pool, Botwell Lane, HAYES, Middlesex, UB3 2BG



Tel: 0844 544 9952
Fax: 0844 544 2551
Web: www.landmark.co.uk



Ordinance Survey Plan

Published 1975 - 1977

Source map scale - 1:10,000

The historical maps shown were reproduced from maps predominantly held at the Ordnance Survey for England, Wales and Scotland in 1940's. In 1964 the 1:2,500 scale was adopted for mapping urban areas; these maps were used to update the 1:10,000 maps. The published data given therefore is often some years later than the surveyed data. Before 1933, all OS maps were based on the Cassini Projection, with independent surveys of a single county or group of counties, giving rise to significant inaccuracies in adjoining areas. In the late 1940's, a Provisional Edition was produced, which updated the 1:10,000 mapping from a number of sources. The maps appear unfinished - with all military camps and other strategic sites removed. These maps were initially overprinted with the National Grid. In 1970, the first 1:10,000 maps were produced using the Transverse Mercator Projection. The revision process continued until recently, with new editions appearing every 10 years or so for urban areas.

Map Name(s) and Date(s)

TC06SE
1977
1:10,000
TC07NE
1975
1:10,000

Historical Map - Slice A

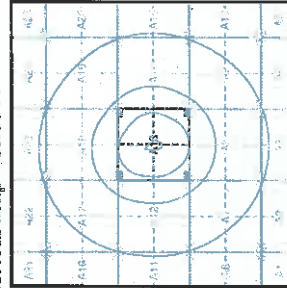

Order Details

Order Number: 46303056.1.1
Customer Ref: J-M0167.00/MK001
National Grid Reference: 509730, 180080
Site:
Site Area (Ha): 1.01
Search Buffer (m): 1000

Site Details

Hayes Swimming Pool, Botwell Lane, HAYES, Middlesex, UB3 2BG



02044 034 3852
02044 034 3851
Web: www.landmark.co.uk



Ordinance Survey Plan

Published 1985 - 1989

Source map scale - 1:10,000

The historical maps shown were reproduced from maps predominantly held at the scale adopted for England, Wales and Scotland in the 1840's. In 1854 the 1:2,500 scale was adopted for mapping urban areas; these maps were used to update the 1:10,000 maps. The published data given therefore is often some years later than the surveyed data. Before 1935, all OS maps were based on the Cassini Projection, with independent surveys of a single county or group of counties, giving rise to significant inaccuracies in outlying areas. In the late 1940's, a Provisional Edition was produced, which updated the 1:10,000 mapping from a number of sources. The maps appear unrecognisable when all military camps and other areas are removed. These 1:10,000 maps were produced using the Transverse Mercator Projection. The revision process continued until recently, with new editions appearing every 10 years or so for urban areas.

Map Name(s) and Date(s)

TO18SW	1885
TO17NW	1885
TO17NE	1885
TO17NW	1885

Historical Map - Slice A

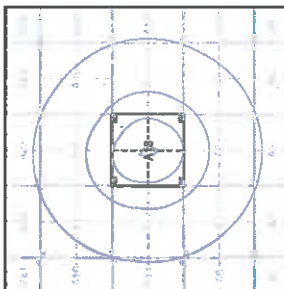

Order Details

Order Number: 46303056_1_1

Customer Ref: J-M0167 00/MK001

National Grid Reference: 509730, 180080

Site: A

Site Area (Ha): 1.01

Search Buffer (m): 1000

Site Details

Hayes Swimming Pool, Botwell Lane, HAYES, Middlesex, UB3 2BG

Landmark

Tel: 0844 844 8852
Fax: 0844 844 8851
Web: www.landmark.co.uk



Published 1985

Source map scale - 1:25,000

These maps were produced by the Russian military during the Cold War between 1950 and 1987, at scales of 1:103,000, 1:250,000 and 1:500,000. They were produced in the Soviet Union, and show the detailed layout of the cities with all planned roads for development, green areas, and undeveloped land with natural vegetation. Buildings are coloured black and important buildings (such as hospitals, post offices, factories etc.) are numbered, with a unidirectional key describing their use.

They were produced by the Russians for the benefit of navigation, as well as for the planning of military sites and transport hubs, for use if they were to have invaded the UK. The detailed information provided indicates that the areas shown were surveyed using land-based personnel, on the ground, in the cities that are mapped.

Map Name(s) and Date(s)

<p>TO08 1986 1:25,000</p>	<p>TO16 1985 1:25,000</p>
<p>TO07 1985 1:25,000</p>	<p>TO17 1986 1:25,000</p>

Russian Map - Slice A

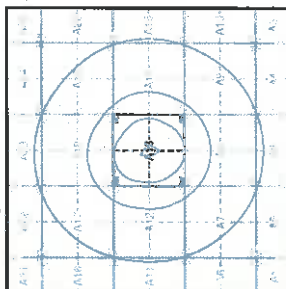

Order Details

Order Number: 46303056_1_1
Customer Ref: J-M0167.00/MK001
National Grid Reference: 509730, 180080
A
Slice: 1.01
Site Area (Ha): 1000
Search Buffer (m):

Site Details

Site Details
Hayes Swimming Pool, Botwell Lane, HAYES, Middlesex, UR3
BG



Tel: 0844 844 8852
Fax: 0844 844 8851
Web: www.arnoldclerk.co.uk

© 2000 by The McGraw-Hill Companies, Inc.

Page 21 of 24



Ordnance Survey Plan

Published 1990 - 1995

Source map scale - 1:10,000

The historical maps shown were reproduced from maps predominantly held at the Ordnance Survey for England, Wales and Scotland in the 1940's. In 1954 the 1:2,500 scale was adopted for mapping urban areas; these maps were used to update the 1:10,000 maps. The published data shown therefore is often some years later than the surveyed data. Before 1933, all OS maps were based on the Cassini Projection, with independent surveys of a single county or group of counties, giving rise to significant inaccuracies in adjoining sheets. In 1948, a Provisional Ordnance Survey was produced, which updated the 1:10,000 scale maps from the Cassini Projection to the Transverse Mercator Projection. These maps were initially overlaid with the National Grid. In 1970, the first 1:10,000 maps were produced using the Transverse Mercator Projection. The revision process continued until recently, with new editions appearing every 10 years or so for urban areas.

Map Name(s) and Data(s)

TO18SE	TO18SW
1800	1800
110,000	110,000
TO17NW	TO17SW
1800	1800
110,000	110,000

Historical Map - Slice A

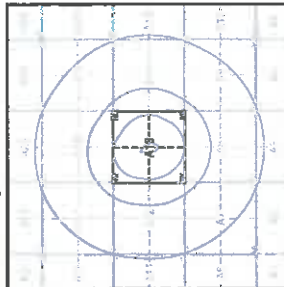

Order Details

Order Number: 46303056 1 1

Customer Ref: J-M0167.00/MK001

National Grid Reference: 509730, 180080

Site: A

Site Area (Ha): 1.01

Search Buffer (m): 1000

Site Details

Hayes Swimming Pool, Botwell Lane, HAYES, Middlesex, UB3 2BG



Tel: 0844 944 9922
Fax: 0844 944 9923
Web: www.landmark.co.uk



10k Raster Mapping

Published 2006

Source map scale - 1:10,000

The historical maps shown were produced from the Ordnance Survey's 1:10,000 colour raster mapping. These maps are derived from information in high detailed contour, buildings, roads, railways, and field boundaries as well as all roads, tracks and paths. Road names are also included together with the relevant road number and classification. Boundary information depicts includes county, unitary authority, district, civil parish and constituency.

Map Name(s) and Date(s)

TO08SE	TO18SW
2006	2006
1:10,000	1:10,000
TO07NE	TO17NW
2006	2006
1:10,000	1:10,000

Historical Map - Slice A

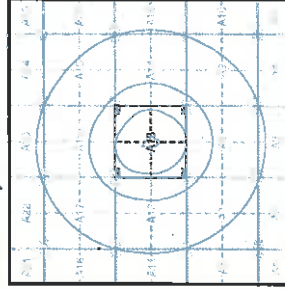

Order Details

Order Number: 46303656 1.1
Customer Ref: J-M0167.00/MK001
National Grid Reference: 509730, 180080
Slice: A
Site Area (Ha): 1.01
Search Buffer (m): 1000

Site Details

Hayes Swimming Pool, Botwell Lane, HAYES, Middlesex, UB3 2BG



Tel: 0844 844 8852
Fax: 0844 844 8851
Web: www.landmark.co.uk



10k Raster Mapping

Published 2013

Source map scale - 1:10,000

The historical maps shown were produced from the Ordnance Survey's 1:10,000 colour raster mapping. These maps are derived from Landplan which replaced the old 1:10,000 maps originally published in 1970. The data is highly detailed showing buildings, fences and field boundaries as well as all roads, tracks and paths. Road names are also included together with the relevant road number and classification. Boundary information depicts all county, unitary authority, district, civil parish and constituency.

Map Name(s) and Date(s)

TO08SE	TO18SW
2013	2013
1:10,000	1:10,000
TO07NE	TO17NW
2013	2013
1:10,000	1:10,000

Historical Map - Slice A

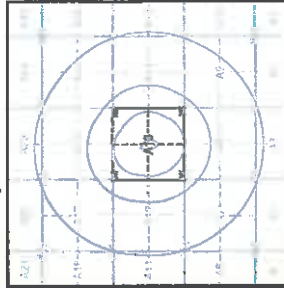

Order Details

Order Number: 46303056.1.1
Customer Ref: J-M0167.00/MK001
National Grid Reference: 509730, 180080

Slice: A
Site Area (Ha): 1.01
Search Buffer (m): 1000

Site Details

Hayes Swimming Pool, Bobwell Lane, HAYES, Middlesex, UB3 2BG



Tel: 0844 844 5852
Fax: 0844 844 5851
Web: www.landmark.co.uk



Envirocheck® Report: Datasheet

Order Details:

Order Number:

46303056_1_1

Customer Reference:

J-M0167.00/MK001

National Grid Reference:

509730, 180080

Slice:

A

Site Area (Ha):

1.01

Search Buffer (m):

1000

Site Details:

Hayes Swimming Pool

Botwell Lane

HAYES

Middlesex

UB3 2BG

Client Details:

MR M Grant

Opus International Consultants (UK) Ltd

Modulus House

Salterns Lane

Fareham

Hampshire

PO16 0QS

Report Section	Page Number
Summary	-
Agency & Hydrological	1
Waste	19
Hazardous Substances	21
Geological	22
Industrial Land Use	36
Sensitive Land Use	68
Data Currency	69
Data Suppliers	74
Useful Contacts	75

Introduction

The Environment Act 1995 has made site sensitivity a key issue, as the legislation pays as much attention to the pathways by which contamination could spread, and to the vulnerable targets of contamination, as it does the potential sources of contamination. For this reason, Landmark's Site Sensitivity maps and Datasheet(s) place great emphasis on statutory data provided by the Environment Agency and the Scottish Environment Protection Agency; it also incorporates data from Natural England (and the Scottish and Welsh equivalents) and Local Authorities; and highlights hydrogeological features required by environmental and geotechnical consultants. It does not include any information concerning past uses of land. The datasheet is produced by querying the Landmark database to a distance defined by the client from a site boundary provided by the client.

In the attached datasheet the National Grid References (NGRs) are rounded to the nearest 10m in accordance with Landmark's agreements with a number of Data Suppliers.

Copyright Notice

© Landmark Information Group Limited 2013. The Copyright on the information and data and its format as contained in this Envirocheck® Report ("Report") is the property of Landmark Information Group Limited ("Landmark") and several other Data Providers, including (but not limited to) Ordnance Survey, British Geological Survey, the Environment Agency and Natural England, and must not be reproduced in whole or in part by photocopying or any other method. The Report is supplied under Landmark's Terms and Conditions accepted by the Customer. A copy of Landmark's Terms and Conditions can be found with the Index Map for this report. Additional copies of the Report may be obtained from Landmark, subject to Landmark's charges in force from time to time. The Copyright, design rights and any other intellectual rights shall remain the exclusive property of Landmark and /or other Data providers, whose Copyright material has been included in this Report.

Natural England Copyright Notice

Site of Special Scientific Interest, National Nature Reserve, Ramsar, Special Protection Area, Special Conservation Area, Marine Nature Reserve data (derived from Ordnance Survey 1:10000 raster) is provided by, and used with the permission of, Natural England who retain the copyright and Intellectual Property Rights for the data.

Ove Arup Copyright Notice

The Data provided in this report was obtained on Licence from Ove Arup & Partners Limited (for further information, contact mining.review@arup.com). No reproduction or further use of such Data is to be made without the prior written consent of Ove Arup & Partners Limited. The information and data supplied in the product are derived from publicly available records and other third party sources and neither Ove Arup & Partners nor Landmark warrant the accuracy or completeness of such information or data.

Peter Brett Associates Copyright Notice

The cavity data presented has been extracted from the PBA enhanced version of the original DEFRA national cavity databases. PBA/DEFRA retain the copyright & intellectual property rights in the data. Whilst all reasonable efforts are made to check that the information contained in the cavity databases is accurate we do not warrant that the data is complete or error free. The information is based upon our own researches and those collated from a number of external sources and is continually being augmented and updated by PBA. In no event shall PBA/DEFRA or Landmark be liable for any loss or damage including, without limitation, indirect or consequential loss or damage arising from the use of this data.

Radon Potential dataset Copyright Notice

Information supplied from a joint dataset compiled by The British Geological Survey and the Health Protection Agency.

Report Version v47.0

Data Type	Page Number	On Site	0 to 250m	251 to 500m	501 to 1000m (*up to 2000m)
Agency & Hydrological					
Contaminated Land Register Entries and Notices					
Discharge Consents	pg 1			2	
Enforcement and Prohibition Notices					
Integrated Pollution Controls	pg 1			1	5
Integrated Pollution Prevention And Control	pg 2				6
Local Authority Integrated Pollution Prevention And Control					
Local Authority Pollution Prevention and Controls	pg 4			2	8
Local Authority Pollution Prevention and Control Enforcements					
Nearest Surface Water Feature	pg 5			Yes	
Pollution Incidents to Controlled Waters	pg 5			17	19
Prosecutions Relating to Authorised Processes					
Prosecutions Relating to Controlled Waters					
Registered Radioactive Substances	pg 11				2
River Quality	pg 11			1	
River Quality Biology Sampling Points					
River Quality Chemistry Sampling Points					
Substantiated Pollution Incident Register					
Water Abstractions	pg 12			2	4 (*15)
Water Industry Act Referrals	pg 17				2
Groundwater Vulnerability	pg 17	Yes	n/a	n/a	n/a
Bedrock Aquifer Designations	pg 17	Yes	n/a	n/a	n/a
Superficial Aquifer Designations	pg 17	Yes	n/a	n/a	n/a
Source Protection Zones					
Extreme Flooding from Rivers or Sea without Defences				n/a	n/a
Flooding from Rivers or Sea without Defences				n/a	n/a
Areas Benefiting from Flood Defences				n/a	n/a
Flood Water Storage Areas				n/a	n/a
Flood Defences				n/a	n/a
Waste					
BGS Recorded Landfill Sites					
Historical Landfill Sites	pg 19				3
Integrated Pollution Control Registered Waste Sites					
Licensed Waste Management Facilities (Landfill Boundaries)					
Licensed Waste Management Facilities (Locations)	pg 19				2
Local Authority Recorded Landfill Sites					
Registered Landfill Sites					
Registered Waste Transfer Sites	pg 20				3
Registered Waste Treatment or Disposal Sites					

Data Type	Page Number	On Site	0 to 250m	251 to 500m	501 to 1000m (*up to 2000m)
Hazardous Substances					
Control of Major Accident Hazards Sites (COMAH)					
Explosive Sites	pg 21				1
Notification of Installations Handling Hazardous Substances (NIHHS)					
Planning Hazardous Substance Consents					
Planning Hazardous Substance Enforcements					
Geological					
BGS 1:625,000 Solid Geology	pg 22	Yes	n/a	n/a	n/a
BGS Estimated Soil Chemistry	pg 22	Yes	Yes	Yes	Yes
BGS Recorded Mineral Sites	pg 28		1	2	8
BGS Urban Soil Chemistry	pg 30		Yes	Yes	Yes
BGS Urban Soil Chemistry Averages	pg 33	Yes			
Brine Compensation Area			n/a	n/a	n/a
Coal Mining Affected Areas			n/a	n/a	n/a
Mining Instability			n/a	n/a	n/a
Man-Made Mining Cavities					
Natural Cavities					
Non Coal Mining Areas of Great Britain				n/a	n/a
Potential for Collapsible Ground Stability Hazards	pg 33	Yes	Yes	n/a	n/a
Potential for Compressible Ground Stability Hazards	pg 33		Yes	n/a	n/a
Potential for Ground Dissolution Stability Hazards				n/a	n/a
Potential for Landslide Ground Stability Hazards	pg 34	Yes	Yes	n/a	n/a
Potential for Running Sand Ground Stability Hazards	pg 34		Yes	n/a	n/a
Potential for Shrinking or Swelling Clay Ground Stability Hazards	pg 34	Yes	Yes	n/a	n/a
Radon Potential - Radon Affected Areas			n/a	n/a	n/a
Radon Potential - Radon Protection Measures			n/a	n/a	n/a
Industrial Land Use					
Contemporary Trade Directory Entries	pg 36		43	94	231
Fuel Station Entries	pg 67		1	1	2

Data Type	Page Number	On Site	0 to 250m	251 to 500m	501 to 1000m (*up to 2000m)
Sensitive Land Use					
Areas of Adopted Green Belt	pg 68		1		2
Areas of Unadopted Green Belt	pg 68		1		2
Areas of Outstanding Natural Beauty					
Environmentally Sensitive Areas					
Forest Parks					
Local Nature Reserves					
Marine Nature Reserves					
National Nature Reserves					
National Parks					
Nitrate Sensitive Areas					
Nitrate Vulnerable Zones	pg 68		1		
Ramsar Sites					
Sites of Special Scientific Interest					
Special Areas of Conservation					
Special Protection Areas					

Map ID	Details	Quadrant Reference (Compass Direction)	Estimated Distance From Site	Contact	NGR
1	Discharge Consents Operator: Ubs Ag Property Type: Office/Data Proc Equip Manufacture Location: Ubs Ag Clayton Road Hayes Middlesex Ub3 1ax Authority: Environment Agency, Thames Region Catchment Area: Not Supplied Reference: Npswqd003883 Permit Version: 2 Effective Date: 26th August 2010 Issued Date: 26th August 2010 Revocation Date: Not Supplied Discharge Type: Trade Discharges - Cooling Water Discharge: Canal Environment: Grand Union Canal Receiving Water: Grand Union Canal Status: Varied under EPR 2010 Positional Accuracy: Located by supplier to within 10m	A12SE (SW)	422	1	509311 179860
1	Discharge Consents Operator: Ubs Ag Property Type: Office/Data Proc Equip Manufacture Location: Ubs Ag Clayton Road Hayes Middlesex Ub3 1ax Authority: Environment Agency, Thames Region Catchment Area: Not Supplied Reference: Npswqd003883 Permit Version: 1 Effective Date: 7th December 2008 Issued Date: 7th December 2008 Revocation Date: 25th August 2010 Discharge Type: Trade Discharges - Cooling Water Discharge: Canal Environment: Grand Union Canal Receiving Water: Grand Union Canal Status: New Consent (Water Resources Act 1991, Section 88 & Schedule 10 as amended by Environment Act 1995) Positional Accuracy: Located by supplier to within 10m	A12SE (SW)	422	1	509311 179860
2	Integrated Pollution Controls Name: Owen Coyle (anodising) Ltd Location: Alpha Works, Blyth Road, HAYES, Middlesex, UB3 1AN Authority: Environment Agency, Thames Region Permit Reference: AL7148 Dated: Not Supplied Process Type: Withdrawn IPC application Description: 4.3 A (F) Acid processes within the Chemical Industry Status: Application referred to Local Authority for consideration Positional Accuracy: Automatically positioned to the address	A8NW (SW)	461	1	509436 179638
3	Integrated Pollution Controls Name: Nestle Uk Ltd Location: Nestle Grocery Division, Nestles Avenue, HAYES, Middlesex, UB3 4RF Authority: Environment Agency, Thames Region Permit Reference: BC5938 Dated: 24th November 1998 Process Type: IPC minor (non-substantial) variation to previous variation Description: 1.3 A (A) Combustion processes within the Fuel & Power Industry Status: Authorisation superseded by a substantial or non substantial variationSuperseded Positional Accuracy: Automatically positioned to the address	A9SW (SE)	857	1	510152 179247
3	Integrated Pollution Controls Name: Nestle Uk Ltd Location: Nestles Avenue, HAYES, Middlesex, UB3 4RF Authority: Environment Agency, Thames Region Permit Reference: AI6740 Dated: 31st December 1993 Process Type: IPC major (substantial) variation Description: 1.3 A (A) Combustion processes within the Fuel & Power Industry Status: Authorisation superseded by a substantial or non substantial variationSuperseded Positional Accuracy: Automatically positioned to the address	A9SW (SE)	857	1	510152 179247
3	Integrated Pollution Controls Name: Nestle Uk Ltd Location: Nestle Grocery Division, Nestles Avenue, HAYES, Middlesex, UB3 4RF Authority: Environment Agency, Thames Region Permit Reference: BE6988 Dated: 4th December 2002 Process Type: IPC minor (non-substantial) variation to previous variation Description: 1.3 A (A) Combustion processes within the Fuel & Power Industry Status: Revoked - Now IPPC Positional Accuracy: Automatically positioned to the address	A9SW (SE)	862	1	510152 179242

Map ID	Details	Quadrant Reference (Compass Direction)	Estimated Distance From Site	Contact	NGR
3	Integrated Pollution Controls Name: Nestle Uk Ltd Location: Nestle Grocery Division, Nestles Avenue, HAYES, Middlesex, UB3 4RF Authority: Environment Agency, Thames Region Permit Reference: AF8106 Dated: 29th October 1992 Process Type: IPC new application Description: 1.3 A (C) Combustion processes within the Fuel & Power Industry Status: Authorisation superseded by a substantial or non substantial variation Superseded Positional Accuracy: Automatically positioned to the address	A9SW (SE)	862	1	510152 179242
4	Integrated Pollution Controls Name: HAWKER PACIFIC AEROSPACE LTD Location: UNIT 3 DAWLEY PARK KESTREL WAY, HAYES, MIDDLESEX, UB3 1HP Authority: Environment Agency, Thames Region Permit Reference: BG6588 Dated: 12th November 1999 Process Type: IPC new application Description: 4.5 A (H) Inorganic Chemical processes within the Chemical Industry Status: Revoked - Now IPPC Positional Accuracy: Located by supplier to within 100m	A7NW (SW)	995	1	508800 179600
5	Integrated Pollution Prevention And Control Name: Owen Coyle Anodising Limited Location: Owen Coyle (Anodising) Ltd, Alpha Works, Blyth Road, Hayes, Middlesex, UB3 1DE Authority: Environment Agency, Thames Region Permit Reference: Bp0334lm Original Permit Ref: Bp0334lm Effective Date: 12th January 2005 Status: Superseded By Variation Application Type: Application App. Sub Type: New Positional Accuracy: Manually positioned to the road within the address or location Activity Code: 2.2 B (A) Activity Description: Surface Treating Metals & Plastics; With Release To Air Of Oxides Of Nitrogen Primary Activity: N Activity Code: 2.3 A(1) (A) Activity Description: Surface Treating Metals And Plastics; Electrolytic/Chemical Greater Than 30 Cubic Metres Primary Activity: Y	A8NW (S)	527	1	509558 179499
6	Integrated Pollution Prevention And Control Name: Owen Coyle Anodising Limited Location: Owen Coyle (Anodising) Ltd, Alpha Works, Blyth Road,,, Hayes, Middlesex, UB3 1DE Authority: Environment Agency - South East Region, North East Thames Area Permit Reference: WP3233MM Original Permit Ref: Bp0334lm Effective Date: 1st July 2007 Status: Effective Application Type: Variation App. Sub Type: Standard Positional Accuracy: Located by supplier to within 100m Activity Code: 2.2 B (A) Activity Description: Surface Treating Metals & Plastics; With Release To Air Of Oxides Of Nitrogen Primary Activity: N Activity Code: 5.3 A(1) (C) (II) Activity Description: Other Waste Disposal; Non-Hazardous Waste >50T/D By Physico-Chemical Treatment Primary Activity: N Activity Code: 2.3 A(1) (A) Activity Description: Surface Treating Metals And Plastics; Electrolytic/Chemical Greater Than 30 Cubic Metres Primary Activity: Y	A7NE (SW)	582	1	509300 179600

Map ID	Details	Quadrant Reference (Compass Direction)	Estimated Distance From Site	Contact	NGR
6	Integrated Pollution Prevention And Control Name: Owen Coyle Anodising Limited Location: Owen Coyle (Anodising) Ltd, Alpha Works, Hayes, Middlesex, UB3 1DE Authority: Environment Agency, Thames Region Permit Reference: WP3233MM Original Permit Ref: Bp0334lm Effective Date: 1st July 2007 Status: Effective Application Type: Variation App. Sub Type: Standard Positional Accuracy: Located by supplier to within 100m Activity Code: 2.3 A(1) (A) Activity Description: Surface Treating Metals And Plastics; Electrolytic/Chemical Greater Than 30 Cubic Metres Primary Activity: Y Activity Code: 5.3 A(1) (C) (II) Activity Description: Other Waste Disposal; Non-Hazardous Waste >50T/D By Physico-Chemical Treatment Primary Activity: N Activity Code: 2.2 B (A) Activity Description: Surface Treating Metals & Plastics; With Release To Air Of Oxides Of Nitrogen Primary Activity: N	A7NE (SW)	582	1	509300 179600
6	Integrated Pollution Prevention And Control Name: Owen Coyle Anodising Limited Location: Owen Coyle (Anodising) Ltd, Alpha Works, Blyth Road,,, Hayes, Middlesex, UB3 1DE Authority: Environment Agency - South East Region, North East Thames Area Permit Reference: BP0334IM Original Permit Ref: Bp0334lm Effective Date: 12th January 2005 Status: Superseded By Variation Application Type: Application App. Sub Type: New Positional Accuracy: Located by supplier to within 100m Activity Code: 2.2 B (A) Activity Description: Surface Treating Metals & Plastics; With Release To Air Of Oxides Of Nitrogen Primary Activity: N Activity Code: 2.3 A(1) (A) Activity Description: Surface Treating Metals And Plastics; Electrolytic/Chemical Greater Than 30 Cubic Metres Primary Activity: Y	A7NE (SW)	582	1	509300 179600
7	Integrated Pollution Prevention And Control Name: Nestle Uk Ltd Location: Hayes Boiler Houses And Roasters, North Hyde Gardens, North Hyde Gardens,,, HAYES, Middlesex, UB3 4RF Authority: Environment Agency - South East Region, North East Thames Area Permit Reference: VP3332ST Original Permit Ref: Vp3332st Effective Date: 27th February 2007 Status: Effective Application Type: Application App. Sub Type: New Positional Accuracy: Automatically positioned to the address Activity Code: 1.1 A(1) (A) Activity Description: Combustion; Any Fuel Greater Or Equal To 50Mw Primary Activity: Y	A9SW (SE)	857	1	510152 179247
7	Integrated Pollution Prevention And Control Name: Nestle Uk Ltd Location: North Hyde Gardens, Hayes, Middlesex, UB3 4RF Authority: Environment Agency, Thames Region Permit Reference: VP3332ST Original Permit Ref: Vp3332st Effective Date: 27th February 2007 Status: Effective Application Type: Application App. Sub Type: New Positional Accuracy: Automatically positioned to the address Activity Code: 1.1 A(1) (A) Activity Description: Combustion; Any Fuel Greater Or Equal To 50Mw Primary Activity: Y	A9SW (SE)	857	1	510152 179247

Map ID	Details	Quadrant Reference (Compass Direction)	Estimated Distance From Site	Contact	NGR
8	Local Authority Pollution Prevention and Controls Name: Direct Line Management Limited Location: Clayton Road, HAYES, Middlesex, UB3 1AX Authority: London Borough of Hillingdon, Environmental Health Department Permit Reference: B3/28 Dated: Not Supplied Process Type: Local Authority Air Pollution Control Description: PG6/34 Respraying of road vehicles Status: Authorisation revokedRevoked Positional Accuracy: Manually positioned to the road within the address or location	A7NE (SW)	463	2	509384 179684
9	Local Authority Pollution Prevention and Controls Name: Owen Coyle (Anodising) Ltd Location: Alpha Works, Blyth Road, HAYES, Middlesex, UB3 1AN Authority: London Borough of Hillingdon, Environmental Health Department Permit Reference: B2/15 Dated: Not Supplied Process Type: Local Authority Air Pollution Control Description: PG4/1 Processes for the surface treatment of metals Status: Authorised Positional Accuracy: Automatically positioned to the address	A8NW (SW)	465	2	509436 179633
10	Local Authority Pollution Prevention and Controls Name: Total Hayes Plc Location: Coldharbour Lane, HAYES, Middlesex, UB3 3HG Authority: London Borough of Hillingdon, Environmental Health Department Permit Reference: EPA/SS/1/037/1 1/1998 Dated: Not Supplied Process Type: Local Authority Air Pollution Control Description: PG1/14 Petrol filling station Status: Authorised Positional Accuracy: Automatically positioned to the address	A14NW (NE)	541	2	510254 180357
11	Local Authority Pollution Prevention and Controls Name: Thomson Thorn Missile Group Location: 120 Blyth Road, HAYES, Middlesex, UB3 1DL Authority: London Borough of Hillingdon, Environmental Health Department Permit Reference: B3/08 Dated: Not Supplied Process Type: Local Authority Air Pollution Control Description: PG6/23 Coating of metal and plastic Status: Authorisation revokedRevoked Positional Accuracy: Manually positioned to the road within the address or location	A7NE (SW)	559	2	509337 179595
12	Local Authority Pollution Prevention and Controls Name: Mays (Pressure Diecasting) Ltd Location: Unit 9 Silverdale Industrial Estate, Silverdale Road, HAYES, Middlesex, UB3 3BL Authority: London Borough of Hillingdon, Environmental Health Department Permit Reference: EPA/B2/12 Dated: Not Supplied Process Type: Local Authority Pollution Prevention and Control Description: PG2/6 Aluminium and aluminium alloy processes Status: Permitted Positional Accuracy: Manually positioned to the address or location	A8NE (SE)	585	2	510046 179500
12	Local Authority Pollution Prevention and Controls Name: Mays (Pressure Diecasting) Ltd Location: Unit 9 Silverdale Industrial Estate, Silverdale Road, HAYES, Middlesex, UB3 3BL Authority: London Borough of Hillingdon, Environmental Health Department Permit Reference: B2/12 Dated: Not Supplied Process Type: Local Authority Air Pollution Control Description: PG2/7 Zinc and zinc alloy processes Status: Authorisation revokedRevoked Positional Accuracy: Manually positioned to the address or location	A8NE (SE)	585	2	510046 179500
13	Local Authority Pollution Prevention and Controls Name: Thom Microwave Devices Ltd Location: 248 Blyth Road, HAYES, Middlesex, UB3 1HR Authority: London Borough of Hillingdon, Environmental Health Department Permit Reference: B3/07 Dated: Not Supplied Process Type: Local Authority Air Pollution Control Description: PG6/23 Coating of metal and plastic Status: Authorisation revokedRevoked Positional Accuracy: Automatically positioned to the address	A7NE (SW)	670	2	509193 179589

Map ID	Details	Quadrant Reference (Compass Direction)	Estimated Distance From Site	Contact	NGR
14	Local Authority Pollution Prevention and Controls Name: Dagenham Motors (Hayes) Ltd Location: Dawley Road, HAYES, Middlesex, UB3 1EH Authority: London Borough of Hillingdon, Environmental Health Department Permit Reference: B1/01 Dated: Not Supplied Process Type: Local Authority Air Pollution Control Description: PG1/1Waste oil burners, less than 0.4MW net rated thermal input Status: Authorised Positional Accuracy: Manually positioned to the road within the address or location	A12SW (SW)	760	2	508981 179772
15	Local Authority Pollution Prevention and Controls Name: Tesco North Hyde Road Location: North Hyde Road, HAYES, Middlesex, UB3 4NE Authority: London Borough of Hillingdon, Environmental Health Department Permit Reference: EPA/SS/1/022/09/1998 Dated: Not Supplied Process Type: Local Authority Air Pollution Control Description: PG1/14 Petrol filling station Status: Authorised Positional Accuracy: Automatically positioned to the address	A8SW (S)	863	2	509676 179136
16	Local Authority Pollution Prevention and Controls Name: Tarmac Roadstone Hayes Location: Hayes Works, Pump Lane, HAYES, Middlesex, UB3 3LZ Authority: London Borough of Hillingdon, Environmental Health Department Permit Reference: EPA/B2/004 Dated: Not Supplied Process Type: Local Authority Air Pollution Control Description: PG3/15 Mineral drying and roadstone coating processes Status: Authorised Positional Accuracy: Manually positioned to the address or location	A9NE (SE)	915	2	510534 179534
	Nearest Surface Water Feature	A13SW (SW)	300	-	509551 179752
17	Pollution Incidents to Controlled Waters Property Type: Not Given Location: Station Road, HAYES Authority: Environment Agency, Thames Region Pollutant: Unknown Sewage Note: Confirmed As A Pollution Incident Incident Date: 7th March 1990 Incident Reference: N1900096 Catchment Area: Not Given Receiving Water: Not Given Cause of Incident: Not Given Incident Severity: Category 3 - Minor Incident Positional Accuracy: Located by supplier to within 100m	A8NE (S)	304	1	509800 179700
18	Pollution Incidents to Controlled Waters Property Type: Not Given Location: HAYES Authority: Environment Agency, Thames Region Pollutant: Agricultural: General Note: Confirmed As A Pollution Incident Incident Date: 3rd October 1991 Incident Reference: N1910542 Catchment Area: Not Given Receiving Water: Not Given Cause of Incident: Not Given Incident Severity: Category 3 - Minor Incident Positional Accuracy: Located by supplier to within 100m	A13SW (SW)	325	1	509400 179900
18	Pollution Incidents to Controlled Waters Property Type: Not Given Location: HAYES Authority: Environment Agency, Thames Region Pollutant: Miscellaneous - Unknown Note: Confirmed As A Pollution Incident Incident Date: 9th March 1995 Incident Reference: N1950111 Catchment Area: Not Given Receiving Water: Not Given Cause of Incident: Not Given Incident Severity: Category 3 - Minor Incident Positional Accuracy: Located by supplier to within 100m	A13SW (SW)	327	1	509400 179895

Map ID	Details	Quadrant Reference (Compass Direction)	Estimated Distance From Site	Contact	NGR
19	Pollution Incidents to Controlled Waters Property Type: Not Given Location: HAYES Authority: Environment Agency, Thames Region Pollutant: Unknown Sewage Note: Confirmed As A Pollution Incident Incident Date: Not Supplied Incident Reference: N1910099 Catchment Area: Not Given Receiving Water: Not Given Cause of Incident: Not Given Incident Severity: Category 3 - Minor Incident Positional Accuracy: Located by supplier to within 100m	A8NW (SW)	373	1	509500 179700
19	Pollution Incidents to Controlled Waters Property Type: Not Given Location: Printhouse Lane, HAYES Authority: Environment Agency, Thames Region Pollutant: Oils - Unknown Note: Not Supplied Incident Date: 2nd October 1997 Incident Reference: THN11997030086 Catchment Area: Not Given Receiving Water: Not Given Cause of Incident: Not Given Incident Severity: Category 3 - Minor Incident Positional Accuracy: Located by supplier to within 100m	A8NW (SW)	377	1	509500 179695
20	Pollution Incidents to Controlled Waters Property Type: Not Given Location: HAYES Authority: Environment Agency, Thames Region Pollutant: Oils - Unknown Note: Confirmed As A Pollution Incident Incident Date: 3rd November 1994 Incident Reference: NE940821 Catchment Area: Not Given Receiving Water: Not Given Cause of Incident: Not Given Incident Severity: Category 3 - Minor Incident Positional Accuracy: Located by supplier to within 100m	A13SW (SW)	376	1	509400 179800
21	Pollution Incidents to Controlled Waters Property Type: Not Given Location: HAYES Authority: Environment Agency, Thames Region Pollutant: Oils - Unknown Note: Confirmed As A Pollution Incident Incident Date: 28th March 1990 Incident Reference: N1900146 Catchment Area: Not Given Receiving Water: Not Given Cause of Incident: Not Given Incident Severity: Category 3 - Minor Incident Positional Accuracy: Located by supplier to within 100m	A8NE (S)	403	1	509800 179600
21	Pollution Incidents to Controlled Waters Property Type: Not Given Location: Silverdale Road Authority: Environment Agency, Thames Region Pollutant: Chemicals - Unknown Note: Confirmed As A Pollution Incident Incident Date: 25th June 1990 Incident Reference: N1900346 Catchment Area: Not Given Receiving Water: Not Given Cause of Incident: Not Given Incident Severity: Category 3 - Minor Incident Positional Accuracy: Located by supplier to within 100m	A8NE (S)	408	1	509800 179595
21	Pollution Incidents to Controlled Waters Property Type: Not Given Location: Dawley Road, HAYES Authority: Environment Agency, Thames Region Pollutant: Unknown Sewage Note: Confirmed As A Pollution Incident Incident Date: Not Supplied Incident Reference: N1900114 Catchment Area: Not Given Receiving Water: Not Given Cause of Incident: Not Given Incident Severity: Category 3 - Minor Incident Positional Accuracy: Located by supplier to within 100m	A8NE (S)	408	1	509805 179595

Map ID	Details	Quadrant Reference (Compass Direction)	Estimated Distance From Site	Contact	NGR
22	Pollution Incidents to Controlled Waters Property Type: Not Given Location: Printing House, HAYES Authority: Environment Agency, Thames Region Pollutant: Miscellaneous - Unknown Note: Confirmed As A Pollution Incident Incident Date: 23rd September 1989 Incident Reference: N1890505 Catchment Area: Not Given Receiving Water: Not Given Cause of Incident: Not Given Incident Severity: Category 3 - Minor Incident Positional Accuracy: Located by supplier to within 100m	A12SE (SW)	416	1	509350 179800
22	Pollution Incidents to Controlled Waters Property Type: Not Given Location: HAYES Authority: Environment Agency, Thames Region Pollutant: Oils - Unknown Note: Confirmed As A Pollution Incident Incident Date: 1st March 1994 Incident Reference: NE940131 Catchment Area: Not Given Receiving Water: Not Given Cause of Incident: Not Given Incident Severity: Category 3 - Minor Incident Positional Accuracy: Located by supplier to within 100m	A12SE (SW)	419	1	509350 179795
23	Pollution Incidents to Controlled Waters Property Type: Not Given Location: Blythe Road Authority: Environment Agency, Thames Region Pollutant: Chemicals - Unknown Note: Confirmed As A Pollution Incident Incident Date: Not Supplied Incident Reference: N1890411 Catchment Area: Not Given Receiving Water: Not Given Cause of Incident: Not Given Incident Severity: Category 2 - Significant Incident Positional Accuracy: Located by supplier to within 100m	A12SE (SW)	417	1	509300 179900
24	Pollution Incidents to Controlled Waters Property Type: Not Given Location: Coldharbour, HAYES Authority: Environment Agency, Thames Region Pollutant: Chemicals - Unknown Note: Confirmed As A Pollution Incident Incident Date: Not Supplied Incident Reference: N1890570 Catchment Area: Not Given Receiving Water: Not Given Cause of Incident: Not Given Incident Severity: Category 2 - Significant Incident Positional Accuracy: Located by supplier to within 100m	A12SE (SW)	418	1	509300 179895
24	Pollution Incidents to Controlled Waters Property Type: Not Given Location: HAYES Authority: Environment Agency, Thames Region Pollutant: Unknown Sewage Note: Confirmed As A Pollution Incident Incident Date: 8th February 1990 Incident Reference: N1900053 Catchment Area: Not Given Receiving Water: Not Given Cause of Incident: Not Given Incident Severity: Category 3 - Minor Incident Positional Accuracy: Located by supplier to within 100m	A12SE (SW)	427	1	509310 179850
25	Pollution Incidents to Controlled Waters Property Type: Not Given Location: GREENFORD Authority: Environment Agency, Thames Region Pollutant: Oils - Unknown Note: Confirmed As A Pollution Incident Incident Date: 8th January 1994 Incident Reference: NE940014 Catchment Area: Not Given Receiving Water: Not Given Cause of Incident: Not Given Incident Severity: Category 3 - Minor Incident Positional Accuracy: Located by supplier to within 100m	A14NW (E)	429	1	510200 180200

Map ID	Details	Quadrant Reference (Compass Direction)	Estimated Distance From Site	Contact	NGR
26	Pollution Incidents to Controlled Waters Property Type: Not Given Location: HAYES Authority: Environment Agency, Thames Region Pollutant: Chemicals - Unknown Note: Confirmed As A Pollution Incident Incident Date: 19th August 1992 Incident Reference: NE920445 Catchment Area: Not Given Receiving Water: Not Given Cause of Incident: Not Given Incident Severity: Category 3 - Minor Incident Positional Accuracy: Located by supplier to within 100m	A8NW (SW)	457	1	509500 179600
27	Pollution Incidents to Controlled Waters Property Type: Not Given Location: Station Road, HAYES Authority: Environment Agency, Thames Region Pollutant: Chemicals - Unknown Note: Confirmed As A Pollution Incident Incident Date: 27th February 1991 Incident Reference: N1910092 Catchment Area: Not Given Receiving Water: Not Given Cause of Incident: Not Given Incident Severity: Category 3 - Minor Incident Positional Accuracy: Located by supplier to within 100m	A8NW (S)	498	1	509700 179500
27	Pollution Incidents to Controlled Waters Property Type: Not Given Location: Station Road, HAYES Authority: Environment Agency, Thames Region Pollutant: Unknown Sewage Note: Confirmed As A Pollution Incident Incident Date: 14th March 1991 Incident Reference: N1910127 Catchment Area: Not Given Receiving Water: Not Given Cause of Incident: Not Given Incident Severity: Category 3 - Minor Incident Positional Accuracy: Located by supplier to within 100m	A8NW (S)	503	1	509700 179495
28	Pollution Incidents to Controlled Waters Property Type: Not Given Location: HAYES Authority: Environment Agency, Thames Region Pollutant: Unknown Sewage Note: Confirmed As A Pollution Incident Incident Date: 2nd October 1991 Incident Reference: N1910541 Catchment Area: Not Given Receiving Water: Not Given Cause of Incident: Not Given Incident Severity: Category 3 - Minor Incident Positional Accuracy: Located by supplier to within 100m	A8NE (S)	502	1	509800 179500
29	Pollution Incidents to Controlled Waters Property Type: Not Given Location: Silverdale Road, HAYES Authority: Environment Agency, Thames Region Pollutant: Chemicals - Unknown Note: Confirmed As A Pollution Incident Incident Date: 30th April 1990 Incident Reference: N1900194 Catchment Area: Not Given Receiving Water: Not Given Cause of Incident: Not Given Incident Severity: Category 2 - Significant Incident Positional Accuracy: Located by supplier to within 100m	A8NE (S)	524	1	509900 179500
30	Pollution Incidents to Controlled Waters Property Type: Not Given Location: Pump Lane, HAYES Authority: Environment Agency, Thames Region Pollutant: Chemicals - Unknown Note: Not Supplied Incident Date: 29th October 1996 Incident Reference: N1960561 Catchment Area: Not Given Receiving Water: Not Given Cause of Incident: Not Given Incident Severity: Category 3 - Minor Incident Positional Accuracy: Located by supplier to within 100m	A9NW (SE)	544	1	510200 179700

Map ID	Details	Quadrant Reference (Compass Direction)	Estimated Distance From Site	Contact	NGR
31	Pollution Incidents to Controlled Waters Property Type: Not Given Location: Argyle Warehouse Authority: Environment Agency, Thames Region Pollutant: Chemicals - Unknown Note: Confirmed As A Pollution Incident Incident Date: 12th January 1989 Incident Reference: N1890020 Catchment Area: Not Given Receiving Water: Not Given Cause of Incident: Not Given Incident Severity: Category 2 - Significant Incident Positional Accuracy: Located by supplier to within 100m	A9NW (SE)	614	1	510100 179500
31	Pollution Incidents to Controlled Waters Property Type: Not Given Location: Silverdale Road, HAYES Authority: Environment Agency, Thames Region Pollutant: Chemicals - Unknown Note: Yes Incident Date: 6th March 1991 Incident Reference: N1910110 Catchment Area: Not Given Receiving Water: Not Given Cause of Incident: Not Given Incident Severity: Category 3 - Minor Incident Positional Accuracy: Located by supplier to within 100m	A9NW (SE)	618	1	510100 179495
32	Pollution Incidents to Controlled Waters Property Type: Not Given Location: Railway Bridge Over, HAYES Authority: Environment Agency, Thames Region Pollutant: Oils - Unknown Note: Not Supplied Incident Date: 16th June 1996 Incident Reference: N1960305 Catchment Area: Not Given Receiving Water: Not Given Cause of Incident: Not Given Incident Severity: Category 3 - Minor Incident Positional Accuracy: Located by supplier to within 100m	A9NW (SE)	644	1	510150 179500
33	Pollution Incidents to Controlled Waters Property Type: Not Given Location: Station Road, HAYES Authority: Environment Agency, Thames Region Pollutant: Oils - Unknown Note: Confirmed As A Pollution Incident Incident Date: 7th December 1993 Incident Reference: NE930826 Catchment Area: Not Given Receiving Water: Not Given Cause of Incident: Not Given Incident Severity: Category 3 - Minor Incident Positional Accuracy: Located by supplier to within 100m	A8SW (SW)	681	1	509400 179400
34	Pollution Incidents to Controlled Waters Property Type: Not Given Location: Avondale Drive, HAYES Authority: Environment Agency, Thames Region Pollutant: Unknown Note: Confirmed incident Incident Date: 28th February 1999 Incident Reference: THNE1999042099 Catchment Area: Not Given Receiving Water: Not Given Cause of Incident: Not Given Incident Severity: Category 3 - Minor Incident Positional Accuracy: Located by supplier to within 10m	A12SW (W)	682	1	509006 179996
34	Pollution Incidents to Controlled Waters Property Type: Not Given Location: HAYES Authority: Environment Agency, Thames Region Pollutant: Oils - Unknown Note: Not Supplied Incident Date: 11th October 1997 Incident Reference: THN11997030514 Catchment Area: Not Given Receiving Water: Not Given Cause of Incident: Not Given Incident Severity: Category 3 - Minor Incident Positional Accuracy: Located by supplier to within 100m	A12SW (W)	686	1	509001 180001

Map ID	Details	Quadrant Reference (Compass Direction)	Estimated Distance From Site	Contact	NGR
34	Pollution Incidents to Controlled Waters Property Type: Not Given Location: HAYES Authority: Environment Agency, Thames Region Pollutant: Chemicals - Unknown Note: Not Supplied Incident Date: 7th August 1998 Incident Reference: THNE1998039919 Catchment Area: Not Given Receiving Water: Not Given Cause of Incident: Not Given Incident Severity: Category 3 - Minor Incident Positional Accuracy: Located by supplier to within 100m	A12SW (W)	687	1	509001 179996
35	Pollution Incidents to Controlled Waters Property Type: Not Given Location: Precinct Road, HAYES Authority: Environment Agency, Thames Region Pollutant: Oils - Unknown Note: Confirmed As A Pollution Incident Incident Date: Not Supplied Incident Reference: N1920073 Catchment Area: Not Given Receiving Water: Not Given Cause of Incident: Not Given Incident Severity: Category 3 - Minor Incident Positional Accuracy: Located by supplier to within 100m	A14NE (E)	780	1	510500 180400
36	Pollution Incidents to Controlled Waters Property Type: Not Given Location: Pump Lane, HAYES Authority: Environment Agency, Thames Region Pollutant: General Note: Not Supplied Incident Date: 21st October 1998 Incident Reference: THNE1998040946 Catchment Area: Not Given Receiving Water: Not Given Cause of Incident: Not Given Incident Severity: Category 3 - Minor Incident Positional Accuracy: Located by supplier to within 100m	A9NE (SE)	808	1	510500 179700
37	Pollution Incidents to Controlled Waters Property Type: Not Given Location: Betam Road, HAYES Authority: Environment Agency, Thames Region Pollutant: Chemicals - Unknown Note: Confirmed As A Pollution Incident Incident Date: 4th November 1993 Incident Reference: NE930757 Catchment Area: Not Given Receiving Water: Not Given Cause of Incident: Not Given Incident Severity: Category 3 - Minor Incident Positional Accuracy: Located by supplier to within 100m	A12SW (W)	827	1	508900 179800
38	Pollution Incidents to Controlled Waters Property Type: Not Given Location: Off Nestles Avenue, HAYES Authority: Environment Agency, Thames Region Pollutant: Oils - Unknown Note: Confirmed incident Incident Date: 8th February 1999 Incident Reference: THNE1999041896 Catchment Area: Not Given Receiving Water: Not Given Cause of Incident: Not Given Incident Severity: Category 3 - Minor Incident Positional Accuracy: Located by supplier to within 10m	A9SW (SE)	836	1	510200 179300
39	Pollution Incidents to Controlled Waters Property Type: Not Given Location: HAYES Authority: Environment Agency, Thames Region Pollutant: Miscellaneous - Other Note: Confirmed incident Incident Date: 30th March 1999 Incident Reference: THNE1999042361 Catchment Area: Not Given Receiving Water: Not Given Cause of Incident: Not Given Incident Severity: Category 3 - Minor Incident Positional Accuracy: Located by supplier to within 10m	A14SE (E)	861	1	510600 179800