

NOTES

1. All dimensions are to be checked on site prior to the commencement of work and any discrepancy is to be reported to the construction manager before construction.
2. All work is to comply with current Building Regulations and allied legislation.
3. All contractors and sub-contractors must ensure that they have the latest issue of this drawing and details before the commencement of work on site.
4. All materials are to be used and installed in strict compliance with the relevant manufacturers instructions and recommendations.
5. All works on site, managed and implemented as a result of the designs indicated on this drawing, are to be given full consideration for compliance with the Health and Safety CDM Regulations in respect of design and implementation on site and no works are to be undertaken if it is considered that compliance with the Building Regulations cannot be achieved.
6. This drawing is not to be scaled.
7. All dimensions shown in millimetres
8. Footprint of buildings shown at 1.0m above ground level

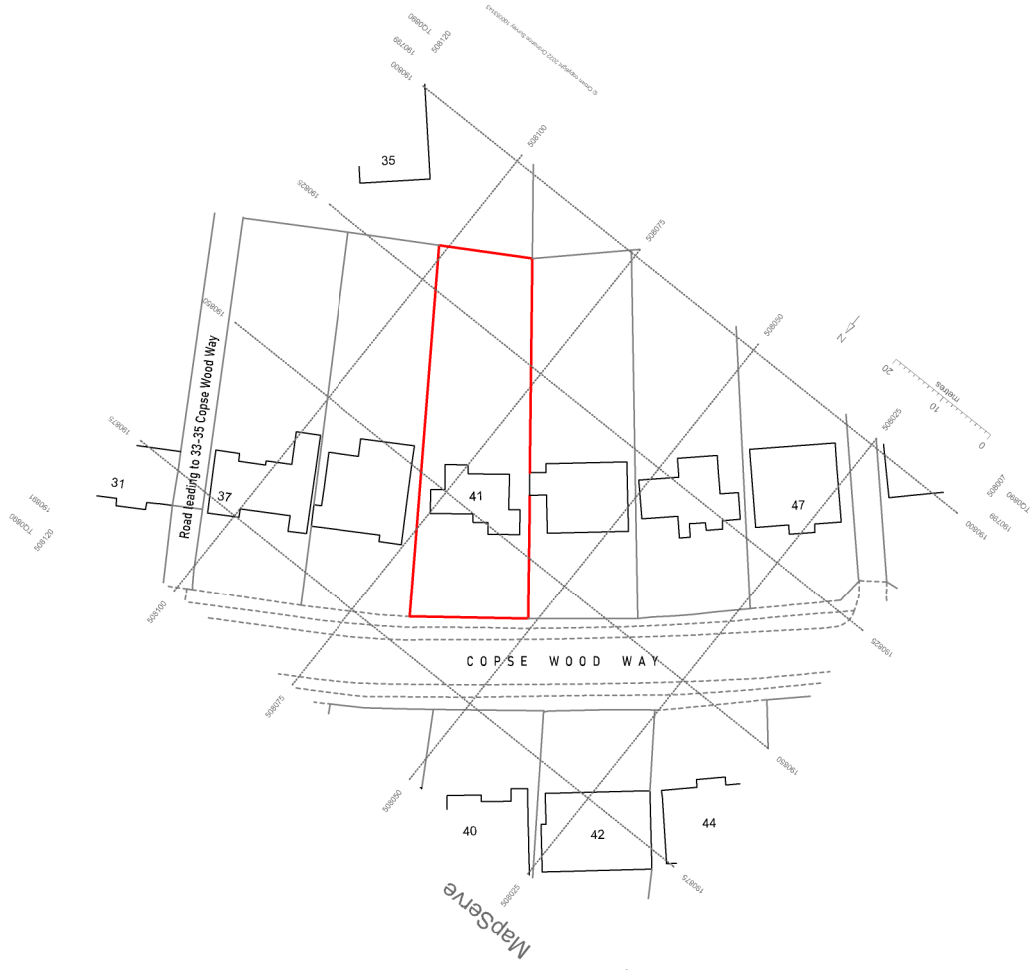

LOCATION PLAN SCALE 1:1250
0(m) 20 40 60
SCALE BAR 1:1250

LEGEND

- Existing trees to remain
- Remove existing trees and shrubs
- Proposed two storey building
- Proposed single storey building
- Existing structures to be removed
- New trees and shrubs
- Proposed hedging
- Existing levels

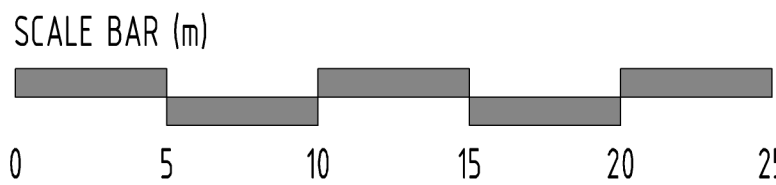

LANDSCAPING LEGEND

- 1
+ + + + +
Prunus Laurocevasus hedging-Laurel Hedging-Plant sizes 60-90cm planted at 600mm c/c in double rows and staggered
- Pinus Sylvestris- SCOTS PINE heavy standard container grown

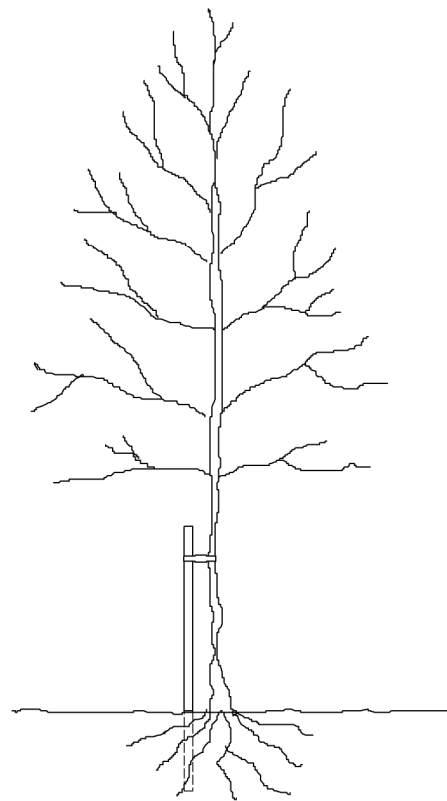

TREE STAKING DETAIL

TREE STAKING SPECIFICATION

For selected standard trees o/a height 3.0-3.5m. Support using stakes extending to 1.00-1.2m above ground and 0.6-0.75m below ground level (depending on ground conditions).

Supported by single non reinforced tie 75mm from top of stake.

Remove stake on onset of or during the second growing season after planting.

LANDSCAPE SPECIFICATION

Landscaping generally to be carried out in accordance with BS.4428. All new trees to be supplied as selected standards unless otherwise noted. Overall height 3.0-3.5m and 18-21m, straight stem to BS.3936 Part 1 1992. Trees supplied with bare roots with polythene wrapping or as noted otherwise, and planted in a min of 3.0 litres peat. Planting beds to be excavated and lined with screened topsoil enriched with peat free compost/fertiliser or similar manure 50mm deep, top dressed with 75mm deep forest bark mulch.

Site to be cleared of all builders rubble and rotavated levelled and filled before planting commences. Front gardens to be turfed and rear gardens seeded. All turfing to BS.3936.1990.

Pericious weeds are to be treated with translocated herbicide during growing season (spot treated).

Tree and shrub planting to BS.3936 Part 1 1992. Tree protection to be carried out in accordance with B.S.5837. 2005. Sub-soil areas below planting to be de-compacted before planting commences.

DRIVEWAY SPECIFICATION

Driveways to be finished with Marshalls Priora grey permeable concrete pavers, framed with brindle Priora border & compatible brindle edgings bedded on 50mm sharp sand on GEOTEXTILE membrane on 6-20mm graded aggregate sub-base on geotextile membrane on compacted sub-grade to falls.

Crossover to be finished in black tarmac. Construction specification in accordance with local authorities requirements.

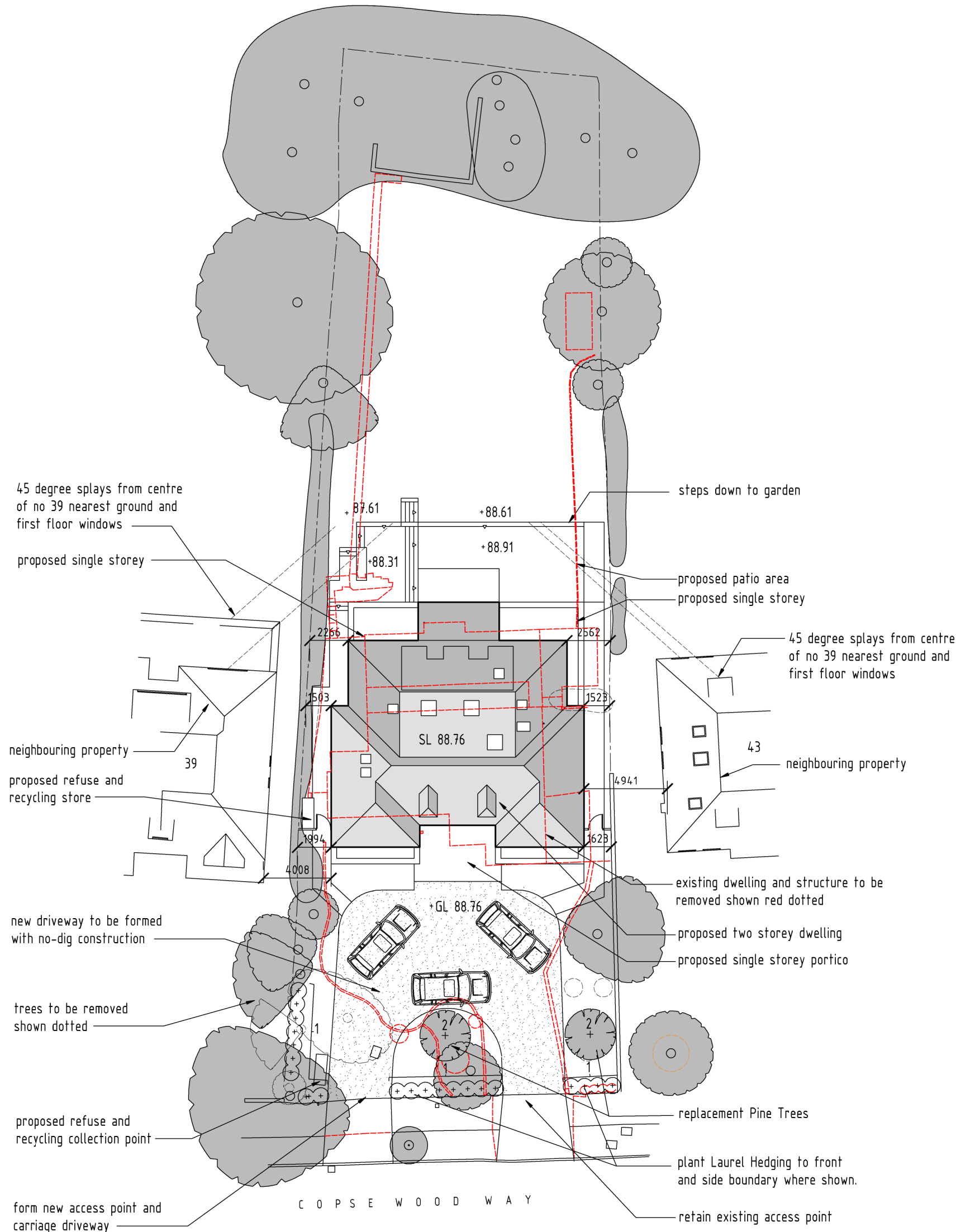

PROPOSED SITE LAYOUT PLAN
SCALE 1:250

rev	date	info	drawn :pd/jd
scale: 1 : 100 @ A1	date: 27-09-22	drw no: 622-P-3	
drawing: PLANNING PROPOSALS PROPOSED SITE & LOCATION PLAN			
project: 41 COPSE WOOD WAY, NORTHWOOD, HA6 2TZ			
client: MR & MRS P. RUDRAN			

