

01
110
UNIT C HGV TRACKING
1:500

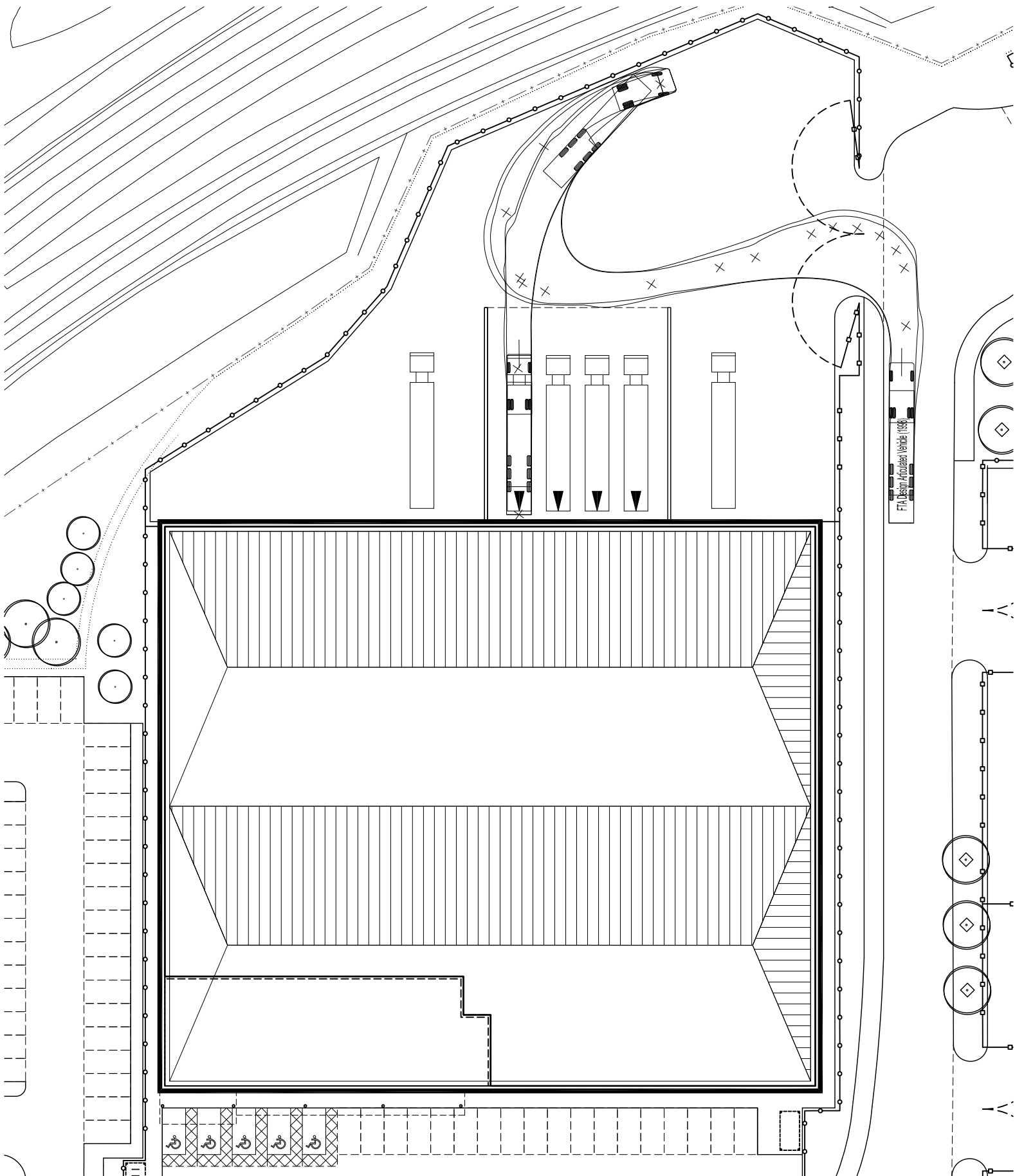

02
110
UNIT C HGV TRACKING
1:500

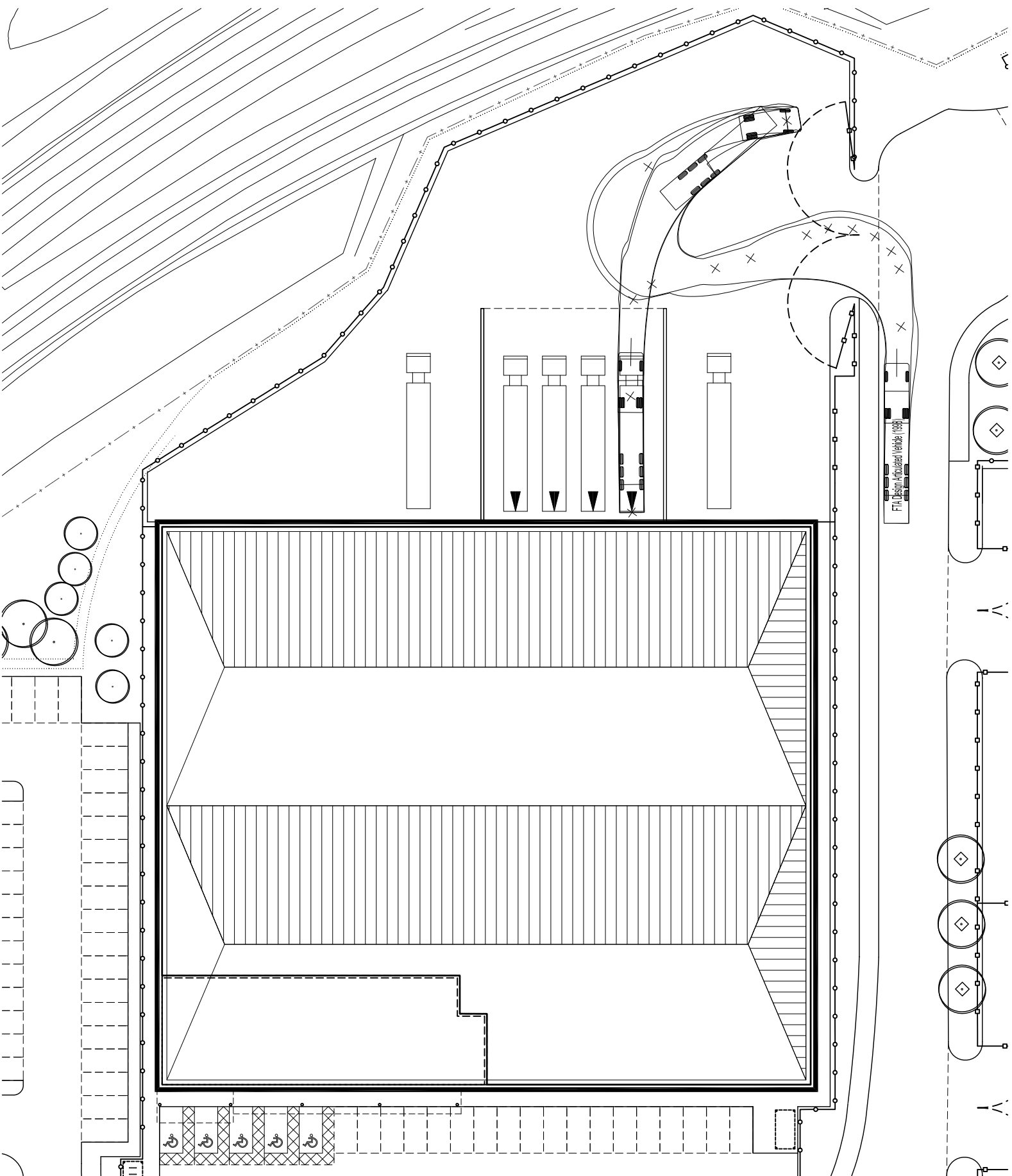

03
110
UNIT C HGV TRACKING
1:500

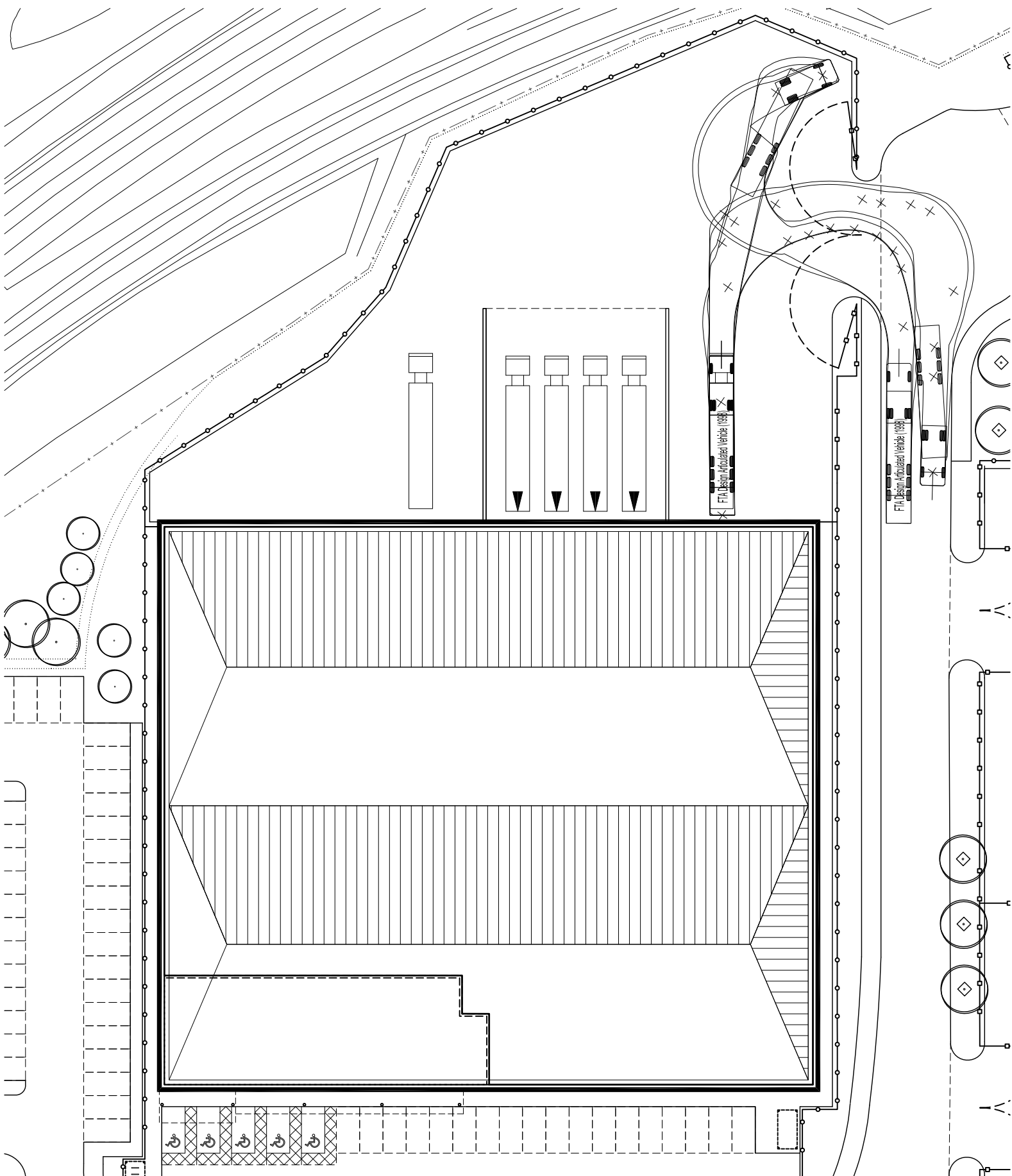

04
110
UNIT C HGV TRACKING
1:500

NOTES:

SUBJECT TO STATUTORY CONSENTS

BASED ON GREENHATCH SURVEY NO. 7159ENT_1 & 14285_OGL

BASED ON OS MAP REPRODUCED BY PERMISSION OF CONTROLLER OF HM STATIONARY OFFICE (c) CROWN COPYRIGHT

COPYRIGHT RESERVED

BOUNDARIES BASED ON LAND REGISTRY TITLE NUMBER MX131015

ADOPTED HIGHWAY BOUNDARY BASED ON INFORMATION RECEIVED FROM LONDON BOROUGH OF HILLINGDON

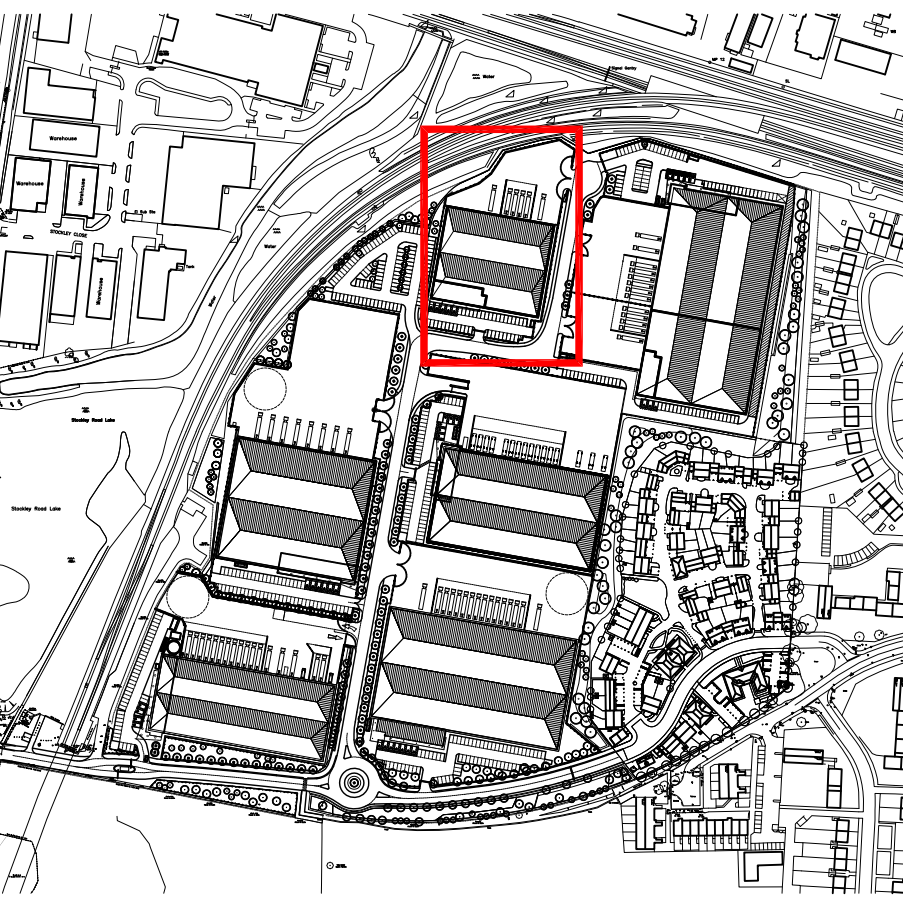
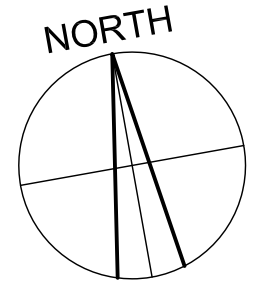

05
110
KEY PLAN



REV	DATE	COMMENT	DRAW	CHK
-	19.03.2013	FIRST ISSUE	VCN	PW



CHARTERED ARCHITECTS

11 PLATO PLACE
ST. DUNSTON ROAD
LONDON SW6 4TU

TELEPHONE 020 7736 6162
FAX 020 7736 3896
info@mso-architects.co.uk



PROLOGIS

TITLE

PHASE 3 - PROLOGIS PARK, HEATHROW

DRAWING

UNIT C - HGV VEHICLE TRACKING

CLIENT

PROLOGIS UK LTD.

DATE	SCALE	DRAWN
MARCH 2013	1:500 @ A1	PW
STATUS		CHECKED
FOR PLANNING		PW

DRAWING NUMBER

30587-PL110