

1 Ground Floor Plan - Proposed
Scale: 1:50

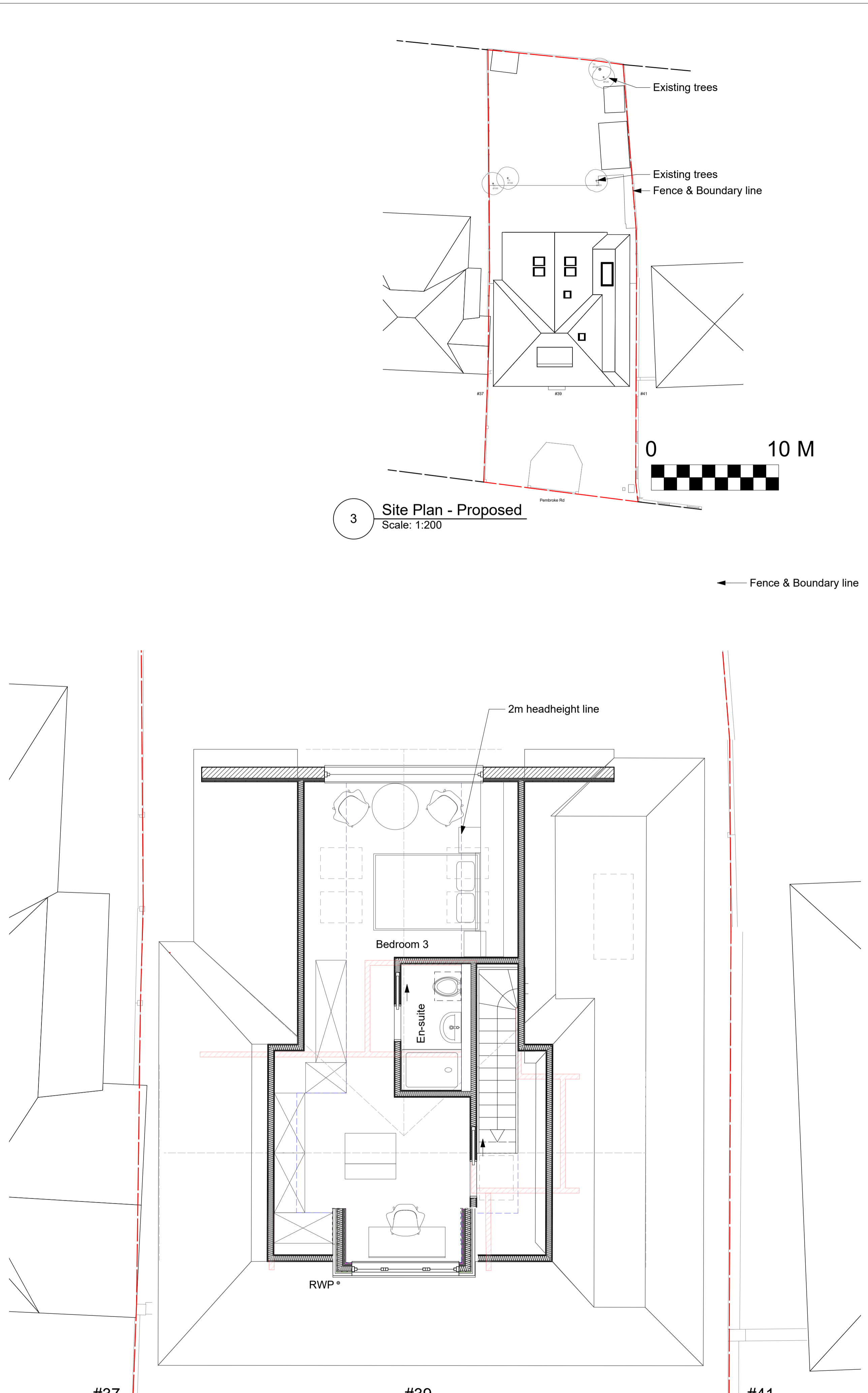

2 First Floor Plan - Proposed
Scale: 1:50

3 Site Plan - Proposed
Scale: 1:200

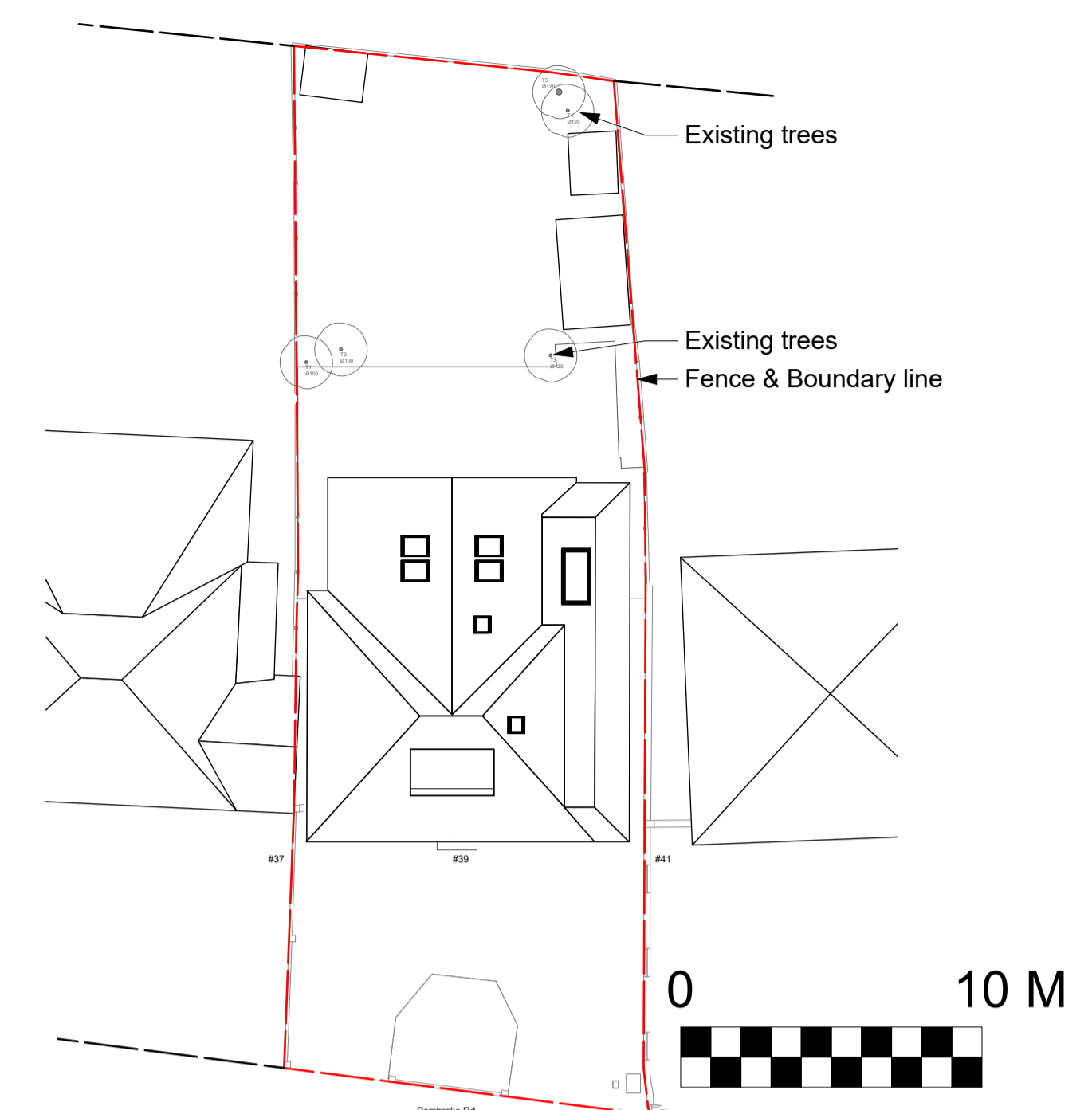

- Notes:
- Use figure dimensions only
 - Do not scale from this drawing
 - Issued for purpose indicated only. This is not for construction
 - All dimensions to be checked on site
 - Architect to be notified of any discrepancies before construction commences
 - Structural and services information is indicative only
 - Refer to consultants' drawings and specification for details and setting out
 - All work and materials to be in accordance with current applicable statutory legislation and to comply with all relevant codes of practice and British and European Standards
 - Information gained from this drawing is the sole copyright of Livewell Architecture and should not be copied or reproduced without prior permission

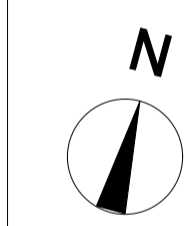

No.	Date	Revision Notes
A	15/04/2025	Scale bar added
B	25/11/2025	Revised

Architect

info@livewellarchitecture.co.uk
www.livewellarchitecture.co.uk
07915 906393

RIBA Chartered Practice

Client

Project Address
39 Pembroke Road, Ruislip, HA4 8NQ

Sheet Title
Plans - Proposed

Scale @ A1 AS NOTED	Status PLANNING
Drawn By CL	Checked By CL
Date 25/11/2025	Project Ref 2024.09-39PR
Drawing Number 110	Revision B