



BLUE ARCHITECTURE LIMITED
Consulting Architects, Engineers and Interiors.
102 Dorchester Way, Hayes, Middlesex,
UB4 0HY, London.

Contact:
Email: info@bluearchdesign.co.uk,
Cell: 044 + 078 3293 8374
Web site: www.bluearchdesign.co.uk

Notes:
© 2023 Blue Architecture Limited.
All rights reserved.
All drawings are for the purpose of gaining
Planning Permission approval only.
All written dimensions to be taken in
preferences to scaled dimensions.

Rev.	Description	By	Clkd	Date

Client:
Mr. Ahmad Kazemi.

Project:
Existing Roof space Conversion into Habitable room involving the erection of a Hip to Gable roof extension incorporating a rear dormer, installation of front two rooflights. And Detach out Building for Physical fitness and storage.

Location:
97 Yew Avenue, Yiewsley,
Middlesex, UB7 8PD.

Status:
Lawful Development Certificate

Title:
Existing and proposed Roof plans.

Drawn by:	Str. Et.	Checked by:
L.p	---	R.k
Project no:	Sheet Size	Sheet no.
BAL-97YA	A3	
Date:	Scale:	
14/11/2023	1:100	

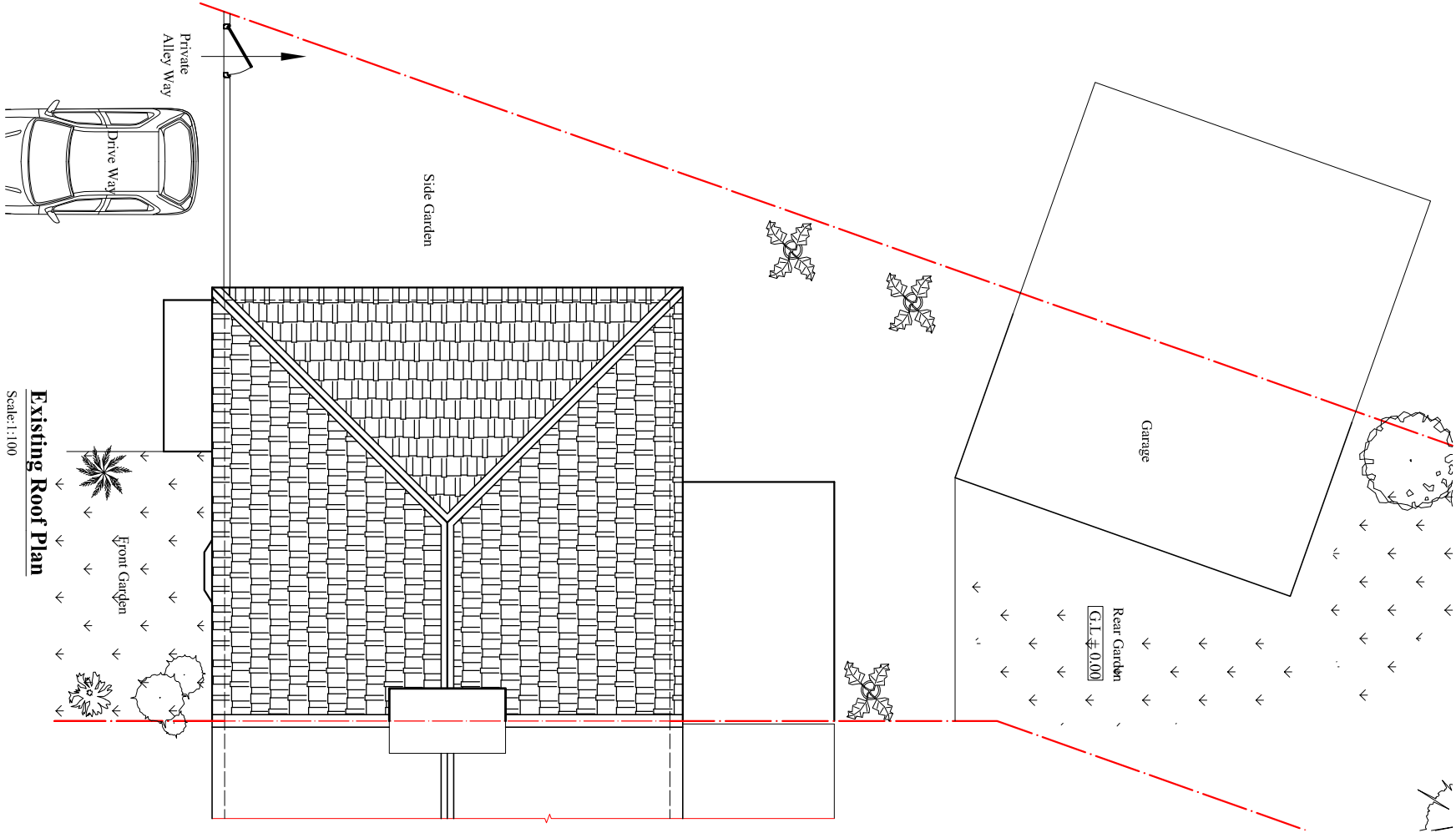
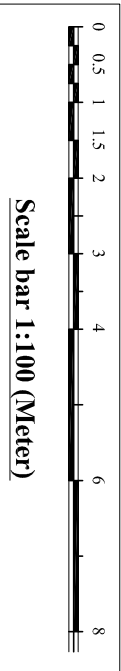

Existing Roof Plan

Scale:1:100

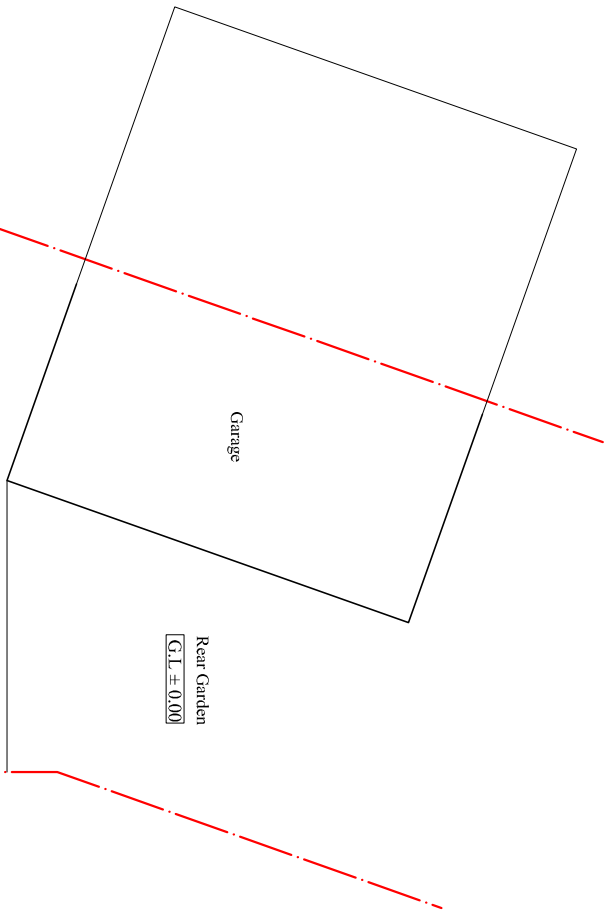

Proposed Roof Plan

Scale:1:100