

# SOFT LANDSCAPE PLAN

REF SLP/GL/REV-

APRIL 2026

Name	Scientific Name	Suitable for part shade	Number of plants in bed	UK Native	Benefits to UK Wildlife
Foxglove	<i>Digitalis purpurea</i>	Yes	5	Yes	Excellent for bees and pollinators; provides nectar in early summer
Red Campion	<i>Silene dioica</i>	Yes	5	Yes	Attracts bees, butterflies, and moths; good for woodland edges
Hellebore	<i>Helleborus orientalis</i>	Yes	5	No	Early nectar source for bees in late winter/early spring
Japanese Anemone	<i>Anemone hupehensis</i>	Yes	5	No	Late-season nectar for pollinators
Lady Fern	<i>Athyrium filix-femina</i>	Yes	3	Yes	Provides shelter for insects and ground wildlife
Tufted Hair Grass	<i>Deschampsia cespitosa</i>	Yes	3	Yes	Seeds for birds; habitat structure for insects
Heuchera	<i>Heuchera sanguinea</i>	Yes	5	No	Flowers attract bees and hoverflies
Lavender	<i>Lavandula angustifolia</i>	Yes	5	No	Highly attractive to bees and other pollinators

## PLANTING TO BED 1

Name	Scientific Name	Suitable for part shade	Number of plants in bed	UK Native	Benefits to UK Wildlife
Foxglove	<i>Digitalis purpurea</i>	Yes	7	Yes	Excellent for bees and pollinators; provides nectar in early summer
Red Campion	<i>Silene dioica</i>	Yes	5	Yes	Attracts bees, butterflies, and moths; good for woodland edges
Hellebore	<i>Helleborus orientalis</i>	Yes	7	No	Early nectar source for bees in late winter/early spring
Japanese Anemone	<i>Anemone hupehensis</i>	Yes	5	No	Late-season nectar for pollinators
Lady Fern	<i>Athyrium filix-femina</i>	Yes	5	Yes	Provides shelter for insects and ground wildlife
Tufted Hair Grass	<i>Deschampsia cespitosa</i>	Yes	5	Yes	Seeds for birds; habitat structure for insects
Heuchera	<i>Heuchera sanguinea</i>	Yes	7	No	Flowers attract bees and hoverflies
Lavender	<i>Lavandula angustifolia</i>	Yes	5	No	Highly attractive to bees and other pollinators
Tree					
Magnolia Tree	<i>M. sieboldii 'Colossus'</i>	Not required	1	No	Early nectar source for bees in late winter/early spring

## PLANTING TO BED 2

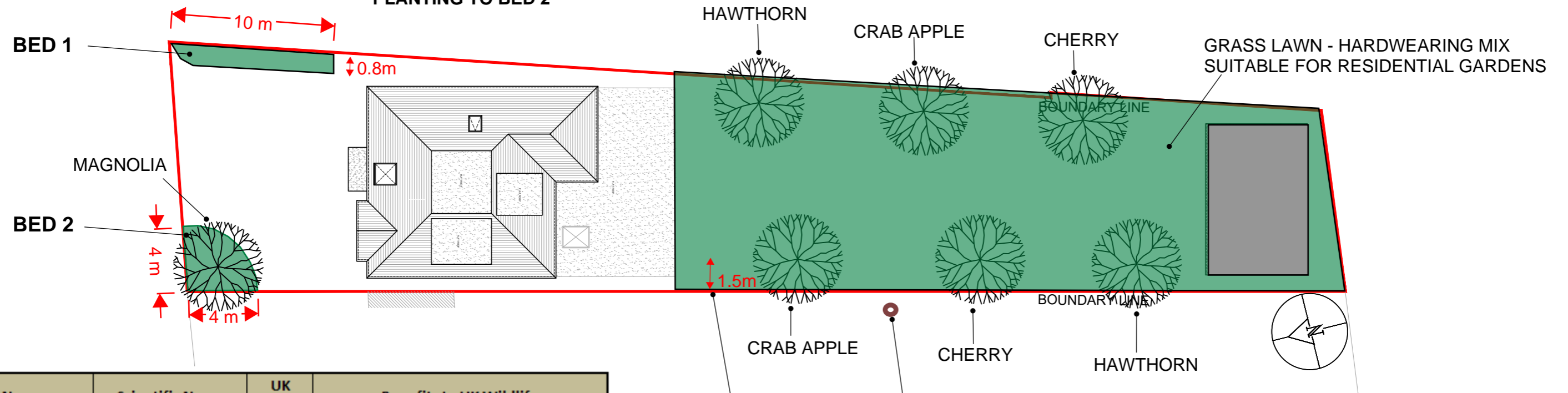

Name	Scientific Name	UK Native	Benefits to UK Wildlife
Wild Cherry	<i>Prunus avium</i>	Yes	Blossom supports pollinators; fruits feed birds and mammals; nesting habitat.
Common Hawthorn	<i>Crataegus monogyna</i>	Yes	Flowers for pollinators; haws for birds; dense thorny shelter and nesting cover.
Crab Apple	<i>Malus sylvestris</i>	Yes	Spring blossom for bees; autumn fruit for birds and mammals; good biodiversity value.

## TREE PLANTING TO REAR GARDEN

ALL 6 REAR GARDEN TREES TO BE PLANTED MINIMUM 1.5M FROM THE BOUNDARY FENCE TO ALLOW ROOM TO GROW.