

HOMES DESIGN

40 WISE LANE
MILL HILL
LONDON NW7 2RE
MOB: 07946 872537

www.homesdesignltd.co.uk

title		PROPOSED ANNEX BUILDING SITE PLANS		
project		102 Green Lane Northwood Middlesex HA6 1AJ		
drawing no		ABC503/2000		
drawn by	R. L	contract no.	ABC503	
scale		1:200 @ A3	date	08/2024

PLANNING STATEMENT:

THE HOST PROPERTY IS A SINGLE DWELLING FAMILY RESIDENTIAL HOUSE. AS PART OF PROPOSAL TO CONSTRUCT A SINGLE STOREY REAR GARDEN ANNEX OUTBUILDING AT 2.5m HEIGHT AS ANCILLARY USE OF FAMILY HOUSE (TO BE USED AS HOME GYM AND PLAYROOM GAMES AREA PLUS STUDY AND STORAGE).

ALL MATERIAL TO NEW EXTENSION TO MATCH EXISTING EXTERNAL FINISHING AND TEXTURE. THE ANNEX SOLELY CONSTRUCTED WITHIN FOOTPRINT OF THE LAND AND USED AS INCIDENTAL AND SOLELY USED FOR PLEASURE USE OF THE SINGLE DWELLING RESIDENTIAL HOUSE'S USE.

THE SITE IS NOT WITHIN HERITAGE OR NATIONAL PARK & AREAS AND DO NOT NEED TO BE RESTRICTED ON CLASS-E2 FOR SETTING OF THE ANNEX RESTRICTION WITHIN 20METER AWAY FROM MAIN WALLS OF THE DWELLING HOUSE AND CAN BE SET WITHIN GIVEN AREAS.

SITE GROSS AREAS (BASED ON BOUNDARY AREA): 1118m²

ORIGINAL HOUSE FOOTPRINTS AREA: 130m²

CARTILAGE OF THE SITE (NET): 988m²

PROPOSED NEW OUT BUILDING USED AS ANCILLARY AND INCIDENTAL USE OF THE RESIDENTIAL SINGLE DWELLING HOUSE WITH GROSS AREA: 57m²

THE PROPOSAL IS LESS THAN 50% OF CARTILAGE AREA OF SITE AND THEREFORE TO COMPLIANCE WITH CLASS-A1(a)

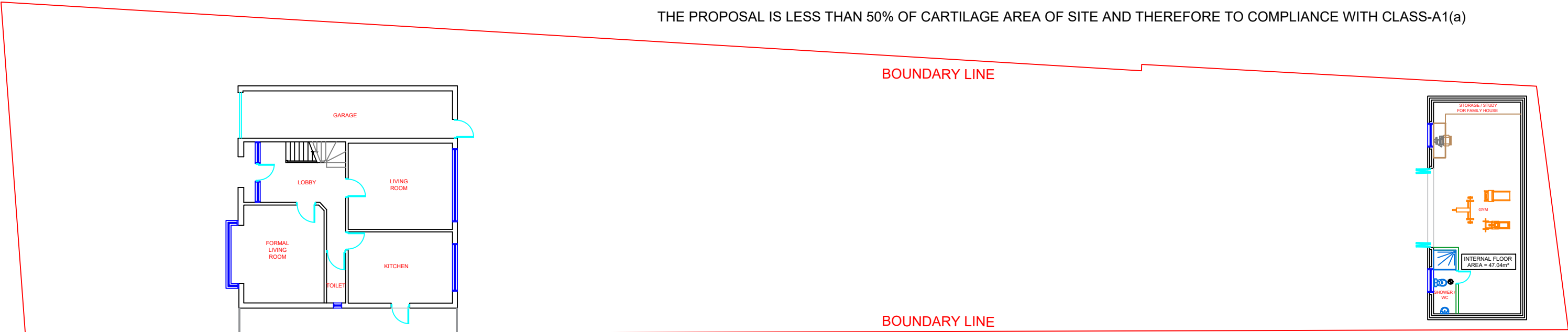

PROPOSED ANNEX GROUND FLOOR PLAN

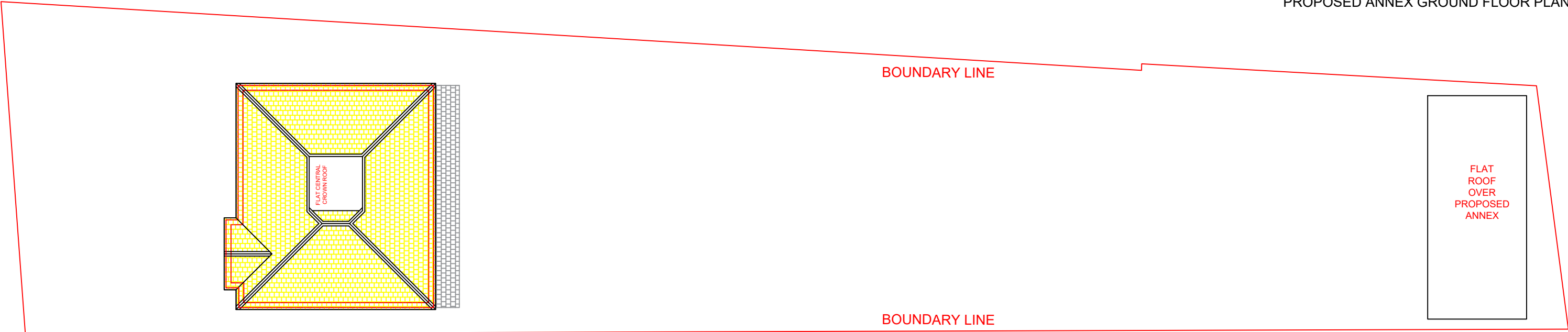

PROPOSED ANNEX ROOF PLAN

