

A Party Wall Notice to be given to adjoining Neighbours prior to Commencement of Work.

- FD
30

30 minutes Fire Resistant Doors in all Habitable rooms at Ground and First Floor level leading from the Staircase.
- HD

Heat Detector / Smoke Alarm to be mains operated and interlinked and to be installed by Competent Electrician.
- SD

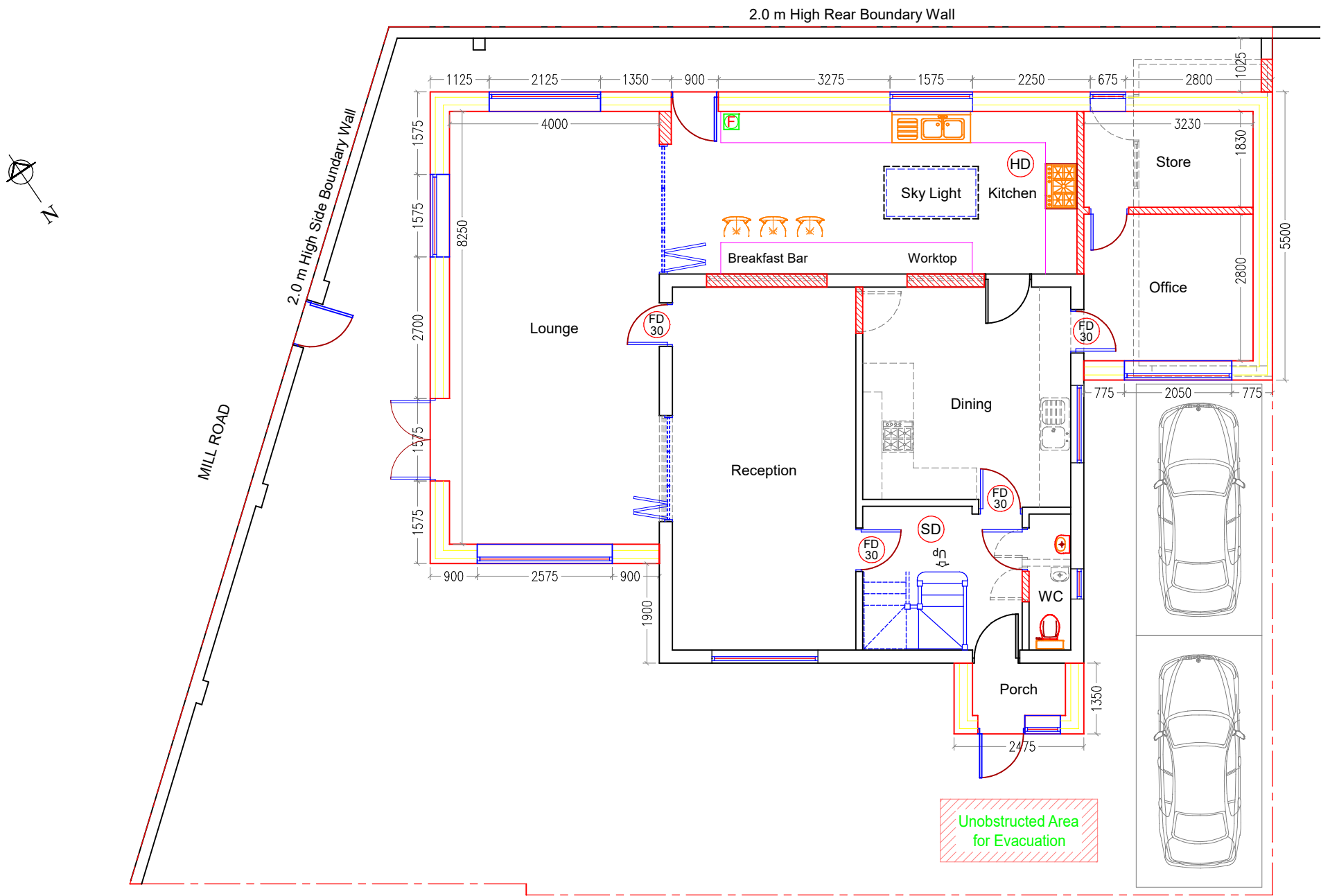

PROPOSED GROUND FLOOR PLAN

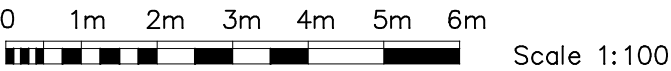

- Notes:
- (1) Dedicated unobstructed area for the storage of Fire Equipment .
 - (2) Requirements of Policy D12A - Fire Safety of the London Plan will be fully met.

Client		MR AHMMAD ZIA KHAIRI.		Site		9 ELRUGE CLOSE, WEST DRAYTON, HILLINGDON, UB7 7ES.	
Project		FRONT PORCH, SINGLE STOREY SIDE AND REAR EXTENSIONS.		Title		PROPOSED GROUND FLOOR PLAN.	
Scale		1:100 @ A3		Date		11/12/2024	
Drawn by		SSC		Org. No		9ELRUGECL/NPA/2	
Revision						0	