

A Party Wall Notice to be given to adjoining Neighbours prior to Commencement of Work.

- FD
20

20 minutes Fire Resistant Doors in all Habitable rooms at Ground and First Floor level leading from the Staircase.
- HD

Heat Detector / Smoke Alarm to be mains operated and interlinked and to be installed by Competent Electrician.
- SD

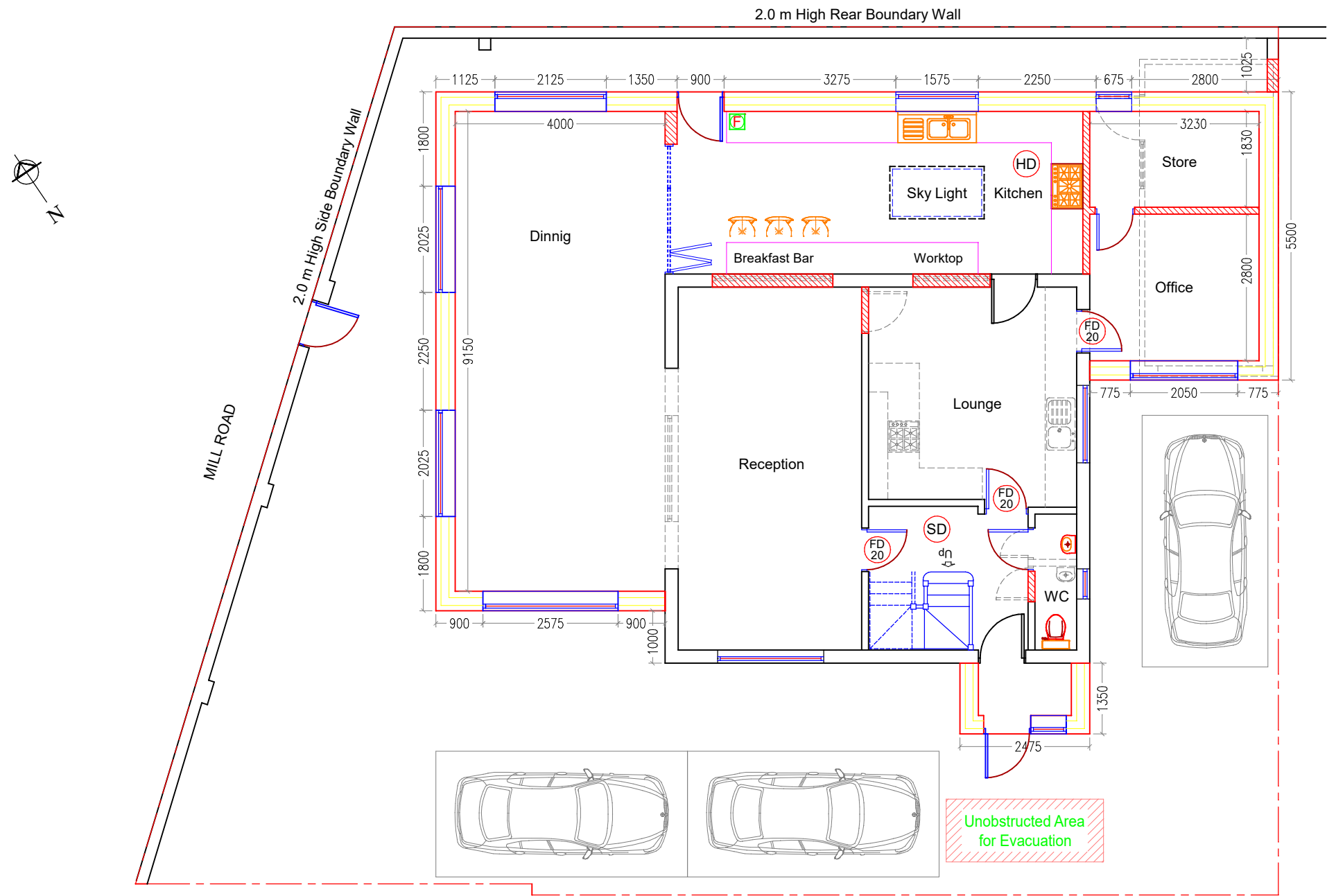

PROPOSED GROUND FLOOR PLAN

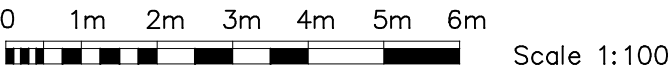

- Notes:
- (1) Dedicated unobstructed area for the storage of Fire Equipment . F
 - (2) Requirements of Policy D12A - Fire Safety of the London Plan will be fully met.

- Ext. Window
- New Window

ClientMR AHMMAD ZIA KHAIRI.		Site9 ELRUGE CLOSE, WEST DRAYTON, HILLINGDON, UB7 7ES.		
ProjectFRONT PORCH, DOUBLE STOREY SIDE, SINGLE STOREY SIDE AND REAR EXTENSIONS.		TitlePROPOSED GROUND FLOOR PLAN.		
Scale1:100 @ A3	Date19/07/2024	Drawn bySSC	Drg. No9ELRUGECL/PA/2	Revision0