

A Party Wall Notice to be given to adjoining Neighbours prior to Commencement of Work.

- FD
20

20 minutes Fire Resistant Doors in all Habitable rooms at Ground and First Floor level leading from the Staircase.
- HD

Heat Detector / Smoke Alarm to be mains operated and interlinked and to be installed by Competent Electrician.
- SD

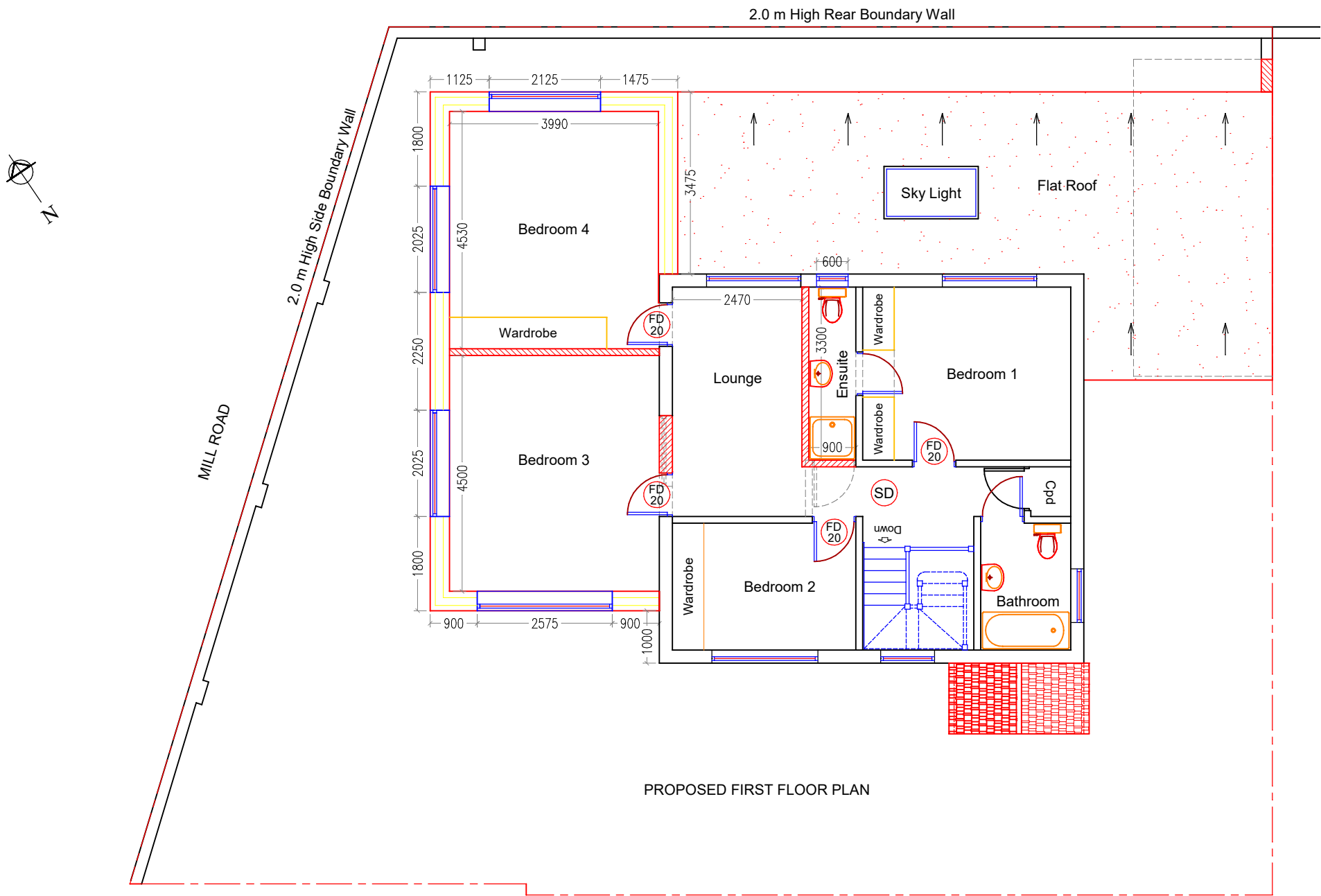

PROPOSED FIRST FLOOR PLAN

Ext. Window

New Window

0 1m 2m 3m 4m 5m 6m
Scale 1:100

Client		MR AHMMAD ZIA KHAIRI.		Site		9 ELRUGE CLOSE, WEST DRAYTON, HILLINGDON, UB7 7ES.			
Project		FRONT PORCH, DOUBLE STOREY SIDE, SINGLE STOREY SIDE AND REAR EXTENSIONS.		Title		PROPOSED FIRST FLOOR PLAN.			
Scale		Date		Drawn by		Org. No		Revision	
1:100 @ A3		19/07/2024		SSC		9ELRUGECL/PA/3		0	