

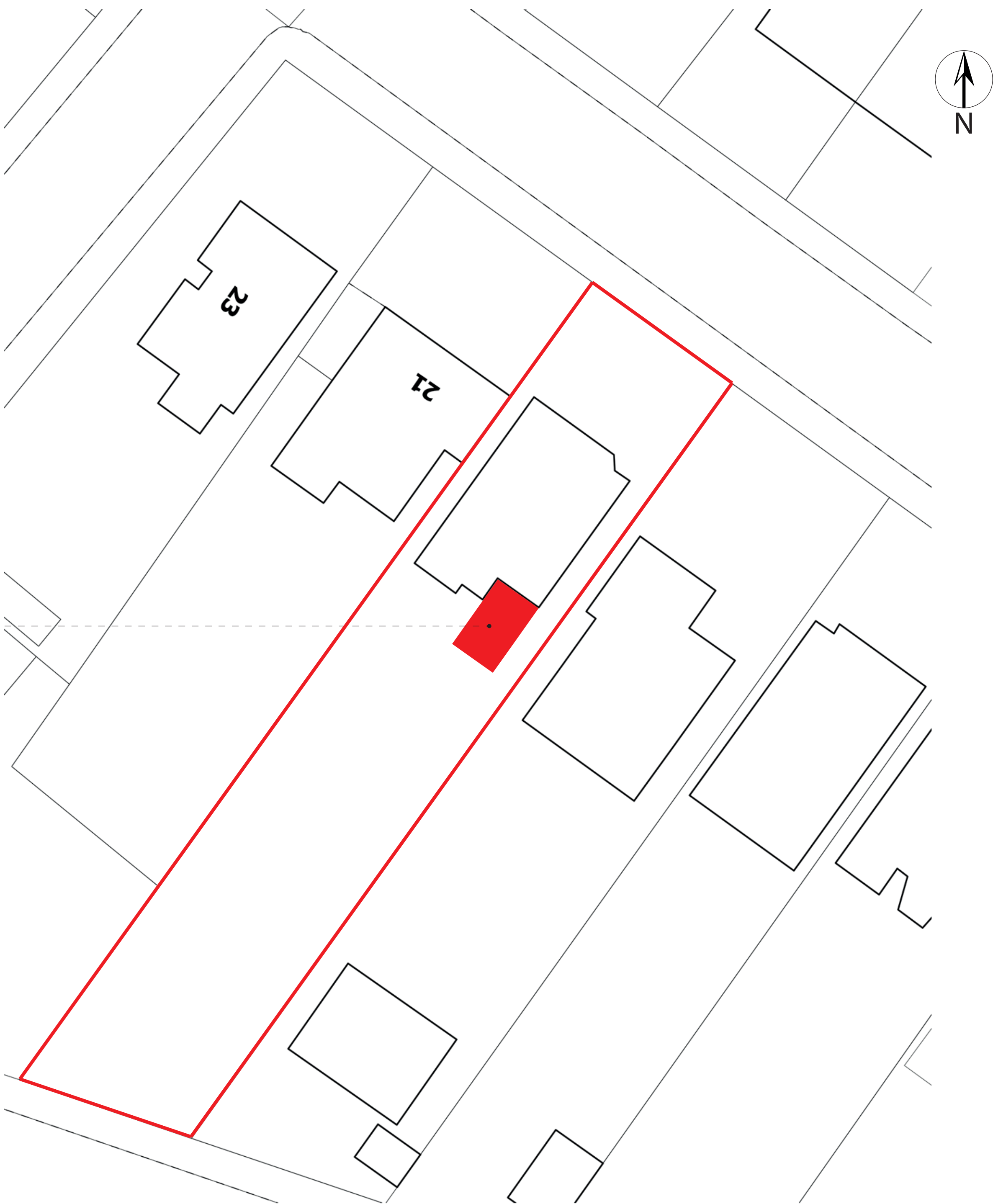

PROPOSED
GROUND FLOOR
REAR EXTENSION



PROPOSED SITE BLOCK PLAN
SCALE 1:200
SITE BOUNDARY : 
PROPOSED : 



- NOTES:
- DO NOT SCALE FROM THIS DRAWING, ANY DIMENSIONS SHOWN ARE INDICATIVE ONLY AND ARE SUBJECT TO VERIFICATION ON SITE.THE CONTRACTOR IS TO SET OUT, CHECK AND COORDINATE ALL DIMENSIONS ON SITE DURING THE COURSE OF THE WORKS. THIS DRAWING IS TO BE READ IN CONIUNCTION WITH ALL OTHER ARCHITECTURAL PLANS, STRUCTURAL CALCULATIONS AND SPECIFICATIONS.
 - PRIOR TO COMMENCEMENT OF ANY WORK ON SITE, LOCAL AUTHORITIES APPROVAL MUST BE ACHIEVED.
 - ALL TEMPORARY WORK TO BE CLIENT / CONTRACTORS RESPONSIBILITY.
 - ALL WORKS TO BE CARRIED OUT IN ACCORDANCE WITH THE LATEST APPROPRIATE CODES OF PRACTICE.
 - VERIFY THE LOCATION AND THE DETAILS OF ALL THE SERVICES PRIOR TO ANY EXCAVATION WORK.
 - WHERE WORKS AFFECT A PARTY WALL OR INVOLVE EXCAVATIONS WITH IN 3m OF ADJOINING BUILDINGS, PARTY WALL AGREEMENT SHALL BE IN PLACE PRIOR TO COMMENCEMENT OF ANY WORKS.
 - TILL TECHNICAL APPROVAL HAS BEEN OBTAINED FROM THE RELEVANT TECHNICAL AUTHORITIES OR STATUTORY BODIES, IT SHOULD BE UNDERSTOOD THAT ALL DRAWINGS ARE ISSUED AS PRELIMINARY AND NOT FOR CONSTRUCTION.

STAGE:	PLANNING	
CLIENT:	MR HARBIR SINGH 19 HIGHFIELD ROAD NORTHWOOD, HA6 1EU	
PROJECT:	RETROSPECTIVE PLANNING PERMISSION FOR REMOVAL OF REAR CHIMNEY AND PROPOSE GROUND FLOOR REAR EXTENSION	
FILE:	PROPOSED BLOCK PLAN	
REVISION:	V/P	REV: A
DRAWING NO:	19FER/HA61EU/009	
SCALE:	1:200/A2	DATE: 04.03.2024
SHEET:	009	