

1 GROUND
Scale: 1:100

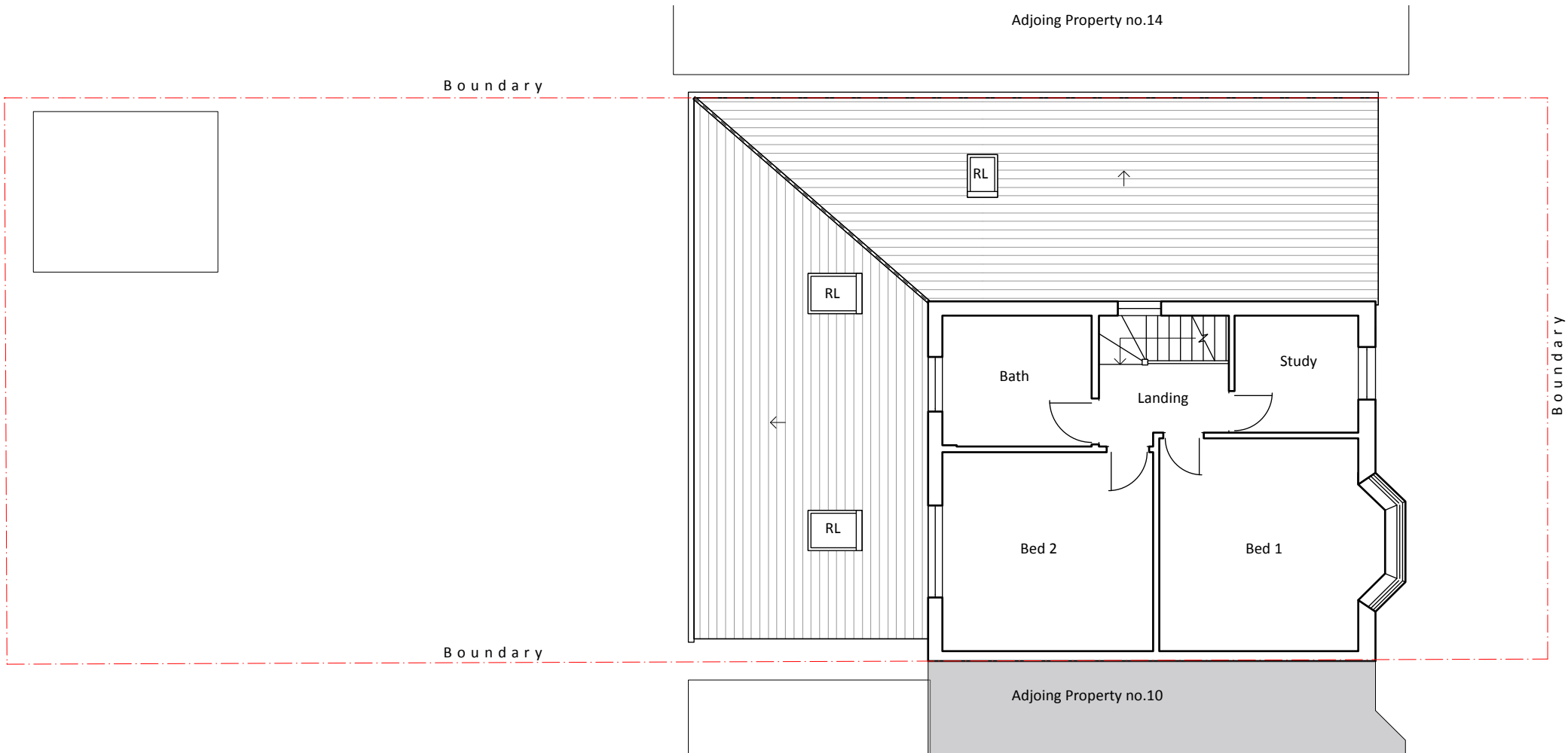

2 FIRST
Scale: 1:100

0 1 2 3 4 5 m

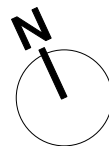

ISSUE	DATE	REVISION
-------	------	----------

PROJECT
12 Little Road, Hayes UB3 3BT

CLIENT
Mr and Mrs Dhaliwal

DRAWING
EXISTING GROUND AND FIRST



STONES
ARCHITECTS

All rights described in chapter IV of the copyright designs & patents act 1988 have been asserted. This drawing must not be scaled; only figured dimensions should be used. Check and verify all dimensions on site prior to commencing any work. Any discrepancies should be reported to the Architects immediately.

PROJECT #	2025.024	DWG #	REV
DATE	23/05/2025		
SCALE	1:100		
DRAWN	PR	CHKD	JC

Stones Architects Ltd
50 Coldharbour Lane Hayes Middlesex UB3 3EP
t 020 8969 0000 e mail@stonesarchitects.co.uk w stonesarchitects.co.uk

S02