

1 Proposed Bar Plan  
Scale: 1:20

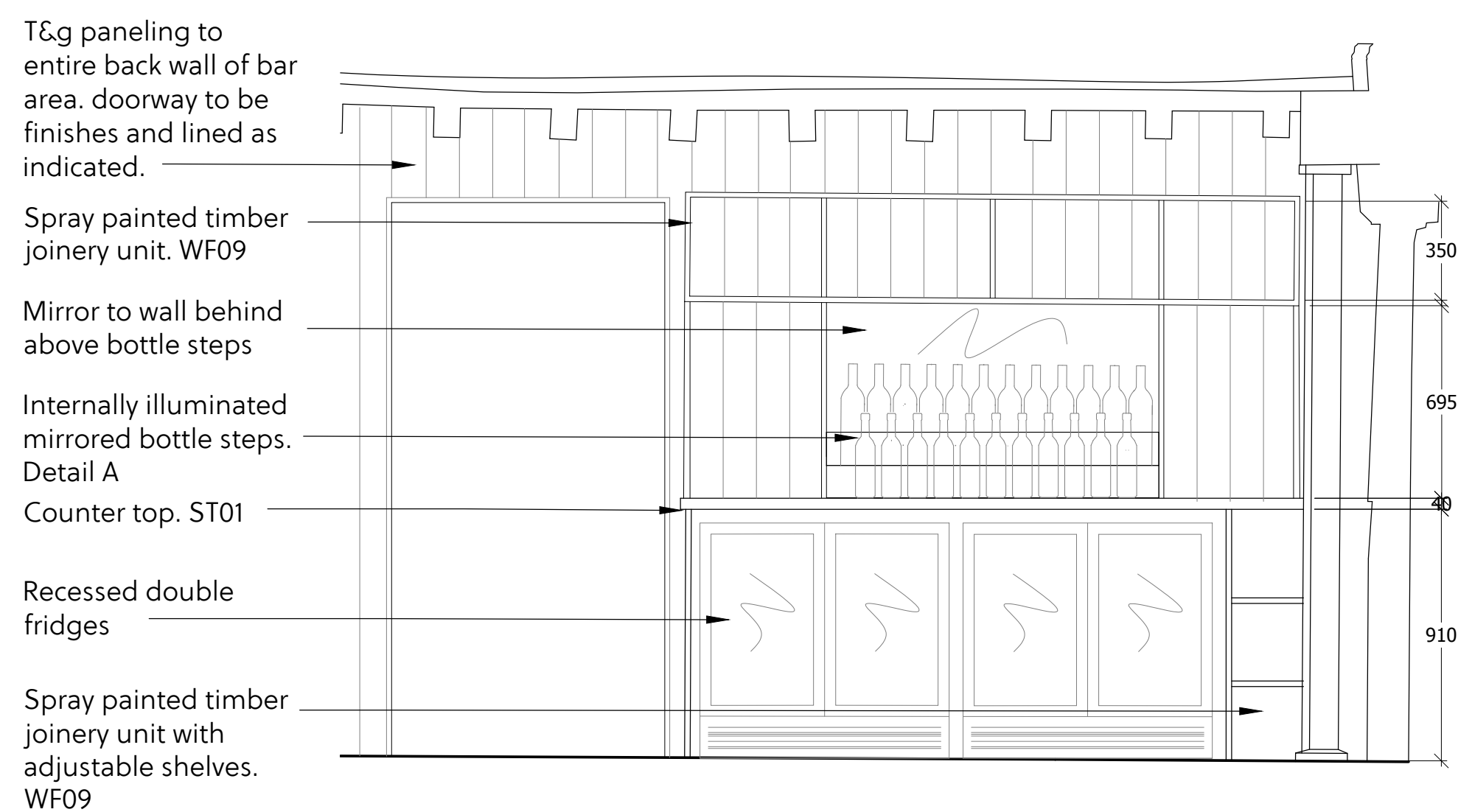

2 Proposed elevation - Back Bar  
Scale: 1:20

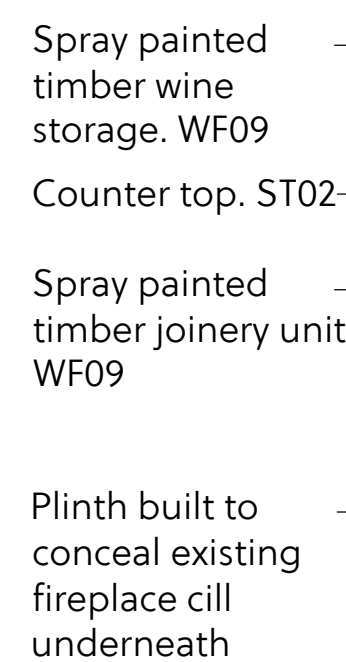

4 Proposed elevation - Service Station  
Scale: 1:20

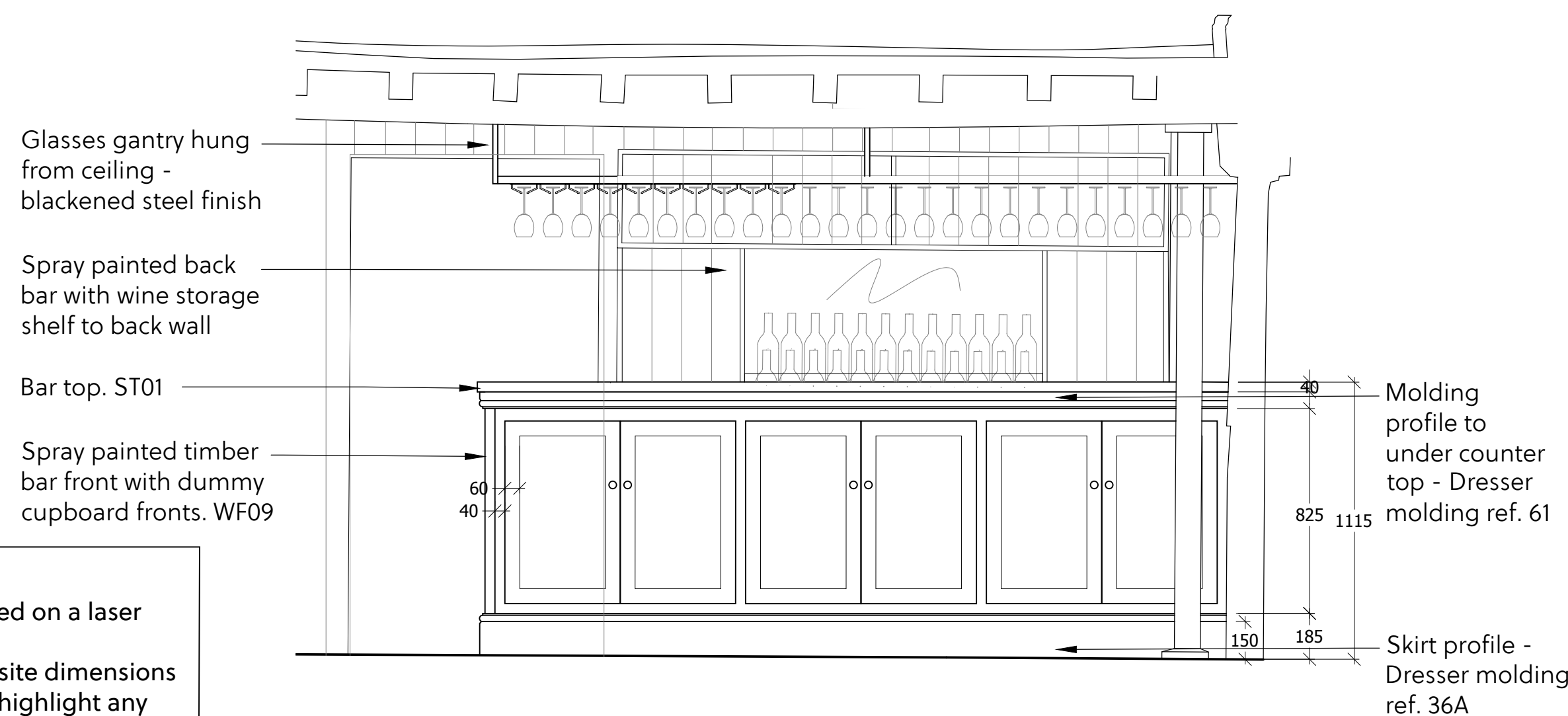

3 Proposed Elevation - Front Bar  
Scale: 1:20

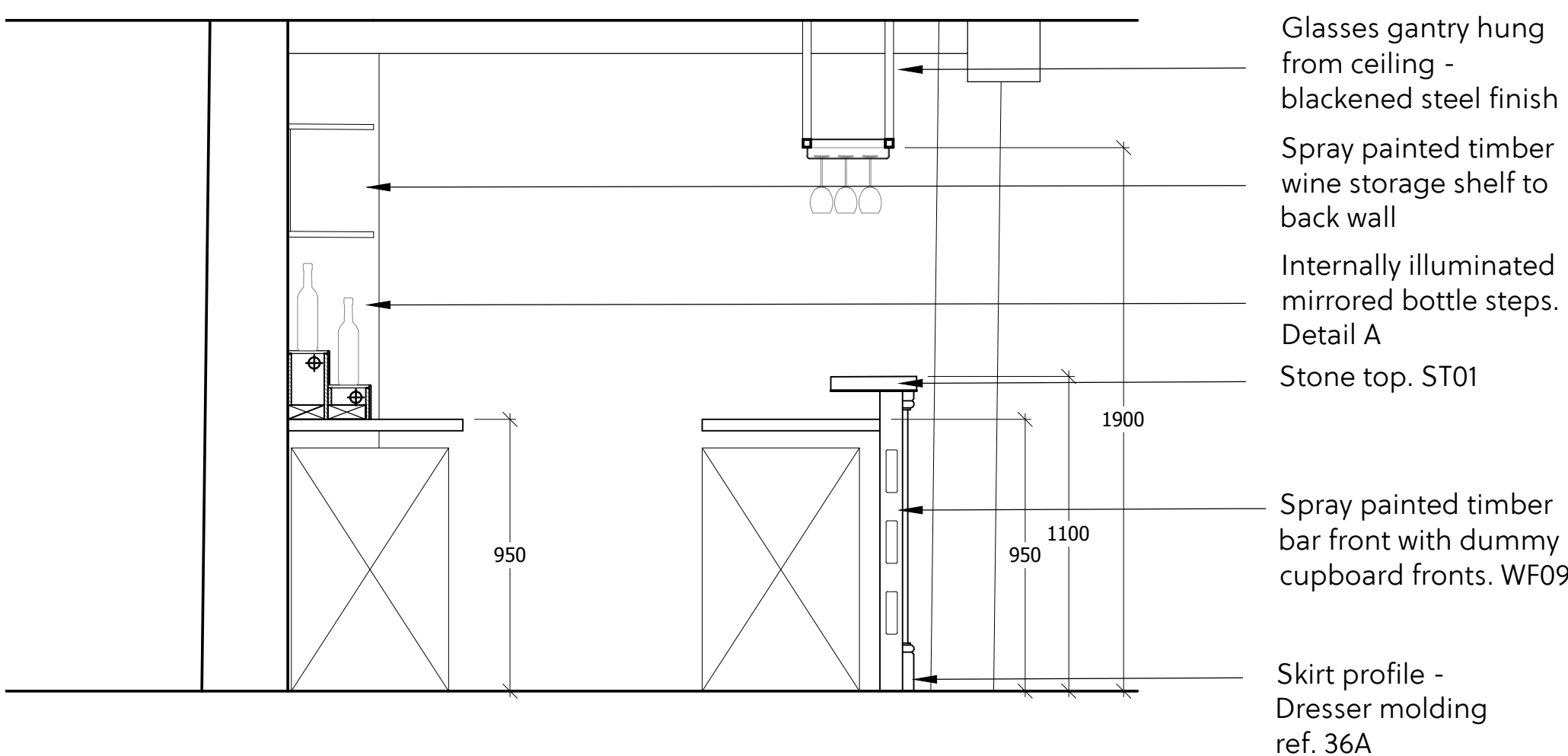

5 Typical section through - Main Bar  
Scale: 1:20

#### General Notes

1. All finishes are to conform to the required current Building Codes & Regulations in the applicable country.
2. The Contractor must verify all site dimensions, drawings, details and specifications and report any discrepancies to StudioARIN before proceeding with any work.
3. The Contractor is to conform to the StudioARIN project preliminaries & scope of works document.
4. All requested drawings showing fixings and construction details are required to be approved by StudioARIN prior to commencement of work.
5. All specified items are to be installed in accordance with the manufacturers recommendations on a suitable substrate.
6. The Contractor is to provide a safe and suitable working environment which conforms to the current Health and Safety and Local Authority regulations.
7. All finishes are to be implemented to a high quality.
8. Any dimensions are to be taken from the setting out plan only and are not to be scaled from the the drawings.
9. It is the contractors responsibility to ensure that any building works are carried out in accordance with current Building Regulations and Local Authority requirements.
10. The contractor is to check and appraise all design intent and construction details and offer alternatives, as appropriate, to implement the design.
11. In the event that there is a conflict in information, the Contractor is to highlight the discrepancies to the designer / Contract Administrator.
12. This drawing is to read in conjunction with the other relevant drawings, specifications, schedules and co-consultants information.
13. Copyright of StudioARIN and is not to be reproduced without permission.

Rev	Date & Item
-	--

X	Reason Issued
X	Information Only
	Local Authority Application
	Tender Issue
	Construction
	As Built Information

#### Job Details

Zaza Restaurant  
The Duck House, Ruislip

Drawing title: Proposed Bar& date  
10/22

Dwg number 10-01  
& revision -

ARIN

info@studioarin.co.uk  
07940934306

#### NOTE:

This plan has been based on a laser survey by others.  
Contractor to check all site dimensions prior to construction & highlight any discrepancies

All alterations subject to relevant planning permissions