

NOTES

1. All dimensions are to be checked on site prior to the commencement of work and any discrepancy is to be reported to the construction manager before construction.
2. All work is to comply with current Building Regulations and allied legislation.
3. All contractors and sub-contractors must ensure that they have the latest issue of this drawing and details before the commencement of work on site.
4. All materials are to be used and installed in strict compliance with the relevant manufacturers instructions and recommendations.
5. All works on site, managed and implemented as a result of the designs indicated on this drawing, are to be given full consideration for compliance with the Health and Safety (COP) Regulations in respect of design and implementation on site and no works are to be undertaken if it is considered that compliance with the Building Regulations cannot be achieved.
6. All dimensions shown in millimetres.
7. Footprint of buildings shown at 0m above ground level.

©Copyright Dusek Design Associates Ltd

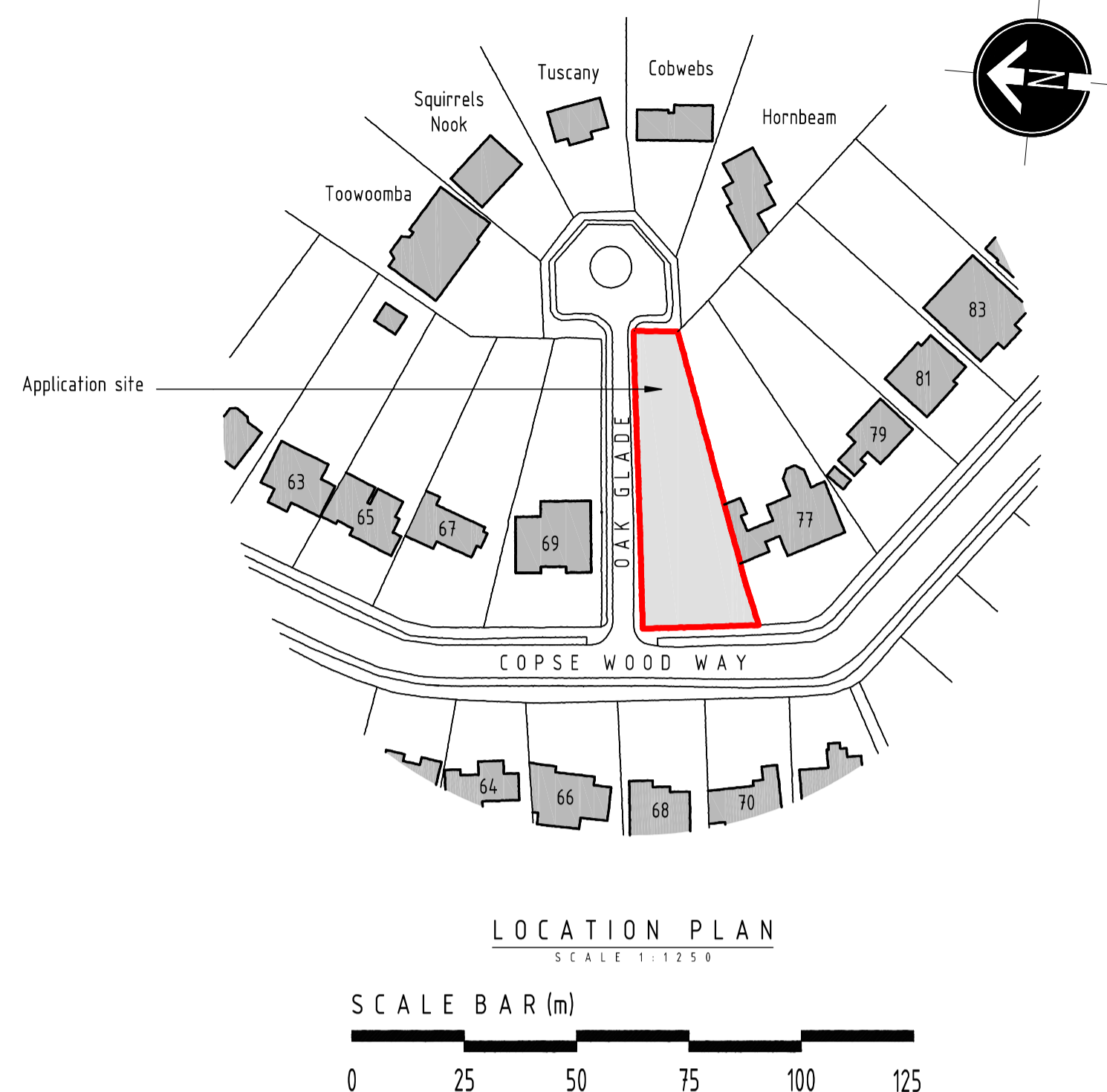
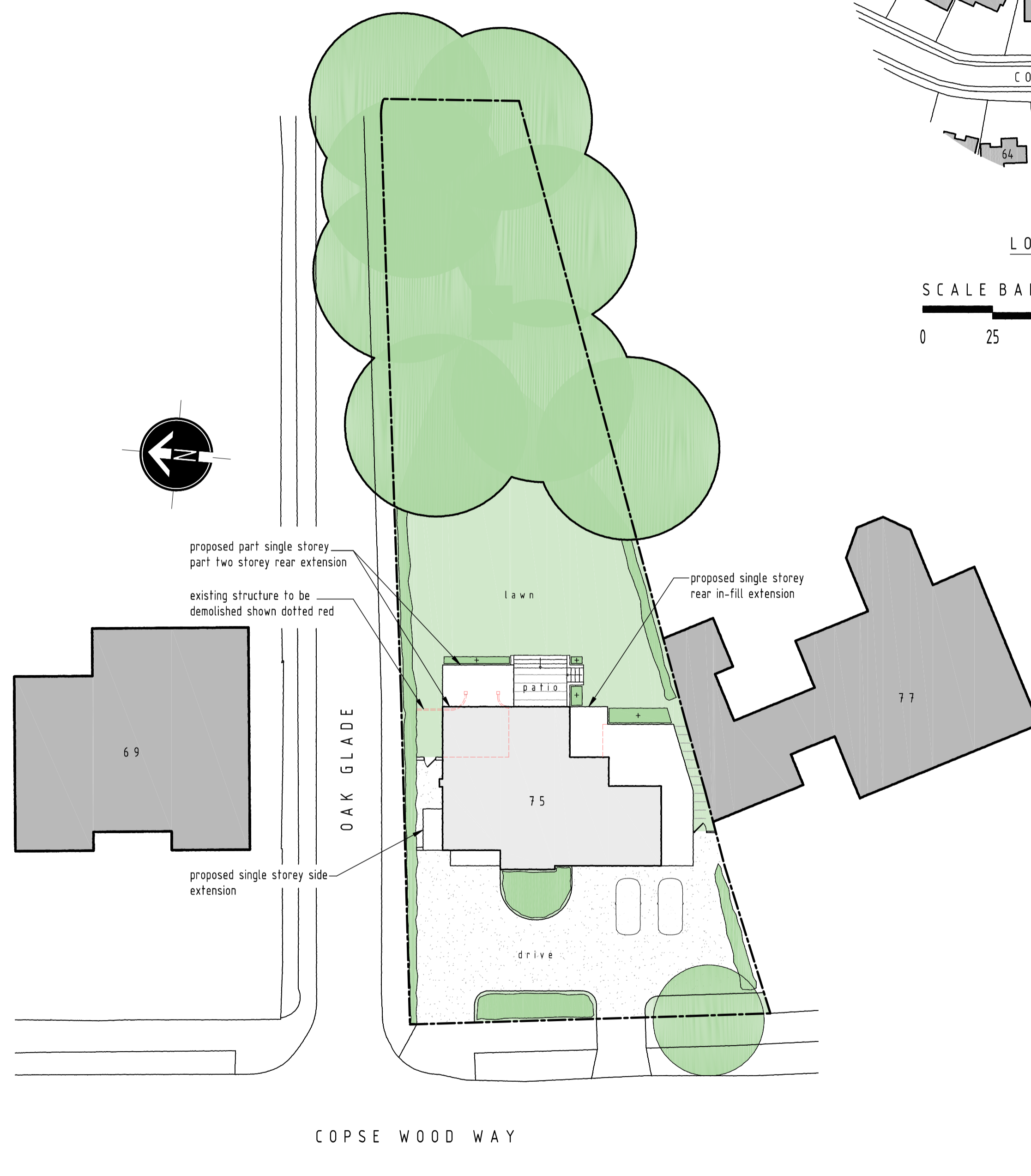
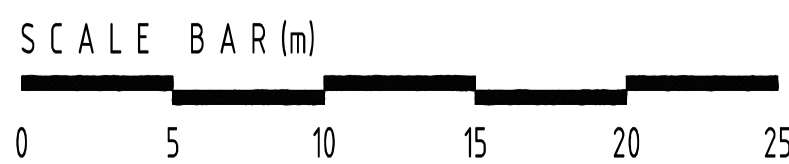
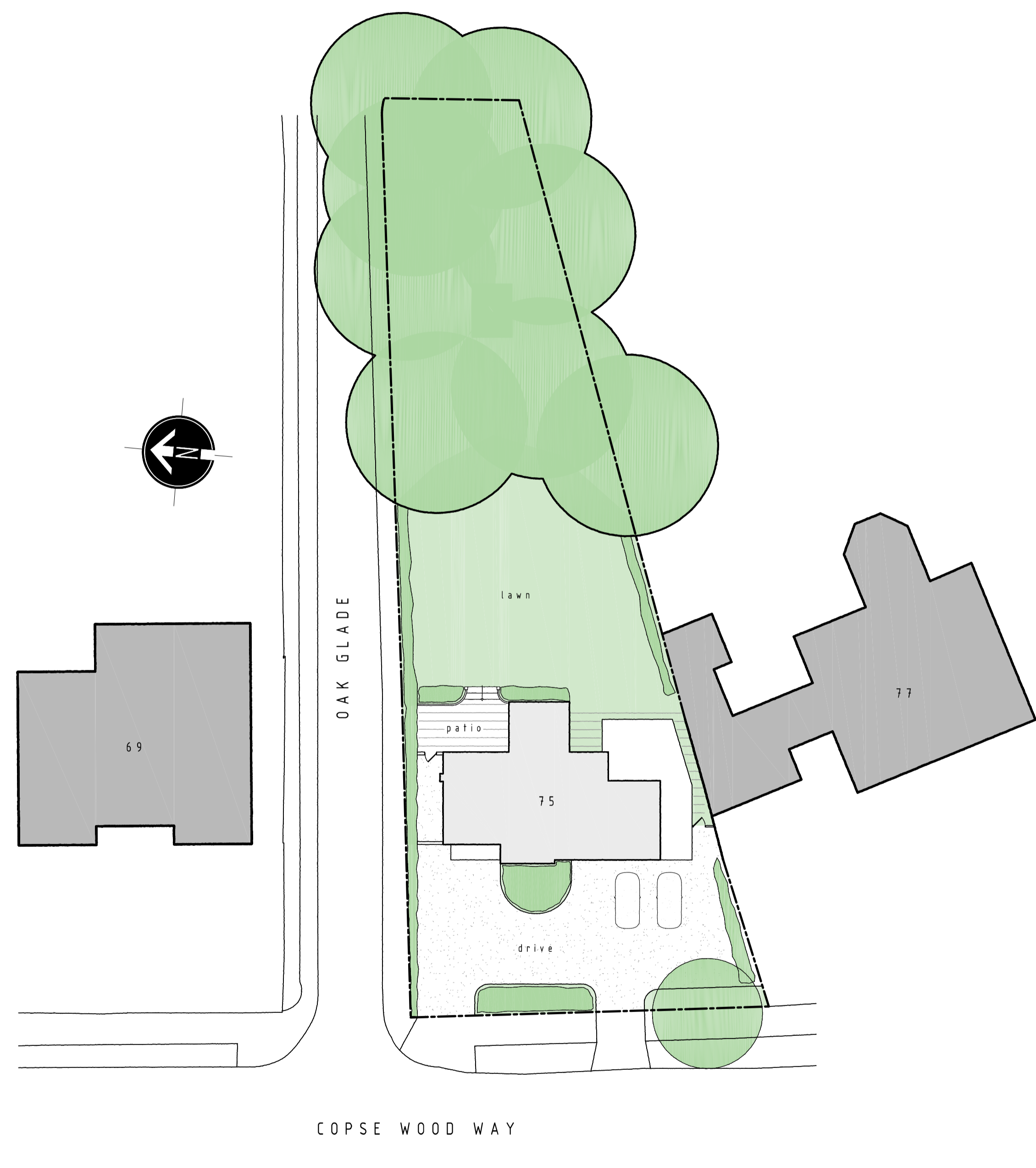

A	15/12/2025	Plans amended
rev:	date:	description:
scale:	1 : 250	A1 date: 30 / 09 / 2025
drawing no:	1530 / P / 1 ^A	drawn: AF
drawing:	PLANNING PROPOSALS	
project:	EXISTING & PROPOSED SITE LAYOUT PLAN	
client:	LAND AT 75 COPSE WOOD WAY, NORTHWOOD, HA6 2TX	
client:	PROPERTY PI	



DUSEK DESIGN ASSOCIATES LTD
ARCHITECTURE + PLANNING

01895 831 103
info@dusek.co.uk
www.dusek.co.uk

print history: Monday, 15 December, 2025 14:30:26

Users\Architect\DDA\Task - Documents\2025\12\15 15:30:26\15 COPSE WOOD WAY, NORTHWOOD\PI\1530-P-1A.dwg