

## SITE INVESTIGATION FACTUAL REPORT

Report No: SI-542609  
Client: Crawford Claims Management  
Site: 6 Nicholas Way  
Hillingdon  
Client Ref: SU2205005  
Date of Visit: 19/12/2022



### Home Emergency Response - Subsidence Investigation - Drainage Services – Crack & Level Monitoring – Property Video Surveys

Unit E2 First Floor Suite, Boundary Court  
Willow Farm Business Park, Castle Donington  
Leicestershire, DE74 2NN

☎ 0843 2272362  
✉ enquiries@cet-uk.com  
🌐 www.cet-uk.com

CET is the trading name of CET Structures Ltd  
Registered in England No. 02527130

# Investigation Layout Plan

Sheet: 1 of 1

Job No: 542609

Date: 19/12/2022

Site: 6 Nicholas way

Work carried out for: Crawford Claims

DWS  
(SI)

SA  
(Checked)

DW  
(Drawn)

Weather: Dry

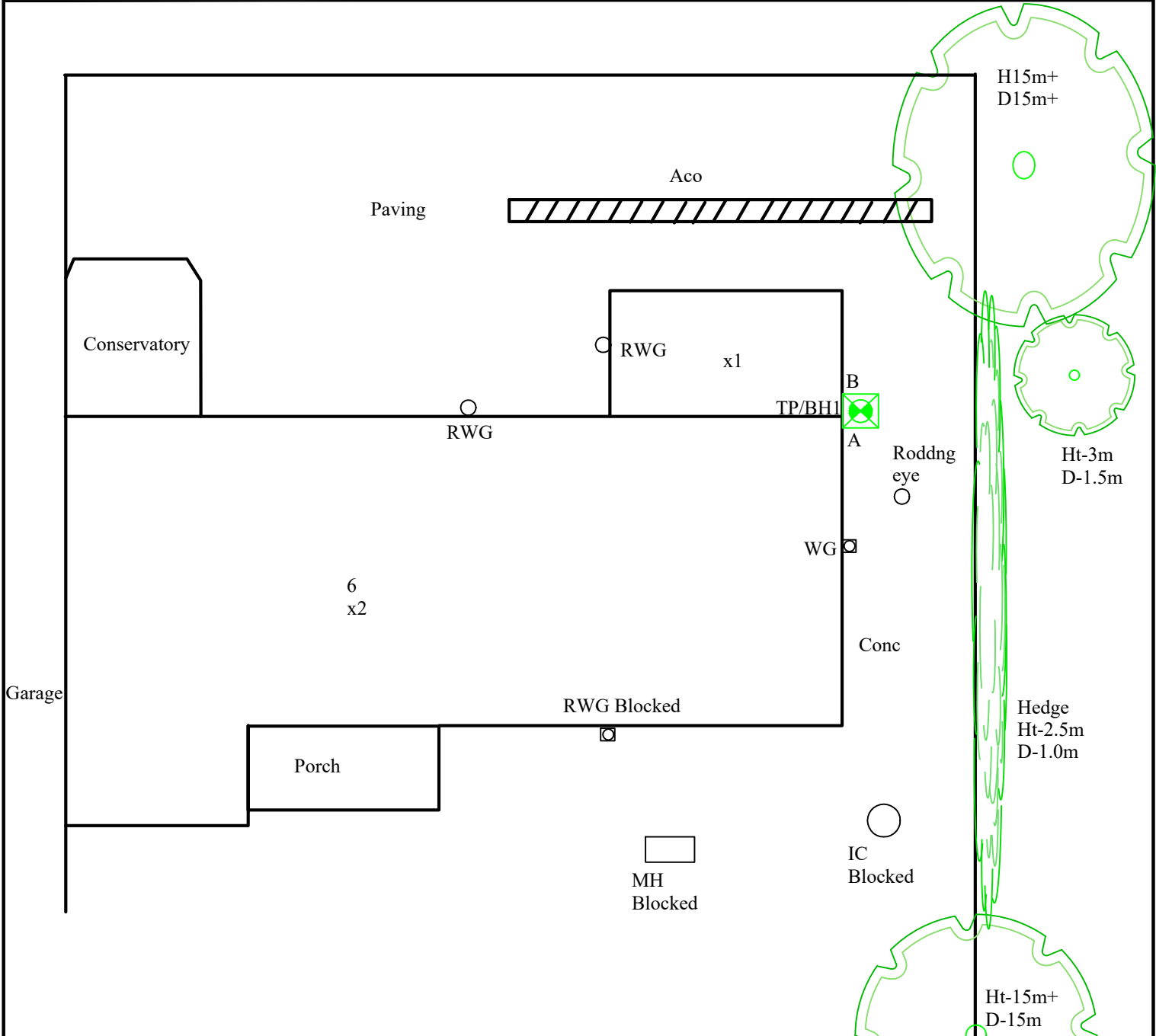

ON SITE TREE IDENTIFICATION FOR GUIDANCE ONLY. NOT AUTHENTICATED.

Remarks:

Key:

- Combined Gully RWWG
- Manhole MH
- Rain Water Pipe RWP
- Rain Water Gully RWG
- Soil Vent Pipe SVP
- Waste Gully WG
- Waste Pipe WP

Surface Water Drain

Foul Water Drain

Tree / Bush

(approx. ht in m)

Trial Pit

Borehole

O/D - Open Discharge

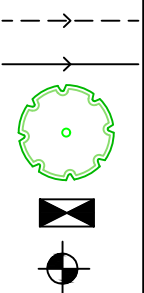

Scale: N.T.S.

**TEST REPORT:** Trial Pit  
**REPORT NUMBER:** C1071973 / 229932.1.1.2  
**TRIAL PIT REF:** TP1B **DATE:** 09/01/2023  
**CLIENT:** Crawford & Co **SITE:** 6 Nicholas Way  
**JOB NO:** 542609 **WEATHER:** Dry  
**EXCAVATION METHOD:** Hand tools

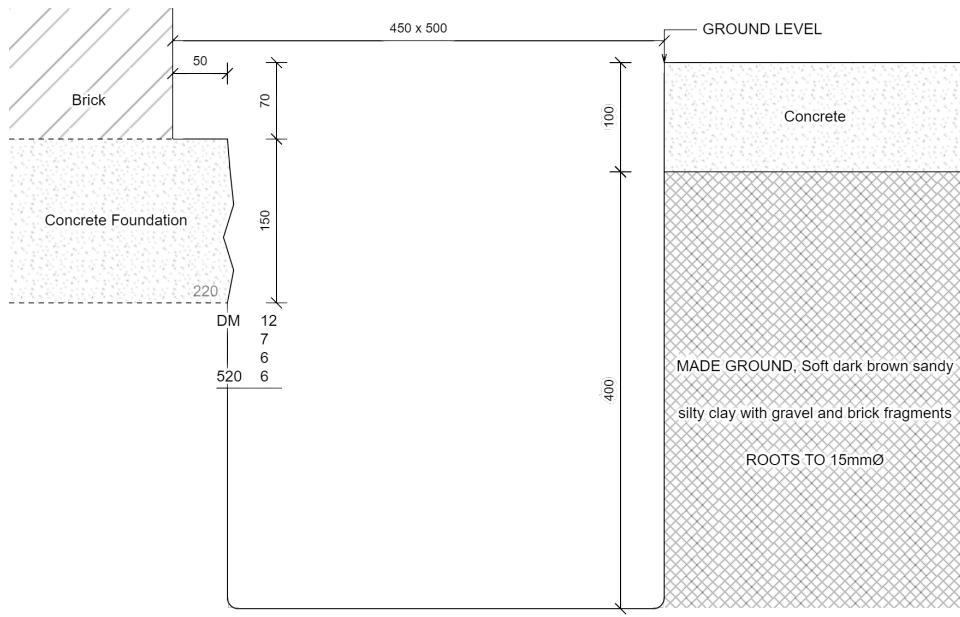

Trial pit ends at 500mm

**Key:**

D Small disturbed sample J Jar sample  
 B Bulk disturbed sample V Pilcon vane (kPa)  
 W Water sample M Mackintosh probe  
 TDTD Too dense to drive

**Remarks:**

Test results reported relate only to the items tested.  
 This report shall not be reproduced except in full without approval of the Laboratory.  
 Opinions and interpretations expressed herein are outside the scope of UKAS Accreditation.  
 The laboratory does not apply a conformity statement to test reports as standard, unless specifically requested by the customer.

For and on behalf of CTS  
 Scott Alger - Lab



Approved Signatory  
 Report date 09-Jan-23

**TEST REPORT:** Trial Pit  
**REPORT NUMBER:** C1071973 / 229932.1.1.1  
**TRIAL PIT REF:** TP1 **DATE:** 09/01/2023  
**CLIENT:** Crawford & Co **SITE:** 6 Nicholas Way  
**JOB NO:** 542609 **WEATHER:** Dry  
**EXCAVATION METHOD:** Hand tools

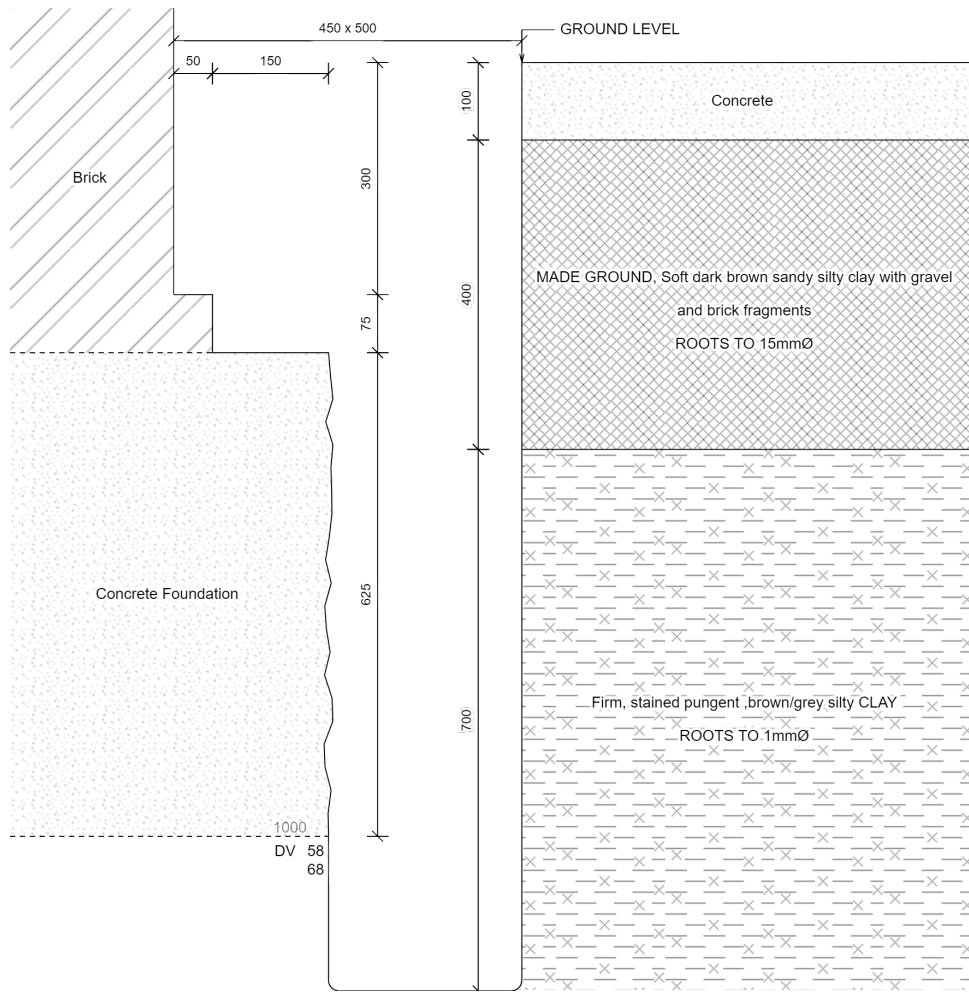

For Strata below 1200mm see Bore Hole log

Water strike at 375mm, standing water level on completion at 375mm. Unable to avoid water ingress.

**Key:**  
 D Small disturbed sample J Jar sample  
 B Bulk disturbed sample V Pilcon vane (kPa)  
 W Water sample M Mackintosh probe  
 TDTD Too dense to drive

**Remarks:**  
 Test results reported relate only to the items tested.  
 This report shall not be reproduced except in full without approval of the Laboratory.  
 Opinions and interpretations expressed herein are outside the scope of UKAS Accreditation.  
 The laboratory does not apply a conformity statement to test reports as standard, unless specifically requested by the customer.

For and on behalf of CTS  
 Scott Alger - Lab



Approved Signatory  
 Report date 09-Jan-23

<b>Borehole</b>		<b>1</b>		Sheet:	1 of 1	Site:	6 NICHOLAS WAY			
				Job No:	542609					
				Date:	19/12/2022					
Boring Method:	Hand Auger			Ground Level:		Client:	CRAWFORD			
Diameter (mm):	75	Weather:	dry							
Depth	Soil Description					Thickness	Legend	Samples and Tests		
(m)								Depth	Type	Result
0.00	See Trial Pit					1.20				
1.20	Firm stained, pungent brown-grey silty CLAY					0.20	x — x x — x			
1.40	End of BH									
Remarks:						Key:			To	Max
BH ends at 1.4m, unable to extract samples through water. Water Strike in trial pit at 375mm, BH open with standing water level at 1.2m on completion.						D - Disturbed Sample			Depth	Dia
						B - Bulk Sample			(m)	(mm)
						W - Water Sample			1.40	1
						J - Jar Sample				
						V - Pilcon Shear Vane (kPa)				
						M - Mackintosh Probe			1.20	
						TDTD - Too Dense To Drive				
Logged:	SP	AM	Checked:	Approved:	Version	V1.0 28/01/16		N.T.S.		



## SITE INVESTIGATION LABORATORY TEST REPORT

SI REPORT NUMBER: 542609

CLIENT : CET Property Assurance (Crawford Claims Management)

SITE:  
6 Nicholas Way  
Northwood  
HA6 2TS

DATE OF SITE VISIT:  
19/12/2022

DATE RECEIVED BY LABORATORY:  
03/01/2023

M. Winn  
Compiled by : .....  
M. Winn - Senior Laboratory Technician

C. Major  
Approved by : .....  
C. Major - Laboratory Manager

DATE REPORTED: 24-Jan-2023

# Laboratory Summary Results

Our Ref : 542609  
 Location : 6 Nicholas Way, Northwood, HA6 2TS  
 Client : CET Property Assurance (Crawford Claims Management)  
 Address : Unit 4, Boundary Court, Willow Farm Business Park, Castle Donington, DE74 2NN

Date Sampled: 19/12/2022  
 Date Received : 03/01/2023  
 Date Tested : 18/01/2023  
 Date of Report : 24/01/2023

Sample Ref		Type	Moisture Content (%) [1]	Soil Fraction > 0.425mm (%) [2]	Liquid Limit (%) [3]	Plastic Limit (%) [4]	Plasticity Index (%) [5]	Liquidity * Index [5]	Modified * Plasticity Index (%) [6]	Soil * Class [7]	Filter Paper Contact Time (d)	Soil Sample Suction (kPa) [8]	Oedometer Strain [9]	Estimated * Heave Potential (Dd) (mm)[10]	In situ * Shear Vane Strength (kPa) [11]	Organic * Content (%) [12]	pH * Value [13]	Sulphate Content * (g/l)		* Class [16]
TP/BH No	Depth (m)																	SO3 [14]	SO4 [15]	
1B	U/S 0.22	D	42	<5	78	26	52	0.31	52	CV										
1A	1.0	D	49	<5	73	32	41	0.41	41	CV										

**Test Methods / Notes**

- [1] BS 1377 : Part 2 : 1990, Test No 3.2
- [2] Estimated if <5%, otherwise measured
- [3] BS 1377 : Part 2 : 1990, Test No 4.4
- [4] BS 1377 : Part 2 : 1990, Test No 5.3
- [5] BS 1377 : Part 2 : 1990, Test No 5.4
- [6] BRE Digest 240 : 1993
- [7] BS 5930 : 2018 : Figure 8 - Plasticity Chart for the classification of fine soils

[8] Building Research Establishment Information Paper 4/93

- [9] In Accordance with BS 1377-5 : 1990 : Clause 3
- [10] Estimated Heave Potential (Dd)
- [11] Values of shear strength were determined in situ by CTS using a Pilcon hand vane or Geonor vane (GV).
- [12] BS 1377 : Part 3 : 1990, Test No 4
- [13] BS 1377 : Part 3 : 1990, Test No 9
- [14] BS 1377 : Part 3 : 1990, Test No 5.6
- [15]  $SO_4 = 1.2 \times SO_3$

[16] BRE Special Digest One (Concrete in Aggressive Ground) August 2005

Note that if the SO4 content falls into the DS-4 or DS-5 class, it would be prudent to consider the sample as falling into the DS-4M or DS-5M class respectively unless water soluble magnesium testing is undertaken to prove otherwise.  
 PSD Chart - BS 1377: Part 2 : 1990, Test No 9.2

\* These tests are not UKAS accredited  
 Full reports can be provided upon request.

**Key**

- D Disturbed sample ( small )
- B Disturbed sample ( bulk )
- U Undisturbed sample
- W Groundwater sample
- ENP Essentially Non-Plastic by inspection
- U/S Underside of Foundation

Test results reported relate only to the items tested.  
 This report shall not be reproduced except in full without approval of the laboratory.  
 The laboratory does not apply a conformity statement to test reports as standard, unless specifically requested by the customer.  
 Opinions and interpretations expressed herein are outside of the scope of UKAS accreditation.



# Moisture Content Profiles

Our Ref : 542609  
Location : 6 Nicholas Way, Northwood, HA6 2TS  
Work carried out for: CET Property Assurance (Crawford Claims Management)

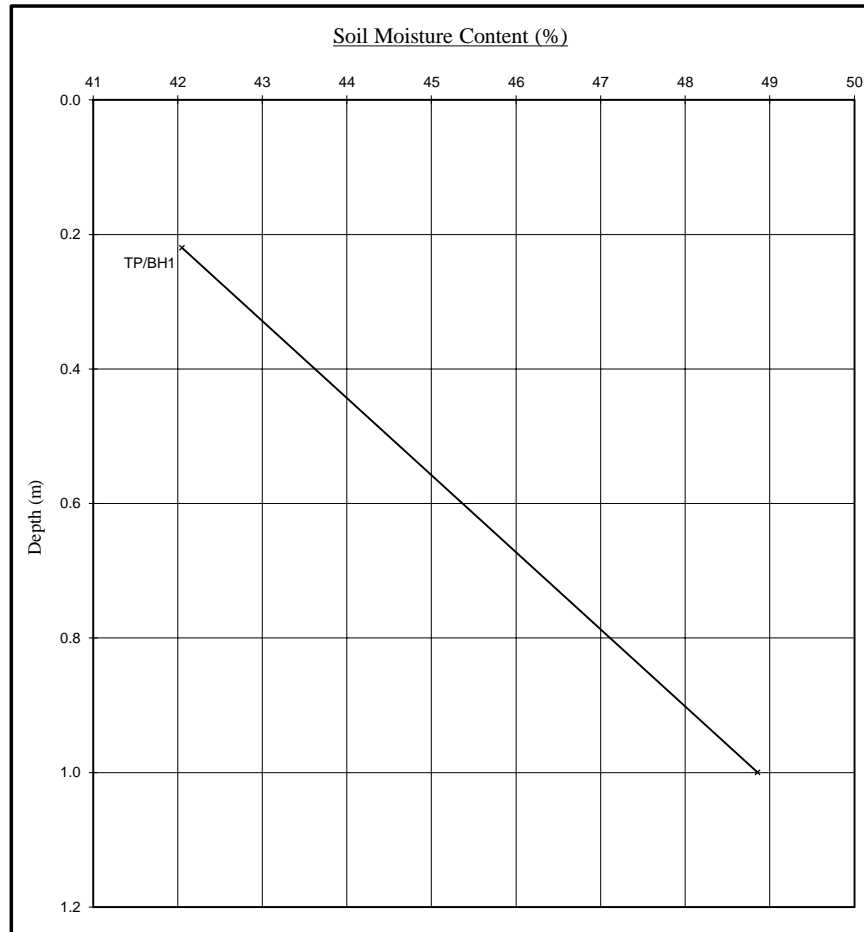

## Notes

1. If plotted, 0.4 LL and PL+2 ( after Driscoll, 1983 ) should only be applied to London Clay ( and similarly overconsolidated clay) at shallow depths.
2. Unless specifically noted the profiles have not been related to a site datum.

Construction Testing Solutions  
4 Oak Spinney Park  
Ratby Lane  
Leicester Forest East  
Leicestershire  
LE3 3AW

Intec  
Parc Menai, Bangor,  
Gwynedd, North Wales  
LL57 4FG  
Tel: 01248 672652  
Fax: 01248 672601

# ROOT IDENTIFICATION

**6 Nicholas Way,**

Client Reference: 542609  
Report Date: 10 January 2023  
Our Ref: R49815

Sub Sample	Species Identified		Root Diameter	Starch
<b>TP1A:</b>				
USF	broadleaved species, too decayed for positive identification	1	1.5 mm	Absent
<b>TP1B:</b>				
USF	unidentified broadleaved species.	2	10 mm	Absent
<b>BH1:</b>				
to 1.4m	broadleaved species, too decayed for positive identification	1	<1 mm	Absent

**Comments:**

1 - Very rotted.

**2 - It would be possible to include/discount species from the list of possibilities. Please contact the laboratory with a list of species on site if this would be useful.**

**Signed:** M D Mitchell

Unless we are otherwise instructed in writing, the above sample material will normally be disposed of 6 years after the date of this report.



<b>Water Mains Test</b>	Sheet:		Site:	
	Job No:	542609		6 NICHOLAS WAY
	Date:	19/12/22	Client:	CRAWFORD CLAIMS

Test	Start Time	Gauge Pressure (bar)		
		0 mins	5 mins	10 mins

If pressure drops before 5 minute test complete, advise time:

Test	Start Time	Gauge Pressure (bar)		
		0 mins	5 mins	10 mins

If pressure drops before 5 minute test complete, advise time:

Test	Start Time	Gauge Pressure (bar)		
		0 mins	5 mins	10 mins

If pressure drops before 5 minute test complete, advise time:

Listening Stick Water Mains Test

Period listening test carried out with all available water services within property switched off:

Any indication of leak detected by way of sound with stick placed on stop cock:

When taps are used, toilets flushed or any other water demand appliance used is there a noticeable flushing noise heard from the listening stick:

Photos Taken of Property

Front

Side

Rear

Internal Floor Coverings and Location of Stopcock

Reason for No External Photos:

Reason for No Internal Photos:

Information Notes

A site plan with external and internal stopcocks is required - also ground surfaces and assumed route of water main.

Water main stop cocks that appear to be seized or in an un-serviceable condition, are not to be forced to complete test, - a listening stick is to be used.

Remarks:

Logged:	sp	Checked:		Approved:	
---------	----	----------	--	-----------	--