

01 PROPOSED MEZZANINE PLAN
1:200

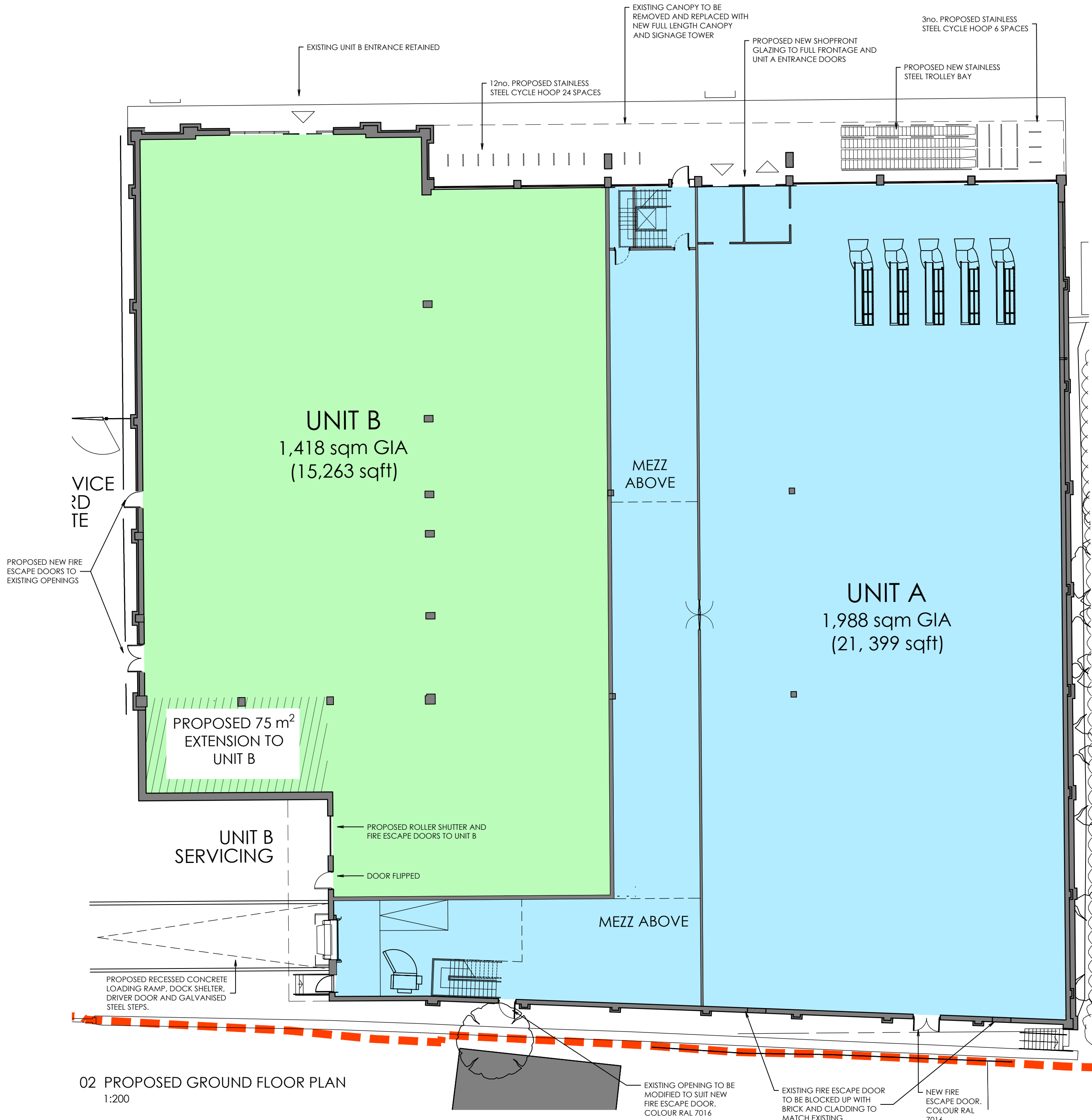
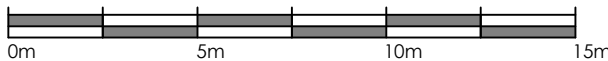

02 PROPOSED GROUND FLOOR PLAN
1:200

The Harris Group Ltd does not accept liability for any deviation to our drawings or specification. This Drawing is copyright and may not be reproduced in whole or part without written authority.

Rev	Date	Description	Drawn	Chk'd
P01	02.07.24	Cycle parking and shopfront amended	JT	DRW

SITE AREA	2.30 acres
PROPOSED CUSTOMER SPACES	137 TOTAL SPACES 9 DDA, 6 P&C, 8 ACTIVE & 6 PASSIVE EV SPACES) PLUS 8 MOTORCYCLE SPACES

PROPOSED UNIT A	
GROSS INTERNAL AREA	1,988 sqm
GROUND FLOOR	1,748 sqm
MEZZANINE	240 sqm

PROPOSED UNIT B	
GROSS INTERNAL AREA	1,418 sqm

PLANNING DRAWING

This drawing has been prepared for submission to the relevant Local Authority as part of a Planning Application. It is not intended to assist with the pricing of any elements.

For Structural details refer to the Structural & Civil Engineers detailed design drawings & specifications.

For M&E information, refer to the M&E Engineers and sub contractor's design drawings & specifications.

For Health & Safety information, refer to the Designers Risk Assessments. This drawing is copyright and may not be reproduced in whole or part without written authority.

 THE HARRIS PARTNERSHIP ARCHITECTS www.harrispartnership.com	WAKEFIELD - T. 01924 291800 2 St John's North, Wakefield, WF1 3GA
	MANCHESTER - T. 0161 238855 Canvies Warehouse, 77 Dale Street, Manchester, M1 2HG
	MILTON KEYNES - T. 01908 211 577 The Old Rectory, 79 High Street Newport Pagnell, MK16 6AB
	READING - T. 0118 950 7700 101 London Road, Reading, RG1 5BY
	LONDON - T. 020 7409 1215 10 Gees Court, St Christopher's Place, London, W1U 1JJ

Client

LEGAL & GENERAL

Project Title

PROPOSED DEVELOPMENT

HAREFIELD ROAD
UXBRIDGE
UB8 1JS

Drawing Title

PROP. GROUND & MEZZANINE PLANS

Drawn	Checked	Scale @A2	Status	Date
JT	DRW	1:200	N/A	11/23

Drawing Status	Rev.	THP Project No
PLANNING	P01	16401-1

Project No.	Originator	Volume	Level	Type	Role	Number
16401-1	THPR	XX	ZZ	DR	A	1011