

NOTES

- 1. Do not scale from this drawing.
- 2. This drawing to be read & printed in colour.
- 3. This drawing is for illustrative purposes only.

C	Revised scheme base & swept paths.	HE	JT	28.07.2023
B	New fire tender swept path added.	HE	JT	26.07.2023
A	Additional topo & design changes to suit.	HE	JT	25.07.2023
Rev	Details	REVISION HISTORY		
Status:		<input type="checkbox"/> Preliminary	<input type="checkbox"/> For Approval	<input type="checkbox"/> For Construction
		<input checked="" type="checkbox"/> For Information	<input type="checkbox"/> For Tender	<input type="checkbox"/> As Built

Client:

Bouygues UK

Project:

Rosedale College

Drawing Title:

Architects Indicative Layout

Scale:
1:1250

Size:
A3

Drawn by:
HE

Checked by:
GS

Date:
20.07.2023



CANEPARO ASSOCIATES
Transport Planning & Highway Design
21 Little Portland Street • London • W1W 8BT • Tel. 020 3617 8200

Scheme Ref:
CA5203

Drawing No:
TR001

Sheet :
1 of 7

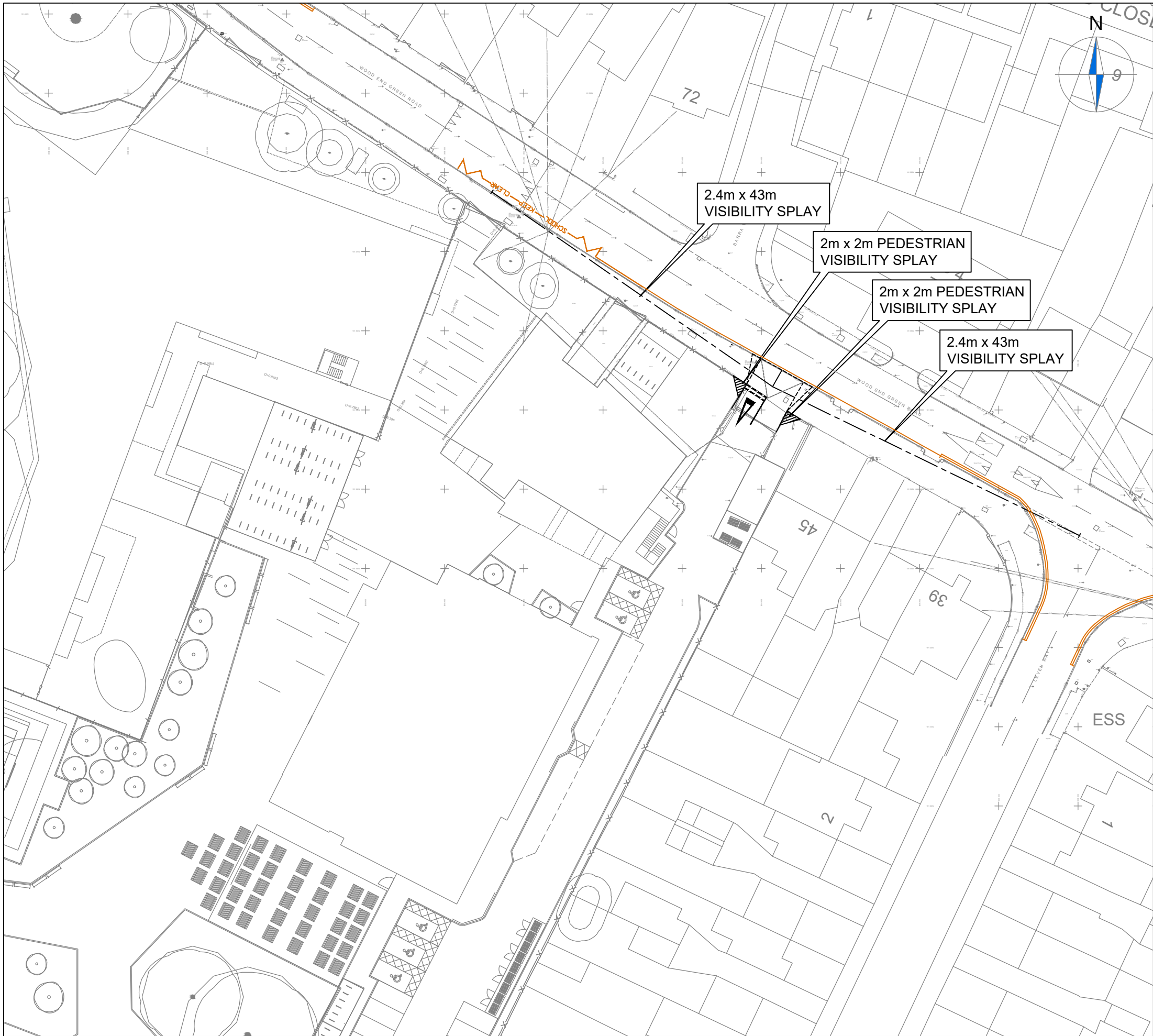
Rev:
C



NOTES

- 1. Do not scale from this drawing.
- 2. This drawing to be read & printed in colour.
- 3. This drawing is for illustrative purposes only.

C	Revised scheme base & swept paths.	HE	JT	28.07.2023			
B	New fire tender swept path added.	HE	JT	26.07.2023			
A	Additional topo & design changes to suit.	HE	JT	25.07.2023			
Rev	Details	REVISION HISTORY			Drawn	Checked	Date
Status:							
<input type="checkbox"/> Preliminary							
<input type="checkbox"/> For Approval							
<input type="checkbox"/> For Construction							
<input checked="" type="checkbox"/> For Information							
<input type="checkbox"/> For Tender							
<input type="checkbox"/> As Built							

Client:

Bouygues UK

Project:

Rosedale College

Drawing Title:

Architects Indicative Layout
Proposed Wood End Green Road Access

Scale:

1:500

Size:

A3

Drawn by:

HE

Checked by:

GS

Date:

20.07.2023

CANEPARO ASSOCIATES

Transport Planning & Highway Design

21 Little Portland Street • London • W1W 8BT • Tel. 020 3617 8200

Scheme Ref:

CA5203

Drawing No:

TR001

Sheet :

2 of 7

Rev:

C

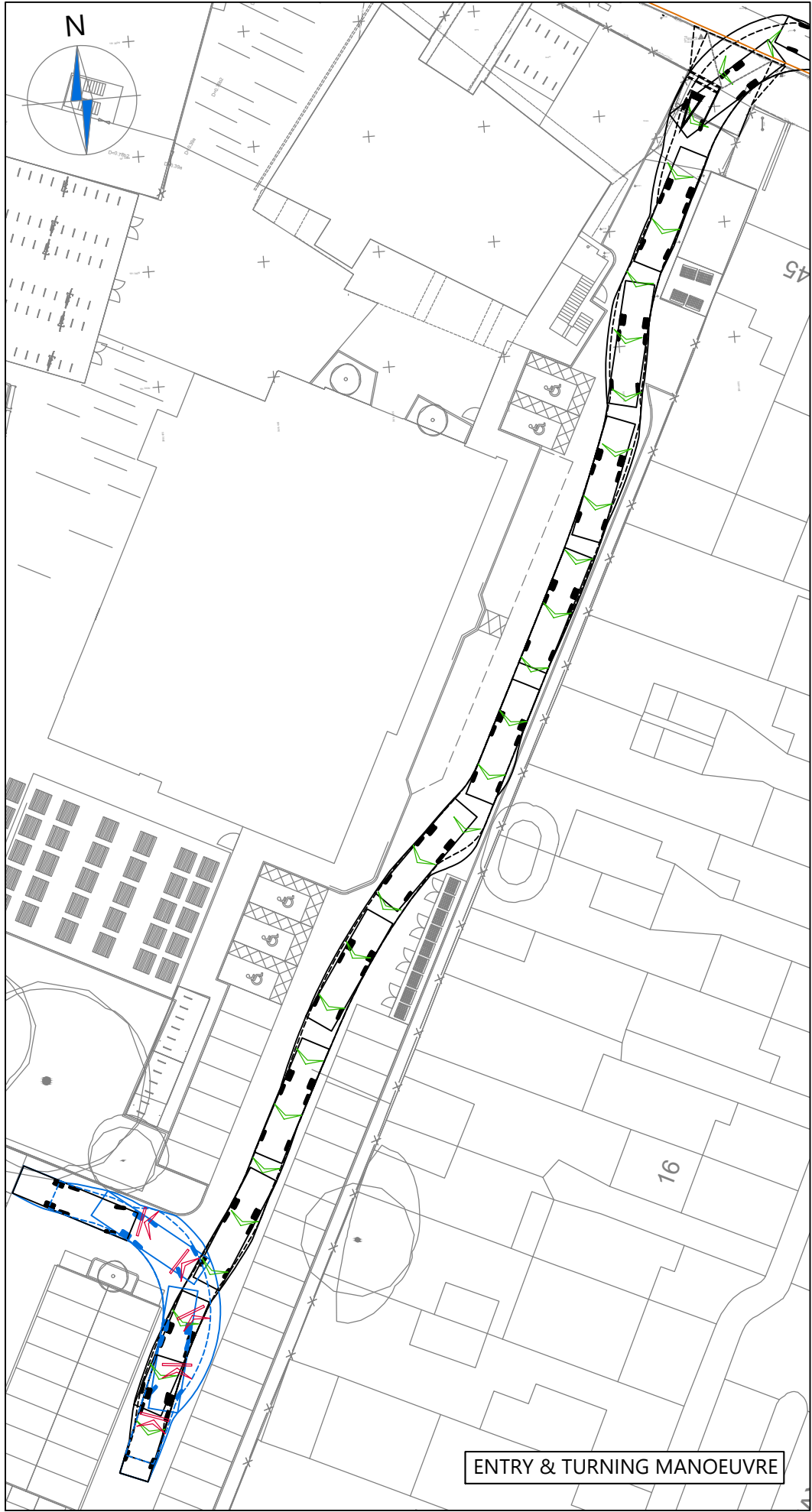

ENTRY & TURNING MANOEUVRE

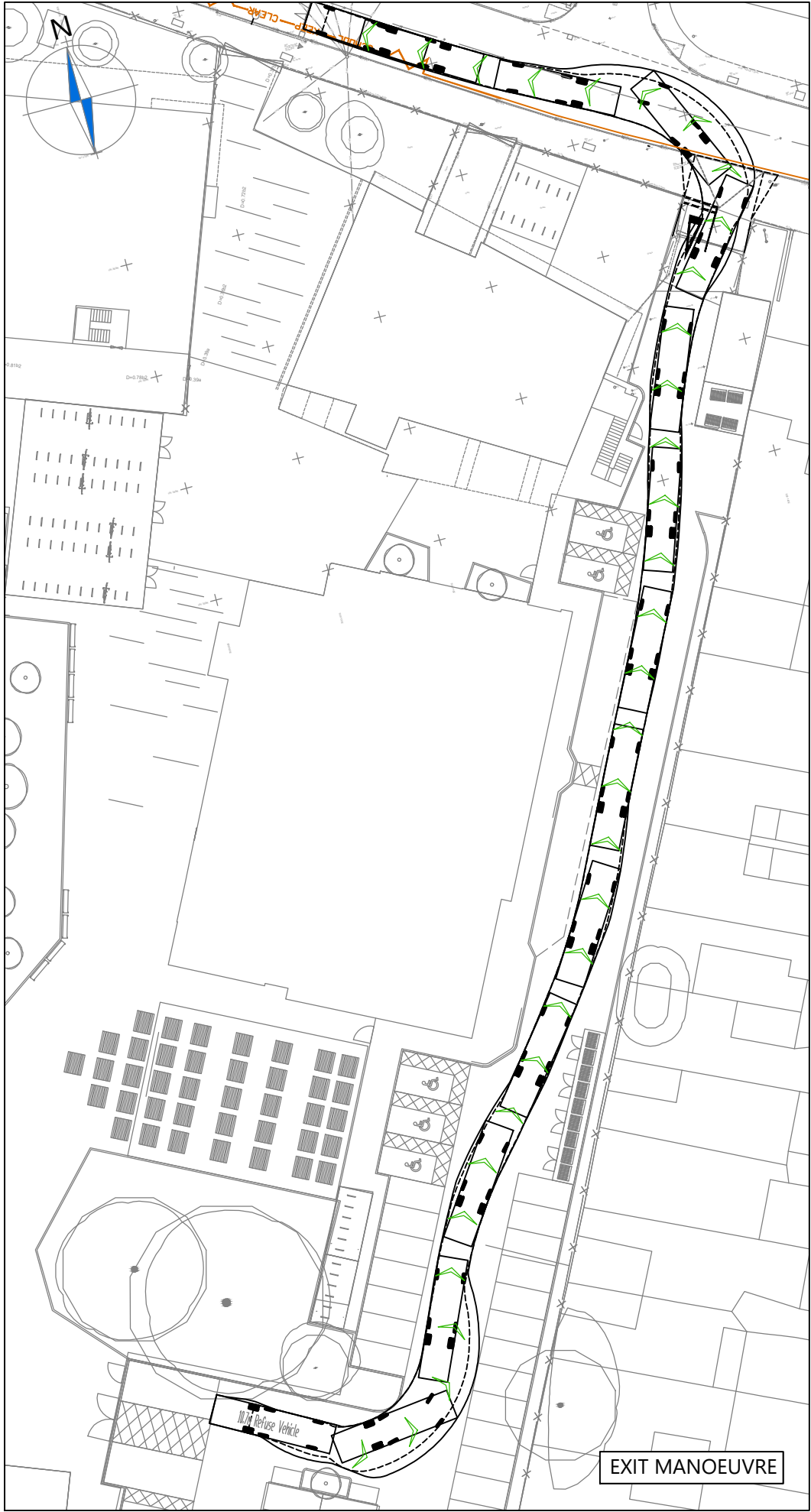

EXIT MANOEUVRE

NOTES

1. Do not scale from this drawing.
2. This drawing to be read & printed in colour.
3. This drawing is for illustrative purposes only.

10.7m REFUSE VEHICLE

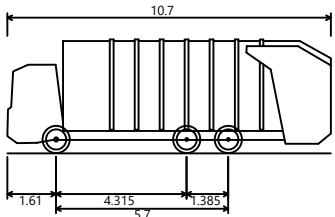

Overall Length 10.700m
Overall Width 2.550m
Overall Body Height 3.760m
Min Body Ground Clearance 0.312m
Track Width 2.550m
Lock to lock time 4.00s
Kerb to Kerb Turning Radius 11.450m

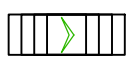

FORWARD MOVEMENTS ARE SHOWN
IN BLACK (*design speed - 5kph*)



REVERSE MOVEMENTS ARE SHOWN
IN BLUE (*design speed - 2.5kph*)

C	Revised scheme base & swept paths.	HE	JT	28.07.2023
B	New fire tender swept path added.	HE	JT	26.07.2023
A	Additional topo & design changes to suit.	HE	JT	25.07.2023

Rev Details Drawn Checked Date

REVISION HISTORY

Status: ☐ Preliminary ☐ For Approval ☐ For Construction
☒ For Information ☐ For Tender ☐ As Built

Client: Bouygues UK

Project: Rosedale College

Drawing Title: Swept Path Analysis using a 10.7m Refuse Vehicle

Scale: 1:500 Size: A3

Drawn by: HE Checked by: GS Date: 20.07.2023

CANEPARO ASSOCIATES
Transport Planning & Highway Design
21 Little Portland Street • London • W1W 8BT • Tel. 020 3617 8200

Scheme Ref: CA5203 Drawing No: TR001 Sheet: 3 of 7 Rev: C



ENTRY & TURNING MANOEUVRE



EXIT MANOEUVRE

NOTES

1. Do not scale from this drawing.
2. This drawing to be read & printed in colour.
3. This drawing is for illustrative purposes only.

LONDON FIRE BRIGADE PUMPING APPLIANCE

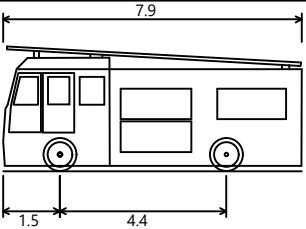

Overall Length	7.900m
Overall Width	2.500m
Overall Body Height	3.300m
Min Body Ground Clearance	0.140m
Track Width	2.500m
Lock to lock time	4.00s
Kerb to Kerb Turning Radius	7.750m

FORWARD MOVEMENTS ARE SHOWN IN BLACK (design speed - 5kph)

REVERSE MOVEMENTS ARE SHOWN IN BLUE (design speed - 2.5kph)

C	Revised scheme base & swept paths.	HE	JT	28.07.2023
B	New fire tender swept path added.	HE	JT	26.07.2023
A	Additional topo & design changes to suit.	HE	JT	25.07.2023

Rev Details REVISION HISTORY Drawn Checked Date

Status: ☐ Preliminary ☐ For Approval ☐ For Construction ☒ For Information ☐ For Tender ☐ As Built

Client:

Bouygues UK

Project:

Rosedale College

Drawing Title:

Swept Path Analysis using a 7.9m LFB Pumping Appliance

Scale: 1:750 Size: A3

Drawn by: HE Checked by: GS Date: 20.07.2023



21 Little Portland Street • London • W1W 8BT • Tel. 020 3617 8200

Scheme Ref: CA5203 Drawing No: TR001 Sheet: 4 of 7 Rev: C

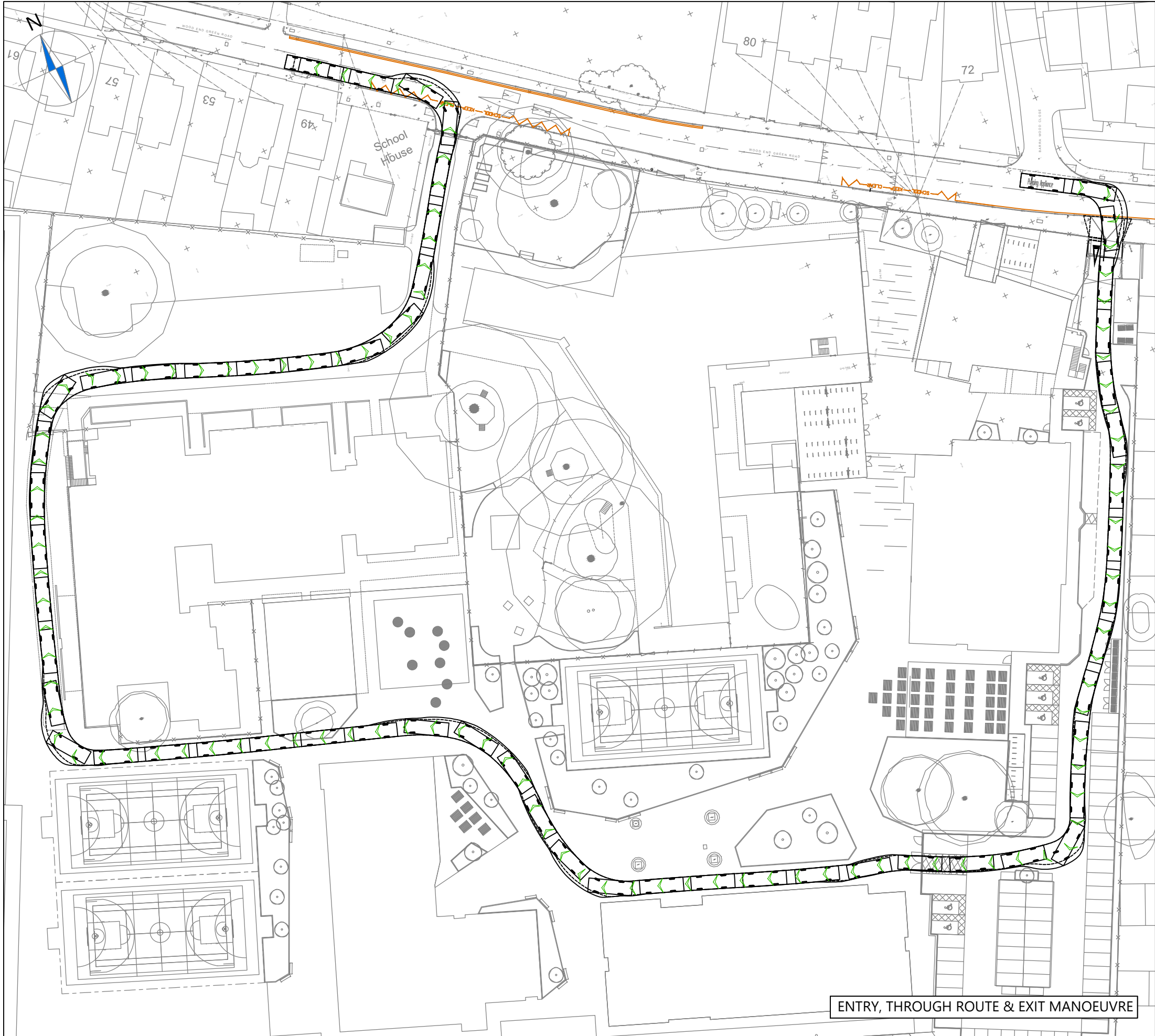

NOTES

1. Do not scale from this drawing.
2. This drawing to be read & printed in colour.
3. This drawing is for illustrative purposes only.

LONDON FIRE BRIGADE PUMPING APPLIANCE

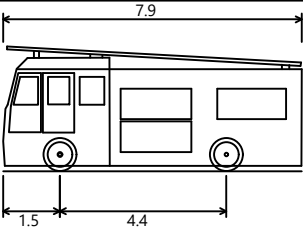

Overall Length	7.900m
Overall Width	2.500m
Overall Body Height	3.300m
Min Body Ground Clearance	0.140m
Track Width	2.500m
Lock to lock time	4.00s
Kerb to Kerb Turning Radius	7.750m

FORWARD MOVEMENTS ARE SHOWN IN BLACK (design speed - 5kph)

REVERSE MOVEMENTS ARE SHOWN IN BLUE (design speed - 2.5kph)

C	Revised scheme base & swept paths.	HE	JT	28.07.2023
B	New fire tender swept path added.	HE	JT	26.07.2023
A	Additional topo & design changes to suit.	HE	JT	25.07.2023

Rev Details REVISION HISTORY Drawn Checked Date

Status: ☐ Preliminary ☐ For Approval ☐ For Construction ☒ For Information ☐ For Tender ☐ As Built

Client:

Bouygues UK

Project:

Rosedale College

Drawing Title:

Swept Path Analysis using a 7.9m LFB Pumping Appliance

Scale: Not to Scale Size: A3

Drawn by: HE Checked by: GS Date: 20.07.2023

CANEPARO ASSOCIATES
Transport Planning & Highway Design
21 Little Portland Street • London • W1W 8BT • Tel. 020 3617 8200

Scheme Ref: CA5203 Drawing No: TR001 Sheet: 5 of 7 Rev: D

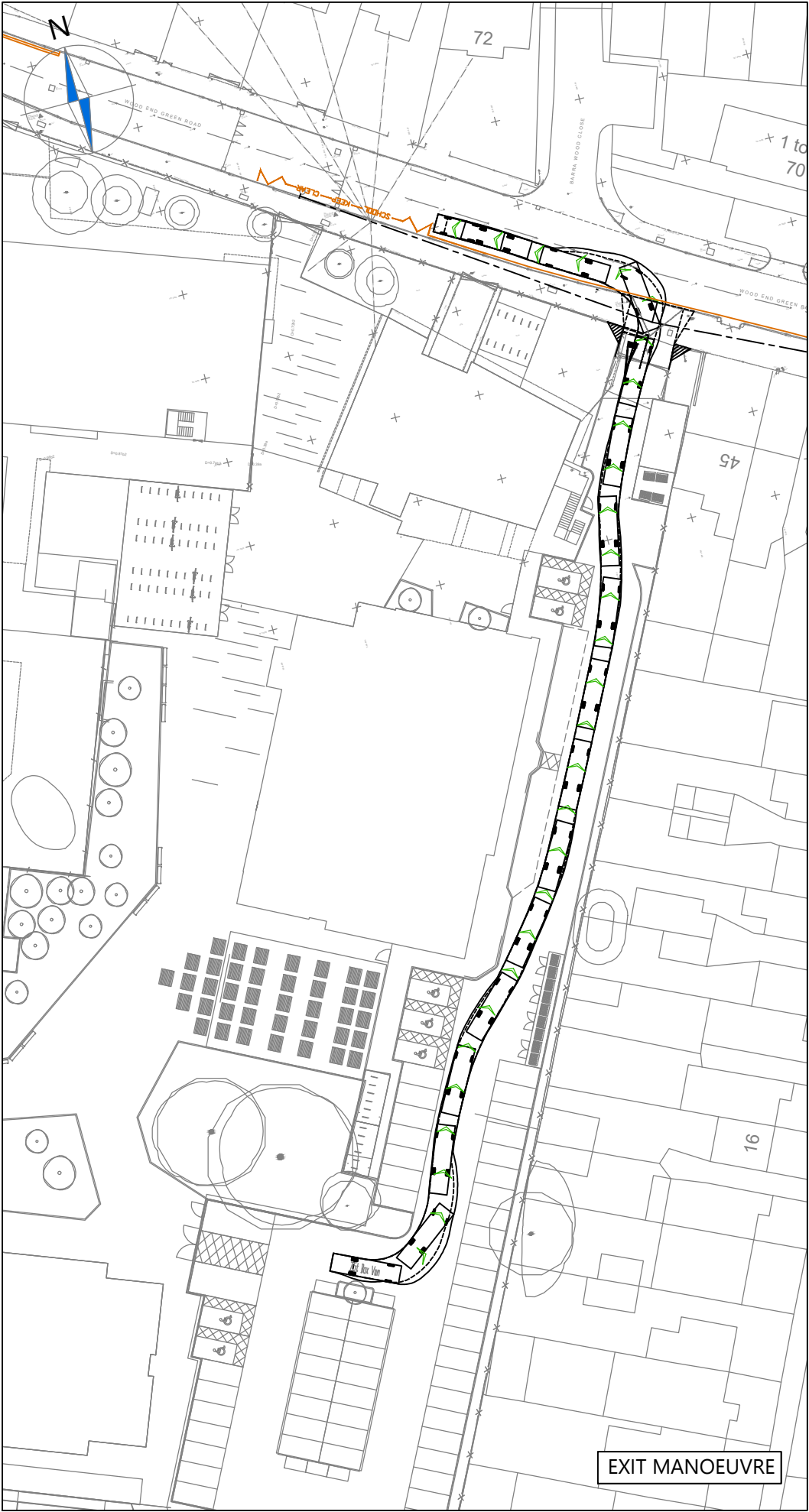

NOTES

- 1. Do not scale from this drawing.
- 2. This drawing to be read & printed in colour.
- 3. This drawing is for illustrative purposes only.

7.5T BOX VAN

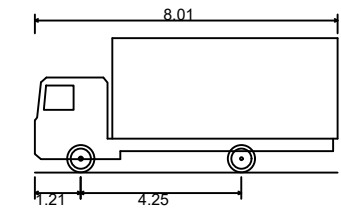

Overall Length	8.010m
Overall Width	2.100m
Overall Body Height	3.556m
Min Body Ground Clearance	0.351m
Track Width	2.064m
Lock to Lock Time	4.00s
Kerb to Kerb Turning Radius	7.400m

FORWARD MOVEMENTS ARE SHOWN IN BLACK (design speed - 5kph)

REVERSE MOVEMENTS ARE SHOWN IN BLUE (design speed - 2.5kph)

C	Revised scheme base & swept paths.	HE	JT	28.07.2023
B	New fire tender swept path added.	HE	JT	26.07.2023
A	Additional topo & design changes to suit.	HE	JT	25.07.2023

Rev	Details	Drawn	Checked	Date
REVISION HISTORY				
Status:	<input type="checkbox"/> Preliminary <input type="checkbox"/> For Approval <input type="checkbox"/> For Construction			
	<input checked="" type="checkbox"/> For Information <input type="checkbox"/> For Tender <input type="checkbox"/> As Built			

Client: Bouygues UK

Project: Rosedale College

Drawing Title: Swept Path Analysis using an 8m 7.5t Box Van

Scale: 1:750 Size: A3

Drawn by: HE Checked by: GS Date: 20.07.2023

CANEPARO ASSOCIATES
Transport Planning & Highway Design
21 Little Portland Street • London • W1W 8BT • Tel. 020 3617 8200

Scheme Ref: CA5203 Drawing No: TR001 Sheet: 6 of 7 Rev: C

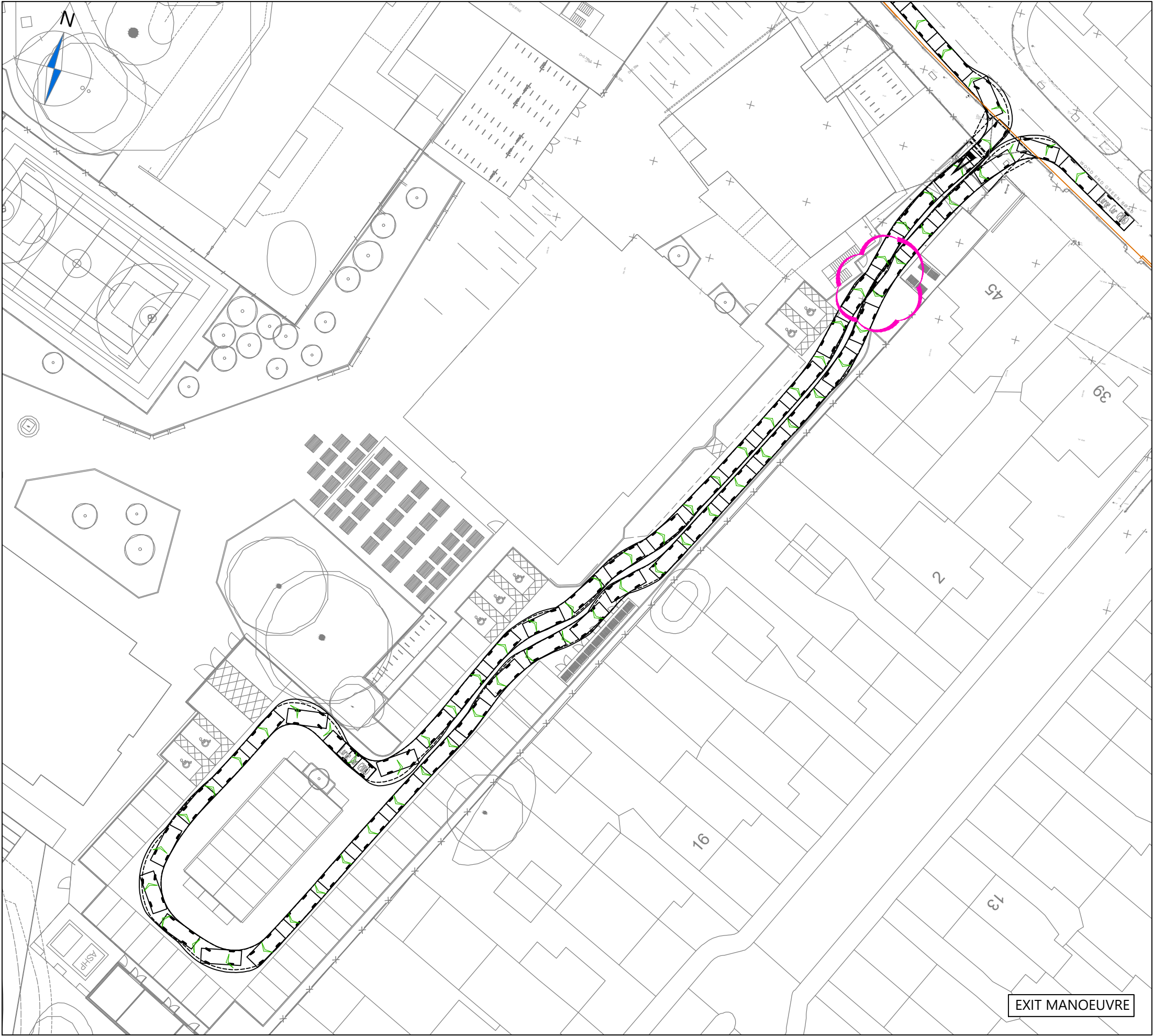

NOTES

- 1. Do not scale from this drawing.
- 2. This drawing to be read & printed in colour.
- 3. This drawing is for illustrative purposes only.

LARGE CAR

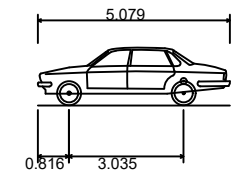

Overall Length	5.079m
Overall Width	1.872m
Overall Body Height	1.525m
Min Body Ground Clearance	0.310m
Max Track Width	1.831m
Lock to Lock Time	4.00s
Kerb to Kerb Turning Radius	5.900m

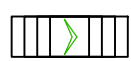

FORWARD MOVEMENTS ARE SHOWN
IN BLACK (*design speed - 5kph*)



REVERSE MOVEMENTS ARE SHOWN
IN BLUE (*design speed - 2.5kph*)

C	Revised scheme base & swept paths.	HE	JT	28.07.2023
B	New fire tender swept path added.	HE	JT	26.07.2023
A	Additional topo & design changes to suit.	HE	JT	25.07.2023

Rev	Details	REVISION HISTORY			Drawn	Checked	Date
Status:							
<input type="checkbox"/> Preliminary		<input type="checkbox"/> For Approval		<input type="checkbox"/> For Construction			
<input checked="" type="checkbox"/> For Information		<input type="checkbox"/> For Tender		<input type="checkbox"/> As Built			

Client: Bouygues UK

Project: Rosedale College

Drawing Title: Swept Path Analysis using an 8m 7.5t Box Van

Scale: 1:500 Size: A3

Drawn by: HE Checked by: GS Date: 20.07.2023

CANEPARO ASSOCIATES
Transport Planning & Highway Design
21 Little Portland Street • London • W1W 8BT • Tel. 020 3617 8200

Scheme Ref: CA5203	Drawing No: TR001	Sheet: 7 of 7	Rev: C
--------------------	-------------------	---------------	--------