

EXISTING PLAN

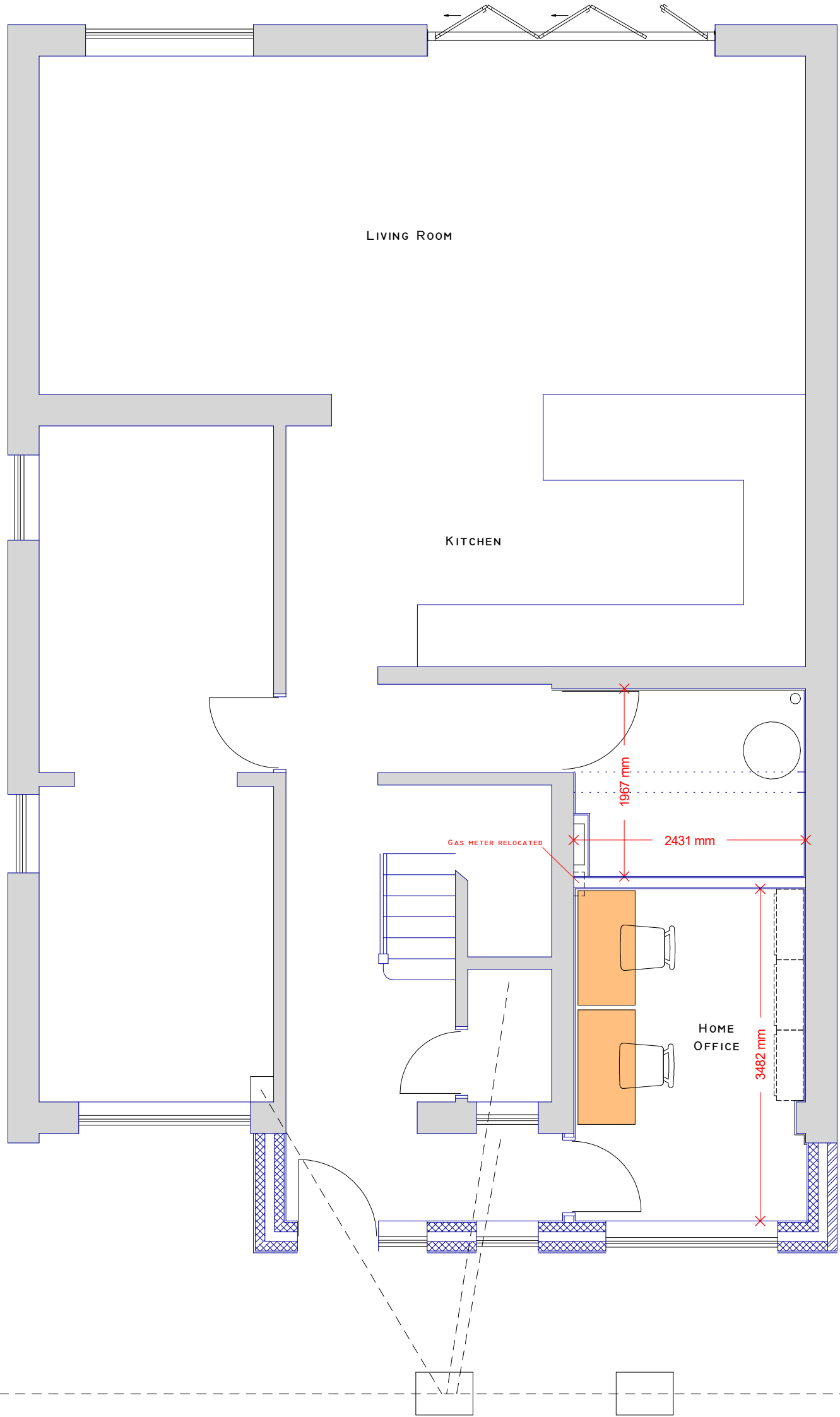

PROPOSED PLAN

13, Bellamy Close  
Ickenham



PLAN

PROJECT

Existing/Proposed Floor Plans  
SINGLE STOREY FRONT EXTENSION

General Notes:  
1. All dimensions to be checked on site prior to construction any discrepancies should be reported to the Highford design.  
2. All drawings are indicative of architect's intent and show design intent only.  
3. All drawings are subject to change without notice.  
4. All drawings are subject to change without notice.  
5. All drawings are subject to change without notice.  
6. All drawings are subject to change without notice.  
7. All drawings are subject to change without notice.  
8. All drawings are subject to change without notice.  
9. All drawings are subject to change without notice.  
10. All drawings are subject to change without notice.

DWG No  
**01**  
Rev: -

Date: June 2023  
Project: 89, Sutton Court Road  
Scale: 1:50 @ A2  
Checked: AN  
Drawing Title: Existing/Proposed Plans  
Status: Planning  
Job No: 404

**Highford**  
Design and Build Limited  
27 Bellamy Close, Ickenham, Middlesex, UB10 8SJ  
email: info@highforddesign.co.uk - web: www.highforddesign.co.uk  
mobile: 07951 340225